

Woven Wire Fence w/ Steel Posts  
NB 435+00 - 451+00 RT  
SB 435+00 - 451+00 LT

Julie Matting  
SB 435+00 - 451+25 LT  
SB 431+00 - 444+25 LT  
NB 449+50 - 451+00 LT  
SB 449+75 - 451+00 LT

Guard Rail, Three Cable w/ Lt Wood Posts  
NB 437+25 - 451+00 RT  
SB 440+05 - 451+00 LT

4" DRAINAGE TILE SHOWN IN APPROX. LOC.

\* Denotes Stage II Construction

"Control of Access is complete on this sheet"

GINGUE, JOHN & H. FRANCIS

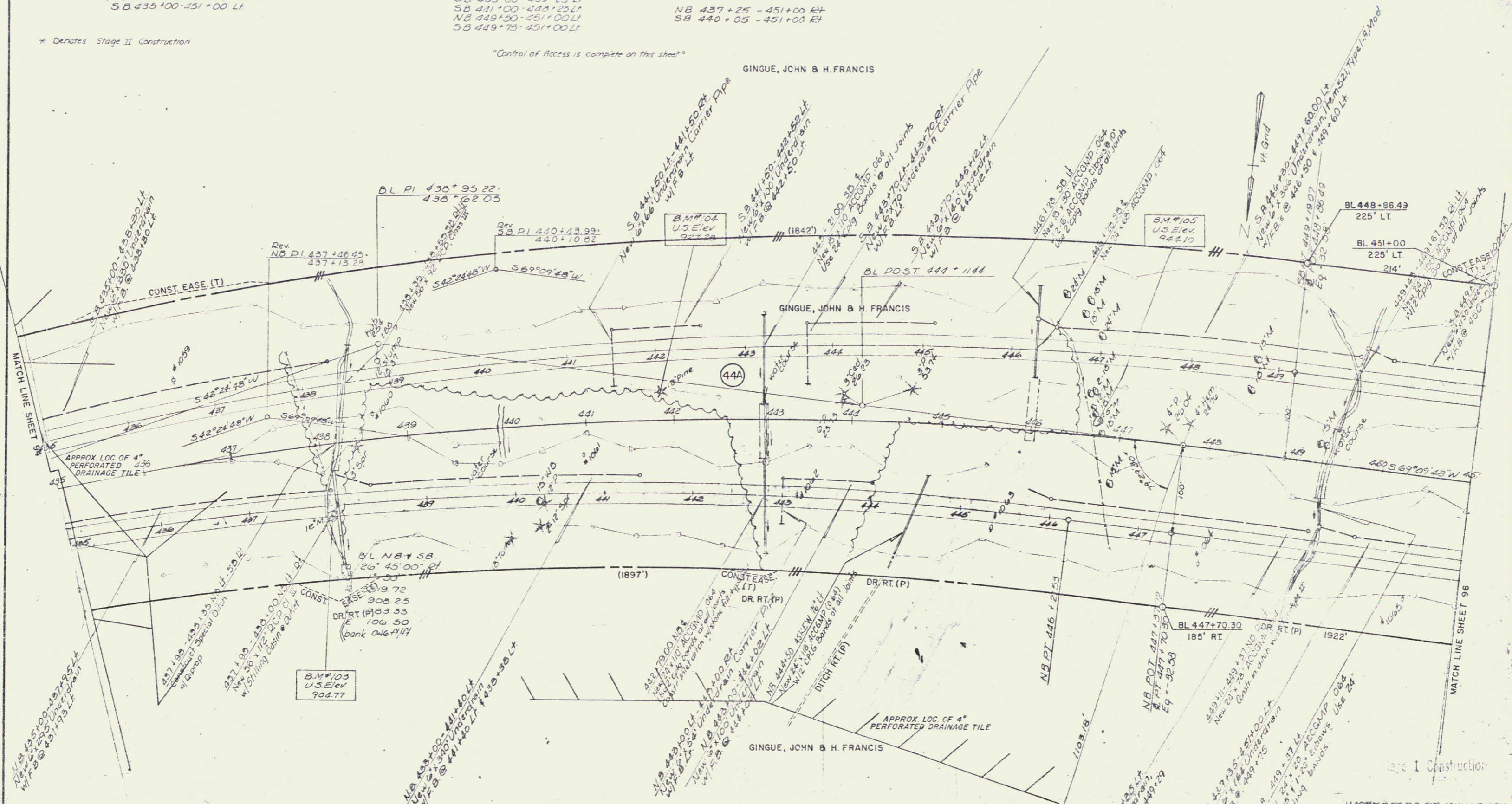

Stage I Construction

WATERFORD-ST. JOHNS-BURY

SURVEYED BY	DATE
DRAWN BY	DATE
TRACED BY	DATE
I 93-1(2) Sect II & Q1 23-1(6) Sect II	
SHEET	NO.
95	168

95

90