

INDEX OF SHEETS

# STATE OF VERMONT AGENCY OF TRANSPORTATION



## PROPOSED IMPROVEMENT BRIDGE PROJECT

### TOWN OF CHARLESTON COUNTY OF ORLEANS

ROUTE NO. TH. 3 BRIDGE NO. 24 & 25

PROJECT LOCATION: BEGINNING AT JUNCTION OF TH. 3 AND VT. 105  
AND EXTENDING SOUTHWEST 536 FT.

PROJECT DESCRIPTION: CONSTRUCT NEW SIMPLE SPAN ROLL-ON BEAM  
BRIDGE WITH NECESSARY ROADWAY APPROACH AND CHANNEL  
WORK.

LENGTH OF STRUCTURE:	59.0 FEET
LENGTH OF PARTICIPATION ROADWAY:	536.41 FEET
LENGTH OF NON-PARTICIPATION ROADWAY:	0.0 FEET
LENGTH OF PROJECT:	536.41 FEET
LENGTH OF R.O.W. PROJECT:	586.00 FEET

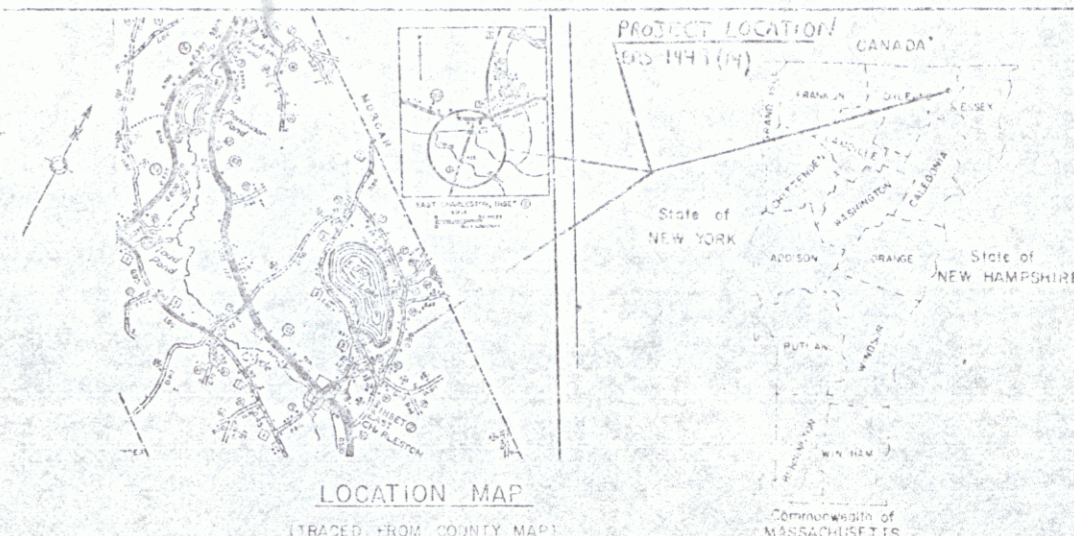

## R.O.W. PLANS

BEGIN R.O.W. PROJECT  
BRZ 1449(14) REV. STA. 50+34 25' RT.

END R.O.W. PROJECT  
BRZ 1449(14) REV. STA. 56+00 22' LT.

CONVENTIONAL SIGNS

COUNTY LINE	---
TOWN LINE	---
POINTS OF ADJACENCY	---
POINT OF ADJACENCY	---
FENCE LINE	---
STONE WALL	---
TRIPLED RAIL	---
RAILROAD	---
SUBVEY LINE	---
CULVERT	---
POWER POLE	---
TELEPHONE POLE	---
TREES	---
CONTROL OF ACCESS	---
PROPERTY LINE	---
R.O.W. TAKING LINE	---
SLOPE RIGHTS	---
TOP OF CUT	---
TOE OF SLOPE	---

DATUM

VERTICAL	---
HORIZONTAL	---

MP 7.050

MP 7.025

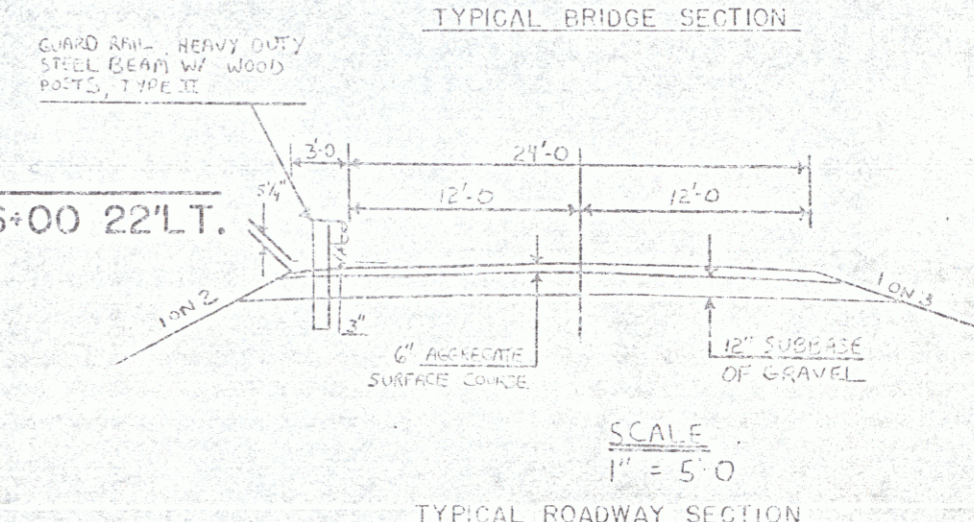
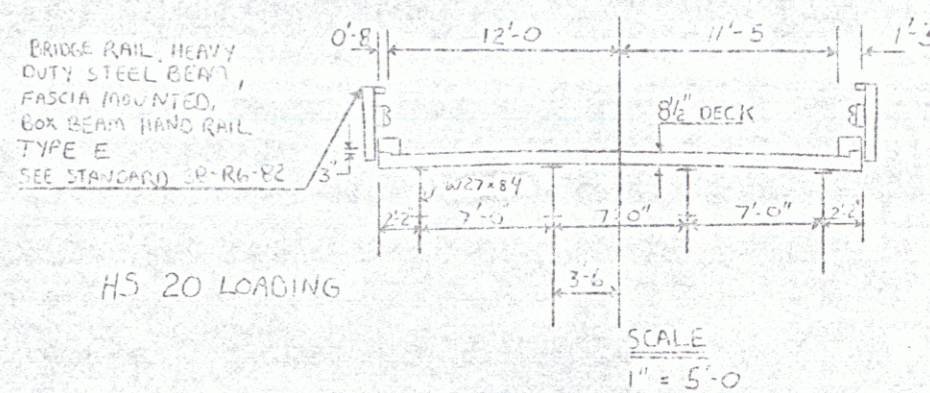
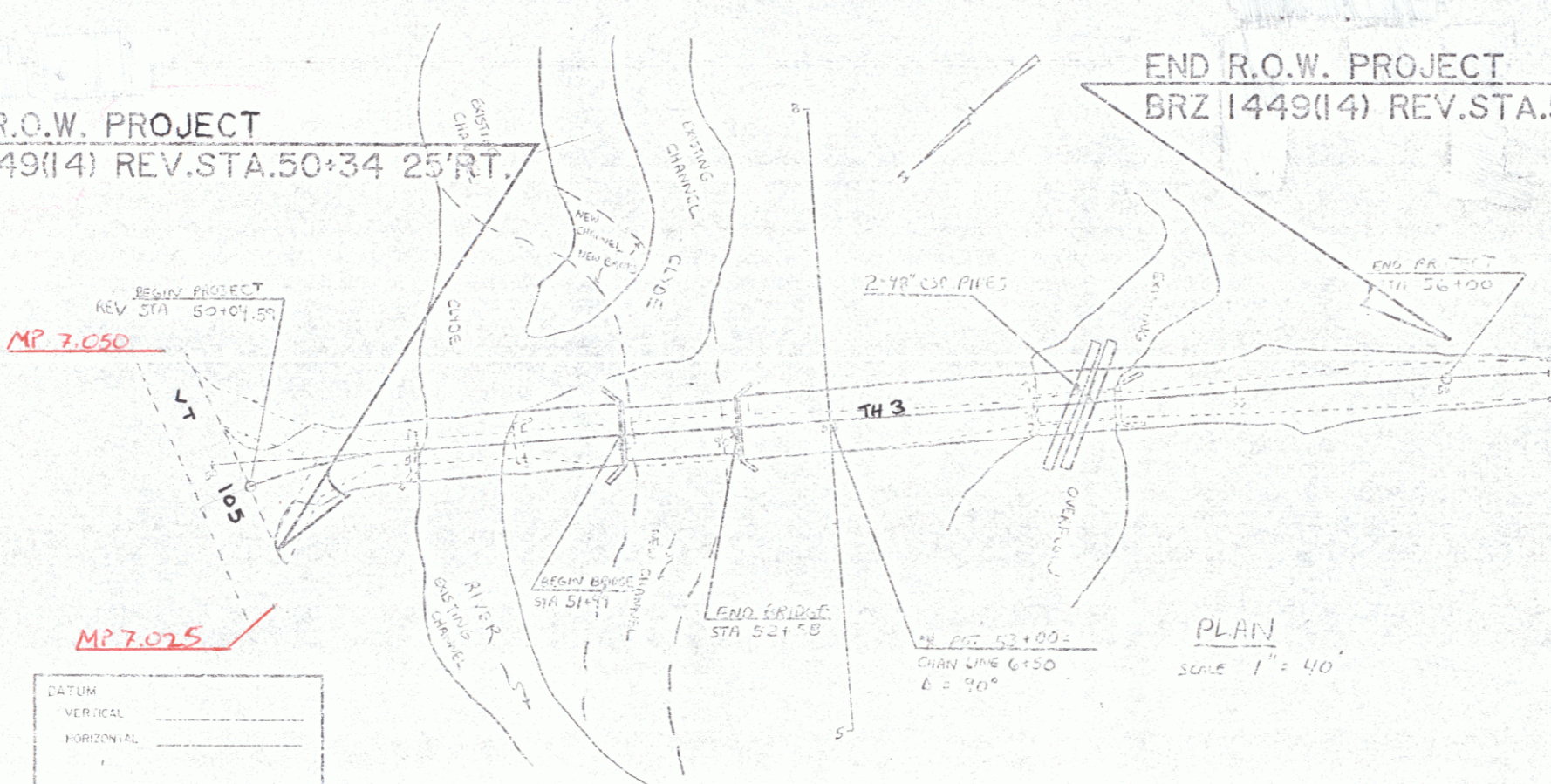

THESE PLANS ARE SUBJECT TO SUCH ENGINEERING  
CHANGES AS MAY BE REQUIRED BY THE FEDERAL  
HIGHWAY ADMINISTRATION OR THE CHIEF ENGINEER.  
CONSTRUCTION IS TO BE CARRIED ON IN ACCORDANCE  
WITH THESE PLANS AND THE STANDARD SPECIFICATIONS  
FOR CONSTRUCTION DATED 1986, FOR USE ON THESE  
PROJECTS, INCLUDING ALL SUBSEQUENT PROVISIONS AS  
ARE INCORPORATED IN THESE PLANS.

Route VT105  
Pin#63C560

APPROVED: *Paul D. Kelly* DATE 1/16/92  
CHIEF ENGINEER

APPROVED: *John N. B. Sullivan* DATE 1/21/92  
Chief, Property Administration

CHARLESTON  
BRZ 1449(14)  
R.O.W. SHEET 1 OF 6

FEB 05 1992

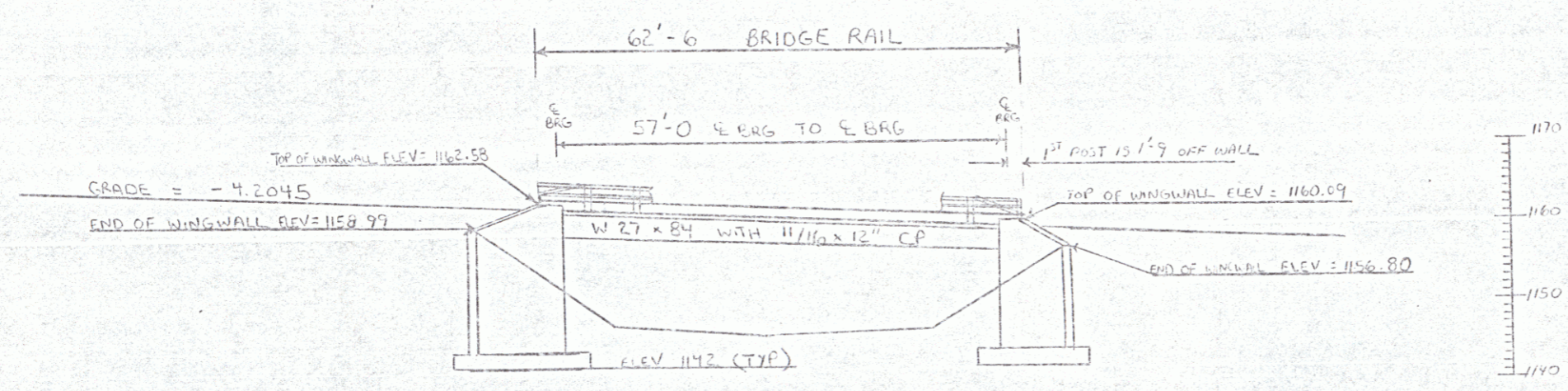
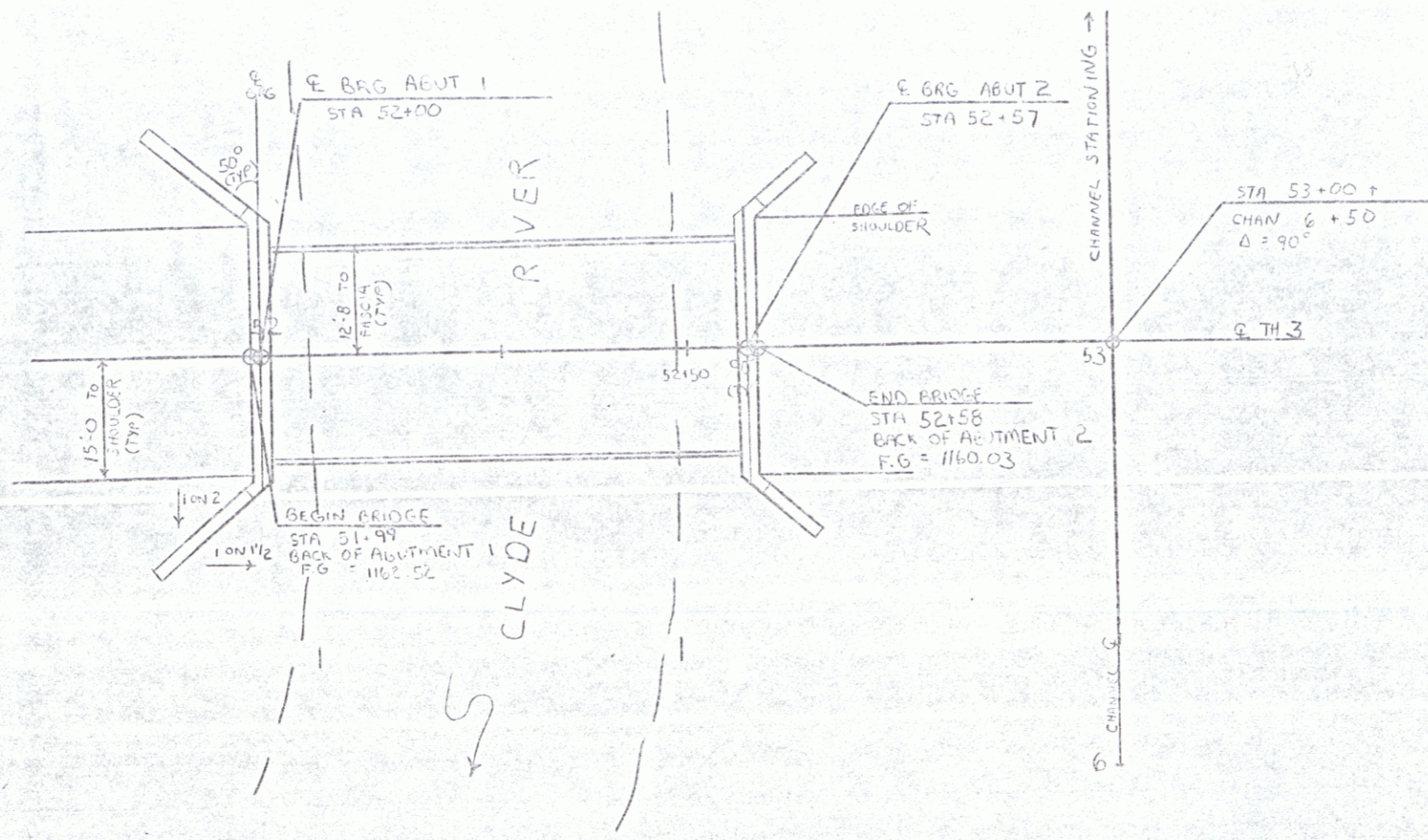

<b>STATE OF VERMONT</b>	
<b>AGENCY OF TRANSPORTATION</b>	
Town Of CHARLESTON	Bridge No. 24
Highway No. TH-2	Loc. Sta. 52+00
TH-2 OVER CLYDE RIVER	
DETAIL PLAN AND ELEVATION BR 24	
Designed By A. CHURCH	Drawn By A. CHURCH
Checked By Date	Bridge Design Supervisor
R.L. OATLEY Date 4-2-89	
PROJECT CHARLESTON	PROJECT NO. BRZ 1449(14)
Loc. Info.	
R.O.W. Sheet 2 of 6	

NOTE:  
BLOCK OF STONE FILL DEPICTED  
HERE IS FOR PIPE OUTLET ONLY  
SEE PLAN FOR STONE FILL LIMITS

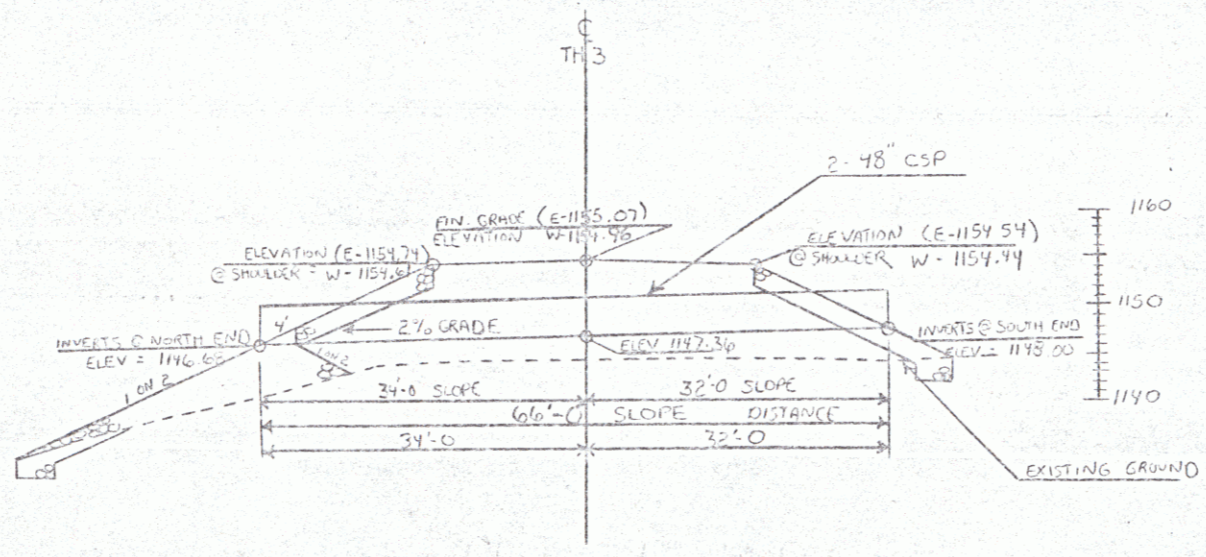
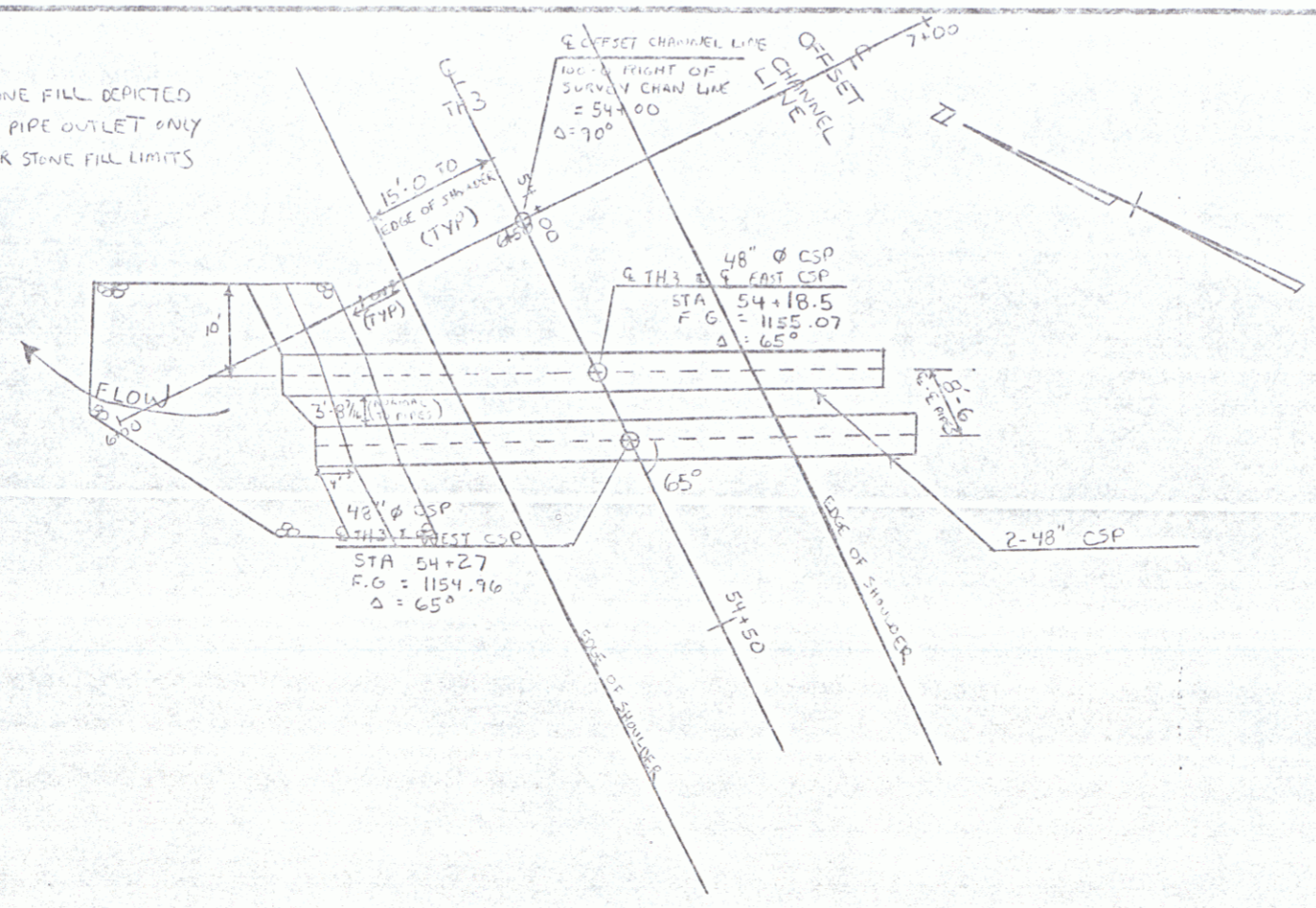

FEB 05 1992

STATE OF VERMONT AGENCY OF TRANSPORTATION	
Town Of	CHARLESTON
Highway No.	TH 3
TH 3 OVER SLIDE RIVER	
DETAIL PLAN AND ELEVATION BR 25	
Designed By	A. CHASE
Checked By	DATE
PROJECT	CHARLESTON
L.C. Info.	

STATE OF VERMONT  
AGENCY OF TRANSPORTATION  
RIGHT OF WAY PLANS  
DETAIL SHEET

PARCEL NO.	GRANTOR	SHEET NO.	BEGINNING STATION	ENDING STATION	TAKING	ITEM	RIGHTS	TITLE TAPEN	DATE	TOWN OR CITY RECORDED	BK.	PG.	REMARKS	REVISION NO.	SHEET NO.	DESCRIPTION OF REVISION	DATE	MADE BY	APPROVED BY	
1	HAUCK, RICHARD F. & JANET	5	50 + 86 LT. REV. 50 + 44 LT. 50 + 69 LT.	51 + 20 LT. 50 + 89 LT. 50 + 87 LT.	0.03 A±		CONST. EASE (T) (100 SF±) SLOPE (P) (45 SF±)	WDOE	9-23-88	CHARLESTON	39	304	(1225 SF±)	1	4,5	PARCEL NO. 2 TITLE CHANGE FROM THE CHURCH OF THE NAZARENE, INC. - HAZEL D. (MORSE) LOCKE - LIFE ESTATE TO THE CHURCH OF THE NAZARENE, INC. PER. CO. 7349  <i>Myans to Berge 2-8-89</i>	7-28-88	A.S.J.	<i>Sub</i>	
2	THE CHURCH OF THE NAZARENE INC.	5	REV. 50 + 34 RT. REV. 50 + 34 RT. 51 + 42 RT. 51 + 47 RT.	51 + 20 RT. 51 + 20 RT. 51 + 90 RT. 51 + 83 RT.	0.03 A±		CONST. EASE (T) (310 SF±) CONST. EASE (T) (0.02 A±) CHANNEL (P) (0.03 A±)	WDOE	2-27-89	CHARLESTON	40	101	(1090 SF±)  ( 950 SF±) (1195 SF±)							
3A	CROWN, LYNWOOD L. & MARLENE L.	5	51 + 20 RT. 51 + 20 RT. 51 + 51 RT. 51 + 84 RT.	54 + 46 RT. 51 + 51 RT. 52 + 55 RT. 55 + 87 RT.	0.08 A±		CONST. EASE (T) (0.03 A±) CHANNEL (P) (0.22 A±) CONST. EASE (T) (0.06 A±)	WDOE	1-6-89	CHARLESTON	40	73	(1250 SF±)  (3435 SF±)							
3B		5	51 + 06 LT. 51 + 73 LT. 53 + 93 LT.	56 + 00 LT. 52 + 20 LT.	0.40 A±		LANDSCAPE (T) DRIVE (T)						18' GRAVEL							
4	CITIZENS UTILITIES												UTILITY							
5	NEW ENGLAND TELE. CO.												UTILITY							

MADE BY: A JONES DATE 1/9/88  
CHECKED BY: F.J. MALNATI DATE 1/9/88

DR. RT. - DRAINAGE RIGHT  
DIT. RT. - DITCHING RIGHT  
CH. RT. - CHANNEL RT.  
DRIVE RT. - DRIVE RIGHT  
CUL. RT. - CULVERT RIGHT  
(D) - DEMOLITION OR REMOVAL  
(W) - WATER SOURCES

PRESENT R.O.W.  
TAKING WITHOUT ACCESS  
TAKING WITH ACCESS  
PERMANENT EASEMENT  
TEMPORARY EASEMENT

LEGEND  
--- CONST. EASE --- CONSTRUCTION EASEMENT  
SR SR SLOPE RIGHTS  
P PROPERTY LINE  
L TOP OF CURB  
O O TOE OF SLOPE

APPROVED: *[Signature]* DATE: 1-28-88  
AGENT D. PLANS & TITLES

CHARLESTON  
BRZ 1448(14)  
ROW SHEET 4 OF 6

FEB 05 1992 4

REV. CURVE DATA  
 $\Delta = 14^{\circ}00'00''$  RT  
 $D = 20^{\circ}00'00''$   
 $R = 286.48$   
 $T = 35.18$   
 $L = 70.37$   
 $E = 2.15$   
 $2T-L = 0.36$

BM #1  
 ELEV 1160.58  
 CH. SQ @ SE  
 CORNER OF ABUT

BRIDGE RAIL - HEAVY DUTY  
 STEEL BEAM TYPE E  
 51+97 RT - 52+60 RT  
 51+97 LT - 52+60 LT

GUARD RAIL - HEAVY DUTY  
 STEEL BEAM W/ WOOD POSTS  
 TYPE II

SUR 50+59.5 RT - 51+97 RT  
 SUR 52+60 RT - 55+29 RT  
 SUR 50+53 LT - 51+77 LT  
 SUR 52+60 LT - 53+78 LT  
 54+09 LT - 55+10 LT

END R.O.W. PROJECT  
 BRZ 1449(14) REV. STA. 56+00 22' LT.  
 END PROJECT STA 56+00

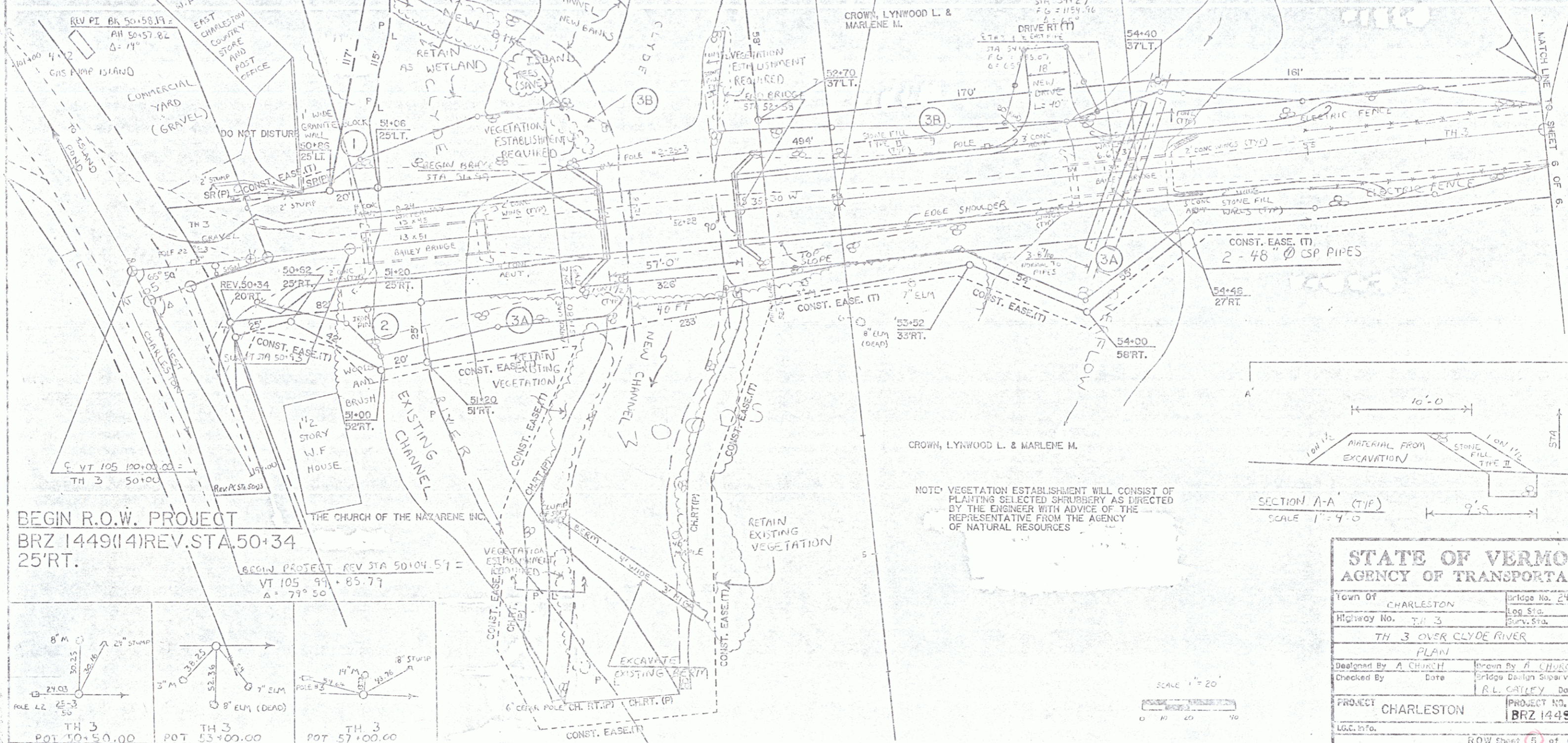

BEGIN R.O.W. PROJECT  
 BRZ 1449(14) REV. STA. 50+34  
 25' RT.

NOTE: VEGETATION ESTABLISHMENT WILL CONSIST OF PLANTING SELECTED SHRUBBERY AS DIRECTED BY THE ENGINEER WITH ADVICE OF THE REPRESENTATIVE FROM THE AGENCY OF NATURAL RESOURCES

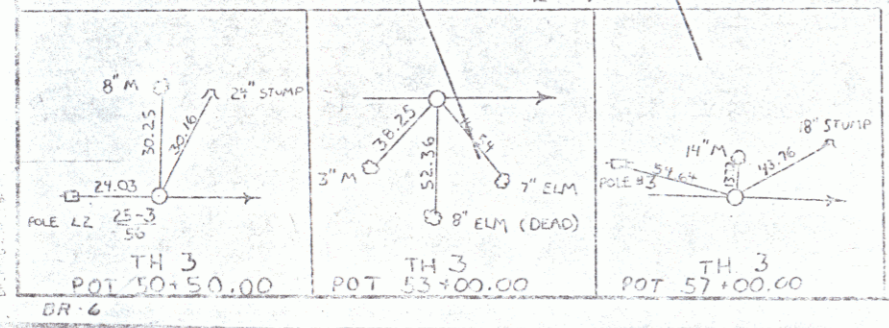
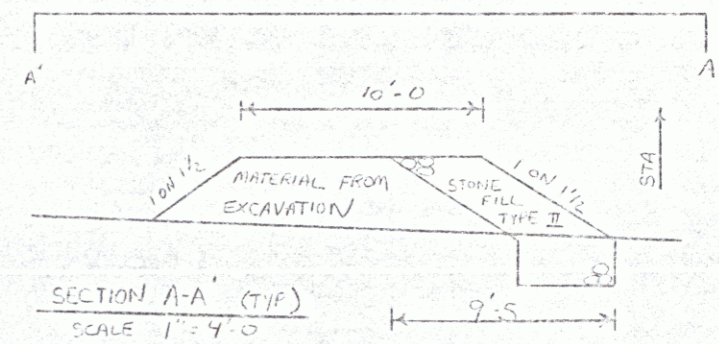

STATE OF VERMONT AGENCY OF TRANSPORTATION	
Town Of	CHARLESTON
Highway No.	TH 3
TH 3 OVER CLYDE RIVER	
PLAN	
Designed By	A. CHURCH
Checked By	Date
PROJECT	CHARLESTON
LOG. INFO.	PROJECT NO. BRZ 1449(14)
R.O.W. Sheet 5 of 6	

FEB 05 1992

BM #2  
ELEV 1152.24  
SPIKE IN POLE #3

CROWN, LYWOOD L. & MARLENE M.

### HYDRAULIC DATA

TH 3 B 24  
55' Steel Beam Bridge  
Drainage Area = 90.0 Sq. Mi. (233.1 Sq. Km.)  
G 2.33 = 1400 cfs (40 cms); Headwater Elevation = 1151.8  
G 10 = 2800 " (80 " 11 " " " = 1153.8  
G 25 = 3400 " (100 " 11 " " " = 1154.4  
G 50 = 4050 " (110 " 11 " " " = 1155.0  
G 100 = 4700 " (135 " 11 " " " = 1155.4  
Tailwater Elevation @ D25 = 1154.4; depth = 8.4' (2.6 m)  
Outlet Velocity @ G 25 = 8.1 fpm (2.5 mps)  
Roadway overflow occurs at approximately G5.  
Use Stone Fill, Type II where deemed necessary.

TH 3 B 25  
2 - 48" pipes  
Drainage Area = 90.0 Sq. Mi. (Overflow to B 24)  
G 2.33 = 1400 cfs (40 cms); Headwater Elevation = 1151.8  
G 10 = 2800 " (80 " 11 " " " = 1153.8  
G 25 = 3400 " (100 " 11 " " " = 1154.4  
G 50 = 4050 " (115 " 11 " " " = 1155.0  
G 100 = 4700 " (135 " 11 " " " = 1155.4  
Tailwater Elevation @ D25 = 1154.4; depth = 9.4' (2.8 m)  
Outlet Velocity @ D25 = 8.7 fpm (2.5 mps)  
Roadway overflow occurs at approximately G5.  
Use Stone Fill, Type II where deemed necessary.

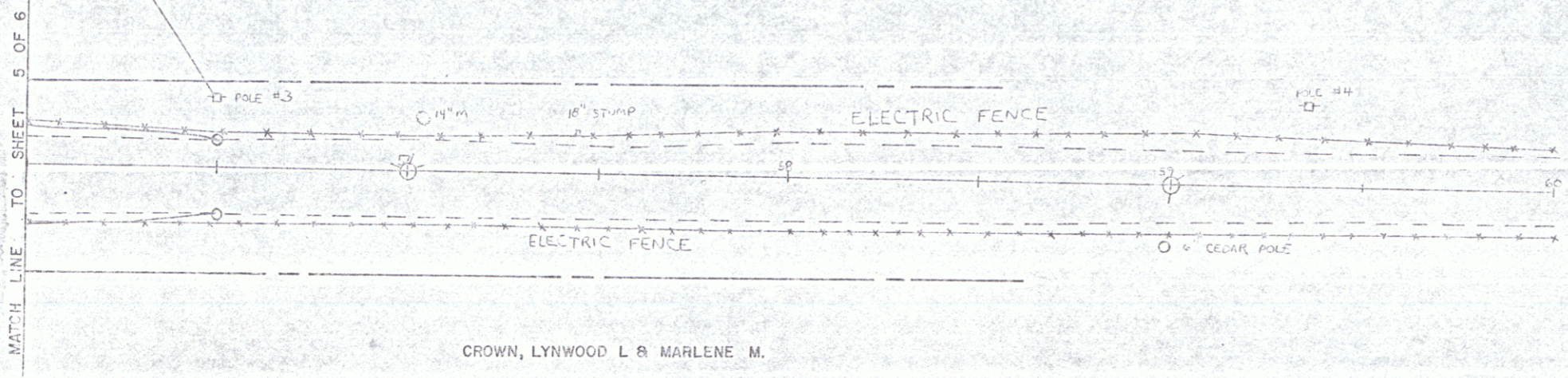

DATE	1/14/92
BY	W. J. BRZ
CHECKED BY	A. C. CRONIN
SCALE	1" = 40'
PROJECT	BRIDGE 1449(14)
SHEET	6 OF 6

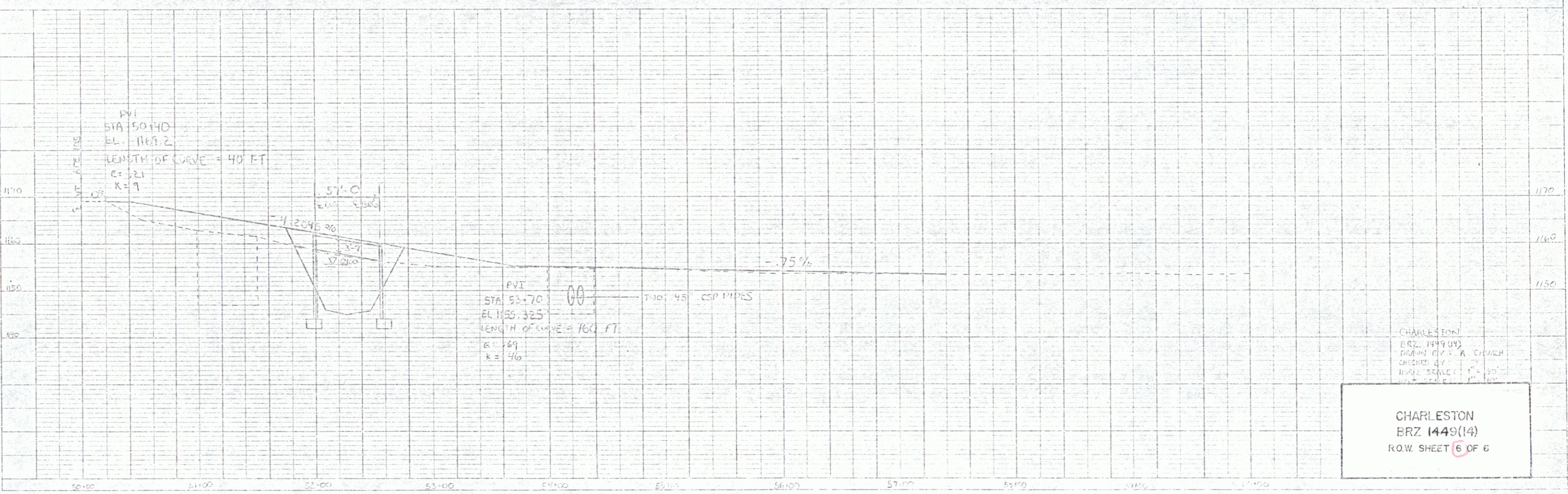

CHARLESTON  
BRZ 1449(14)  
DRAWN BY: A. CRONIN  
CHECKED BY: W. J. BRZ  
SCALE: 1" = 40'

CHARLESTON  
BRZ 1449(14)  
R.O.W. SHEET 6 OF 6

FEB 05 1992 6