

INDEX OF SHEETS

STATE OF VERMONT AGENCY OF TRANSPORTATION



PROPOSED IMPROVEMENT BRIDGE PROJECT

TOWN OF CHARLESTON COUNTY OF ORLEANS

ROUTE NO. TH. 3 BRIDGE NO. 24 & 25

PROJECT LOCATION: BEGINNING AT JUNCTION OF TH. 3 AND VT. 105 AND EXTENDING SOUTHWEST 536 FT.

PROJECT DESCRIPTION: CONSTRUCT NEW SIMPLE SPAN ROLLER BEAM BRIDGE WITH NECESSARY ROADWAY APPROACH AND CHANNEL WORK.

LENGTH OF STRUCTURE:	59.0 FEET
LENGTH OF PARTICIPATION ROADWAY:	536.41 FEET
LENGTH OF NON-PARTICIPATION ROADWAY:	0.0 FEET
LENGTH OF PROJECT:	536.41 FEET
LENGTH OF R.O.W. PROJECT:	586.00 FEET

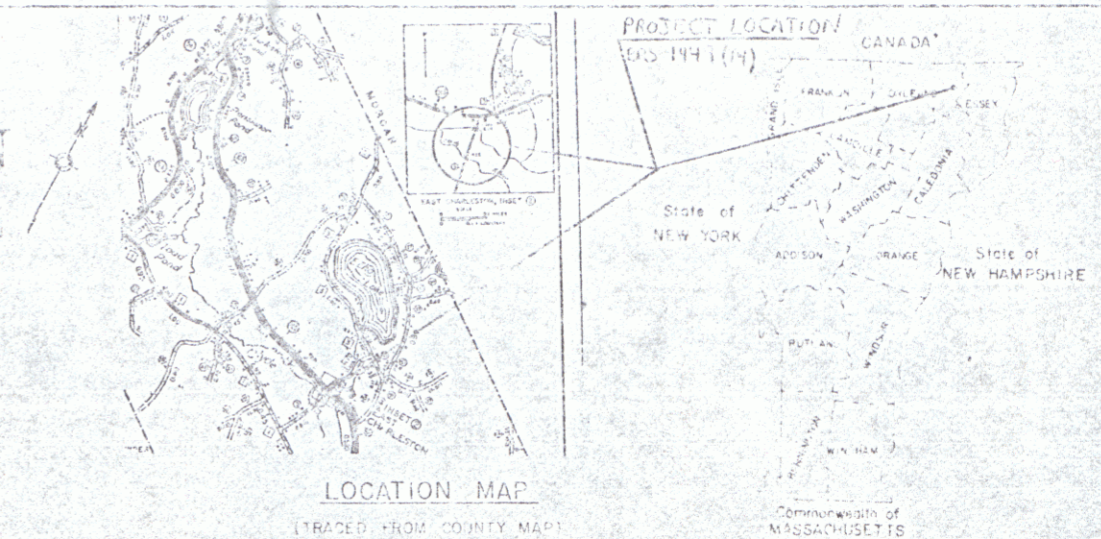

R.O.W. PLANS

BEGIN R.O.W. PROJECT
BRZ 1449(14) REV. STA. 50+34 25' RT.

END R.O.W. PROJECT
BRZ 1449(14) REV. STA. 56+00 22' LT.

CONVENTIONAL SIGNS

COUNTY LINE	---
TOWN LINE	---
POINT OF ADJACENCY	---
POINT OF ADJACENCY	---
FENCE LINE	---
STONE WALL	---
TRAP-ELED WAY	---
BOARD RAIL	---
RAILROAD	---
SILVER LINE	---
CULVERT	---
POWER POLE	---
TELEPHONE POLE	---
TREES	---
CONTROL OF ACCESS	---
PROPERTY LINE	---
R.O.W. TAKING LINE	---
SLOPE RIGHTS	---
TOP OF CUT	---
TOE OF SLOPE	---

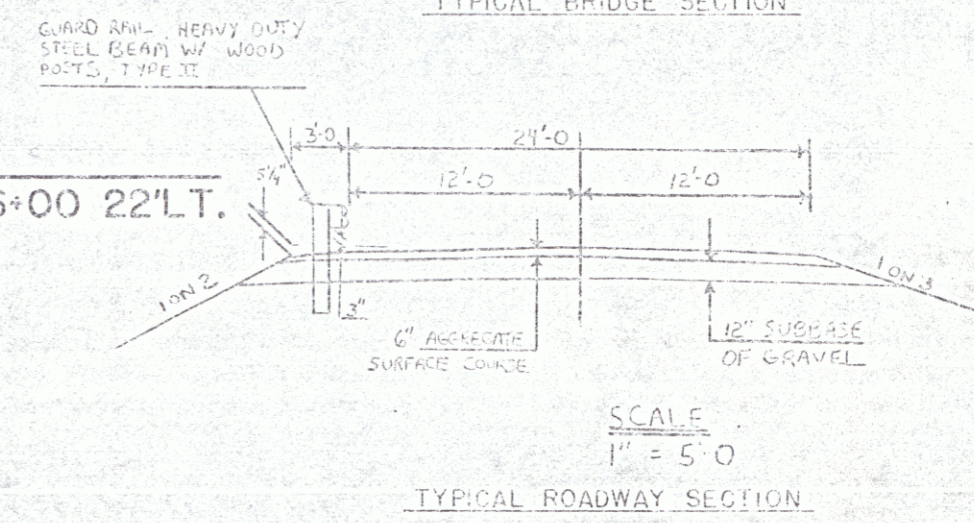
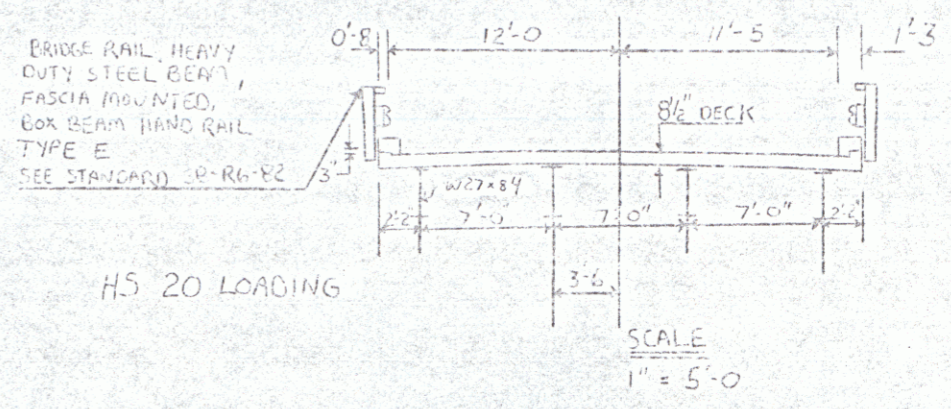
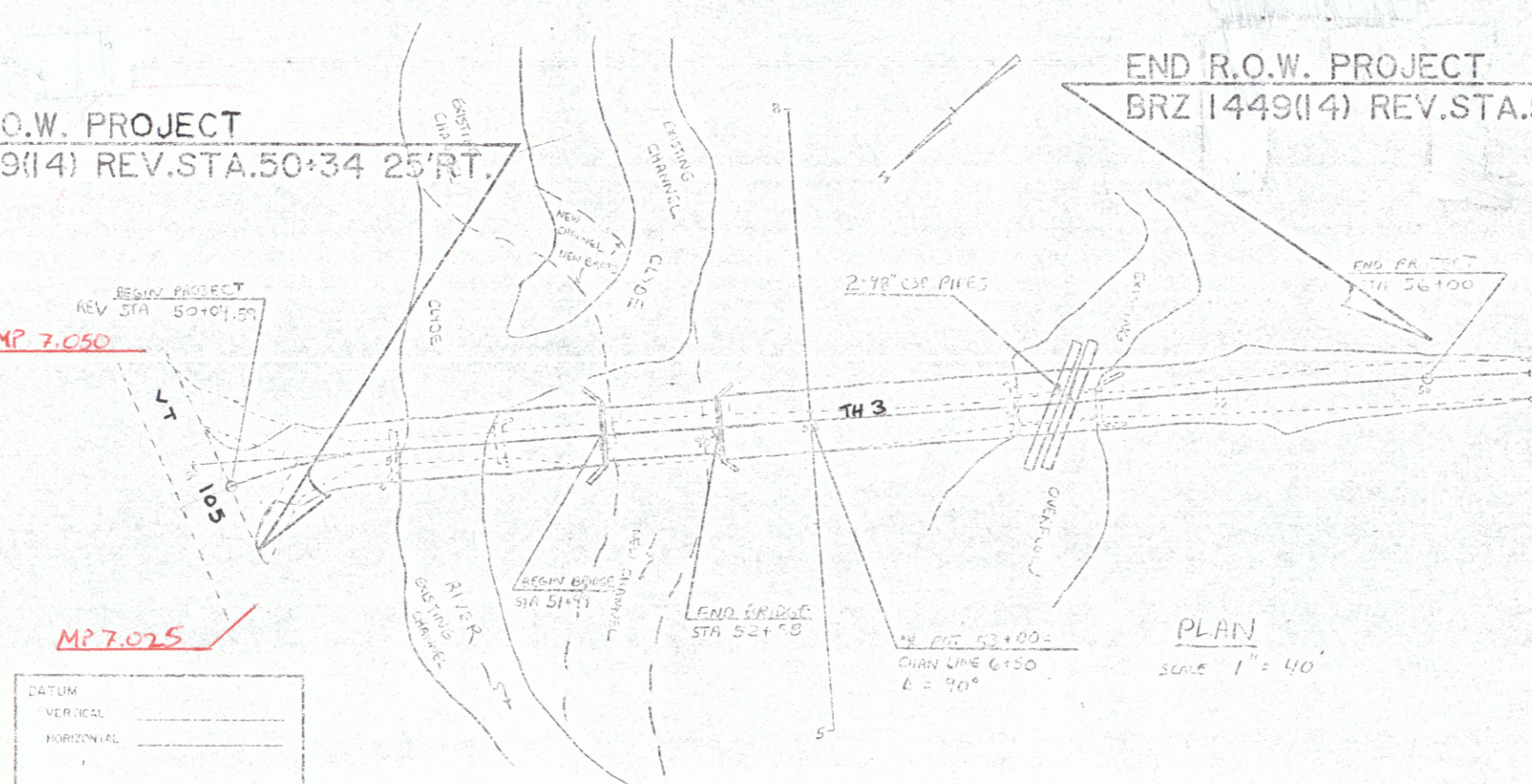

THESE PLANS ARE SUBJECT TO SUCH ENGINEERING CHANGES AS MAY BE REQUIRED BY THE FEDERAL HIGHWAY ADMINISTRATION OR THE CHIEF ENGINEER. CONSTRUCTION IS TO BE CARRIED ON IN ACCORDANCE WITH THESE PLANS AND THE STANDARD SPECIFICATIONS FOR CONSTRUCTION DATED 1986, FOR USE ON THESE PROJECTS, INCLUDING ALL SUBSEQUENT PROVISIONS AS ARE INCORPORATED IN THESE PLANS.

Route VT105
Pin # 63C560

APPROVED: *Paul D. Kelly* DATE 1/16/92
CHIEF ENGINEER

APPROVED: *John N. B. Sullivan* DATE 1/21/92
Chief, Property Administration

CHARLESTON
BRZ 1449(14)
R.O.W. SHEET 1 OF 6

FEB 05 1992