

- INDEX OF SHEETS**
1. TITLE SHEET
 2. BRIDGE QUANTITY SHEET
 3. PLAN & PROFILE
 4. PLAN
 5. PLAN & PROFILE
 6. PLAN & ELEVATION
 7. ROADWAY X-SECTIONS
 8. CHANNEL X-SECTIONS

RIGHT-OF-WAY DIVISION
TOWN FILE
PERPETUAL
Town of Randolph
(To Be Returned To R.O.W. Division)

STATE OF VERMONT
AGENCY OF TRANSPORTATION



PROPOSED IMPROVEMENT
BRIDGE PROJECT

TOWN OF RANDOLPH

COUNTY OF ORANGE

ROUTE NO: T.H. 42 BRIDGE NO: 37

PROJECT LOCATION: Starting at a Point on T.H. 42 650 ft. Westward from
V. 12. and Continuing Eastward From That Point for 650 ft.
Crossing AHERS BROOK, Extending to V. 12. in Direction
PROJECT DESCRIPTION: Construct 37' of Concrete Slab
Bridge, including Roadway Approach
and Channel Work.

LENGTH OF STRUCTURE:	35.	FEET
LENGTH OF PARTICIPATION ROADWAY:	612.	FEET
LENGTH OF NON-PARTICIPATION ROADWAY:	0.	FEET
LENGTH OF PROJECT:	650.	FEET
LENGTH OF PROJECT (R.O.W.):	780.	FEET

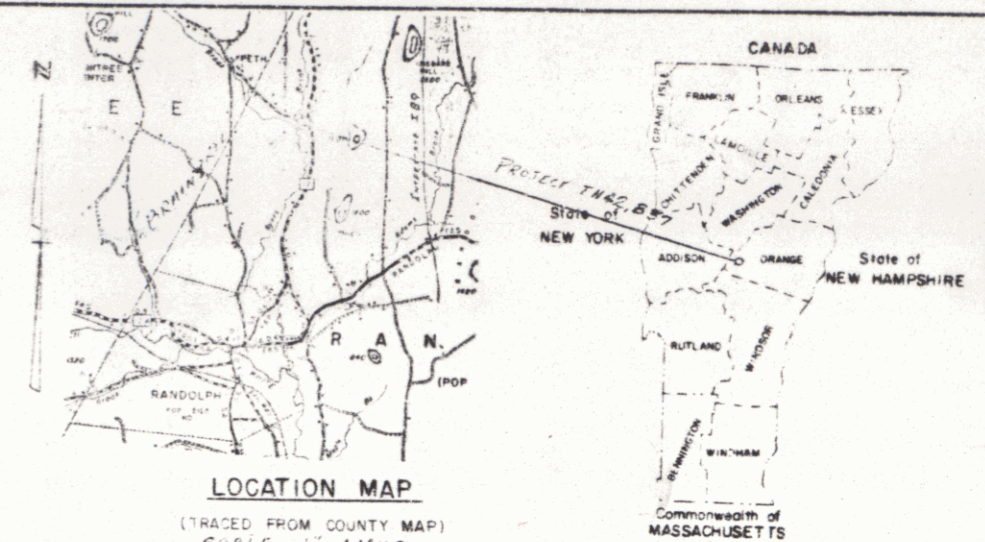

GENERAL NOTES
1. ALL SEEDING, FERTILIZING AND MULCHING SHALL BE
SUBSIDIARY TO PROJECT ITEMS.

R.O.W. PLANS

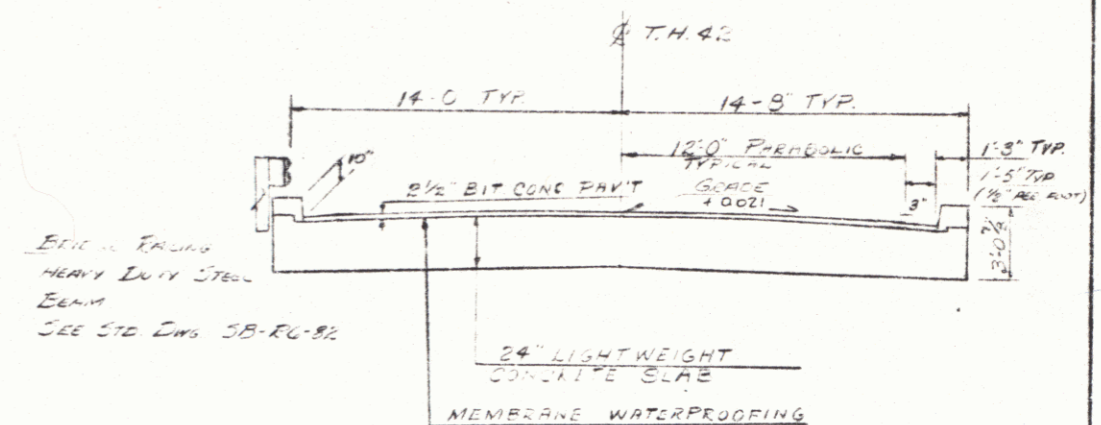
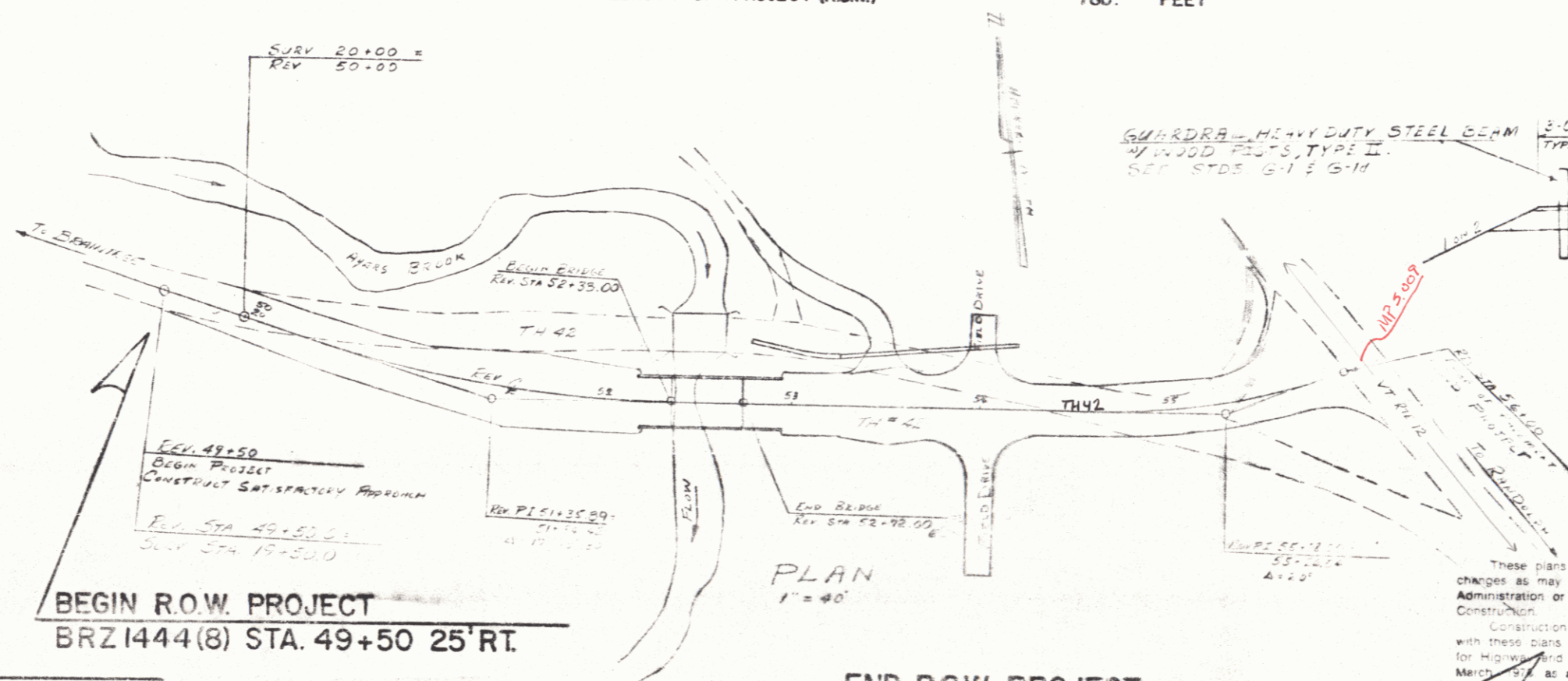

TYPICAL BRIDGE SECTION
1" = 4'

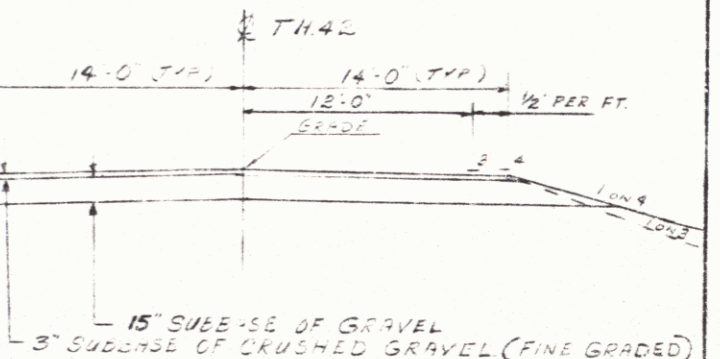

TYPICAL ROADWAY SECTION
1" = 5'

- CONVENTIONAL SIGNS**
- COUNTY LINE
 - TOWN LINE
 - LIMITS OF ACCESS
 - POINT OF ACCESS
 - FENCE LINE
 - STONE WALL
 - TRAVELED WAY
 - RAILROAD
 - SURVEY LINE
 - CULVERT
 - POWER POLE
 - TELEPHONE POLE
 - TREES
 - CONTROL OF ACCESS
 - PROPERTY LINE
 - R.O.W. TAKING LINE
 - SLOPE RIGHTS
 - TOP OF CUT
 - TOE OF SLOPE

DATE: M
VERTICAL: 1/11/87
HORIZONTAL: 1/11/87

BEGIN R.O.W. PROJECT
BRZ 1444(8) STA. 49+50 25' RT.

END R.O.W. PROJECT
BRZ 1444(8) SURV. STA. 27+30 58' RT.

Rte. VT 12

These plans are subject to such engineering changes as may be required by the Federal Highway Administration or the Director of Engineering and Construction.
Construction is to be carried on in accordance with these plans and the Standard Specifications for Highway and Bridge Construction dated March 1974 as approved by the Federal Highway Administration on October 27, 1974 for use on Vermont including all subsequent revisions and supplementary specifications and special provisions as are incorporated in these plans.

APPROVE: W.P.C. DATE: 6-27-87
CHIEF, PROPERTY ADMINISTRATION

SUBMITTED BY ORDER OF THE STATE TRANSPORTATION BOARD

APPROVED: [Signature] DATE: 6-27-87
CHIEF, ENGINEERING

Pin # 63C216

PROJECT: RANDOLPH PROJECT NO: BRZ 1444(8)

SHEET: D OF 4

6/24/87
FEB 24 1987

GUARDRAIL - HEAVY DUTY STEEL BEAM W/ WOOD POSTS
TYPE II (ITEM 62.1.33)

51+61.75 LT ~ 52+11.75 LT 52+99.25 LT ~ 53+49.25 LT
51+36.75 RT ~ 52+11.75 RT 52+99.25 RT ~ 53+49.25 RT

BRIDGE RAILING - HEAVY DUTY STEEL BEAM - FACIA MOUNTED
(ITEM 617.35)

52+11.75 LT ~ 52+99.25 LT
52+11.75 RT ~ 52+99.25 RT

ANCHORS FOR STEEL BEAM
GUARD RAIL W/ STEEL OR WOOD
POSTS @ OPENINGS

51+61.75 LT & 53+49.25 LT
51+36.75 RT & 53+49.25 RT

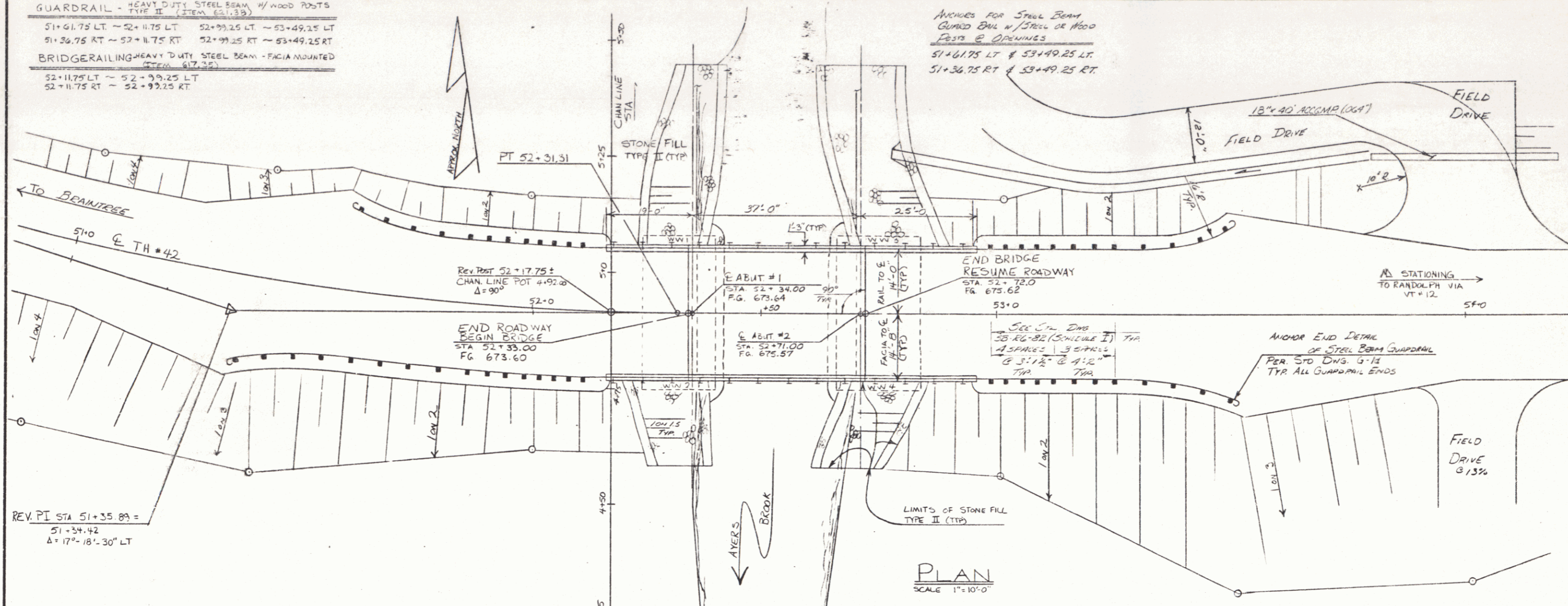

REV. PI STA 51+35.89 =
51+34.42
Δ = 17°-18'-30" LT

HYDRAULIC DATA

Drainage Area = 23.9 sq. mi. (59.6 sq. km.)
Q 2.33 = 700 cfs (20 cms.); BM. Elev. = 666.4
Q 10 = 1700 cfs (50 cms.); BM. Elev. = 666.9
Q 25 = 2400 cfs (70 cms.); BM. Elev. = 668.3
Q 50 = 2900 cfs (85 cms.); BM. Elev. = 669.2
Q 100 = 3400 cfs (100 cms.); BM. Elev. = 669.7
Tailwater at Q 25 = 7.2' (2.2 m.)
Outlet velocity @ Q 25 = 10.1 fps (3.1 m/s.)
Overflow spillway at Q = 2600 cfs. = Q 33+

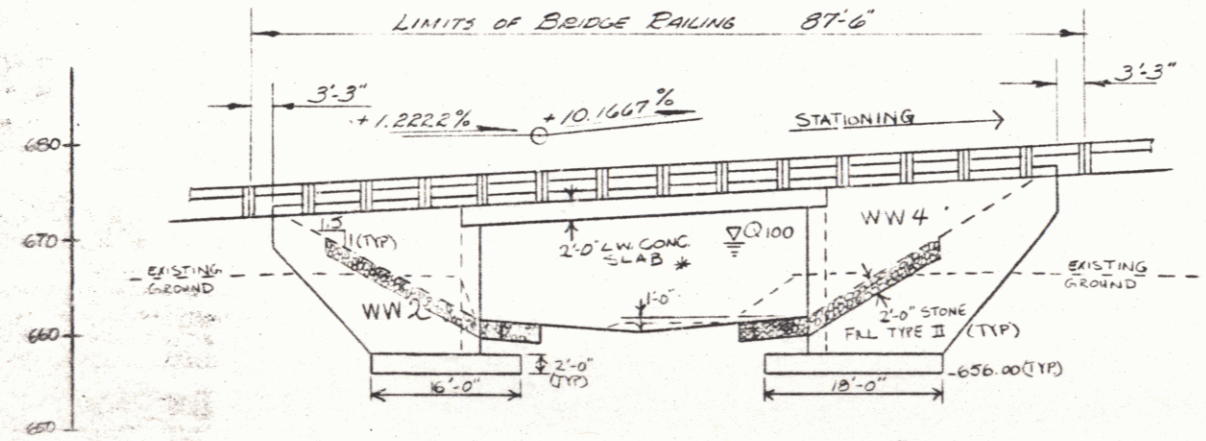

ELEVATION

SCALE 1" = 10'-0"

* HERE: LINE TO BE CONSTRUCTED
ON A TANGENT.

STATE OF VERMONT	
AGENCY OF TRANSPORTATION	
TOWN OF RANDOLPH	Bridge No. 37
HIGHWAY NO. TH # 42	Log Sta. 22+50
PLAN AND ELEVATION	
TH # 42 BR 37 OVER AYER'S BROOK	
Designed by R. P. GENDRON	Drawn by E. JUNG
Checked by	Bridge Design Supervisor
date	R. S. HAUPT date
PROJECT RANDOLPH	PROJECT NO. BRZ 1444(8)
Bridge Sheet No. 6	Sheet (2) of 6

PLAN
 DATE: 12-22-21
 BY: [Signature]
 CHECKED: [Signature]
 IN CHARGE: [Signature]

PROFILE
 DATE: 12-22-21
 BY: [Signature]
 CHECKED: [Signature]
 IN CHARGE: [Signature]

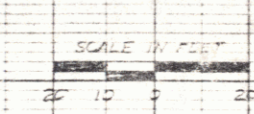
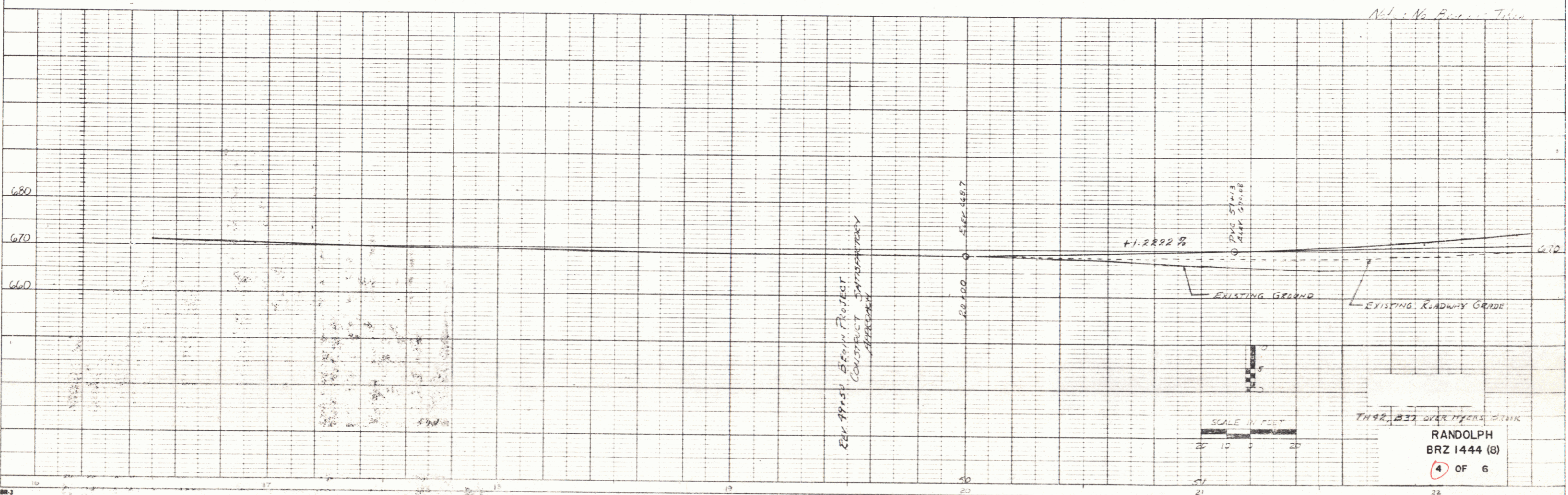
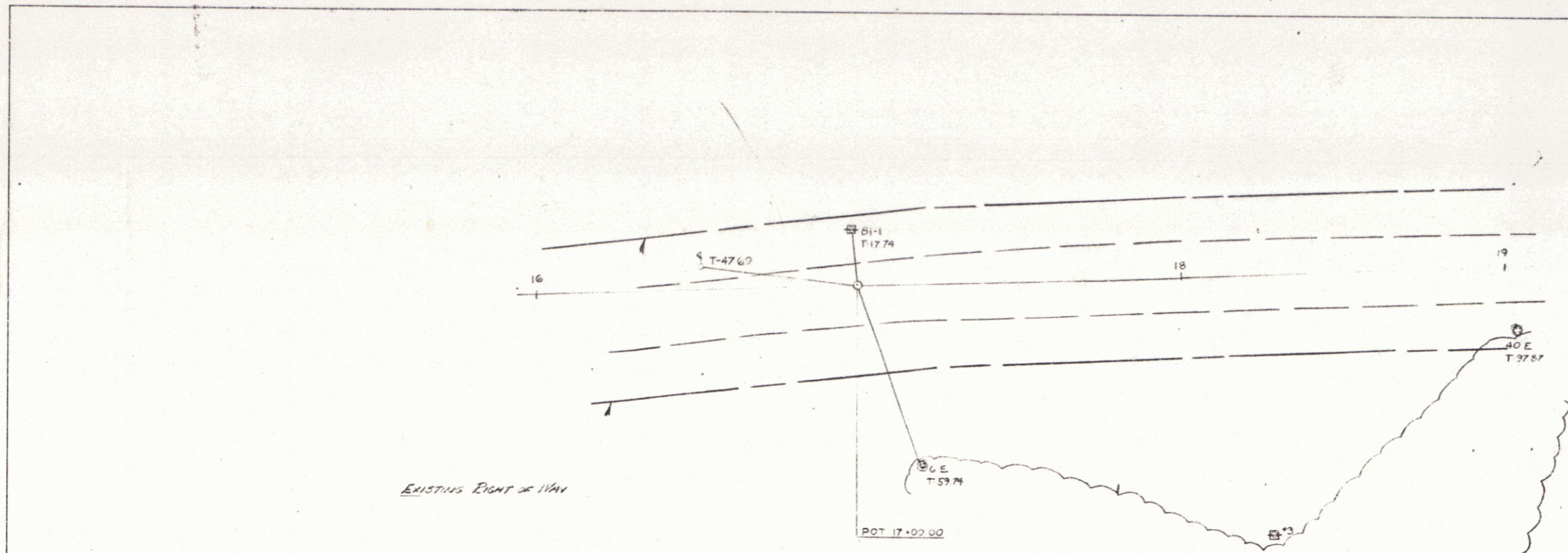

RANDOLPH
 BRZ 1444 (B)
 4 OF 6

STONE FILL TYPE III
STA 50+00 LT - 51+00 LT

NOTE: FOR BRIDGE PAV. STATIONING
SEE CAT. G.

REV. CURVE #1 DATA
Δ 17°-18'-30"
D 9'
T 96.59'
R 636.62
L 192.31
E 7.33
Bank 0.04' MEET

CONSTRUCT FIELD DRIVE
REV. STA 53+48 LT
REV. STA 54+00 LT
REV. STA 54+00 RT
CONSTRUCT DRIVES w/ 1 on 1 1/2 SLOPES
WIDTHS AS NOTED.

REV. CURVE #2 DATA
Δ = 20° LT
D = 14'
T = 72.16
R = 409.26
L = 142.86
E = 6.31
NO BANK

SURV. CURVE #1 DATA
Δ 17°-18'-30" LT
D 8'
R 716.20
T 109.00
L 216.35
E 8.25

EXISTING BRIDGE DATA

I BEAM #2 WITH CROSS PIECES
CONC DECK
CONC ABUT
PERP DIST 30'
ROADWAY 16.5'
CLEAR HEIGHT 6.5'
REMOVE EXISTING STRUCTURE TO EL. 666.0
PAV ITEM 202.50 - PARTIAL REMOVAL OF STRUCTURE

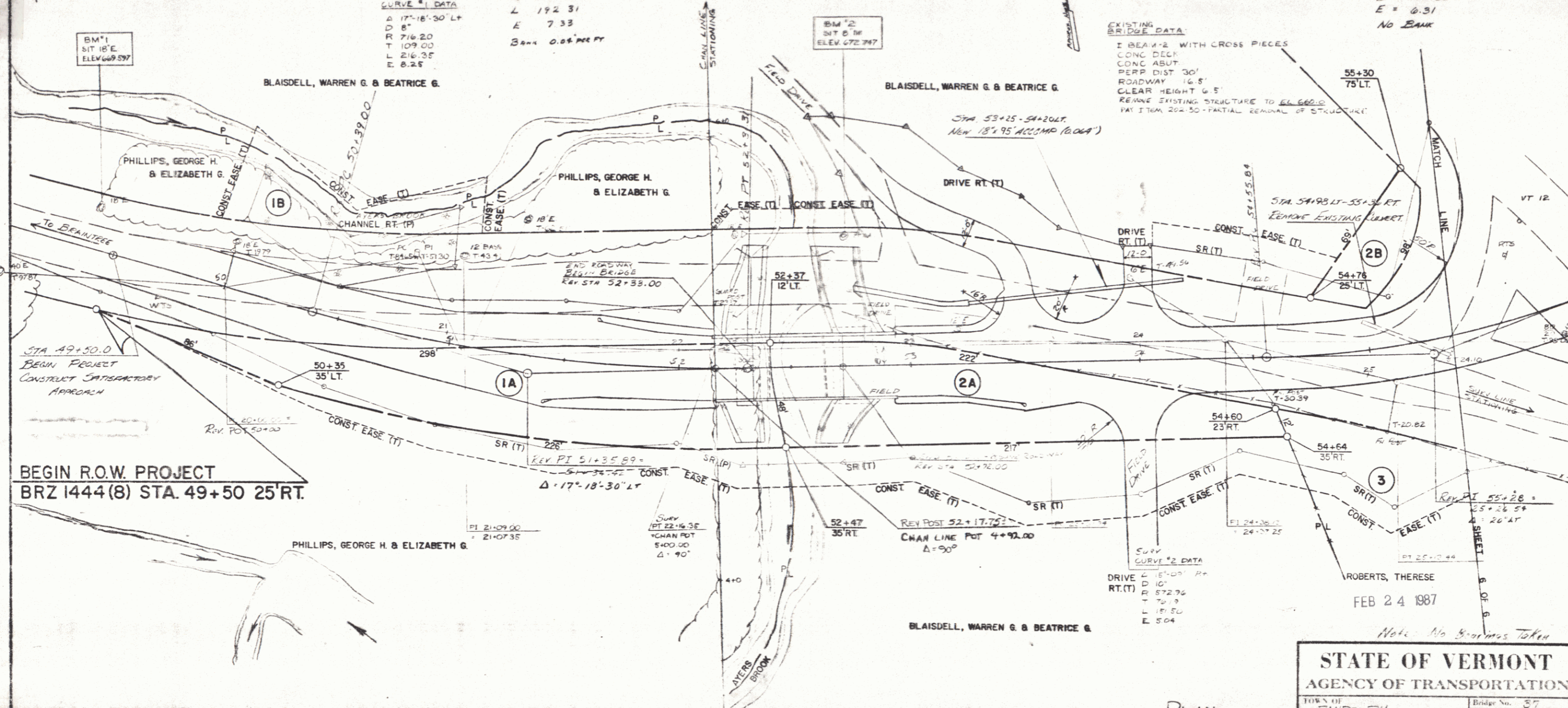

BEGIN R.O.W. PROJECT
BRZ 1444 (8) STA. 49+50 25' RT.

FEB 24 1987

STATE OF VERMONT AGENCY OF TRANSPORTATION	
TOWN OF RANDOLPH	Bridge No. 57
HIGHWAY NO. TH 40	Log Sta.
PLAN	
THRU BRZ OVER AYERS BROOK	
Designed by P. J. GARDNER	Drawn by D. E. HERITT
Checked by	Bridge Design Specialist
PROJECT RANDOLPH	PROJECT NO. BRZ 1444 (8)
Bridge Sheet No.	Sheet 5 of 6

PLAN
SCALE 1" = 20' HORIZONTAL
SCALE 1" = 10' VERTICAL

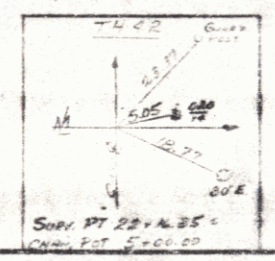

5

