

- INDEX OF SHEETS**
1. TITLE SHEET
 2. BRIDGE QUANTITY SHEET
 3. PLAN & PROFILE
 4. PLAN
 5. PLAN & PROFILE
 6. PLAN & ELEVATION
 7. ROADWAY X-SECTIONS
 8. CHANNEL X-SECTIONS

RIGHT-OF-WAY DIVISION
TOWN FILE
PERPETUAL
Town of Randolph
(To Be Returned To R.O.W. Division)

STATE OF VERMONT
AGENCY OF TRANSPORTATION



PROPOSED IMPROVEMENT
BRIDGE PROJECT

TOWN OF RANDOLPH

COUNTY OF ORANGE

ROUTE NO: T.H. 42 BRIDGE NO: 37

PROJECT LOCATION: Starting at a Point on T.H. 42 650 ft. Westward from
V. 12. and Continuing Eastward From That Point for 650 ft.
Crossing AHERS BROOK, Extending to V. 12. in direction
PROJECT DESCRIPTION: Construct 37' wide Concrete Slab
Bridge including Roadway Approach
and Channel Work.

LENGTH OF STRUCTURE:	35.	FEET
LENGTH OF PARTICIPATION ROADWAY:	612.	FEET
LENGTH OF NON-PARTICIPATION ROADWAY:	0.	FEET
LENGTH OF PROJECT:	650.	FEET
LENGTH OF PROJECT (R.O.W.):	780.	FEET

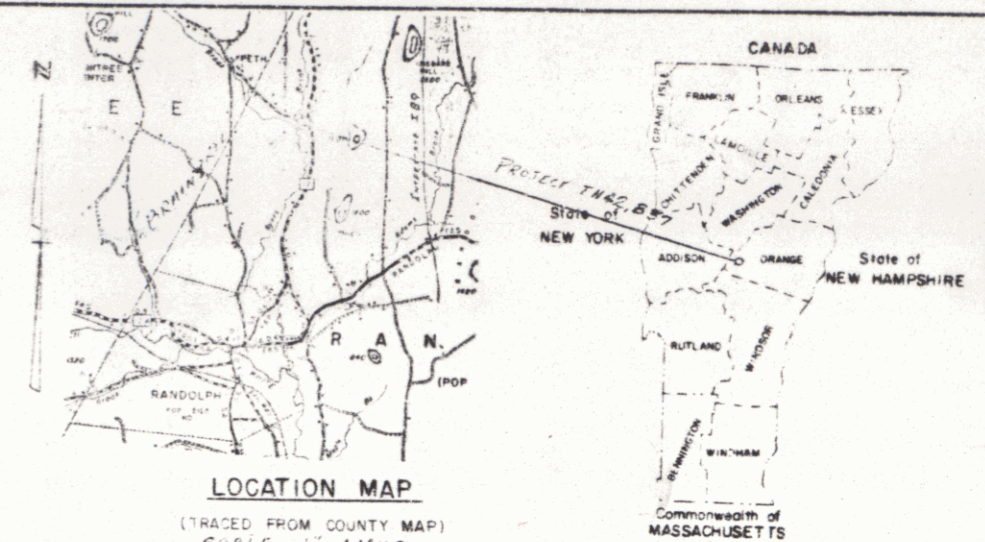

GENERAL NOTES
1. ALL SEEDING, FERTILIZING AND MULCHING SHALL BE
SUBSIDIARY TO PROJECT ITEMS.

R.O.W. PLANS

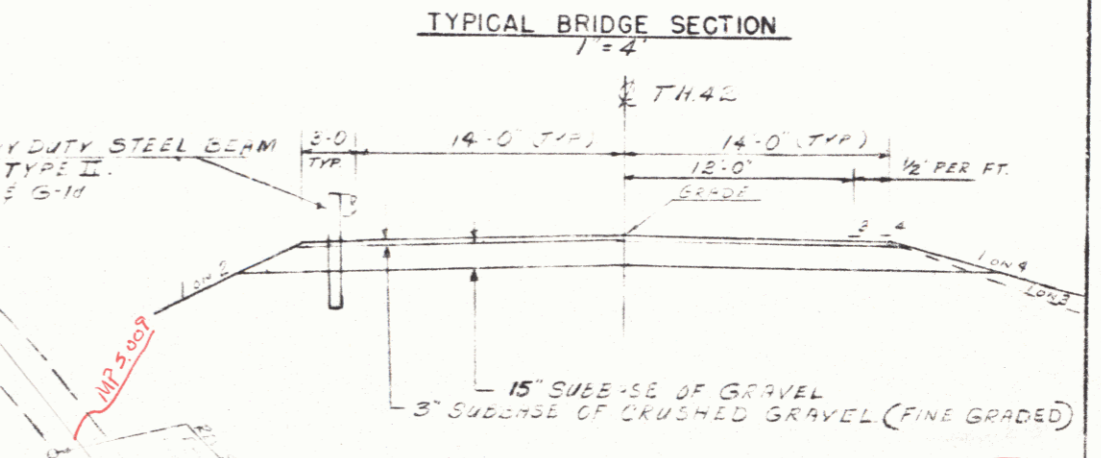
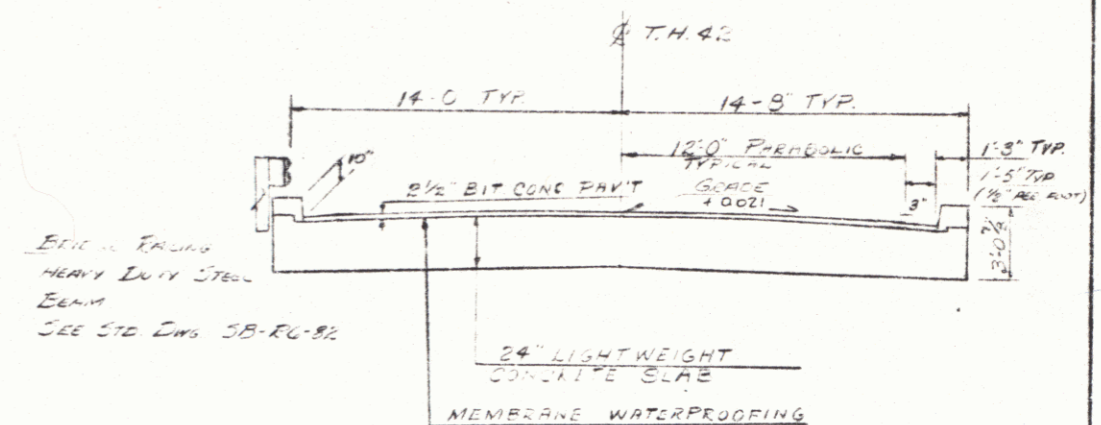
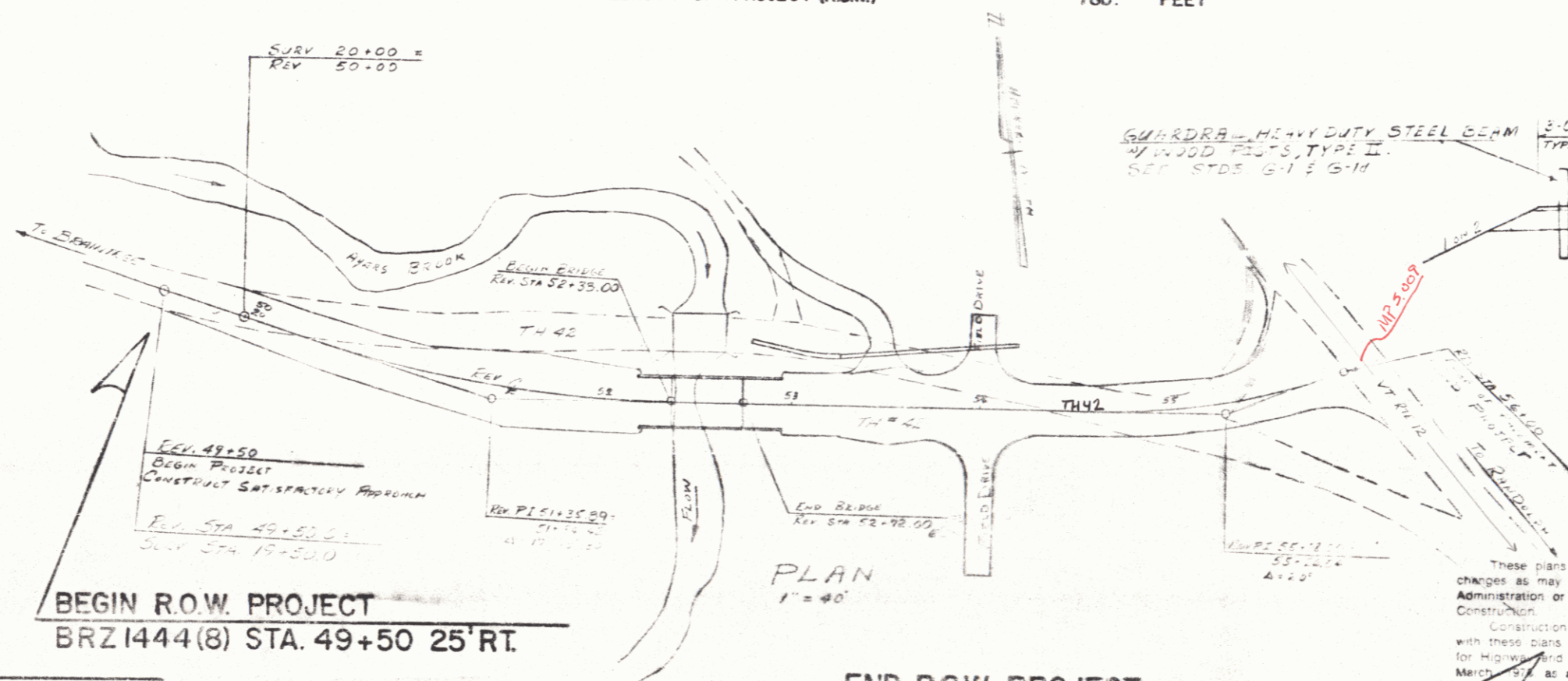

- CONVENTIONAL SIGNS**
- COUNTY LINE
 - TOWN LINE
 - LIMITS OF ACCESS
 - POINT OF ACCESS
 - FENCE LINE
 - STONE WALL
 - TRAVELED WAY
 - RAILROAD
 - SURVEY LINE
 - CULVERT
 - POWER POLE
 - TELEPHONE POLE
 - TREES
 - CONTROL OF ACCESS
 - PROPERTY LINE
 - R.O.W. TAKING LINE
 - SLOPE RIGHTS
 - TOP OF CUT
 - TOE OF SLOPE

DATE: M
VERTICAL: 1/11/87
HORIZONTAL: 1/11/87

Rte. VT 12

APPROVE: [Signature] DATE: 6-27-87
CHIEF, PROPERTY ADMINISTRATION

SUBMITTED BY ORDER OF THE STATE TRANSPORTATION BOARD
APPROVED: [Signature] DATE: 6-27-87
CHIEF, ENGINEERING AND CONSTRUCTION

Pin # 63C216

PROJECT: RANDOLPH PROJECT NO: BRZ 1444 (8)
SHEET: D OF 4

6/24/87
FEB 24 1987

These plans are subject to such engineering changes as may be required by the Federal Highway Administration or the Director of Engineering and Construction.
Construction is to be carried on in accordance with these plans and the Standard Specifications for Highway and Bridge Construction dated March 1974 as approved by the Federal Highway Administration on October 27, 1974 for use on Vermont including all subsequent revisions and supplementary specifications and special provisions as are incorporated in these plans.