

BRIDGE RAILING, H.D. STEEL BEAM, TYPE D
 T.H.57 STA. 10+35 TO STA. 10+81 AT. E. LT.

GUARD RAIL, H.D. STEEL BEAM WITH WOOD POST
TYPE II (H.S.B. STEEL) (6' POST SPACING TYPICAL)
 VT. 11 STA. 4+14 AT. TO T.H. 57 STA. 10+35 AT.
 T.H. 57 STA. 10+35 LT. TO VT. 11 STA. 5+50 AT.
 T.H. 57 STA. 10+81 TO STA. 11+08 AT. E. LT.

STONE FILL, TYPE II
 CHAN. STA. 4+72 TO 5+25 AT.

- TEMPORARY BRIDGE NOTES:
1. TEMPORARY BRIDGE IS TO BE LOCATED IN APPROPRIATE LOCATION AS PREVIOUS TEMPORARY CROSSINGS AND APPROXIMATELY AS SHOWN ON THIS DRAWING.
 2. EVERY EFFORT SHALL BE MADE TO SAVE AS MANY TREES AS POSSIBLE.
 3. FINAL LOCATION OF TEMPORARY BRIDGE, ACCESS ROAD, AND CONST. EASEMENTS SHALL MEET THE APPROVAL OF THE PROPERTY OWNER.

VT TEL. CO.
 6-57-1
 6-57-1



BEGIN R.O.W. PROJECT
BRZ 1442 (2) STA. 10+00 @

END R.O.W. PROJECT
BRZ 1442 (2) STA. 12+00 @

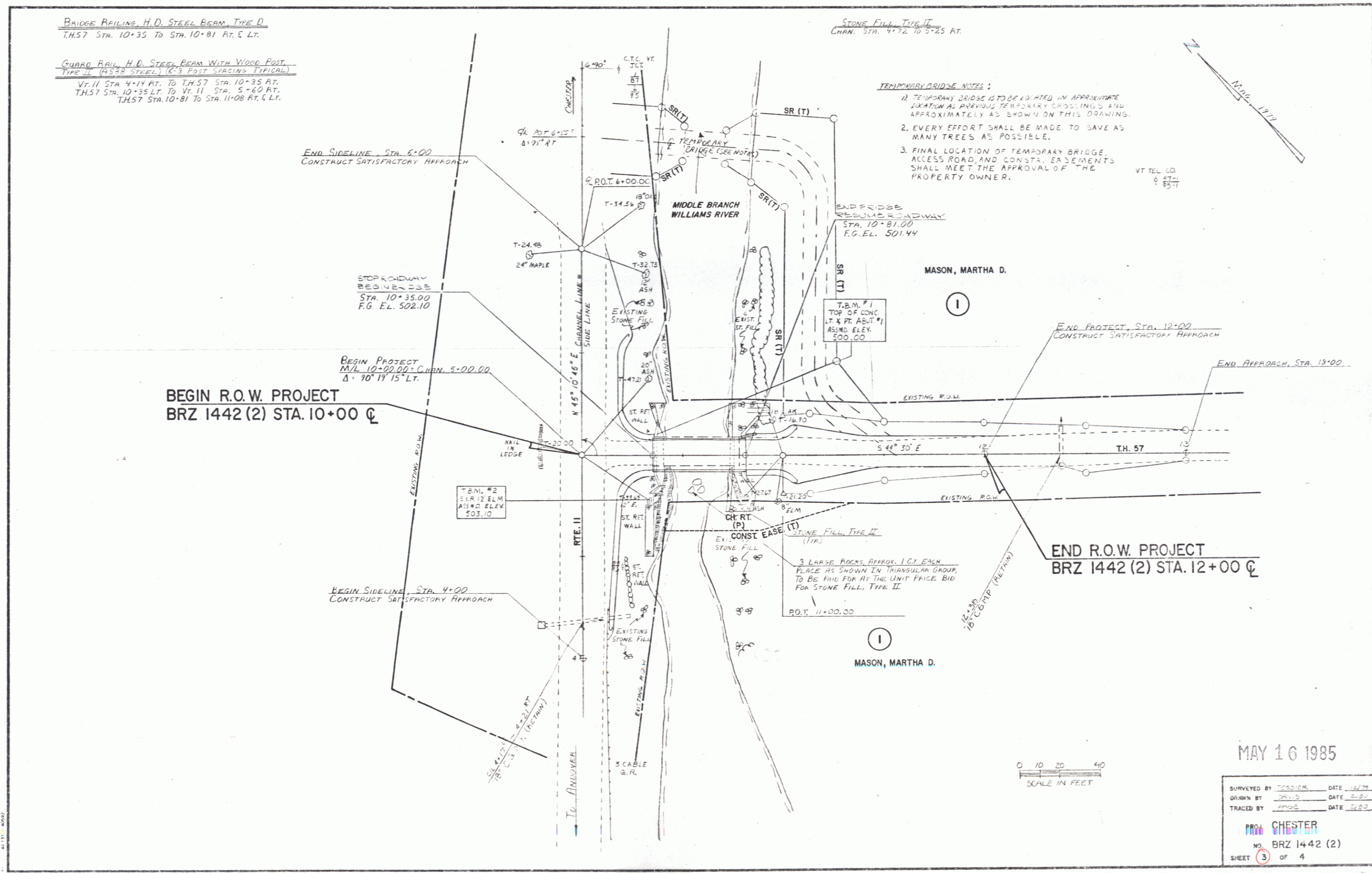

MAY 16 1985

SURVEYED BY	TRUCK	DATE	12/74
DRAWN BY	TRUCK	DATE	2/80
TRACED BY	TRUCK	DATE	2/80
PROJ. CHESTER			
NO. BRZ 1442 (2)			
SHEET	3	OF	4