

INDEX OF SHEETS

1. Title Page	
2. Typical Sheet	
3. Drainage and Quantity Sheet	
4. Blank	
5. Earthworks and Earthworks Summary	
6. Blank	
7. R.O.W. Sheet	
8. R.O.W. Sheet	
9. Blank	
10. Blank	
11. Plan	
12. Profile	
13. Plan	
14. Profile	
15. Blank	
16. 100 Series Pipe Arch at 100-52	
17. A-61 Solid Rock Excavation	4/20/75 R
18. B-5 Slope Grading	12/ 6/71 R
19. C-1 Treated Timber Curb	8/ 30/72 R
20. D-2 Cement Rubble Masonry	11/ 6/72 R
21. D-16 Precast Curb Drop Inlet	11/14/72 R
22. Blank	
23. Blank	
24. E-2 Road Construction Signs	5/14/74 R
25. E-6 Construction Signs on Project	5/14/74 R
26. E-7 Barricades	9/19/73 R
27. Blank	
28. G-4 Wood Marker Posts	5/25/74 R
29. S-6a Guard Rail, 3 Cable w/LI. Wood Posts	4/17/73 R
30. J-1 Project Markers	12/ 6/71 R
31. T-1 Temporary Erosion Control	6/14/73 R
32. Blank	
33. T-2 Temporary Erosion Control	7/ 5/72 R
34-43. Cross Sections	
44. Blank	
45. Channel Line	
46. Channel Line	
47. Channel Line	
48. Banking Diagram	

PERU FH 3-1(2)
RECORD PLANS
MATERIALS

SAND BORROW - MICHELL REALTY, LONDONDERRY, VT.
GRANULAR BORROW - FURMAN'S, PERU, VT.
SUBBASE OF GRAVEL - WHITCOMB - WALPOLE, N.H.
BIT. CONC. PAVEMENT - WHITCOMB - WALPOLE, N.H.
CONCRETE CLASS B - CHARLESTOWN READY MIX, CHARLESTOWN, N.H.
REINF. STEEL - BETHLEHEM STEEL CORP.
METAL PIPES - NORTHEASTER CULVERT CO. RE.
WESTMINSTER, VT.
GUARD RAIL ITEMS - GRISWOLD FENCE CO. INC.
ESSEX JCT. VT.
PRCG DROP INLET - HUME PIPE CO.
WINDSOR, VT.
CAST IRON FRAME & GRATE -
E. L. LE BARON FOUNDRY, BROCTON, MA.
SEED - AGWAY, SYRACUSE, N.Y.
FERTILIZER - OLD FOX CHEMICAL INC., BRANDON, VT.

STATE OF VERMONT
DEPARTMENT OF HIGHWAYS
FOREST HIGHWAY PROJECT



PROPOSED IMPROVEMENT
TOWN OF PERU
COUNTY OF BENNINGTON
FOREST HIGHWAY 3

BEGINNING AT A POINT APPROXIMATELY 1.5 MILES
WESTERLY OF THE PERU-LANDGROVE TOWN LINE AND
EXTENDING NORTHEASTERLY APPROXIMATELY 0.331 MILE
LENGTH OF ROADWAY 1750 FEET = 0.331 MILE
LENGTH OF PROJECT 1750 FEET = 0.331 MILE

1970 ADT	140
1992 ADT	250
1992 DHV	45
D	56%
T	5%
V	40 MPH

CONTRACT DATED - DEC. 26, 1974
CONTRACT STARTED - APR. 1, 1975
CONTRACT COMPLETED - ~~SEPT. 10, 1975~~
CONTRACT ACCEPTED - SEPT. 10, 1975

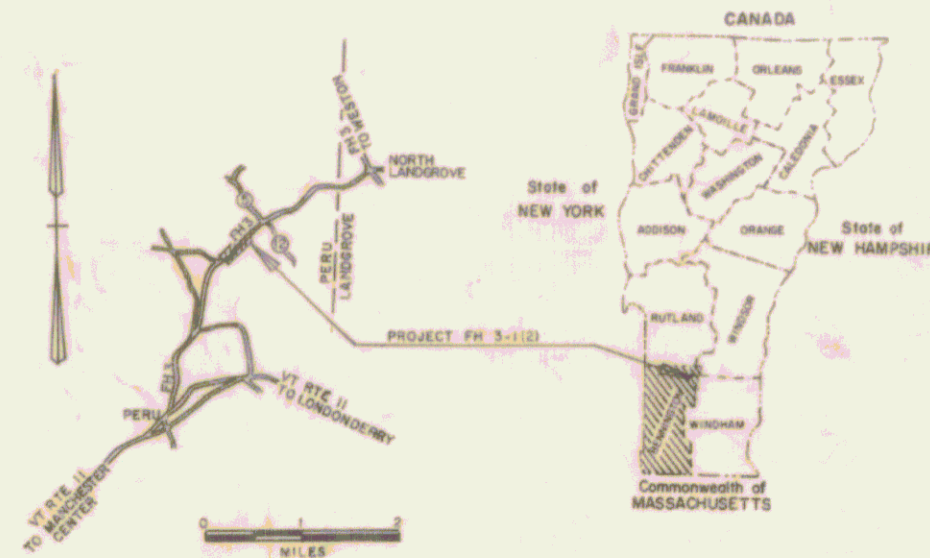

BENCH MARKS BASED ON U.S.O.S. ELEVATIONS

CONVENTIONAL SIGNS

- COUNTY LINE
- TOWN LINE
- LIMITS OF ACCESS
- POINT OF ACCESS
- FENCE LINE
- STONE WALL
- TRAVELED ROAD
- GUARD RAIL
- RAILROAD
- SURVEY LINE
- CULVERT
- POWER
- TELEPHONE
- TREES
- F & COST IDENTIFICATION SIGNS
- PROPERTY LINE
- ROW TAKING LINE
- SLOPE RIGHTS
- TOP OF CUT
- TOE OF SLOPE

CONTRACTOR - SAILOR BROS. CONSTR.
PERU, SOUTH, VT.
RESENGR. - ALBERT J. BENHART
RECORD PLANS - S.C. MERRAY
CONSTRUCTED - SEPT. 10, 1975

STA. 96+00 MP 1.746
BEGIN PROJECT FH 3-1(2)
PROJECT PERU FH 3A (1959) ENDS

STA. 115+00 MP 2.077
END PROJECT FH 3-1(2)
CONSTRUCT SATISFACTORY APPROACH

97+00 TO 118+00
CONSTRUCTION AREA

NOTE: FOR FURTHER INFORMATION CONCERNING
SPECIAL QUANTITIES, AMOUNTS OR OTHER DETAILS
RELATIVE TO THIS PROJECT MAY BE FOUND IN
EITHER THE FIELD BOOKS OR THE ESTIMATE
FILES.

These plans are subject to such revisions as may be required by the Federal Highway Administration or the Chief Engineer.
Construction is to be carried on in accordance with these plans and the Standard Specifications for Highway and Bridge Construction dated Jan 3, 1972, as approved by the Federal Highway Administration for use on this project, including all subsequent approved revisions and such revised specifications and special provisions as are incorporated in these plans.
For right-of-way details, see the right-of-way plans for this project.

SUBMITTED BY ORDER OF THE STATE HIGHWAY BOARD
APPROVED: *S.H. Stickey* DATE: 9-2-74
CHIEF ENGINEER
DEPARTMENT OF TRANSPORTATION
FEDERAL HIGHWAY ADMINISTRATION
APPROVED: _____ DATE: _____
DIVISION ENGINEER
PROJECT NO.: 13R386
SHEET 1 OF 46 SHEETS

Pin # 13R386
Route: 5A1

STATE OF VERMONT
DEPARTMENT OF HIGHWAYS
RIGHT-OF-WAY PLANS
DETAIL SHEET

TABLE OF PROJECT PROPERTY ACQUISITION

PARCEL NO	GRANTOR	SHEET NO	BEGINNING STATION	ENDING STATION	TAKING	REM	RIGHTS	TITLE TAKEN	DATE	TOWN OR CITY RECORDED	BK	PG	REMARKS
IA	DEPARTMENT OF FOREST & PARKS , DEPARTMENT OF AGRICULTURE , UNITED STATES GOVERNMENT	7,8	98+00 LT	118+00 LT	1.3430A		SLOPE (T) (0.0379A)						
			98+00 LT	99+35 LT		CHANNEL (P) (0.1200A)							
			99+80 LT	102+50 LT		METAL PIPE STRUCTURE & DITCH (P)							
			100+52 LT			SLOPE (T) (0.3692A)							
			102+50 LT	111+30 LT		CULVERT (T)							
			104+30 RT			DRIVE (T)							
			104+30 RT			CULVERT & DRAINAGE(P)							
			107+54 LT			SLOPE (T) (0.1348A)							
			112+70 LT	117+00 LT		DRAINAGE (P)							
			113+53 RT			DITCH & DRAINAGE (P)							
116+55 RT		CULVERT & DITCH (P)											
116+62 LT													
IB		7	98+00 RT	98+80 RT	0.0062A		DRIVE (T)						
			98+11 RT										
IC		7	104+90 RT	110+20 RT	0.0804A		SLOPE (T) (0.2045A)						
			105+00 RT	109+25 RT									
ID		8	115+65 RT	118+00 RT	0.0476A		SLOPE (T) (0.0764A)						
			114+35 RT	118+00 RT									

TABLE OF REVISIONS

REVISION NO	SHEET NO	DESCRIPTION OF REVISION	DATE	MADE BY	APPROVED BY

MADE BY: JLB DATE: 8-21-75
CHECKED BY: [Signature] DATE: 8/21/13

DR RT - DRAINAGE RIGHT
DT RT - DITCHING RIGHT
CH RT - CHANNEL RIGHT
DRIVE RT - DRIVE RIGHT
CUL RT - CULVERT RIGHT
D - DEMOLITION OR REMANAL
W - WATER SOURCE

----- PRESENT R.O.W.
---/--- TAKING WITHOUT ACCESS
---/--- TAKING WITHOUT ACCESS ALONG PROPERTY LINES
---/--- TAKING WITH ACCESS
[P] PERMANENT EASEMENT
[T] TEMPORARY EASEMENT

LEGEND

SR - SR SLOPE RIGHTS
P - P PROPERTY LINE
TOP OF CUT
TOP OF SLOPE

APPROVED: _____ DATE: _____
CHIEF OF PLANS & TITLES

PROJECT PERU
NO FH 3 - 1 (2)
SHEET 6 OF _____

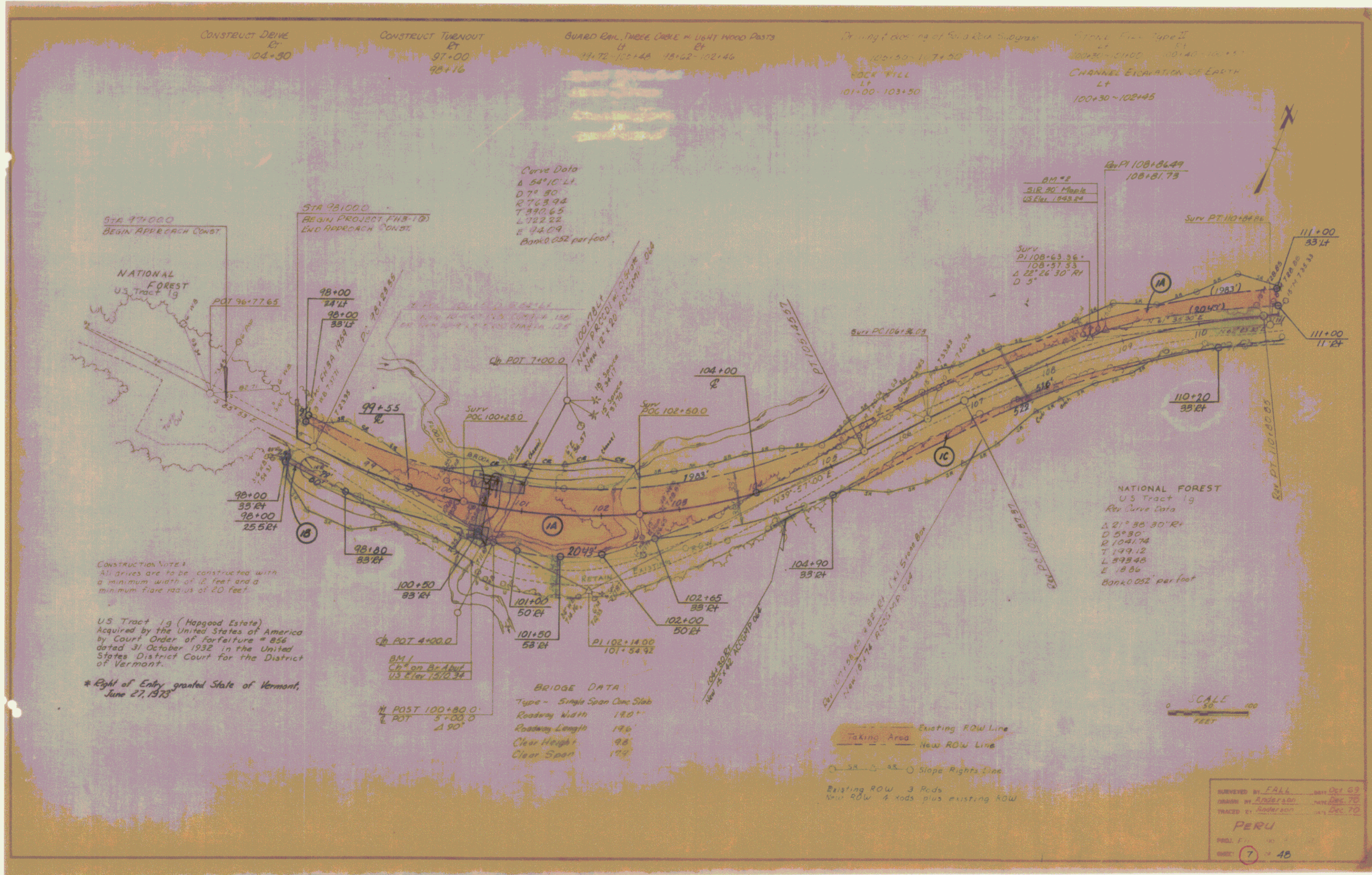

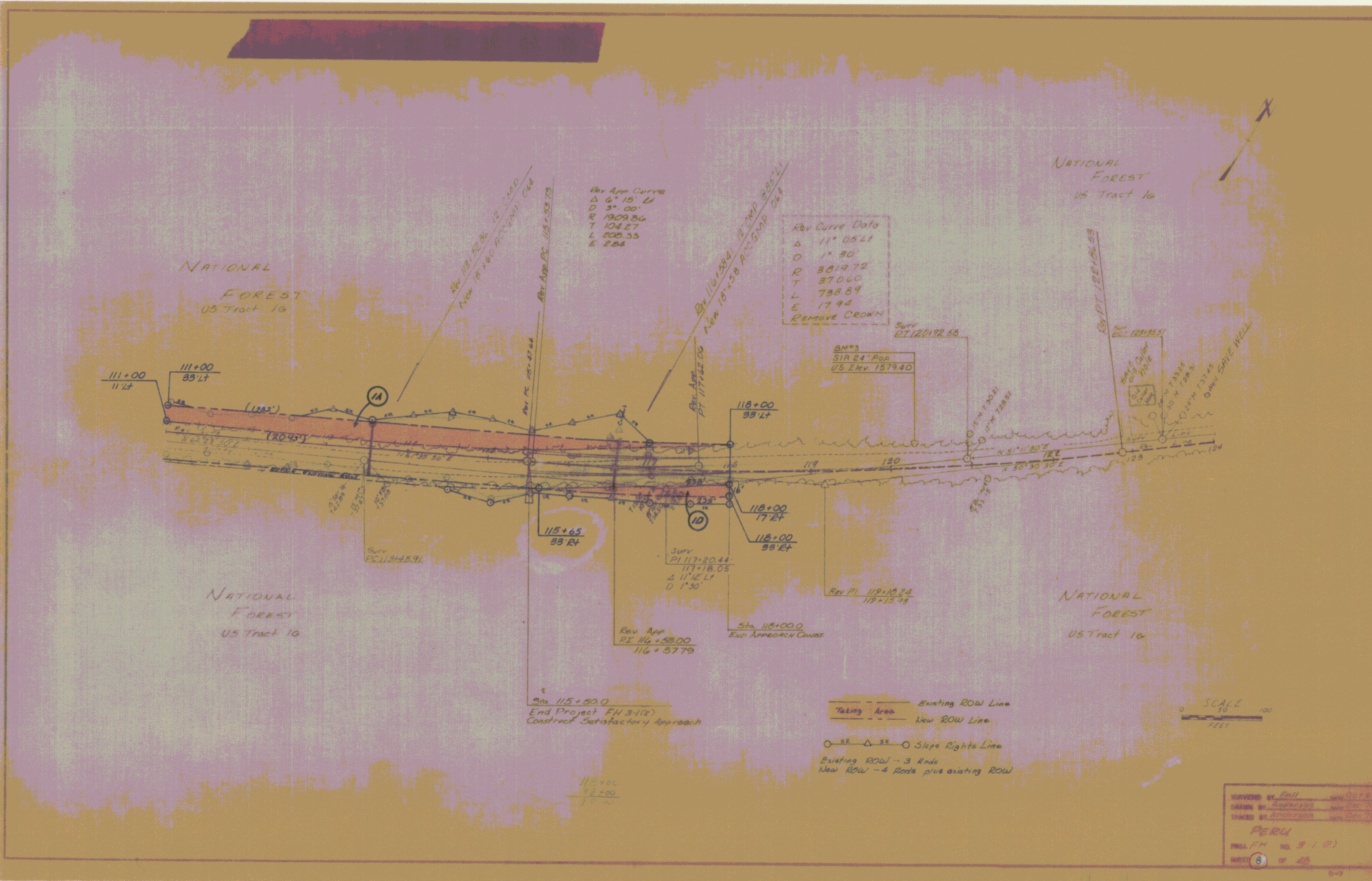

Rev App Curve
 Δ 6° 15' Lt
 D 3° 00'
 R 1909.86
 T 104.27
 L 808.33
 E 284

Rev Curve Data
 Δ 11° 05' Lt
 D 1° 30'
 R 8019.72
 T 870.60
 L 798.89
 E 17.94
 REMOVE CROWN

BM#3
 SIR 24' Pole
 US Elev. 1579.40

Sta 115+80.0
 End Project FH 3-107
 Construct Satisfactory Approach

Existing ROW Line
 New ROW Line
 Slope Rights Line
 Existing ROW - 3 Rds
 New ROW - 4 Rds plus existing ROW

SCALE
 1" = 100'
 FEET

DESIGNED BY: [Signature] DATE: OCT 69
 CHECKED BY: [Signature] DATE: DEC 70
 TRACED BY: [Signature] DATE: DEC 70
 PERU
 PROJ. FH 3-107
 SHEET 8 OF 48