

INDEX OF SHEETS

TYP	TITLE SHEET
PP1-PP6	TYPICAL SECTIONS
PP1-PP6	PLAN & PROFILE NORTH SECTION
PP7-PP11	PLAN & PROFILE SOUTH SECTION
RW1	RETAINING WALL
RW2	RETAINING WALL SECTIONS & DETAILS
RW3	TRAIL HEAD PARKING AREA RETAINING WALL
RW4	PADDOCK ROAD BRIDGE RAIL DETAIL
D1	DETAILS
D2	DETAILS
SD	TRAFFIC SIGN DETAILS
LD	LANDSCAPE DETAILS
KD	KIOSK DETAILS

TRANSVERSE POINT COORDINATES

STATION	NORTHING	EASTING
TP1	3048.0700	4080.0000
TP2	3140.8713	4092.0000
TP3	3211.4000	3953.0000
TP4	3284.8410	3740.0000
TP5	3353.1100	3611.0000
TP6	3405.0000	3500.0000
TP7	3441.2000	3394.8130
TP8	3484.0000	3294.4710
TP9	3505.0000	3190.0000
TP10	3520.0000	3084.0000
TP11	3530.0000	2978.0000
TP12	3535.0000	2872.0000
TP13	3535.0000	2766.0000
TP14	3530.0000	2660.0000
TP15	3520.0000	2554.0000
TP16	3505.0000	2448.0000
TP17	3484.0000	2342.0000
TP18	3457.0000	2236.0000
TP19	3424.0000	2130.0000
TP20	3385.0000	2024.0000
TP21	3341.0000	1918.0000
TP22	3292.0000	1812.0000
TP23	3238.0000	1706.0000
TP24	3179.0000	1600.0000
TP25	3115.0000	1494.0000
TP26	3046.0000	1388.0000
TP27	2972.0000	1282.0000

* LOCATION VERIFIED IN FIELD
MAY 13, 1999

COORDINATES ALONG PATH CENTERLINE

STATION	NORTHING	EASTING
0+000	3048.0700	4080.0000
0+200	3051.3480	3991.8713
0+400	3045.7190	3905.4424
0+600	3031.1374	3810.8583
0+800	3007.7170	3718.2897
1+000	2975.2890	3628.2876
1+200	2934.8210	3540.9499
1+400	2886.3624	3456.2818
1+600	2829.9000	3374.2900
1+800	2765.5340	3294.9600
2+000	2693.2620	3218.2900
2+200	2613.0820	3144.2800
2+400	2525.0000	3072.9410
2+600	2429.0200	3004.2710
2+800	2325.1400	2938.2800
3+000	2213.3600	2874.9600
3+200	2093.6900	2814.3100
3+400	1966.1300	2756.3300
3+600	1830.6800	2700.9400
3+800	1687.3400	2648.1600
4+000	1536.1100	2597.9900
4+200	1377.9900	2550.4400

PROPOSED IMPROVEMENT TOWN OF SPRINGFIELD COUNTY OF WINDSOR SPRINGFIELD TRANSPORTATION PATH STP BIKE(23)S

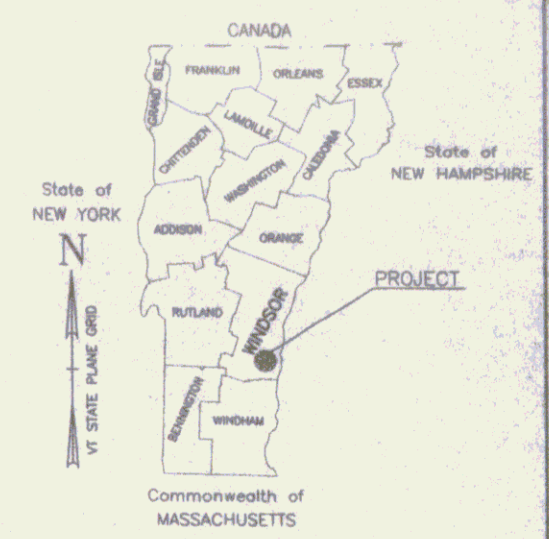

NORTH SECTION - BEGINNING AT A POINT AT THE ENTRANCE TO THE S.R.D.C. PROPERTY AND EXTENDING SOUTH ALONG THE RAILBED TO THE EAST END OF THE PADDOCK ROAD BRIDGE.
LENGTH OF NORTH SECTION 2184 METERS.

SOUTH SECTION - BEGINNING ON THE EASTERLY END OF PADDOCK ROAD AT A DISTANCE OF 130 METERS FROM THE INTERSECTION WITH ROUTE 11 AND EXTENDING SOUTH ALONG THE FORMER RAILBED, THEN CROSSING BENEATH THE ROUTE 11 BRIDGE AND EXTENDING EAST ALONG THE RAILBED, CROSSING ROUTE 5, PASSING UNDER I-91, EXTENDING ALONG THE SOUTH SIDE OF YOUNG'S ROAD TO ROUTE 11, THEN EXTENDING ALONG THE EAST SIDE OF ROUTE 11 TO THE INTERSECTION WITH ROUTE 5 NORTH.
LENGTH OF SOUTH SECTION 1787 METERS.
TOTAL LENGTH OF PROJECT 3971 METERS.

WORK TO BE DONE UNDER THIS PROJECT INCLUDES CUTTING BRUSH, LANDSCAPING, FENCING, SIGNING, REGRADING OLD RAILBED, AND CONSTRUCTION OF ASPHALT AND CONCRETE PATHS AND CONCRETE RETAINING WALLS.

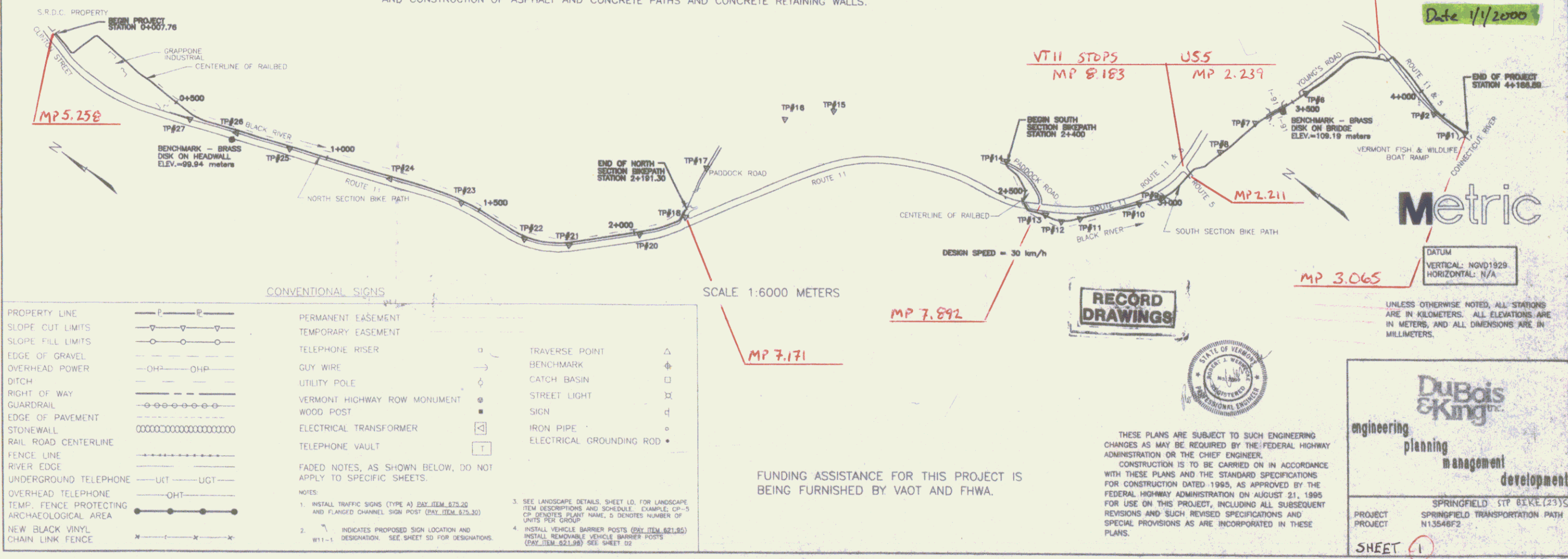

CONVENTIONAL SIGNS

PROPERTY LINE	— P —	PERMANENT EASEMENT	— P —
SLOPE CUT LIMITS	— V —	TEMPORARY EASEMENT	— T —
SLOPE FILL LIMITS	— O —	TELEPHONE RISER	□
EDGE OF GRAVEL	— G —	GUY WIRE	— G —
OVERHEAD POWER	— OHP —	UTILITY POLE	□
DITCH	— D —	VERMONT HIGHWAY ROW MONUMENT	— V —
RIGHT OF WAY	— R —	WOOD POST	□
GUARDRAIL	— GR —	ELECTRICAL TRANSFORMER	□
EDGE OF PAVEMENT	— EP —	TELEPHONE VAULT	□
RAIL ROAD CENTERLINE	— RR —	FADED NOTES, AS SHOWN BELOW, DO NOT APPLY TO SPECIFIC SHEETS.	
FENCE LINE	— F —		
RIVER EDGE	— RE —		
UNDERGROUND TELEPHONE	— UGT —		
OVERHEAD TELEPHONE	— OHT —		
TEMP. FENCE PROTECTING ARCHAEOLOGICAL AREA	— TFA —		
NEW BLACK VINYL CHAIN LINK FENCE	— NCV —		

SCALE 1:6000 METERS

DESIGN SPEED = 30 km/h

FUNDING ASSISTANCE FOR THIS PROJECT IS BEING FURNISHED BY VAOT AND FHWA.

RECORD DRAWINGS

STATE OF VERMONT
DEPARTMENT OF TRANSPORTATION
REGISTERED PROFESSIONAL ENGINEER

THESE PLANS ARE SUBJECT TO SUCH ENGINEERING CHANGES AS MAY BE REQUIRED BY THE FEDERAL HIGHWAY ADMINISTRATION OR THE CHIEF ENGINEER. CONSTRUCTION IS TO BE CARRIED ON IN ACCORDANCE WITH THESE PLANS AND THE STANDARD SPECIFICATIONS FOR CONSTRUCTION DATED 1995, AS APPROVED BY THE FEDERAL HIGHWAY ADMINISTRATION ON AUGUST 21, 1995 FOR USE ON THIS PROJECT, INCLUDING ALL SUBSEQUENT REVISIONS AND SUCH REVISED SPECIFICATIONS AND SPECIAL PROVISIONS AS ARE INCORPORATED IN THESE PLANS.

DuBois & King
INC.
engineering
planning
management
development

PROJECT: SPRINGFIELD STP BIKE(23)S
PROJECT: SPRINGFIELD TRANSPORTATION PATH N13548F2
SHEET 1