

NOTES:
 1. SEE LANDSCAPE DETAILS, SHEET LD, FOR LANDSCAPE ITEM DESCRIPTIONS AND SCHEDULE. EXAMPLE: CP-5
 CP DENOTES PLANT NAME, S DENOTES NUMBER OF UNITS PER GROUP.
 2. SEE LANDSCAPE DETAILS, SHEET LD, FOR LANDSCAPE ITEM DESCRIPTIONS AND SCHEDULE. EXAMPLE: CP-5
 CP DENOTES PLANT NAME, S DENOTES NUMBER OF UNITS PER GROUP.

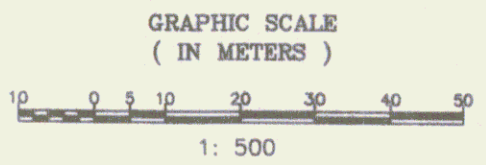

NOTE:
 V.A.O.T. R.O.W. EXTENDS TO WEST SIDE OF ROUTE 11

STA. 1+810.5 RT. 4.5m - STA. 1+881 RT. 4.5m
 CONSTRUCT 70.5m ± 300mm CPEP (SL)
 INV. IN (W) = 96.72
 INV. OUT (S) = 95.74
 PAY ITEM 801-2008 NOT IN CONTRACT
 CONSTRUCT 300mm CPEP AT EACH END
 PAY ITEM 801-2005 NOT IN CONTRACT

Metric

DATUM
 VERTICAL: NVD1929
 HORIZONTAL: N/A

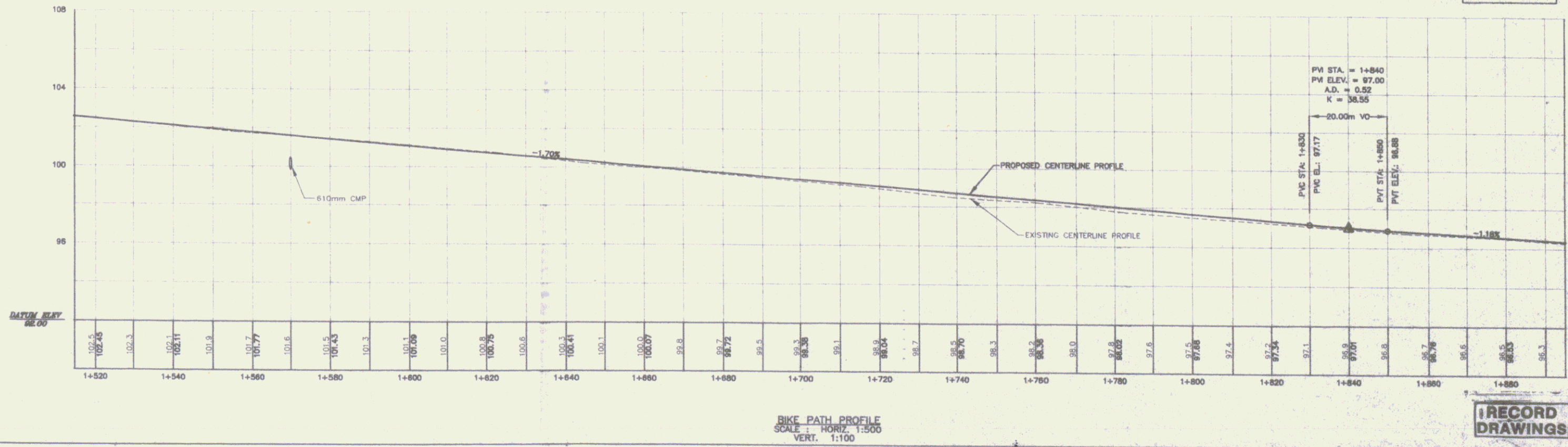

BIKE PATH PROFILE
 SCALE: HORIZ. 1:500
 VERT. 1:100

RECORD DRAWINGS

SHEET 7

10/1/2010
 10/1/2010
 10/1/2010
 10/1/2010

REV.	DATE	BY	DESCRIPTION
3	11/08		REVISED PER REVIEW COMMENTS
2	8/08		REVISED PER REVIEW COMMENTS
1	5/08		REVISED PER REVIEW COMMENTS

SPRINGFIELD TRANSPORTATION PATH
 PHASE 1
 TOWN OF SPRINGFIELD
 SPRINGFIELD, VERMONT
 PLAN AND PROFILE

METRIC
 PP5