

STATE OF VERMONT AGENCY OF TRANSPORTATION



PROPOSED IMPROVEMENT TOWNS OF MORETOWN-MIDDLESEX

COUNTY OF WASHINGTON

VT. ROUTE 100B (F.A.S.)

END R.O.W. PROJECT
BRS 0167(II) STA. U.S. 2 8+50 25' LT.

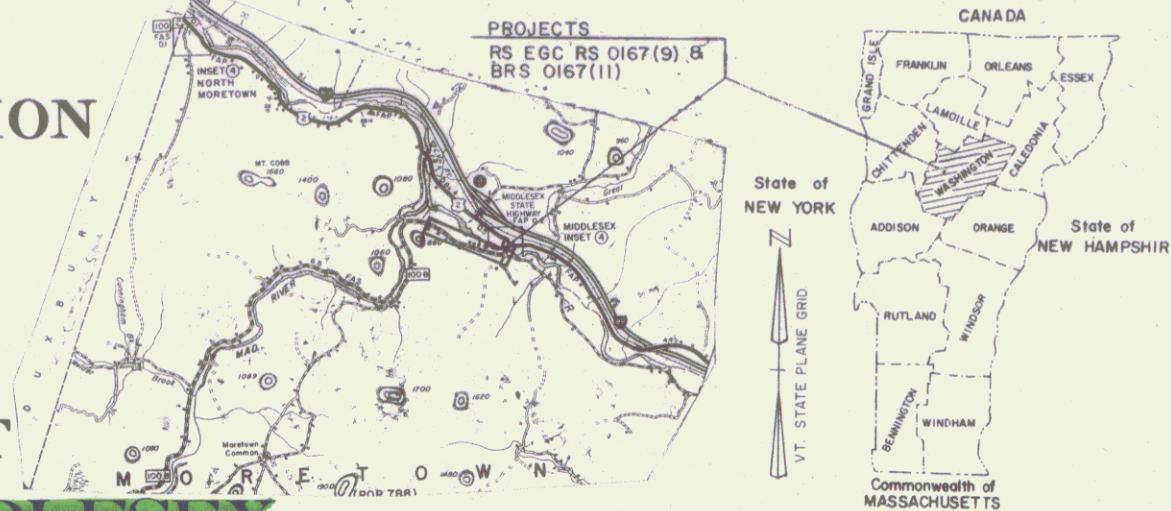

R.O.W. PLANS

PROJECT MORETOWN RS EGC RS 0167(9)

BEGINNING AT A POINT, ON VT. 100B, 0.804 MILES WESTERLY OF THE PRESENT MORETOWN-MIDDLESEX TOWN LINE AND EXTENDING EASTERLY 0.849 MILES.

LENGTH OF ROADWAY 4490.08 FEET = 0.851 MILES
LENGTH OF PROJECT 4490.08 FEET = 0.851 MILES

PROJECT CONSISTS OF RECONSTRUCTING VT. 100B ON MINOR RELOCATION WITH NECESSARY APPROACHES AND CONNECTING WITH PROJECT MORETOWN-MIDDLESEX BRS 0167(II).

PROJECT MORETOWN - MIDDLESEX BRS 0167(II)

BEGINNING AT A POINT 91 FEET WESTERLY OF THE PRESENT MORETOWN-MIDDLESEX TOWN LINE AND EXTENDING EASTERLY 0.120 MILES.

LENGTH OF ROADWAY 358.85 FEET = 0.068 MILES
LENGTH OF BRIDGE 265.50 FEET = 0.050 MILES
LENGTH OF PROJECT 624.35 FEET = 0.118 MILES
LENGTH OF R.O.W. PROJECT 898.00 FEET = 0.170 MILES

PROJECT CONSISTS OF REPLACING THE EXISTING STEEL TRUSS BRIDGE OVER THE WINOOSKI RIVER ON NEW ALIGNMENT WITH NECESSARY ROADWAY APPROACH CREATING A NEW INTERSECTION WITH U.S. ROUTE 2.

BEGIN R.O.W. PROJECT
BRS 0167(II) REV. STA. 211+56 60' LT.

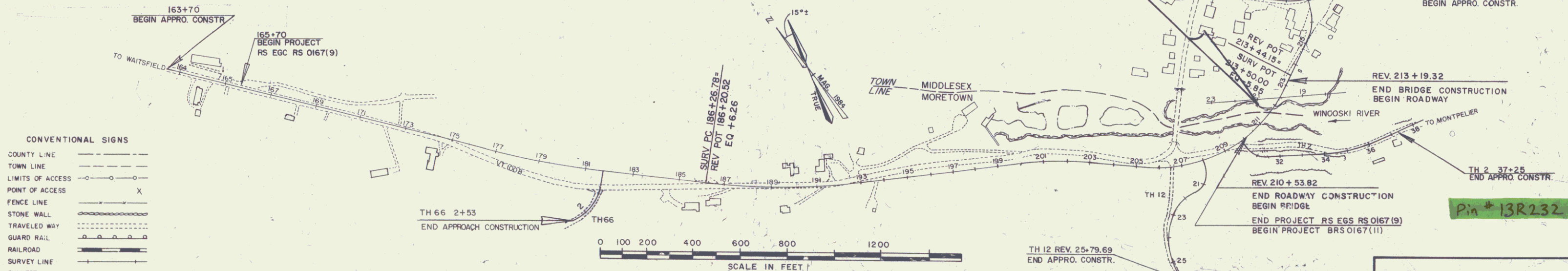

CONVENTIONAL SIGNS

| | |
|-------------------|---------|
| COUNTY LINE | --- |
| TOWN LINE | - - - - |
| LIMITS OF ACCESS | —○— |
| POINT OF ACCESS | X |
| FENCE LINE | —x—x— |
| STONE WALL | —x—x—x— |
| TRAVELED WAY | —x—x—x— |
| GUARD RAIL | —x—x—x— |
| RAILROAD | —x—x—x— |
| SURVEY LINE | —x—x—x— |
| CULVERT | —x—x—x— |
| POWER POLE | —x—x—x— |
| TELEPHONE POLE | —x—x—x— |
| TREES | —x—x—x— |
| CONTROL OF ACCESS | —x—x—x— |
| PROPERTY LINE | —x—x—x— |
| R.O.W TAKING LINE | —x—x—x— |
| SLOPE RIGHTS | —x—x—x— |
| TOP OF CUT | —x—x—x— |
| TOE OF SLOPE | —x—x—x— |

DATUM

| | |
|------------|-----------|
| VERTICAL | NGVD 1929 |
| HORIZONTAL | N/A |

ALL DRIVES AS INDICATED ON PLANS ARE SUBJECT TO PERMITS PURSUANT TO TITLE 19 SECTION III, V.S.A.

THESE PLANS ARE SUBJECT TO SUCH ENGINEERING CHANGES AS MAY BE REQUIRED BY THE FEDERAL HIGHWAY ADMINISTRATION OR THE CHIEF ENGINEER. CONSTRUCTION IS TO BE CARRIED OUT IN ACCORDANCE WITH THESE PLANS AND THE STANDARD SPECIFICATIONS FOR CONSTRUCTION DATED 1980, AS APPROVED BY THE FEDERAL HIGHWAY ADMINISTRATION ON MARCH 1981. FOR USE ON THIS PROJECT INCLUDING ALL SUBSEQUENT REVISIONS AND SUCH REVISED SPECIFICATIONS AND SPECIAL PROVISIONS AS ARE INCORPORATED IN THESE PLANS.

APPROVED: *[Signature]* DATE: 7/1/12
Director of Engineering

APPROVED: *[Signature]* DATE: 7/1/12
Chief, Right of Way

MORETOWN-MIDDLESEX
BRS 0167(II)
R.O.W. SHEET 1 OF 11 SHEETS

MAR 23 2006