

STATE OF VERMONT
AGENCY OF TRANSPORTATION



PROPOSED IMPROVEMENT
TOWN OF BRATTLEBORO
COUNTY OF WINDHAM

R.O.W. PLANS

**U.S. ROUTE 5 & VT. ROUTE 9 & BRATTLEBORO STATE HIGHWAY
(MINOR & PRINCIPAL ARTERIALS)**

BEGINNING ON U.S. ROUTE 5 APPROXIMATELY 1.483 KM SOUTH OF THE BRATTLEBORO/DUMMERSTON TOWN LINE AND EXTENDING NORTHERLY THROUGH THE U.S. RTE. 5 / VT. RTE 9 / BRATTLEBORO STATE HIGHWAY INTERSECTION FOR 144.38 M.

LENGTH OF ROADWAY = 144.38 M = 0.144 KM

LENGTH OF PROJECT = 144.38 M = 0.144 KM

WORK TO BE PERFORMED UNDER THIS PROJECT INCLUDES THE RECONSTRUCTION OF THE U.S.-5, VT.-9, BRATTLEBORO STATE HIGHWAY INTERSECTION WITH NEW PAVEMENT, SUBBASE, DRAINAGE, CURB, AND SIDEWALK
LENGTH OF R.O.W. PROJECT = 168.9 M = 0.169 KM
(554.1') 0.10 MILES

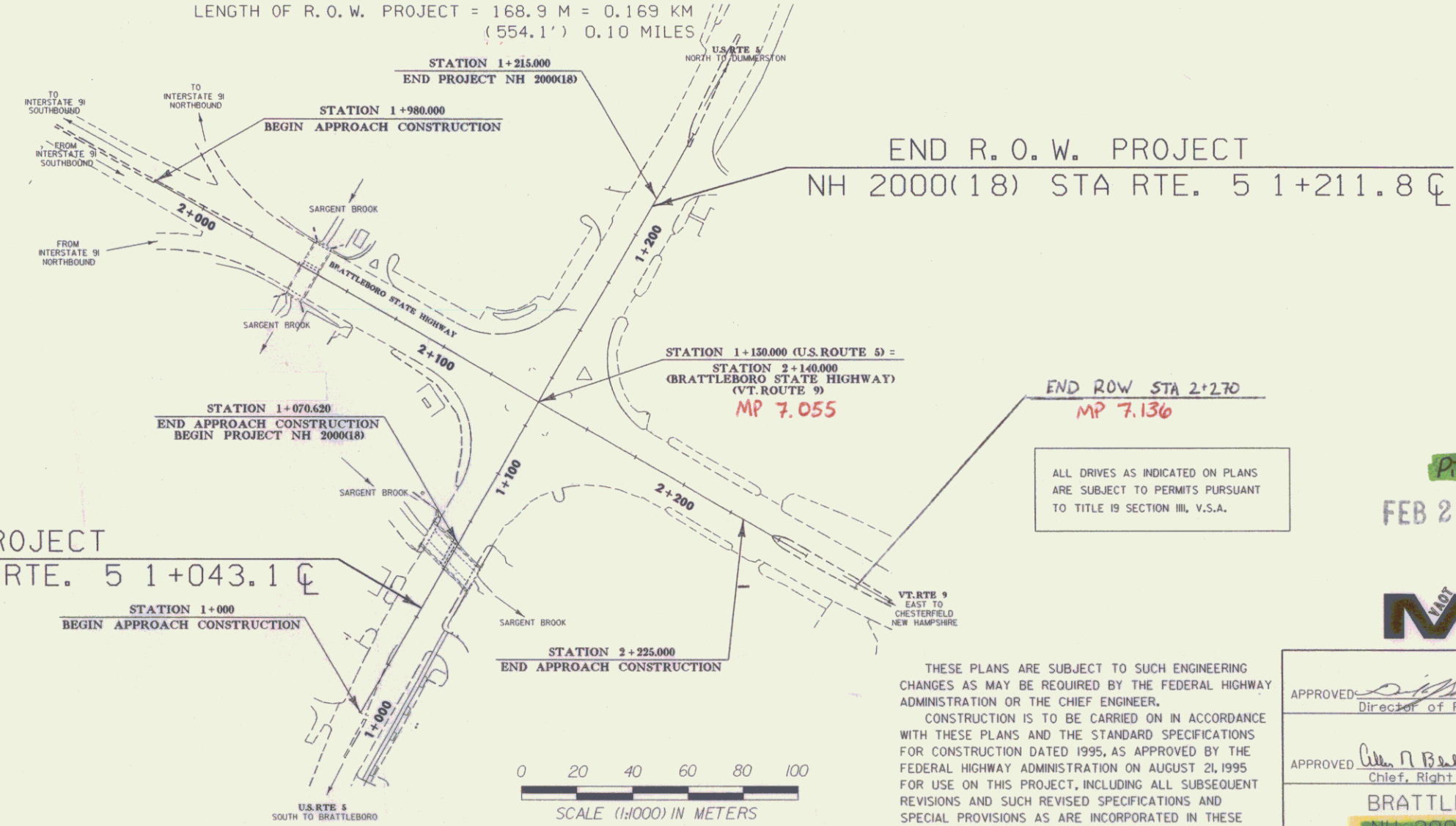
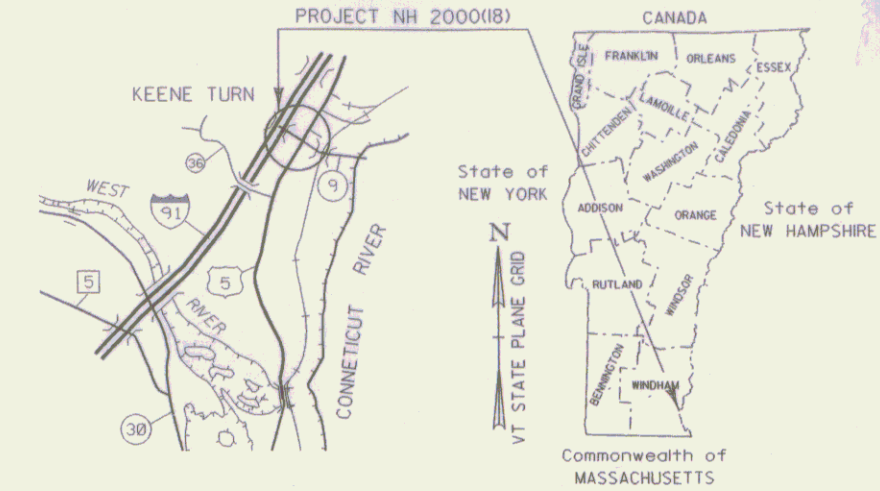

CONVENTIONAL SIGNS

COUNTY LINE	---
TOWN LINE	---
LIMITS OF ACCESS	---o---
POINT OF ACCESS	---X---
FENCE LINE	---x---
STONE WALL	---o---o---
TRAVELED WAY	---o---o---
GUARD RAIL	---o---o---
RAILROAD	---o---o---
SURVEY LINE	---o---o---
CULVERT	---o---o---
POWER POLE	---o---o---
TELEPHONE POLE	---o---o---
TREES	---o---o---
CONTROL OF ACCESS	---o---o---
PROPERTY LINE	---o---o---
R.O.W. TAKING LINE	---o---o---
SLOPE RIGHTS	---o---o---
TOP OF CUT	---o---o---
TOE OF SLOPE	---o---o---

DATUM

VERTICAL	NAVD88
HORIZONTAL	NAD83(92)

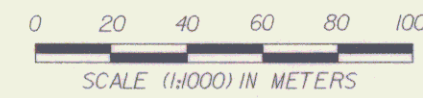

THESE PLANS ARE SUBJECT TO SUCH ENGINEERING CHANGES AS MAY BE REQUIRED BY THE FEDERAL HIGHWAY ADMINISTRATION OR THE CHIEF ENGINEER.
CONSTRUCTION IS TO BE CARRIED ON IN ACCORDANCE WITH THESE PLANS AND THE STANDARD SPECIFICATIONS FOR CONSTRUCTION DATED 1995, AS APPROVED BY THE FEDERAL HIGHWAY ADMINISTRATION ON AUGUST 21, 1995 FOR USE ON THIS PROJECT, INCLUDING ALL SUBSEQUENT REVISIONS AND SUCH REVISED SPECIFICATIONS AND SPECIAL PROVISIONS AS ARE INCORPORATED IN THESE PLANS.

ALL DRIVES AS INDICATED ON PLANS ARE SUBJECT TO PERMITS PURSUANT TO TITLE 19 SECTION III, V.S.A.

Pin # 13R230
FEB 21 2001



APPROVED	<i>[Signature]</i>	DATE	10/14/97
	Director of Project Development		
APPROVED	<i>[Signature]</i>	DATE	10/15/97
	Chief, Right of Way		
BRATTLEBORO			
NH 2000(18)			
R.O.W. SHEET 1 OF 14 SHEETS			

TYPICAL SECTIONS

(ALL DRAWINGS NOT TO SCALE)

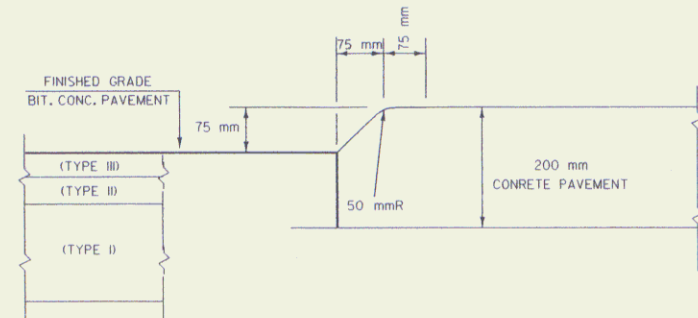

DETAIL "B"

MATERIAL	ALL LANE AND CIRCULATING ROADWAY
BITUMINOUS CONCRETE PAVEMENT (TYPE III)	50 mm
BITUMINOUS CONCRETE PAVEMENT (TYPE II)	75 mm
BITUMINOUS CONCRETE PAVEMENT (TYPE I)	150 mm
SUBBASE-CRUSHED GRAVEL (COARSE GRADED)	600 mm
SAND BORROW	250 mm

THICKNESS TOLERANCES

PAVEMENT (TOTAL DEPTH) = 5 mm
 SUBBASE = 30 mm
 SAND BORROW = 30 mm

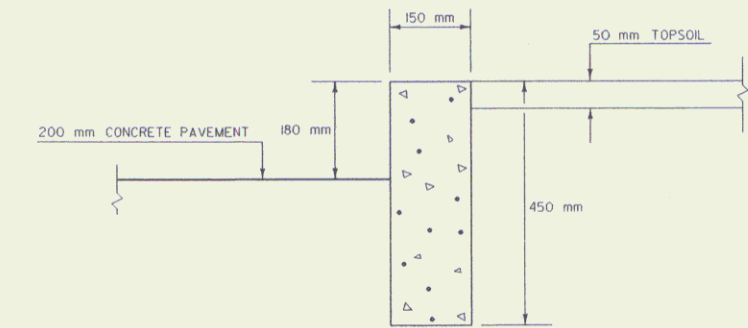

DETAIL "A"
 VERTICAL GRANITE CURB

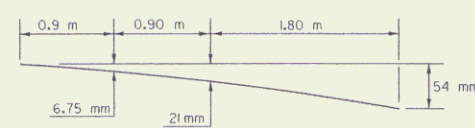

MODIFIED PARABOLIC DETAIL

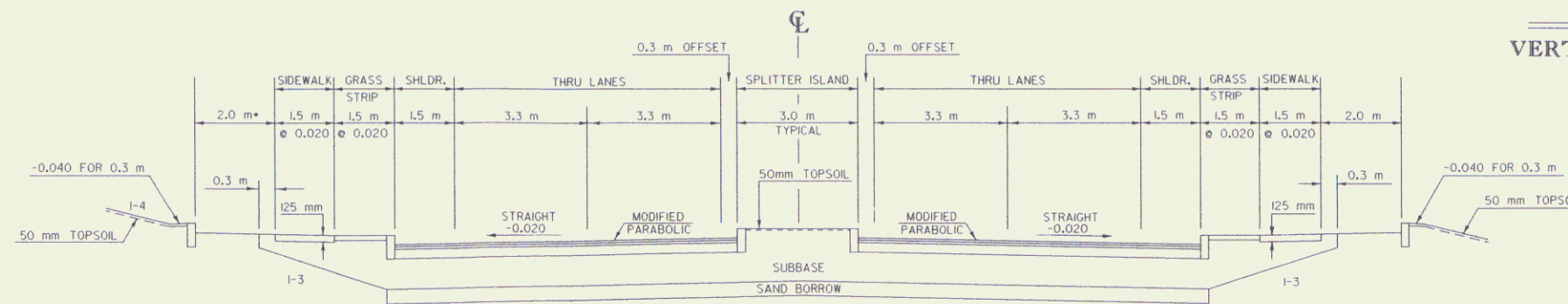

*1.4 m U.S. 5 LT ~ B.S.H. RT

FOUR LANE SECTION WITH SIDEWALK

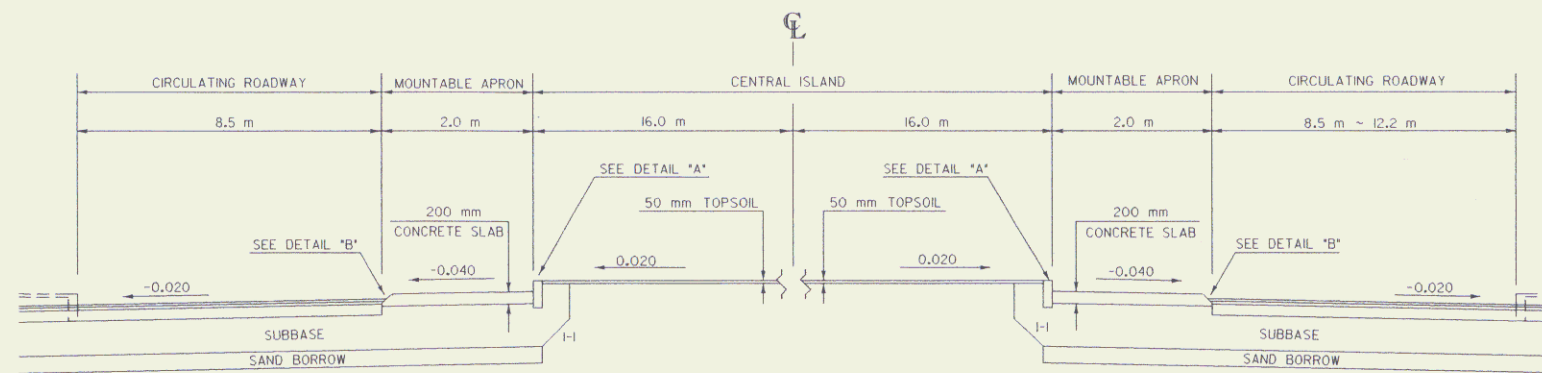

CIRCULATING ROADWAY SECTION

SEEDING FORMULA URBAN AREAS

% WT.	kg/ha	NAME	PUR %	GERM %
42.5	38.0	CREeping RED FESCUE	98	85
10.0	9.0	PERENNIAL RYE GRASS	95	90
42.5	38.0	KENTUCKY BLUE GRASS	85	85
5.0	5.0	ANNUAL RYE GRASS	95	85
100.0	90.0			

GENERAL NOTES

- SEED MIXTURE: SHALL NOT HAVE A WEED CONTENT EXCEEDING 0.40% BY WEIGHT AND SHALL BE FREE OF ALL NOXIOUS SEED.
- SEED: TO BE APPLIED PER SEEDING FORMULAS OR AS DIRECTED BY THE ENGINEER.
- FERTILIZER FORMULA 10-20-10, TO BE USED WITH SEED, APPLIED AT THE RATE OF 560 kg/ha. (HYDRO SEEDERS MAY USE 19-19-19 FORMULA).
- AGRICULTURAL LIMESTONE: TO BE APPLIED AT THE RATE OF 4500 kg/ha, OR AS DIRECTED BY THE ENGINEER.
- HAY MULCH: TO BE PLACED ON EARTH SLOPES AT THE RATE OF 4500 kg/ha, OR AS DIRECTED BY THE ENGINEER.
- TOPSOIL: TO BE USED WITH SEED AS INDICATED ON THE PLANS, OR AS DIRECTED BY THE ENGINEER.
- MARKER POSTS: TO BE PLACED AS INDICATED OR AS DIRECTED BY THE ENGINEER.
- SLOPE ROUNDING: ALL CUT SLOPES TO BE ROUNDED IN ACCORDANCE WITH STANDARD SHEET B-5.
- PAY LIMITS OF SAND BORROW: WHEN USED IN CONJUNCTION WITH UNDERDRAIN - SEE STANDARD SHEET D-2.
- TACK COAT: EMULSIFIED ASPHALT IS TO BE APPLIED AT THE RATE OF 0.0679 L/m² BETWEEN SUCCESSIVE COURSES OF PAVEMENT AS DIRECTED BY THE ENGINEER.

DATUM

VERTICAL	NAVD88
HORIZONTAL	NAD83(92)

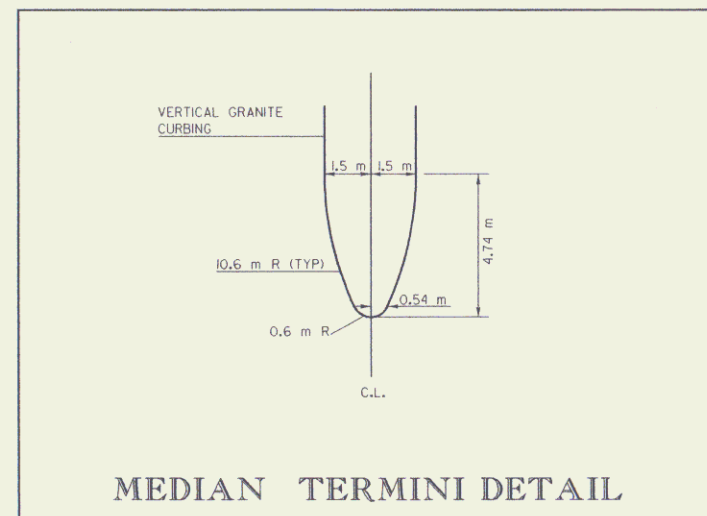

MEDIAN TERMINI DETAIL

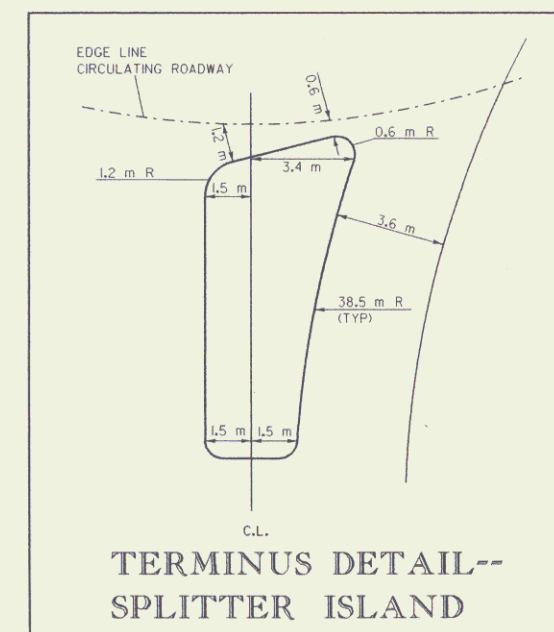

TERMINUS DETAIL-- SPLITTER ISLAND

FEB 21 2001

PROJECT:	BRATTLEBORO	PROJECT NO.:	NH 2000(18)
DESIGN FILE NAME:	sado/93d91/dd91xsl.dgn	PLOT DATE:	30-SEP-1997
IPARM FILE NAME:	dd91ttyp.l	SURVEY DATE:	10/95
SURVEYED BY:	R. GILMAN	DRAWN BY:	K. UPMAL
SOUND LEADER:	S. MENARD		
	R. O. W. SHEET 2 OF 14		SHEETS

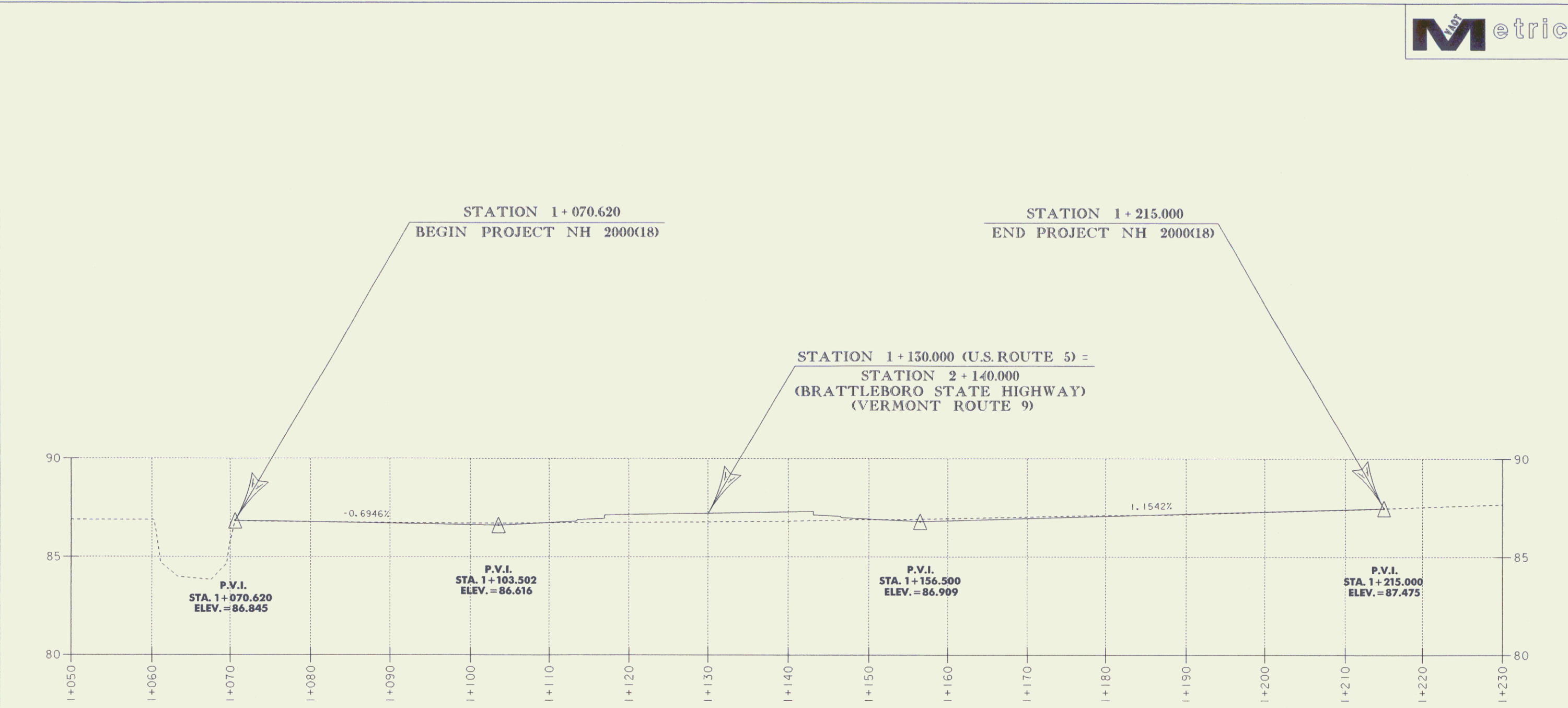

Profile

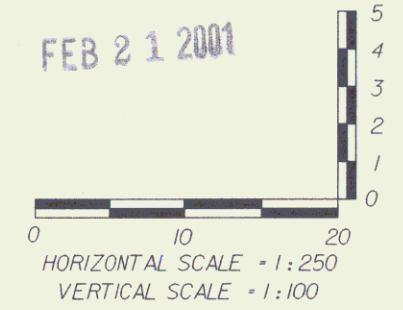

DATUM
 VERTICAL NAVD88
 HORIZONTAL NAD83(92)

U.S. ROUTE 5

PROJECT:	BRATTLEBORO	PROJECT NO.:	NH 2000(18)
DESIGN FILE NAME:	sgdc/93d91/dd91xs.dgn	PLOT DATE:	30-SEP-1997
IPARM FILE NAME:	dd91p1	SURVEY DATE:	10/95
SURVEYED BY:	R. GILMAN	DRAWN BY:	K. UPMAL
SQUAD LEADER:	S. MENARD		
R. O. W. SHEET 3 OF 14 SHEETS			

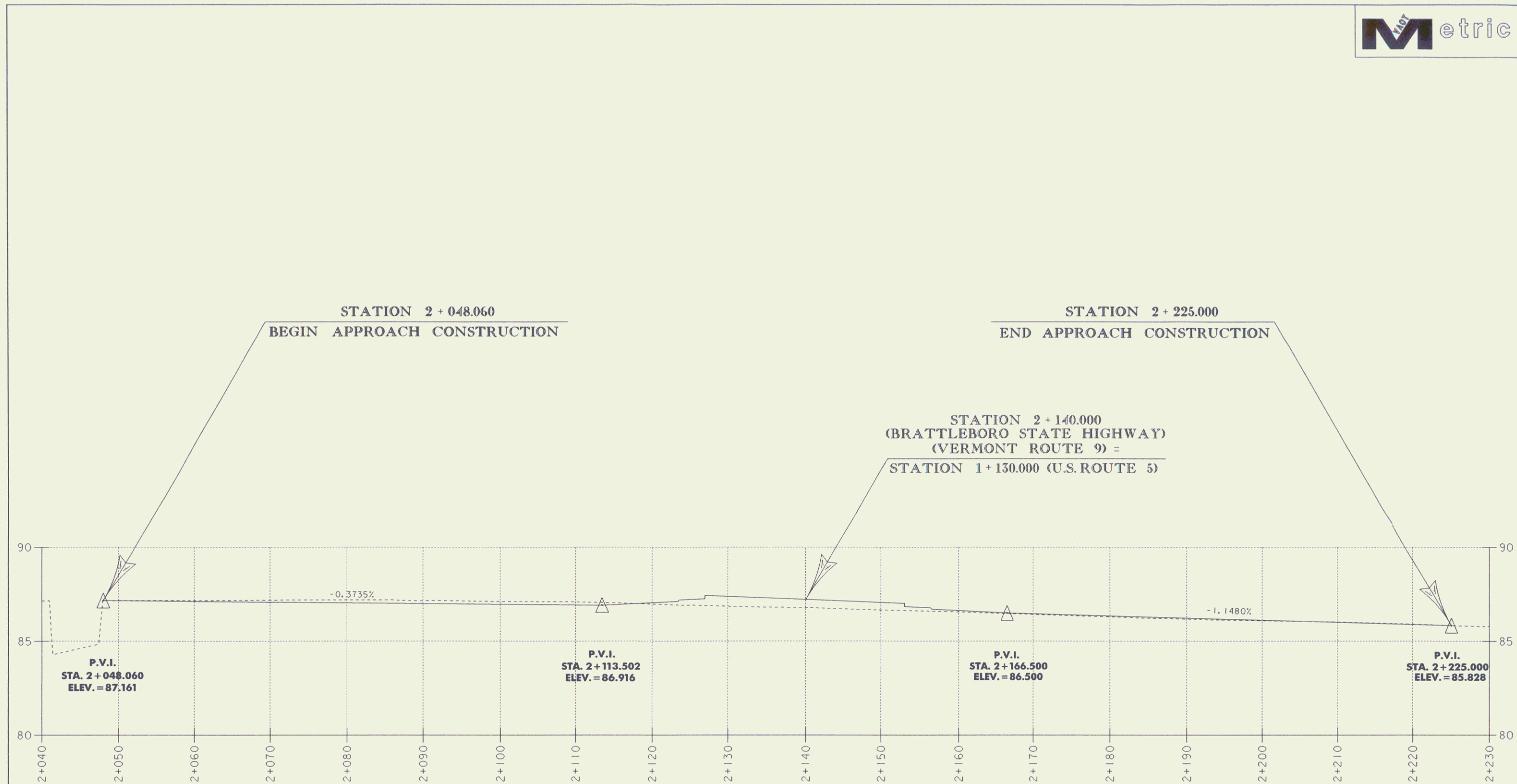

Profile

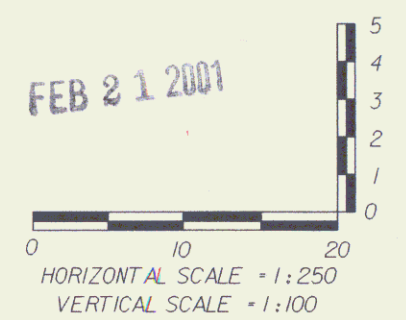

VT. ROUTE 9 -
BRATTLEBORO STATE HIGHWAY

DATUM
VERTICAL NAVD88
HORIZONTAL NAD83(92)

PROJECT:	BRATTLEBORO	PROJECT NO.:	NH 2000(18)
DESIGN FILE NAME:	sadd/93d191/dd191xs.dgn	PLOT DATE:	30-SEP-1997
IPARM FILE NAME:	dd191p21	SURVEY DATE:	10/95
SURVEYED BY:	R. GILMAN	DRAWN BY:	K. UPMAL
SQUAD LEADER:	S. MENARD		
R. O. W. SHEET 4 OF 14 SHEETS			

VT STATE PLANE GRID

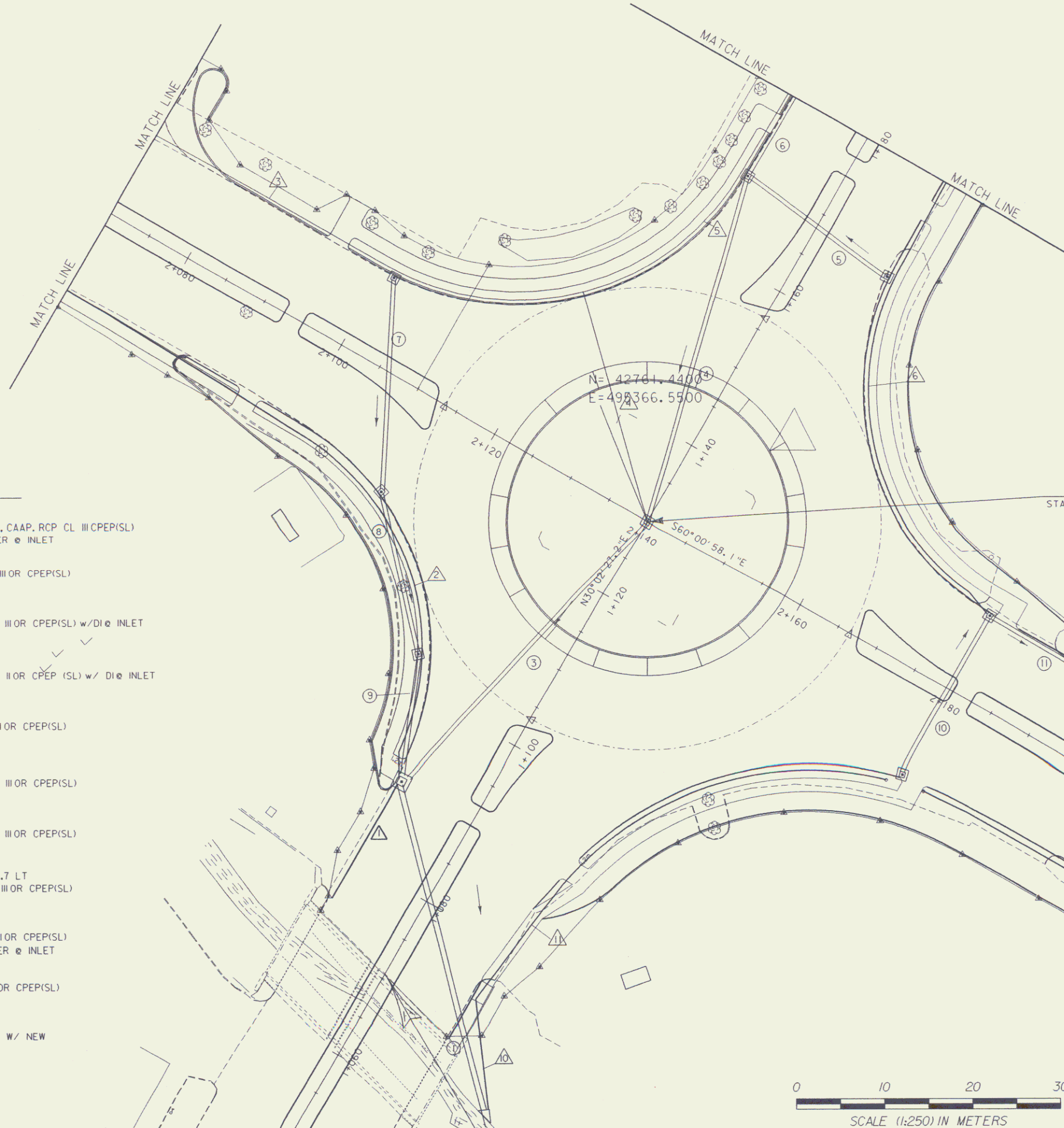

- NEW DRAINAGE**
- ① I+062.70 RT ~ I+091.35 LT
NEW 600 mm X 38 m PCCPSP, CAAP, RCP CL III CPEPISL)
NEW 1.2 X 1.2 M.H. w/ C.I. COVER @ INLET
 - ② I+090 LT ~ I+091.66 LT
NEW 450 mm X 5 m RCP CL III OR CPEPISL)
NEW 1.2 X 1.2 RCDI @ INLET
 - ③ I+092.27 LT ~ I+124.00 C.L.
NEW 450 mm X 37 m RCP CL III OR CPEPISL) w/ DI @ INLET
NEW 1.2 X 1.2 RCDI @ INLET
 - ④ I+130.7 C.L. ~ I+169.00 LT
NEW 450 mm X 39 m RCP CL II OR CPEPISL) w/ DI @ INLET
NEW 1.2 X 1.2 RCDI @ INLET
 - ⑤ I+167.57 RT ~ I+169.47 LT
NEW 450mm X 18 m RCP CL III OR CPEPISL)
NEW 1.2 X 1.2 RCDI @ INLET
 - ⑥ I+169.76 LT ~ I+238.71 LT
NEW 450 mm X 69 m RCP CL III OR CPEPISL)
NEW 1.2 X 1.2 RCDI @ INLET
 - ⑦ 2+101.50 LT ~ 2+111.9 RT
NEW 450 mm X 24 m RCP CL III OR CPEPISL)
NEW 1.2 X 1.2 RCDI @ INLET
 - ⑧ VT 9 2+112.0 LT ~ US 5 I+103.7 LT
NEW 450 mm X 19 m RCP CL III OR CPEPISL)
NEW 1.2 X 1.2 RCDI @ INLET
 - ⑨ I+090.4 LT ~ I+103.4 LT
NEW 450 mm X 15m RCP CL III OR CPEPISL)
NEW 1.2 X 1.2 RCDI w/ C.I. COVER @ INLET
 - ⑩ 2+179.35 LT ~ RT
NEW 450 mm X 20 m RCP III OR CPEPISL)
NEW 1.2 X 1.2 RCDI @ INLET
 - ⑪ 2+179.35 LT ~ 2+191.0 LT
EXTEND EXISTING 450 mm RCP W/ NEW
450 mm X 5 m RCP CL III

- UNDERDRAIN**
- ① U.S. 5 I+075 LT ~ I+089.8 LT
NEW 150 mm X 15 m F.B. @ I+075 LT
 - ② B.S.H. 2+055.0 RT ~ U.S. 5 I+090.5 LT
NEW 150 mm X 33 m--F.B. @ 2+055.0 RT
 - ③ B.S.H. 2+052.0 LT ~ 2+120.8 LT
NEW 150 mm X 69 m U/D F.B. @ 2+052 LT
 - ④ B.S.H. 2+120.8 LT ~ 2+140.0 LT
NEW 150 mm X 27 m CARRIER
 - ⑤ U.S. 5 I+148.9 LT ~ I+215.0 LT
NEW 150 mm X 113m U/D
 - ⑥ VT. RTE. 9 2+178.9 LT ~ U.S. 5 I+215.0 RT
NEW 150 mm X 90 m U/D
 - ⑦ VT. RTE. 9 2+192.0 LT ~ 2+225.0 LT
NEW 150 mm X 33m U/D F.B. @ 2+192.0 LT
 - ⑧ VT. RTE. 9
NEW 150 mm X 20 m CARRIER
 - ⑨ VT. RTE. 9 2+183.0 RT ~ 2+243.0 RT
NEW 150 mm X 60 m U/D F.B. @ 2+183.0 RT
 - ⑩ U.S. 5 I+063 RT ~ I+073.3 RT
NEW 150 mm X 13m CARRIER
 - ⑪ U.S. 5 I+073.3 RT ~ VT. RTE. 9 I+178.0 RT
NEW 150 mm X 63 m U/D F.B. @ I+178.0 RT

FEB 21 2001

NEW DRAINAGE
Metric

PROJECT: BRATTLEBORO	PROJECT NO. : NH 2000(18)
DESIGN FILE NAME: /prop/93d9/r/d9/zzz.dgn	PLOT DATE: 1-OCT-1997
IPARM FILE NAME: -	SURVEY DATE: 10-95
SURVEYED BY: R. GILMAN	DRAWN BY: K. UPMAL
SQUAD LEADER: S. MENARD	
R. O. W. SHEET 5 OF 14	

5

VT STATE PLANE GRID



- EXISTING DRAINAGE**
- ① U.S. 5 1+062.70 RT ~ 1+104.19 LT
REMOVE EXISTING 460 mm RCP & DI
 - ② U.S. 5 1+102.77 LT ~ 1+104.10 LT
REMOVE EXISTING 300 mm CGMP & DI
 - ③ U.S. 5 1+04.67 LT ~ 1+17.40 LT
REMOVE EXISTING 450 mm RCP & DI
 - ④ U.S. 5 1+17.95 LT ~ 1+123.41 LT
REMOVE EXISTING 450 mm RCP & DI
 - ⑤ U.S. 5 1+124.13 LT ~ 1+140 LT
REMOVE EXISTING 450 mm RCP & DI
 - ⑥ U.S. 5 1+140 LT
REMOVE EXISTING 450 mm RCP & DI
 - ⑦ U.S. 5 1+140.75 LT ~ 1+152.05 LT
REMOVE EXISTING 450 mm RCP & DI
 - ⑧ U.S. 5 1+152.05 LT
REMOVE EXISTING 200 mm CSP & DI
 - ⑨ U.S. 5 1+152.6 LT ~ 1+181.8 LT
REMOVE EXISTING 450 mm RCP & DI
 - ⑭ U.S. 5 1+112.6 RT ~ 1+115.5 RT
REMOVE EXISTING 300 mm RCP & DI
 - ⑮ U.S. 5 1+111.2 RT ~ 1+115.4 RT
REMOVE EXISTING 375 mm RCP & DI
 - ⑯ U.S. 5 1+109.0 RT ~ 1+110.0 RT
REMOVE EXISTING 150 mm CSP & DI
 - ⑰ VT 9 2+161.6 RT ~ 2+167.2 RT
REMOVE EXISTING 375 mm RCP & DI
 - ⑱ VT 9 2+167.4 RT ~ 2+173.1 LT
REMOVE EXISTING 450 mm RCP & DI
 - ⑲ VT 9 2+162.1 LT ~ 2+173.2 LT
REMOVE EXISTING 375mm RCP & DI
 - ⑳ VT 9 2+156.8 LT ~ 2+161.3 LT
REMOVE EXISTING 375 mm RCP & DI
 - ㉑ US 5 1+140.0 RT ~ VT 9 2+156.8 LT
EXISTING 375 mm RCP & DI--REMOVE
 - ㉒ VT 9 2+173.8 LT ~ 2+190.9 LT
REMOVE EXISTING 450 mm RCP & DI
 - ㉓ VT 9 2+196.5 LT ~ 2+242.5 LT
EXISTING 375 mm RCP & DI--RETAIN

FEB 21 2001

LAYOUT--EXISTING DRAINAGE

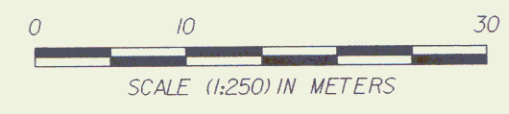

PROJECT:	BRATTLEBORO	PROJECT NO.:	NH 2000(18)		
DESIGN FILE NAME:	/prop/93d191/r/d191zzz.dgn		PLOT DATE:	30-SEP-1997	
IPARM FILE NAME:	-	SURVEYED BY:	R. GILMAN	SURVEY DATE:	10-95
SQUAD LEADER:	S. MENARD	DRAWN BY:	K. UPMAL		
R. O. W. SHEET 6 OF 14					

6

STATION 1 215.00
 END PROJECT NH 2000(18)

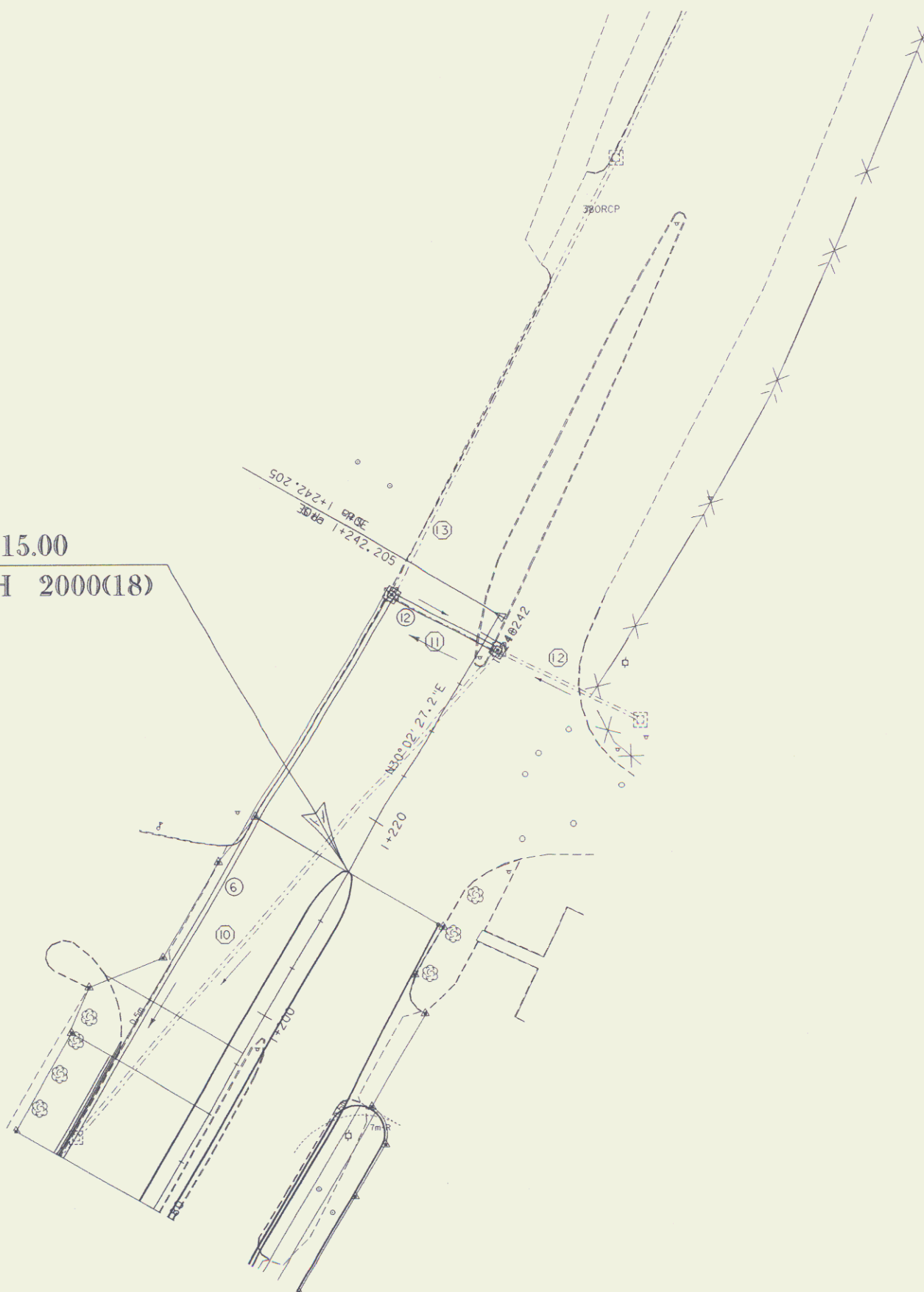

- EXISTING DRAINAGE
- ⑩ U.S. 5 1+182.6 LT ~ 1+239.45 RT
 REMOVE EXISTING 375 mm RCP & DI
 - ⑪ U.S. 5 1+238.8 LT ~ 1+239.4 RT
 REMOVE EXISTING 300 mm RCP & DI
 - ⑫ U.S. 5 1+239.6 RT ~ 1+240.0 RT
 RETAIN EXISTING 300 mm RCP & DI
 - ⑬ U.S. 5 1+239.2 LT
 RETAIN EXISTING 375 mm RCP & DI

FEB 21 2001

LAYOUT--EXISTING & NEW DRAINAGE

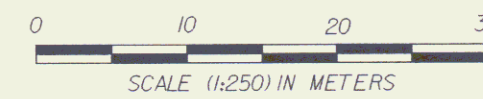

PROJECT: BRATTLEBORO	PROJECT NO. : NH 2000(18)
DESIGN FILE NAME: /prop/93d9/r/d9/zz.dgn	PLOT DATE: 30-SEP-1997
IPARM FILE NAME: d9d3.i	SURVEY DATE:
SURVEYED BY:	DRAWN BY: SQUAD C
SQUAD LEADER: MENARD	R. O. W. SHEET 7 OF 14 SHEETS



**STATE OF VERMONT
AGENCY OF TRANSPORTATION
RIGHT OF WAY PLANS
DETAIL SHEET**

TABLE OF PROJECT PROPERTY ACQUISITION

PARCEL NO.	GRANTOR	SHEET NO.	BEGINNING STATION	ENDING STATION	TAKING	REM.	RIGHTS	TITLE TAKEN	DATE	TOWN OR CITY RECORDED	BK.	PG.	REMARKS	REVISION NO.	SHEET	DESCRIPTION OF REVISION	DATE	MADE BY	APPROVED BY
1A	THE ELLIS ROBERTSON CO. INC. - LESSOR ELXSI - LESSEE	10,11, 13	RTE. 5 1+085.3 RT. RTE. 5 1+057.8 RT. RTE. 5 1+061.8 RT. RTE. 5 1+062.0 RT. RTE. 5 1+082.4 RT. RTE. 5 1+080.0 RT. RTE. 5 1+102.5 RT.	RTE. 9 2+226.7 RT. RTE. 5 1+072.0 RT. RTE. 5 1+067.7 RT. RTE. 9 2+228.8 RT. RTE. 5 1+104.8 RT.	0.03HA±		CONST. (T) 77 SM± DITCH & DRAINAGE (P) CULVERT (P) 0.03 HA± CONST. (T) DRIVE (T) REMOVE (T)			BRATTLEBORO			0.07A± 829 S.F.± 0.07A± 9M (29.5') PAVED MP 0458 CURB & TREE	1	8,10 11,13	PARCEL NO. 1 ELLIS ROBERTSON CO. INC., ADD ELXSI AS LESSEE. PER C.O. 8948.	02-10-98	W. L. G.	L. W. B.
1B		10,11, 13	RTE. 5 1+043.1 CL	RTE. 9 2+239.8 CL	0.26HA±		ALL R. T. & I.						U.S. RTE. 5 & VT. RTE. 9 RIGHT OF WAY 0.65A±	2	8,12	PARCEL NO. 3 TARMY-PIZZA HUT, ADD REMOVE & RESET (T) FOR LIGHT & APPURTENANCES. PER C.O. 8953.	03-12-98	W. L. G.	L. W. B.
2A	THE ELLIS ROBERTSON CO. INC. - LESSOR ROUNTREE MOTORS, INC. D/B/A/ BRATTLEBORO FORD-MERCURY- LESSEE	11,13, 14	RTE. 9 2+187.3 LT. RTE. 9 2+216.0 LT. RTE. 9 2+189.5 LT. RTE. 5 1+187.5 RT. RTE. 5 1+202 RT.	RTE. 5 1+197.7 RT.	54 SM±		REMOVE & RESET (T) REMOVE & RESET (T) REMOVE & RESET (T)			BRATTLEBORO			580 S.F.± LIGHT & POLE LIGHT & POLE LIGHT & POLE DRIVE (9.5M (31.2') PAVED MP 0466	3	8	PARCEL NO. 4 MOBIL OIL, ADD TO DETAIL SHEET BSH 2+085.1 RT. REMOVE & RESET (T), REMARKS YARD LIGHT. PER C.O. 8966.	05-18-98	W. L. G.	L. W. B.
2B		11,13, 14	RTE. 9 2+235.6 CL	RTE. 5 1+211.8 CL	0.22HA±		ALL R. T. & I.						U.S. RTE. 5 & VT. RTE. 9 RIGHT OF WAY 0.54A±	4	8,11, 14	PARCEL NO. 3 PIZZA HUT, REMOVE ALL CONSTRUCTION EASEMENTS. PER C.O. 8969.	06-02-98	M. J. R.	L. W. B.
2B		11,13, 14	RTE. 9 2+235.6 CL	RTE. 5 1+211.8 CL	0.22HA±		ALL R. T. & I.						U.S. RTE. 5 & VT. RTE. 9 RIGHT OF WAY 0.54A±	5	8	PARCEL NO. 2 ELLIS ROBERTSON CO. INC. NOTE ON DETAIL SHEET RTE. 5 1+202 RT. 9.5M (31.2') DRIVE PAVED MP 0466. PER C.O. 8979	07-09-98	W. L. G.	L. W. B.
2B		11,13, 14	RTE. 9 2+235.6 CL	RTE. 5 1+211.8 CL	0.22HA±		ALL R. T. & I.						U.S. RTE. 5 & VT. RTE. 9 RIGHT OF WAY 0.54A±	6	8,11 12,13	PARCEL NO. 3 PIZZA HUT, NOTE ON DETAIL SHEET RTE. 5 1+202 LT. WIDTH VARIES PAVED MP 0466. ADD 'S' ON HUT ON DETAIL SHEET, LAYOUT SHEETS 11,12, & 14 ADD 'VERMONT' AND 'S' TO PIZZA HUT FOR LESSEE PER C.O. 8980.	07-08-98	W. L. G.	L. W. B.
3A	THE JACK TARMY REVOCABLE TRUST, JANUARY 22, 1982 - LESSOR VT. PIZZA HUTS, INC. - LESSEE	11,12, 14	RTE. 5 1+163.7 LT. RTE. 5 1+190.5 LT. RTE. 5 1+194.3 LT. RTE. 5 1+202 LT. BSH 2+063.2 LT. BSH 2+064 LT. BSH 2+070.8 LT.	RTE. 5 1+194.3 LT. RTE. 5 1+196.2 LT. RTE. 5 1+196.2 LT. RTE. 5 1+196.2 LT. BSH 2+073 LT. BSH 2+074.3 LT.	27.5 SM±		SLOPE (T) 2.2 SM± REMOVE & RESET (T) DRIVE (T) REMOVE & RESET (T) INSTALL (T)			BRATTLEBORO			296 S.F.± 23.7 S.F.± CURB DRIVE VARIES PAVED MP 0466 PAVED 12M (39.4') MP 0009 LIGHT & APPURTENANCES CURB	7	9,11	REMOVE RELINQUISHMENTS FROM PROJECT. PER C.O. 8991.	08-25-98	M. J. R.	L. W. B.
3B		11,12, 14	BSH 2+051.7 CL	RTE. 5 1+211.8 CL	0.24HA±		ALL R. T. & I.						U.S. RTE. 5 & VT. RTE. 9 RIGHT OF WAY 0.59A±	8	8,11 14	PARCEL NO. 2 ELLIS ROBERTSON CO., INC. PULL IN ACQUISITION NEEDS TO NEW LIMITS. REDUCE TAKING TO 54 SM± (580 S.F.±). DELETE REMOVE & RESET AT RTE. 9 STA. 2+175.5 RT, RTE. 9 STA. 2+166.2 RT & RTE. 5 STA. 1+157.0 RT. PER C.O. 9027.	02-22-99	R. M. W.	L. W. B.
3B		11,12, 14	BSH 2+051.7 CL	RTE. 5 1+211.8 CL	0.24HA±		ALL R. T. & I.						U.S. RTE. 5 & VT. RTE. 9 RIGHT OF WAY 0.59A±	9	8,11 13,14	PARCEL NO. 2 ELLIS ROBERTSON CO., INC. CHANGE NAME TO INCLUDE LESSEE: ROUNTREE MOTORS, INC. D/B/A/ BRATTLEBORO FORD-MERCURY. REMOVE CONST. (T). PER C.O. 9028.	02-24-99	R. M. W.	L. W. B.
4A	MOBIL OIL CORPORATION	10,11, 12	RTE. 5 1+091.1 LT. RTE. 5 1+087.8 LT. RTE. 5 1+102.8 LT.± BSH 2+085.1 RT.	BSH 2+093.5 RT. BSH 2+082.7 RT.	53.5 SM±		CONST. (T) 0.01 HA± REMOVE (T) REMOVE & RESET (T)			BRATTLEBORO			575 S.F.± 0.03A± DROP INLET & CULVERT YARD LIGHT			REPRODUCIBLES TO DESIGN 03-04-99			
4B		10,11, 12	RTE. 5 1+068.2 CL	BSH 2+061.2 RT.	0.18HA±		ALL R. T. & I.						U.S. RTE. 5 & VT. RTE. 9 RIGHT OF WAY 0.45A±						

FEB 21 2001

2000018 100 1804 FJM	DR. (P)- DRAINAGE RIGHT DIT. (P)- DITCHING RIGHT CH. (P)- CHANNEL RT. DRIVE (T)- DRIVE RIGHT CUL. (P)- CULVERT RIGHT [X]- WATER SOURCES	<p>PRESENT R.O.W. TAKING WITHOUT ACCESS TAKING WITHOUT ACCESS ALONG PROPERTY LINE TAKING WITH ACCESS PERMANENT EASEMENT TEMPORARY EASEMENT</p>	<p>LEGEND</p> <p>..... CZ (P) CLEAR ZONE --- CONST. (T) --- CONSTRUCTION EASEMENT --- SR --- SLOPE RIGHTS --- P --- PROPERTY LINE --- L --- TOP OF CUT --- O --- TOE OF SLOPE</p>	REVISED 02-22-99	R. O. W. PLANS
ACCT. prap /p/prop/93d/9/r/d/9/10d.dgn DATE PLOTTED 7-APR-1999 rd/9/10d.i				APPROVED: LAWRENCE W. BLISS DATE: 03-22-97 AGENT D. PLANS & TITLES	<p align="center">BRATTLEBORO NH 2000(18) R. O. W. SHEET (8) OF 14 SHEETS SHEET 13 OF 67</p>

TABLE OF PROJECT PROPERTY ACQUISITION

**STATE OF VERMONT
AGENCY OF TRANSPORTATION
RIGHT OF WAY PLANS
DETAIL SHEET**

PARCEL NO.	GRANTOR	SHEET NO.	BEGINNING STATION	ENDING STATION	TAKING	REM.	RIGHTS	TITLE TAKEN	DATE	TOWN OR CITY RECORDED	BK.	PG.	REMARKS	REVISION NO.	SHEET	DESCRIPTION OF REVISION	DATE	MADE BY	APPROVED BY	
5	CENTRAL VERMONT PUBLIC SERVICE CORP.												UTILITY							
6	NEW ENGLAND TELEPHONE AND TELEGRAPH D/B/A BELL ATLANTIC-NEW ENGLAND												UTILITY							
7	WARNER CABLE OF BRATTLEBORO, INC.												UTILITY							
8	TOWN OF BRATTLEBORO FIRE DEPARTMENT												UTILITY							
9	TOWN OF BRATTLEBORO PUBLIC WORKS DEPARTMENT												UTILITY							

10M (32.8') TO 15M (49.2')
RADIUS FROM INTERSECTION OF
RTE. 5 & RTE. 9 SURVEY
CENTER LINES

FEB 21 2001

<p>2000018 100 1804 FJM</p> <p>ACCT.prop /prop/93d91/r-d91d.dgn DATE PLOTTED 21-AUG-1998 r-d91d2.1</p>	<p>DR. (P)- DRAINAGE RIGHT DIT. (P)- DITCHING RIGHT CH. (P)- CHANNEL RT. DRIVE (T)- DRIVE RIGHT CUL. (P)- CULVERT RIGHT [W]- WATER SOURCES</p>	<p>PRESENT R.O.W. TAKING WITHOUT ACCESS TAKING WITHOUT ACCESS ALONG PROPERTY LINE TAKING WITH ACCESS PERMANENT EASEMENT TEMPORARY EASEMENT</p>	<p>LEGEND</p> <p>--- C&T (P) --- CLEARING & TRIMMING . . . C.Z. (P) . . . CLEAR ZONE --- CONSTRUCTION --- CONSTRUCTION EASEMENT SR SR SLOPE RIGHTS P PROPERTY LINE L TOP OF CUT L TOE OF SLOPE</p>	<p>APPROVED: LAWRENCE W. BLISS DATE: 09-22-97 AGENT D. PLANS & TITLES</p>	<p>R. O. W. PLANS</p> <p>BRATTLEBORO NH 2000(18) SHEET 9 OF 14</p>
--	--	--	--	---	--

VT STATE PLANE GRID

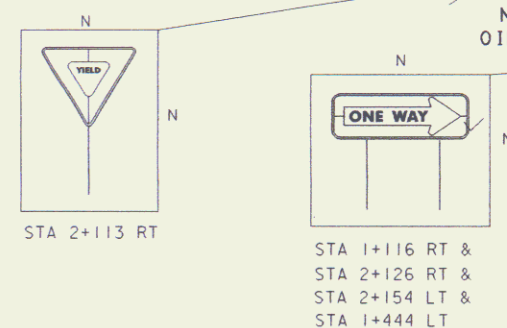
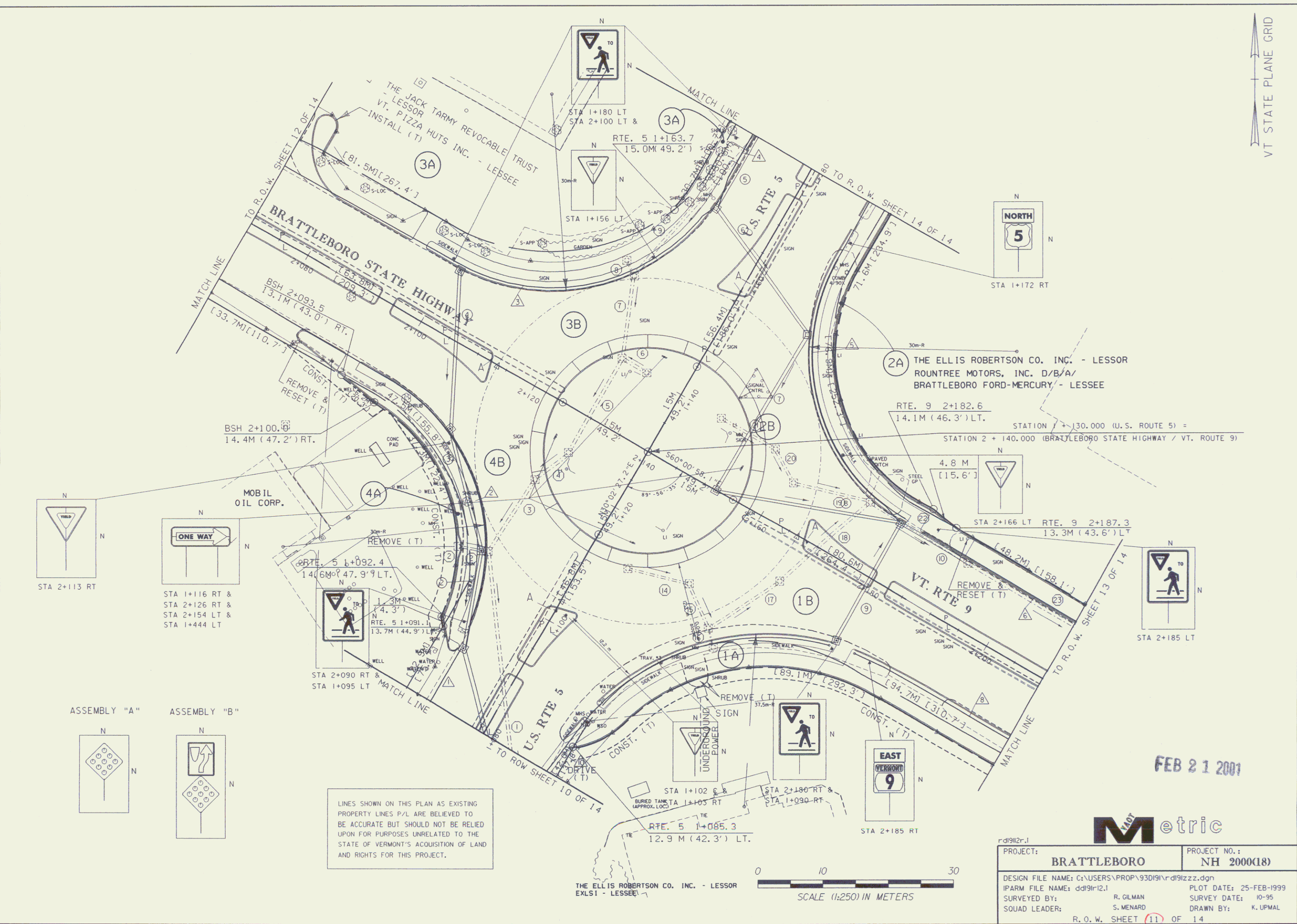

LINES SHOWN ON THIS PLAN AS EXISTING PROPERTY LINES P/L ARE BELIEVED TO BE ACCURATE BUT SHOULD NOT BE RELIED UPON FOR PURPOSES UNRELATED TO THE STATE OF VERMONT'S ACQUISITION OF LAND AND RIGHTS FOR THIS PROJECT.

FEB 21 2001

Metric

PROJECT:	BRATTLEBORO	PROJECT NO.:	NH 2000(18)
DESIGN FILE NAME:	C:\USERS\PROP\930191\rd91zzz.dgn		
IPARM FILE NAME:	dd91r12.1		
SURVEYED BY:	R. GLMAN	SURVEY DATE:	10-95
SQUAD LEADER:	S. MENARD	DRAWN BY:	K. UPMAL
R. O. W. SHEET 11 OF 14			

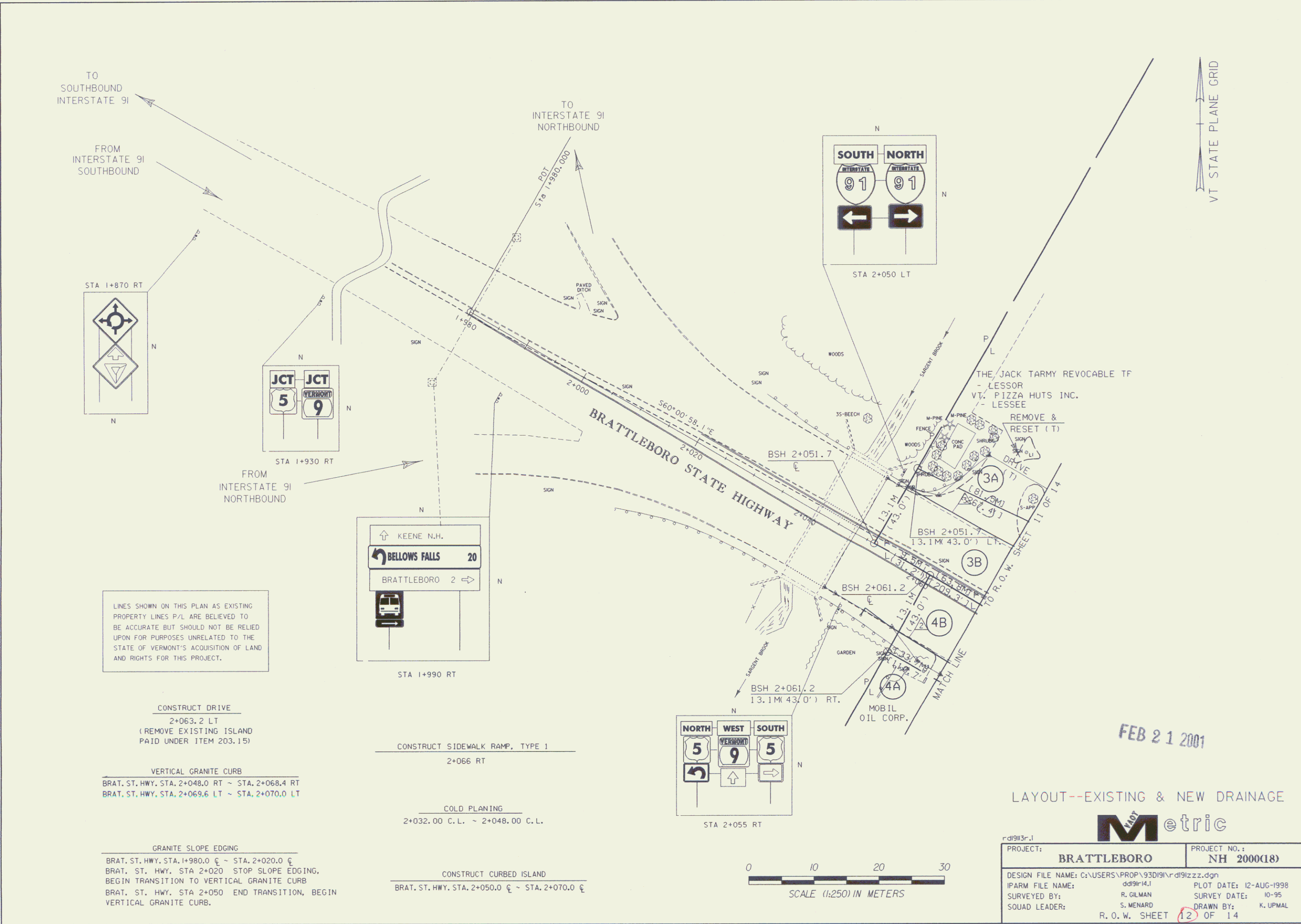

TO
SOUTHBOUND
INTERSTATE 91

FROM
INTERSTATE 91
SOUTHBOUND

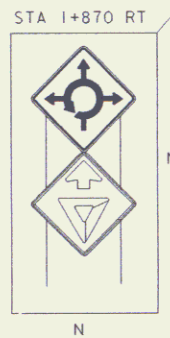

TO
INTERSTATE 91
NORTHBOUND

FROM
INTERSTATE 91
NORTHBOUND

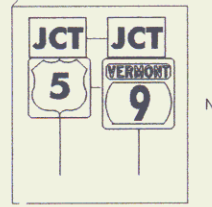

FROM
INTERSTATE 91
NORTHBOUND

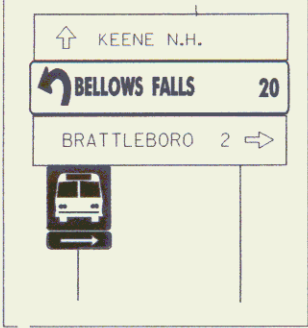

LINES SHOWN ON THIS PLAN AS EXISTING
PROPERTY LINES P/L ARE BELIEVED TO
BE ACCURATE BUT SHOULD NOT BE RELIED
UPON FOR PURPOSES UNRELATED TO THE
STATE OF VERMONT'S ACQUISITION OF LAND
AND RIGHTS FOR THIS PROJECT.

CONSTRUCT DRIVE
2+063.2 LT
(REMOVE EXISTING ISLAND
PAID UNDER ITEM 203.15)

VERTICAL GRANITE CURB
BRAT. ST. HWY. STA. 2+048.0 RT ~ STA. 2+068.4 RT
BRAT. ST. HWY. STA. 2+069.6 LT ~ STA. 2+070.0 LT

CONSTRUCT SIDEWALK RAMP, TYPE 1
2+066 RT

COLD PLANING
2+032.00 C.L. ~ 2+048.00 C.L.

GRANITE SLOPE EDGING
BRAT. ST. HWY. STA. 1+980.0 ☐ ~ STA. 2+020.0 ☐
BRAT. ST. HWY. STA. 2+020 STOP SLOPE EDGING,
BEGIN TRANSITION TO VERTICAL GRANITE CURB
BRAT. ST. HWY. STA. 2+050 END TRANSITION, BEGIN
VERTICAL GRANITE CURB.

CONSTRUCT CURBED ISLAND
BRAT. ST. HWY. STA. 2+050.0 ☐ ~ STA. 2+070.0 ☐

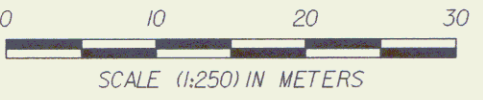
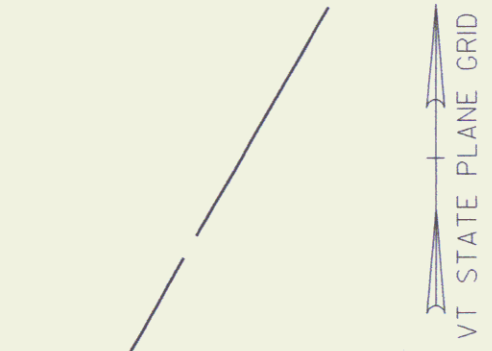
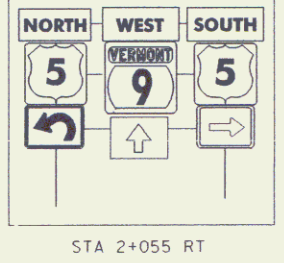
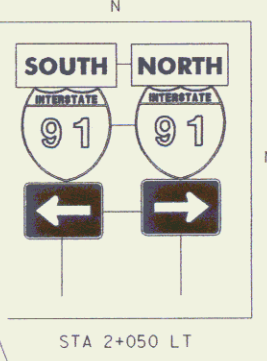

FEB 21 2001

LAYOUT--EXISTING & NEW DRAINAGE



PROJECT:	BRATTLEBORO	PROJECT NO.:	NH 2000(18)
DESIGN FILE NAME:	C:\USERS\PROP\93D\91\rd\91z.z.dgn	PLOT DATE:	12-AUG-1998
IPARM FILE NAME:	dd91r14.1	SURVEY DATE:	10-95
SURVEYED BY:	R. GILMAN	DRAWN BY:	K. UPMAL
SQUAD LEADER:	S. MENARD		
	R. O. W. SHEET	12	OF 14

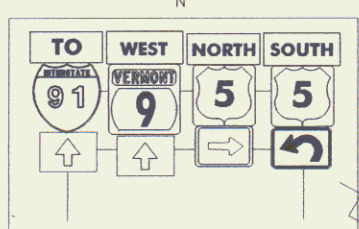

STATION 2 + 225.000
END APPROACH CONSTRUCTION

THE ELLIS ROBERTSON CO. INC. - LESSOR
ROUNTREE MOTORS, INC. D/B/A/
BRATTLEBORO FORD-MERCURY - LESSEE

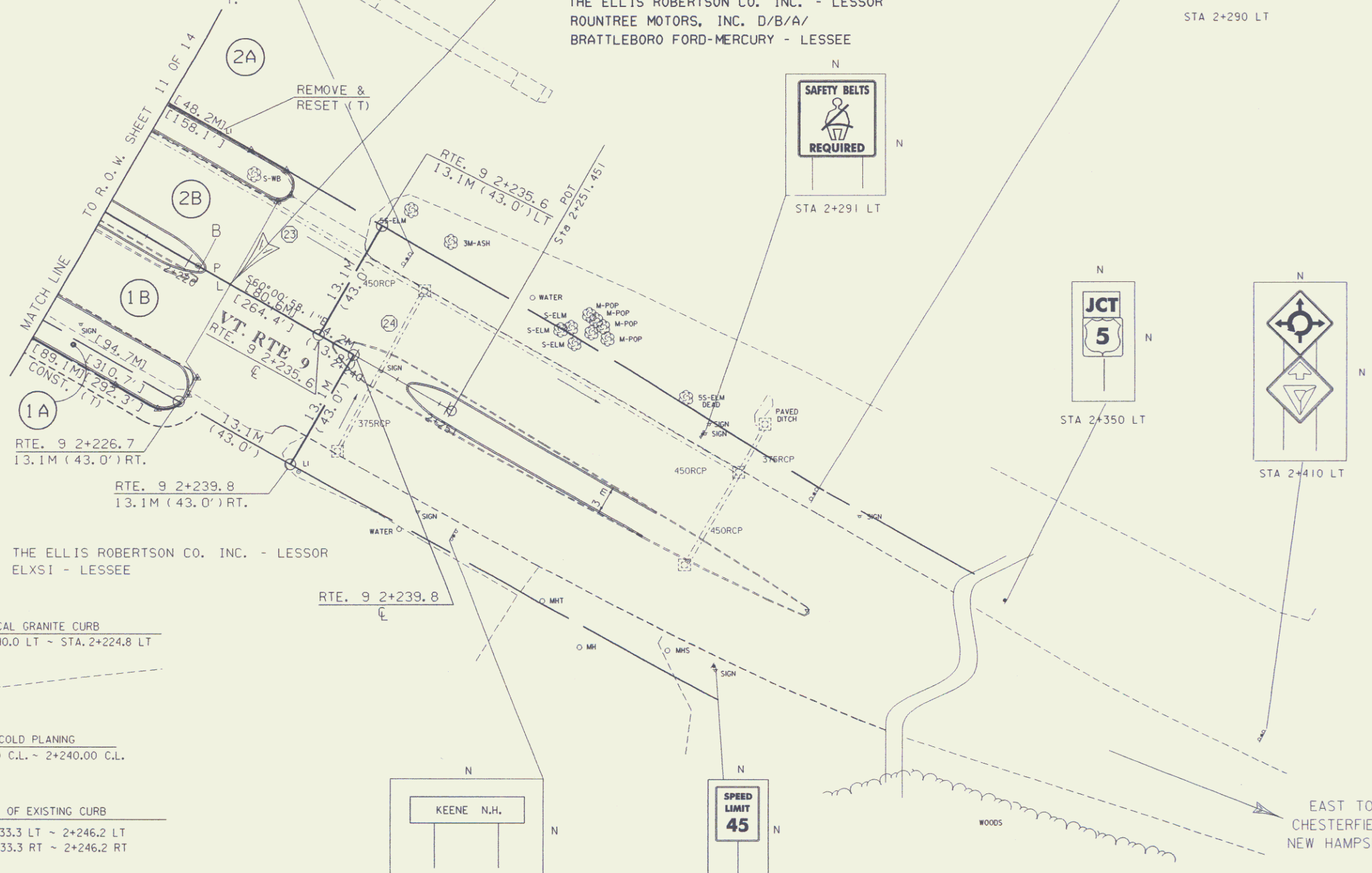
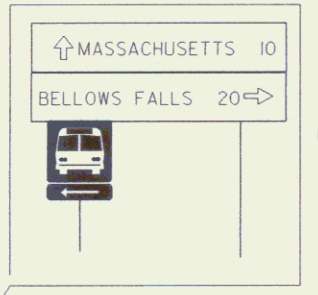

THE ELLIS ROBERTSON CO. INC. - LESSOR
ELXS1 - LESSEE

VERTICAL GRANITE CURB
VT 9 STA. 2+210.0 LT ~ STA. 2+224.8 LT

COLD PLANING
2+225.00 C.L. ~ 2+240.00 C.L.

REMOVAL OF EXISTING CURB
VT 9 2+233.3 LT ~ 2+246.2 LT
VT 9 2+233.3 RT ~ 2+246.2 RT

REMOVING AND RESETTING CURB
VT 9 2+246.2 LT ~ 2+264.4 LT
VT 9 2+246.2 RT ~ 2+264.4 RT

CONSTRUCT CURBED ISLAND
VT 9 STA. 2+210.0 € ~ STA. 2+222.0 €
VT 9 STA. 2+210.0 RT ~ STA. 2+225.0 RT

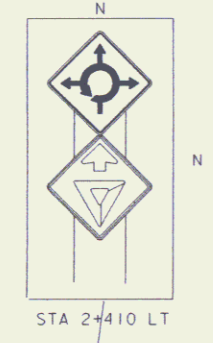
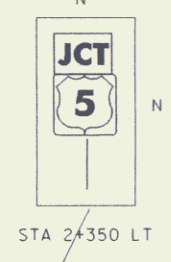
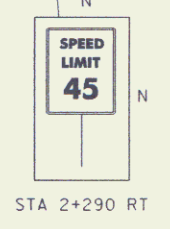
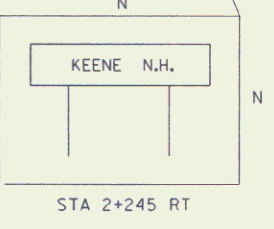

LINES SHOWN ON THIS PLAN AS EXISTING
PROPERTY LINES P/L ARE BELIEVED TO
BE ACCURATE BUT SHOULD NOT BE RELIED
UPON FOR PURPOSES UNRELATED TO THE
STATE OF VERMONT'S ACQUISITION OF LAND
AND RIGHTS FOR THIS PROJECT.

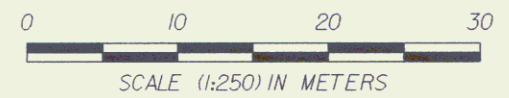

FEB 21 2001



PROJECT:	BRATTLEBORO	PROJECT NO.:	NH 2000(18)
DESIGN FILE NAME:	C:\USERS\PROP\9309\rd\91z2.dgn	PLOT DATE:	25-FEB-1999
IPARM FILE NAME:	r\d914r.j	SURVEY DATE:	10-95
SURVEYED BY:	R. GLMAN	DRAWN BY:	K. UPMAL
SQUAD LEADER:	S. MENARD		
R. O. W. SHEET 13 OF 14			

13

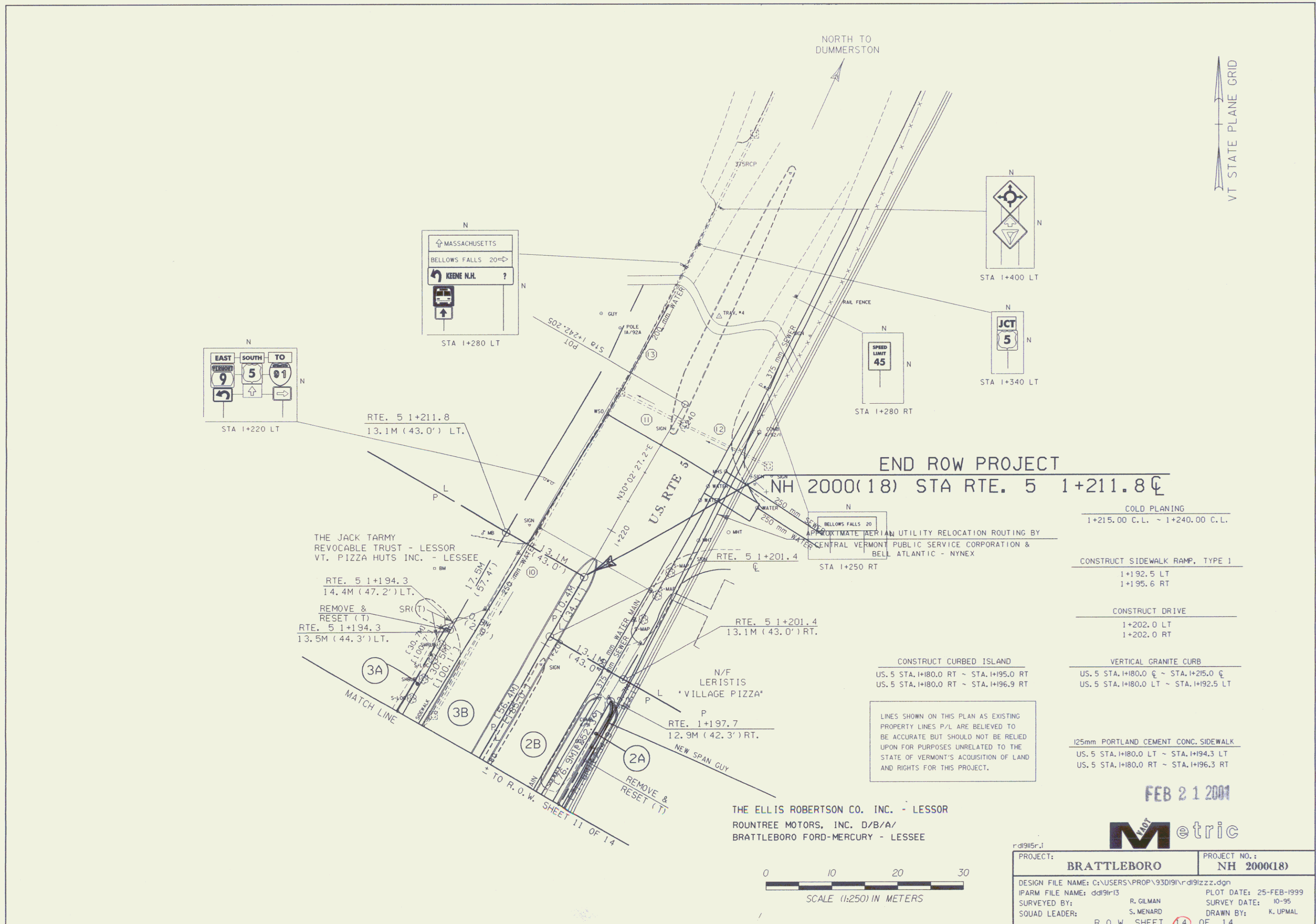

END ROW PROJECT
NH 2000(18) STA RTE. 5 1+211.8 C

- COLD PLACING
1+215.00 C.L. ~ 1+240.00 C.L.
- CONSTRUCT SIDEWALK RAMP, TYPE 1
1+192.5 LT
1+195.6 RT
- CONSTRUCT DRIVE
1+202.0 LT
1+202.0 RT
- VERTICAL GRANITE CURB
US. 5 STA. 1+180.0 C ~ STA. 1+215.0 C
US. 5 STA. 1+180.0 LT ~ STA. 1+192.5 LT
- 125mm PORTLAND CEMENT CONC. SIDEWALK
US. 5 STA. 1+180.0 LT ~ STA. 1+194.3 LT
US. 5 STA. 1+180.0 RT ~ STA. 1+196.3 RT

CONSTRUCT CURBED ISLAND
 US. 5 STA. 1+180.0 RT ~ STA. 1+195.0 RT
 US. 5 STA. 1+180.0 RT ~ STA. 1+196.9 RT

LINES SHOWN ON THIS PLAN AS EXISTING PROPERTY LINES P/L ARE BELIEVED TO BE ACCURATE BUT SHOULD NOT BE RELIED UPON FOR PURPOSES UNRELATED TO THE STATE OF VERMONT'S ACQUISITION OF LAND AND RIGHTS FOR THIS PROJECT.

THE JACK TARMY REVOCABLE TRUST - LESSOR
 VT. PIZZA HUTS INC. - LESSEE

RTE. 5 1+194.3
 14.4M (47.2') LT.

REMOVE & RESET (T)
 RTE. 5 1+194.3
 13.5M (44.3') LT.

THE ELLIS ROBERTSON CO. INC. - LESSOR
 ROUNTREE MOTORS, INC. D/B/A/
 BRATTLEBORO FORD-MERCURY - LESSEE

FEB 21 2001

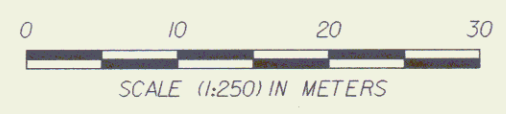

PROJECT: BRATTLEBORO	PROJECT NO.: NH 2000(18)
DESIGN FILE NAME: G:\USERS\PROP\930191\rd91zzz.dgn	PLOT DATE: 25-FEB-1999
IPARM FILE NAME: ddi91r13	R. GILMAN SURVEY DATE: 10-95
SURVEYED BY: S. MENARD	DRAWN BY: K. UPMAL
SQUAD LEADER: R. O. W. SHEET 14	OF 14