

STATION 2 + 225.000
END APPROACH CONSTRUCTION

THE ELLIS ROBERTSON CO. INC. - LESSOR
ROUNTREE MOTORS, INC. D/B/A/
BRATTLEBORO FORD-MERCURY - LESSEE

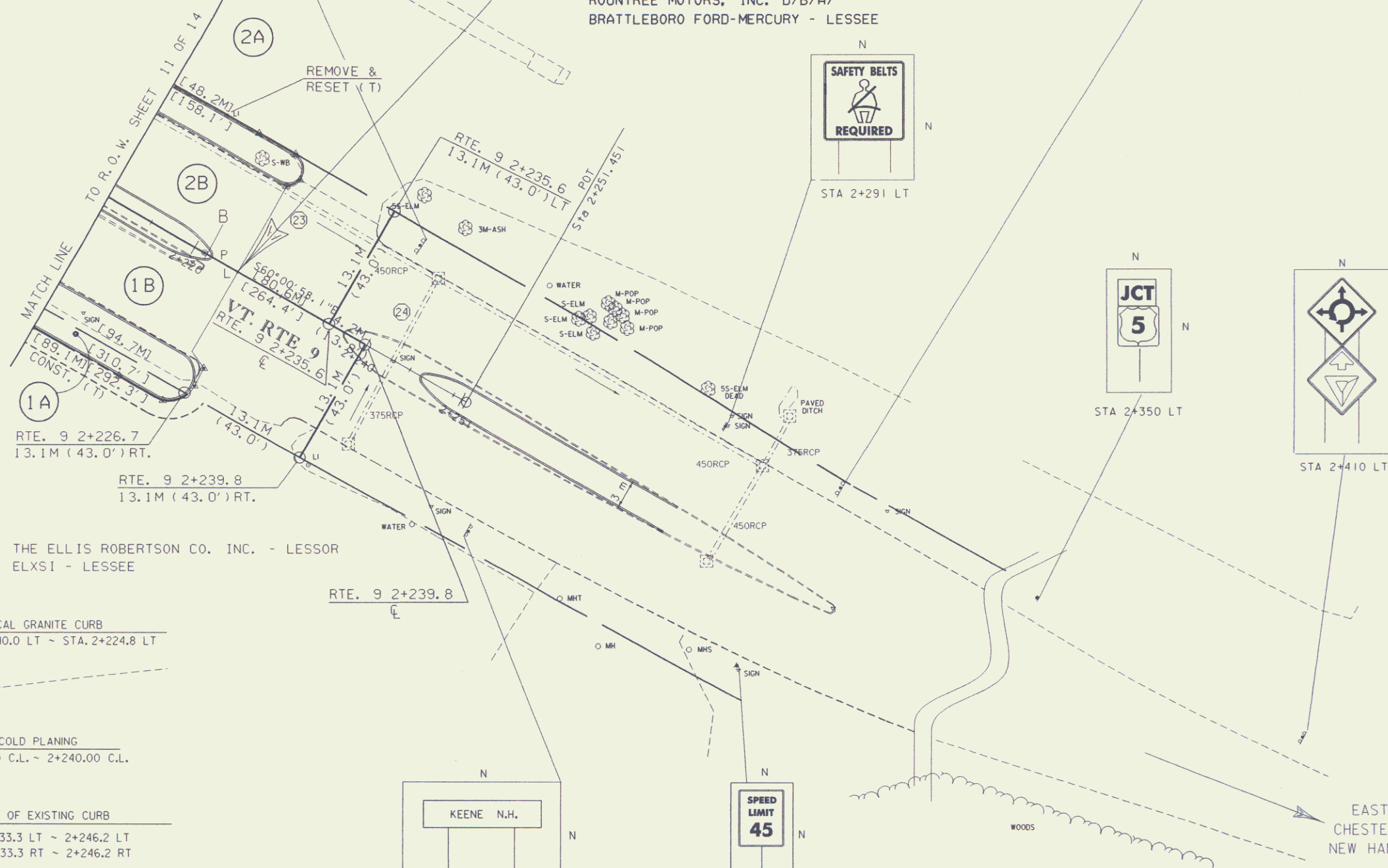
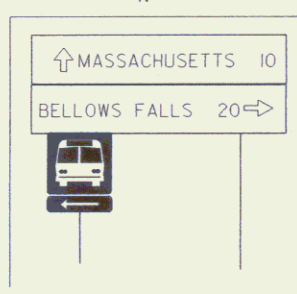

THE ELLIS ROBERTSON CO. INC. - LESSOR
ELXSI - LESSEE

VERTICAL GRANITE CURB
VT 9 STA. 2+210.0 LT ~ STA. 2+224.8 LT

COLD PLANING
2+225.00 C.L. ~ 2+240.00 C.L.

REMOVAL OF EXISTING CURB
VT 9 2+233.3 LT ~ 2+246.2 LT
VT 9 2+233.3 RT ~ 2+246.2 RT

REMOVING AND RESETTING CURB
VT 9 2+246.2 LT ~ 2+264.4 LT
VT 9 2+246.2 RT ~ 2+264.4 RT

CONSTRUCT CURBED ISLAND
VT 9 STA. 2+210.0 € ~ STA. 2+222.0 €
VT 9 STA. 2+210.0 RT ~ STA. 2+225.0 RT

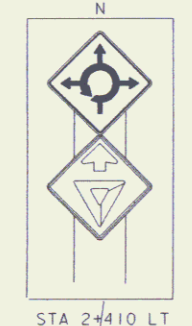
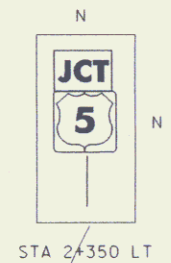
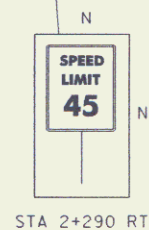
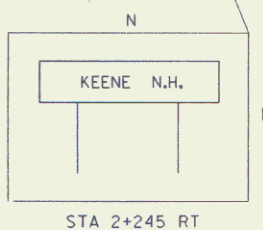

LINES SHOWN ON THIS PLAN AS EXISTING
PROPERTY LINES P/L ARE BELIEVED TO
BE ACCURATE BUT SHOULD NOT BE RELIED
UPON FOR PURPOSES UNRELATED TO THE
STATE OF VERMONT'S ACQUISITION OF LAND
AND RIGHTS FOR THIS PROJECT.

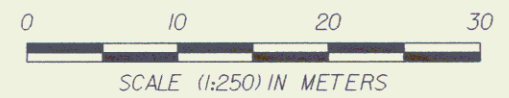

FEB 21 2001



PROJECT:	BRATTLEBORO	PROJECT NO.:	NH 2000(18)
DESIGN FILE NAME:	C:\USERS\PROP\9309\rd91z2z.dgn	PLOT DATE:	25-FEB-1999
IPARM FILE NAME:	rd91z2z.dgn	SURVEY DATE:	10-95
SURVEYED BY:	R. GLMAN	DRAWN BY:	K. UPMAL
SQUAD LEADER:	S. MENARD		
R. O. W. SHEET 13 OF 14			

13