

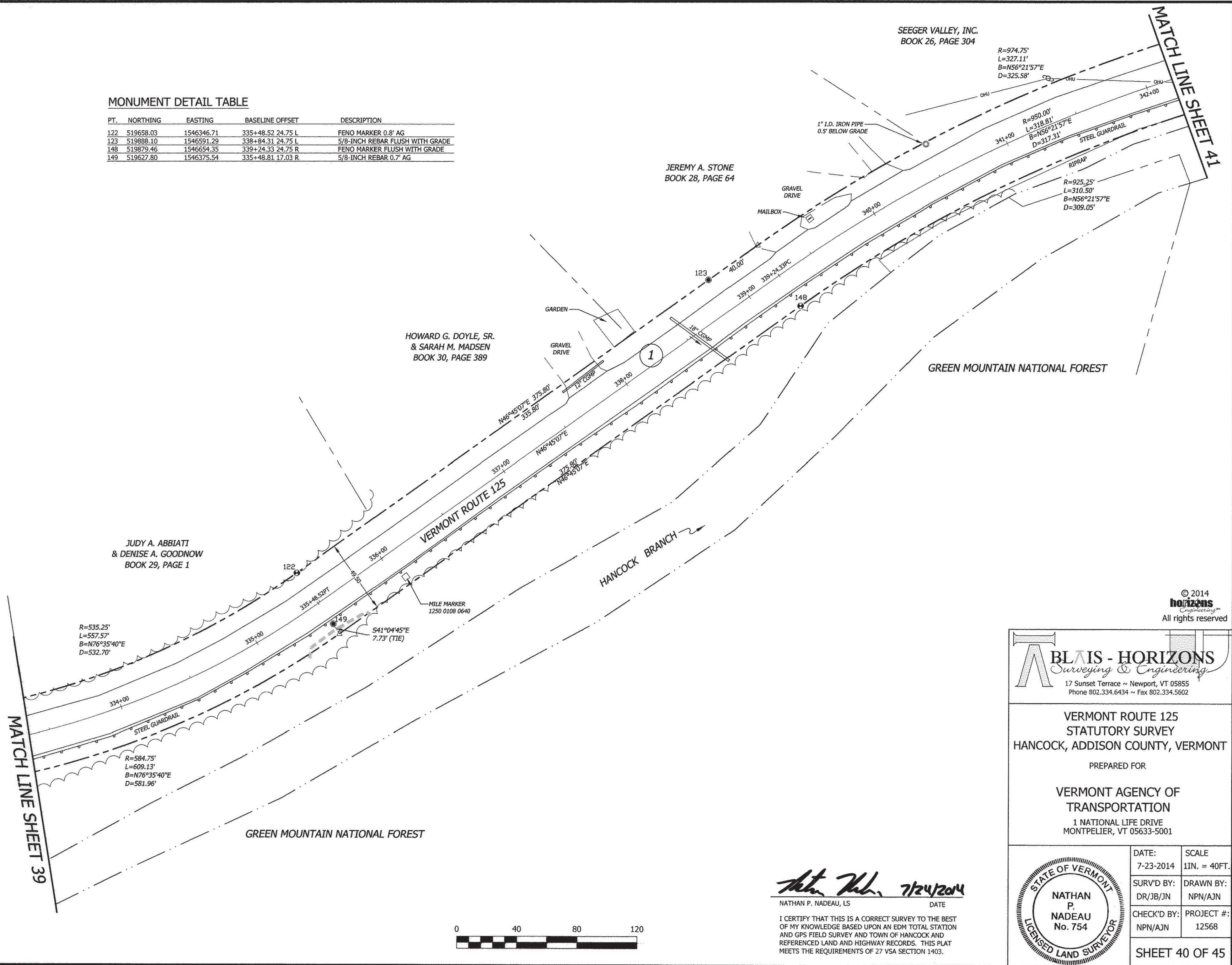

MONUMENT DETAIL TABLE

PT.	NORTHING	EASTING	BASELINE OFFSET	DESCRIPTION
122	519658.03	1546346.71	335+48.52 24.75 L	FENO MARKER 0.8' AG
123	519888.10	1546591.29	338+84.31 24.75 L	5/8-INCH REBAR FLUSH WITH GRADE
148	519879.46	1546654.35	339+24.33 24.75 R	FENO MARKER FLUSH WITH GRADE
149	519627.80	1546375.54	335+48.81 17.03 R	5/8-INCH REBAR 0.7' AG



BLAIS-HORIZONS CERTIFIES THAT THIS DRAWING WAS PRODUCED AS AN ORIGINAL INK ON MYLAR

SIGNATURE

Nathan P. Nadeau



Nathan P. Nadeau 7/24/2014
 NATHAN P. NADEAU, LS DATE

I CERTIFY THAT THIS IS A CORRECT SURVEY TO THE BEST OF MY KNOWLEDGE BASED UPON AN EDM TOTAL STATION AND GPS FIELD SURVEY AND TOWN OF HANCOCK AND REFERENCED LAND AND HIGHWAY RECORDS. THIS PLAT MEETS THE REQUIREMENTS OF 27 VSA SECTION 1403.

© 2014
horizons
 Engineering
 All rights reserved

BLAIS - HORIZONS
 Surveying & Engineering
 17 Sunset Terrace ~ Newport, VT 05855
 Phone 802.334.6434 ~ Fax 802.334.5602

**VERMONT ROUTE 125
 STATUTORY SURVEY
 HANCOCK, ADDISON COUNTY, VERMONT**

PREPARED FOR
**VERMONT AGENCY OF
 TRANSPORTATION**
 1 NATIONAL LIFE DRIVE
 MONTPELIER, VT 05633-5001

	DATE:	SCALE
	7-23-2014	1IN. = 40FT.
	SURV'D BY:	DRAWN BY:
	DR/JB/JN	NPN/AJN
CHECK'D BY:	PROJECT #:	
NPN/AJN	12568	
SHEET 40 OF 45		