

MATCH LINE SHEET 35

MATCH LINE SHEET 33

SIGNATURE

JASON STONE &
JAMIE STONE
BOOK 26, PAGES 544-545

R=3524.75'
L=398.75'
B=N86°55'38"E
D=398.54'

R=3500.00'
L=395.95'
B=N86°55'38"E
D=395.74'

R=3475.25'
L=393.15'
B=N86°55'38"E
D=392.94'

MERVIN COMES
BOOK 22, PAGE 234

JILL JESSO WHITE
& DALE WHITE
BOOK 22, PAGE 285

STOP AHEAD SIGN
MILE MARKER
1250 0108 0540

EVERETT BETTIS
& PAMELA BETTIS
BOOK 25, PAGE 1
BOOK 16, PAGE 192

PETER J. COLLINS &
DARLENE M. PETERS
BOOK 23, PAGE 95
BOOK 23, PAGE 101

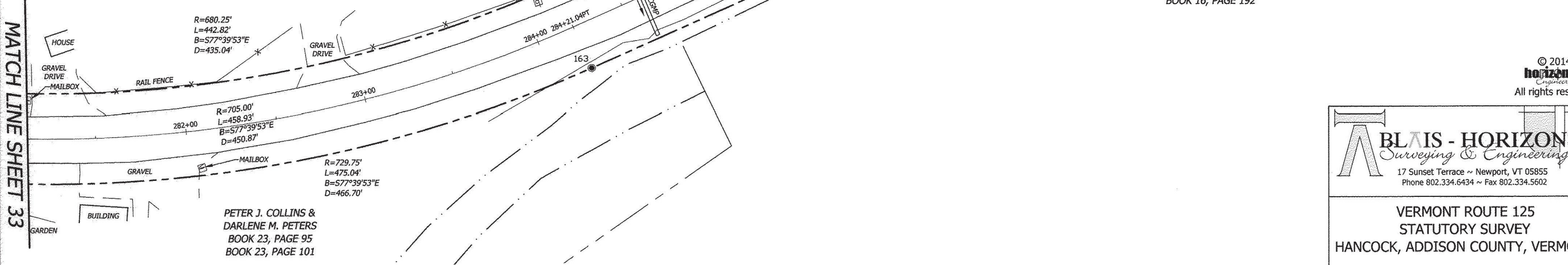

© 2014
BLAIS - HORIZONS
Engineering
All rights reserved

BLAIS - HORIZONS
Surveying & Engineering
17 Sunset Terrace ~ Newport, VT 05855
Phone 802.334.6434 ~ Fax 802.334.5602

VERMONT ROUTE 125
STATUTORY SURVEY
HANCOCK, ADDISON COUNTY, VERMONT

PREPARED FOR

VERMONT AGENCY OF
TRANSPORTATION
1 NATIONAL LIFE DRIVE
MONTPELIER, VT 05633-5001

MONUMENT DETAIL TABLE

PT.	NORTHING	EASTING	BASELINE OFFSET	DESCRIPTION
108	520220.88	1541404.21	284+21.04 24.75 L	FENO MARKER FLUSH WITH GRADE
109	520254.78	1541710.56	287+29.25 24.75 L	FENO MARKER FLUSH WITH GRADE
162	520213.41	1541718.99	287+33.10 17.29 R	5/8-INCH REBAR 0.2' AG
163	520171.68	1541409.66	284+21.04 24.75 R	5/8-INCH REBAR FLUSH WITH GRADE



Nathan P. Nadeau
NATHAN P. NADEAU, LS
DATE: 7/24/2014

I CERTIFY THAT THIS IS A CORRECT SURVEY TO THE BEST OF MY KNOWLEDGE BASED UPON AN EDM TOTAL STATION AND GPS FIELD SURVEY AND TOWN OF HANCOCK AND REFERENCED LAND AND HIGHWAY RECORDS. THIS PLAT MEETS THE REQUIREMENTS OF 27 VSA SECTION 1403.

	DATE:	7-23-2014	SCALE:	1IN. = 40FT.
	SURV'D BY:	DR/JB/JN	DRAWN BY:	NPN/AJN
	CHECK'D BY:	NPN/AJN	PROJECT #:	12568
	SHEET 34 OF 45			

BLAIS-HORIZONS CERTIFIES THAT THIS DRAWING WAS PRODUCED AS AN ORIGINAL INK ON MYLAR