

MONUMENT DETAIL TABLE

PT.	NORTHING	EASTING	BASELINE OFFSET	DESCRIPTION
54	519901.73	1525842.02	123+85.71 66.00 L	FENO MARKER 1.3' AG
55	519911.88	1526051.97	125+95.90 66.00 L	5/8-INCH REBAR 1.5' AG
56	519927.42	1526179.88	127+34.44 66.00 L	5/8-INCH REBAR 1.0' AG
217	519780.04	1526058.35	125+95.90 66.00 R	5/8-INCH REBAR 1.0' AG
218	519770.53	1525861.88	123+99.21 66.00 R	FENO MARKER FLUSH WITH GRADE
219	519729.57	1525793.20	123+33.40 104.91 R	5/8-INCH REBAR 1.0' AG
220	519752.80	1525834.96	123+72.43 82.50 R	5/8-INCH REBAR 0.8' AG
221	519768.47	1525793.09	123+33.40 66.00 R	5/8-INCH REBAR 1.0' AG

GREEN MOUNTAIN  
NATIONAL FOREST  
SEE SPECIAL USE PERMIT  
JUNE 8, 1956

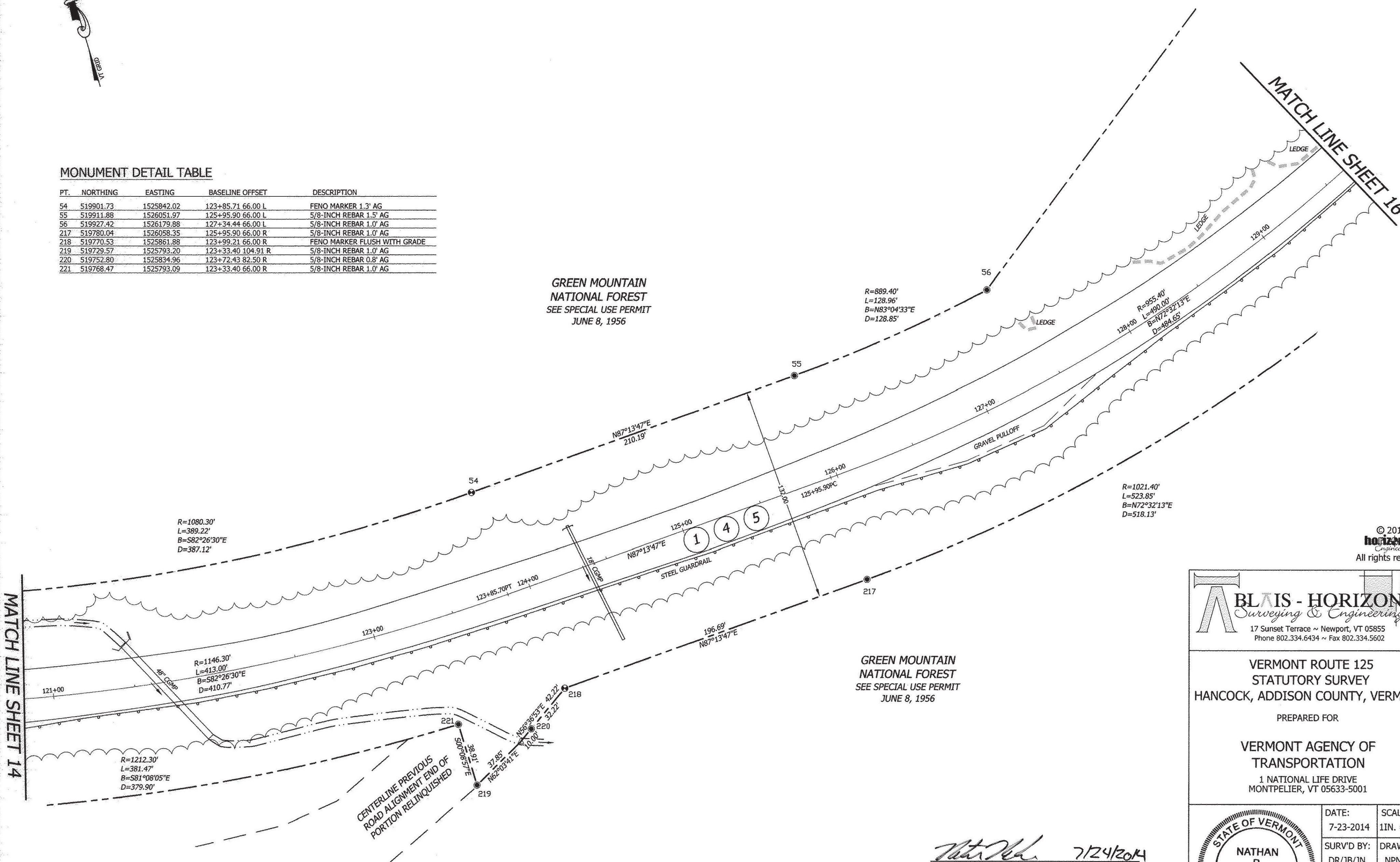

© 2014  
horizons  
Engineering  
All rights reserved

**BLAIS - HORIZONS**  
Surveying & Engineering  
17 Sunset Terrace ~ Newport, VT 05855  
Phone 802.334.6434 ~ Fax 802.334.5602

VERMONT ROUTE 125  
STATUTORY SURVEY  
HANCOCK, ADDISON COUNTY, VERMONT

PREPARED FOR

VERMONT AGENCY OF  
TRANSPORTATION  
1 NATIONAL LIFE DRIVE  
MONTPELIER, VT 05633-5001

	DATE: 7-23-2014	SCALE 1IN. = 40FT.
	SURV'D BY: DR/JB/JN	DRAWN BY: NPN/AJN
	CHECK'D BY: NPN/AJN	PROJECT #: 12568

*Nathan P. Nadeau*  
NATHAN P. NADEAU, LS DATE 7/24/2014

I CERTIFY THAT THIS IS A CORRECT SURVEY TO THE BEST OF MY KNOWLEDGE BASED UPON AN EDM TOTAL STATION AND GPS FIELD SURVEY AND TOWN OF HANCOCK AND REFERENCED LAND AND HIGHWAY RECORDS. THIS PLAT MEETS THE REQUIREMENTS OF 27 VSA SECTION 1403.



BLAIS-HORIZONS CERTIFIES THAT THIS DRAWING WAS PRODUCED AS AN ORIGINAL INK ON MYLAR

SIGNATURE

MATCH LINE SHEET 14

MATCH LINE SHEET 16

CENTERLINE PREVIOUS ROAD ALIGNMENT END OF PORTION RELINQUISHED