

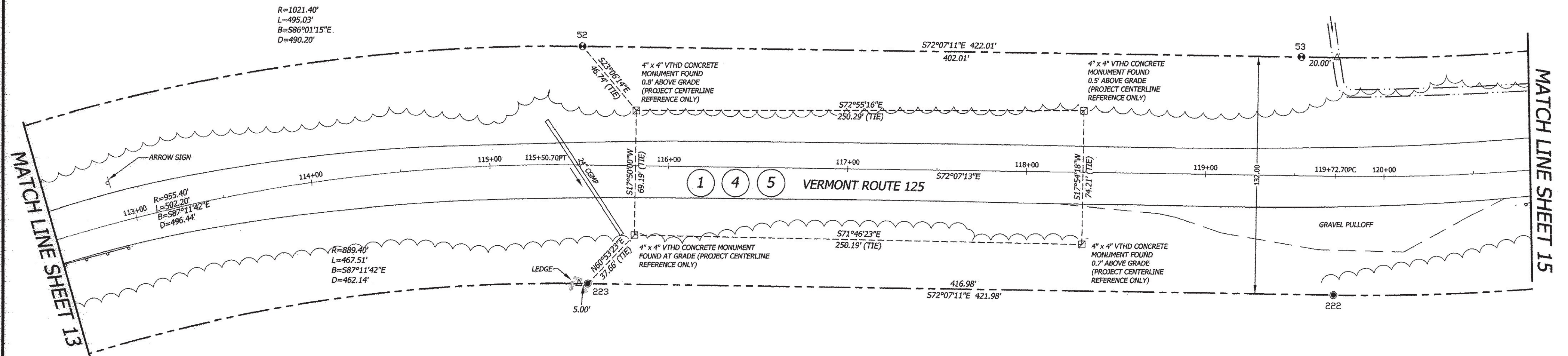

GREEN MOUNTAIN  
NATIONAL FOREST  
SEE SPECIAL USE PERMIT  
JUNE 8, 1956



GREEN MOUNTAIN  
NATIONAL FOREST  
SEE SPECIAL USE PERMIT  
JUNE 8, 1956

© 2014  
**BLAIS - HORIZONS**  
Engineering  
All rights reserved

**BLAIS - HORIZONS**  
Surveying & Engineering  
17 Sunset Terrace ~ Newport, VT 05855  
Phone 802.334.6434 ~ Fax 802.334.5602

VERMONT ROUTE 125  
STATUTORY SURVEY  
HANCOCK, ADDISON COUNTY, VERMONT  
PREPARED FOR  
VERMONT AGENCY OF  
TRANSPORTATION  
1 NATIONAL LIFE DRIVE  
MONTPELIER, VT 05633-5001

MONUMENT DETAIL TABLE

PT.	NORTHING	EASTING	BASELINE OFFSET	DESCRIPTION
52	520082.21	1525056.63	115+50.70 66.00 L	FENO MARKER 1.0' AG
53	519958.78	1525439.23	119+52.70 65.99 L	FENO MARKER 1.0' AG
222	519827.02	1525417.74	119+72.70 66.00 R	5/8-INCH REBAR 0.5' AG
223	519955.03	1525020.87	115+55.70 66.02 R	5/8-INCH REBAR 0.5' AG



*Nathan P. Nadeau* 7/24/2014  
NATHAN P. NADEAU, LS DATE

I CERTIFY THAT THIS IS A CORRECT SURVEY TO THE BEST OF MY KNOWLEDGE BASED UPON AN EDM TOTAL STATION AND GPS FIELD SURVEY AND TOWN OF HANCOCK AND REFERENCED LAND AND HIGHWAY RECORDS. THIS PLAT MEETS THE REQUIREMENTS OF 27 VSA SECTION 1403.

	DATE:	7-23-2014	SCALE:	1IN. = 40FT.
	SURV'D BY:	DR/JB/JN	DRAWN BY:	NPN/AJN
	CHECK'D BY:	NPN/AJN	PROJECT #:	12568
	SHEET 14 OF 45			

BLAIS-HORIZONS CERTIFIES THAT THIS DRAWING WAS PRODUCED AS AN ORIGINAL LINK ON MYLAR

SIGNATURE