

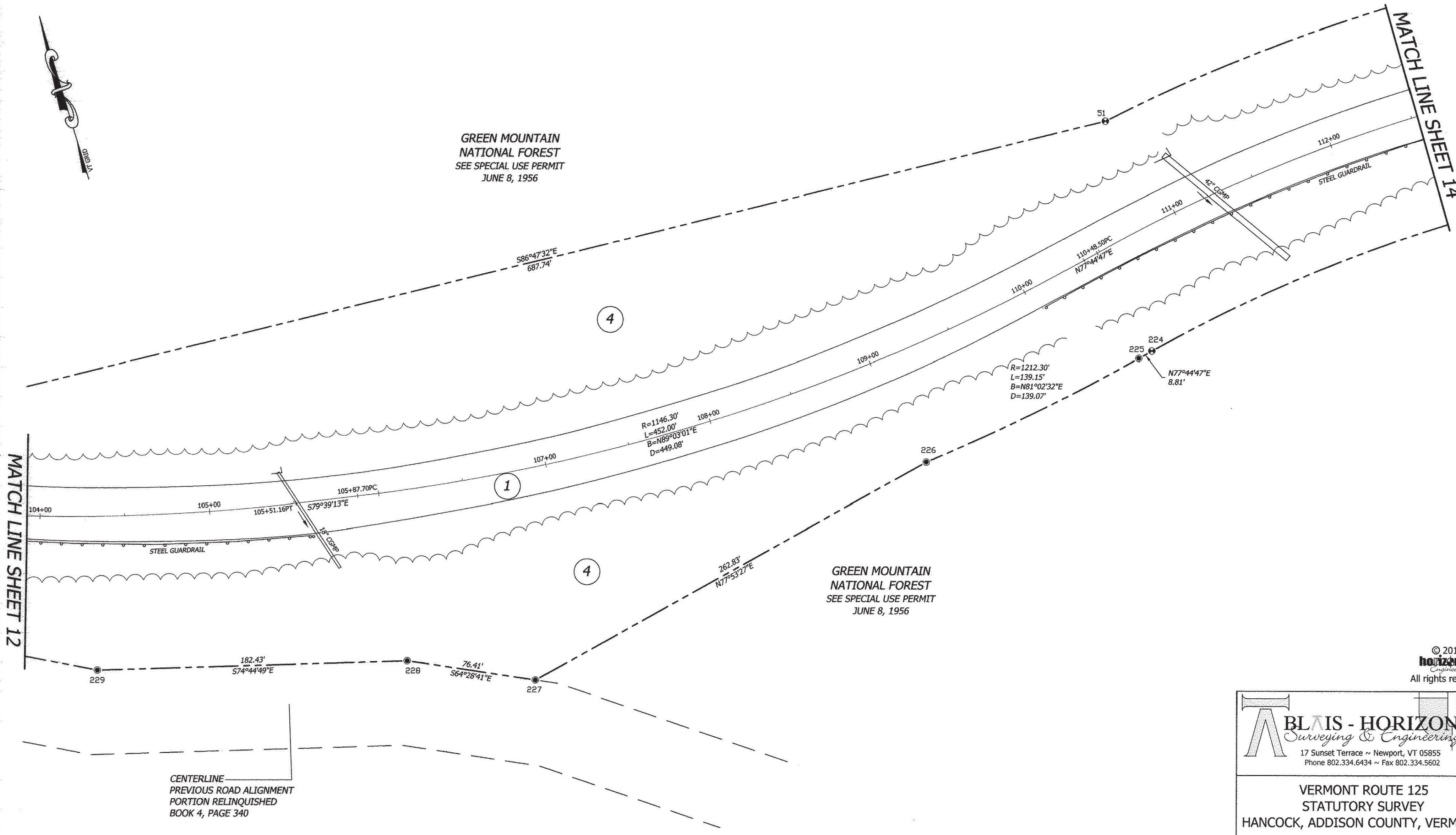

GREEN MOUNTAIN  
NATIONAL FOREST  
SEE SPECIAL USE PERMIT  
JUNE 8, 1956

MATCH LINE SHEET 14

MATCH LINE SHEET 12



CENTERLINE  
PREVIOUS ROAD ALIGNMENT  
PORTION RELINQUISHED  
BOOK 4, PAGE 340

MIDDLEBURY COLLEGE  
SEE PROJECT PLANS  
HIGHWAY PROJECT HANCOCK ST.187(N)

GREEN MOUNTAIN  
NATIONAL FOREST  
SEE SPECIAL USE PERMIT  
JUNE 8, 1956

© 2014  
horizons  
Engineering  
All rights reserved

**BLAIS - HORIZONS**  
Surveying & Engineering  
17 Sunset Terrace ~ Newport, VT 05855  
Phone 802.334.6434 ~ Fax 802.334.5602

VERMONT ROUTE 125  
STATUTORY SURVEY  
HANCOCK, ADDISON COUNTY, VERMONT

PREPARED FOR  
VERMONT AGENCY OF  
TRANSPORTATION  
1 NATIONAL LIFE DRIVE  
MONTPELIER, VT 05633-5001

MONUMENT DETAIL TABLE

PT.	NORTHING	EASTING	BASELINE OFFSET	DESCRIPTION
51	520116.23	1524567.61	110+87.66 66.00 L	FENO MARKER 0.5' AG
224	519979.19	1524554.55	110+48.50 66.00 R	FENO MARKER 0.2' AG
225	519977.32	1524545.94	110+39.70 66.00 R	5/8-INCH REBAR 0.7' AG
226	519955.67	1524408.56	109+08.13 66.00 R	5/8-INCH REBAR 0.7' AG
227	519900.53	1524151.58	106+70.50 122.65 R	5/8-INCH REBAR 0.8' AG
228	519933.46	1524082.63	106+04.11 99.46 R	5/8-INCH REBAR 0.8' AG
229	519981.45	1523906.62	104+32.87 90.31 R	5/8-INCH REBAR 0.8' AG



*Nathan P. Nadeau*  
NATHAN P. NADEAU, LS DATE 7/24/2014

I CERTIFY THAT THIS IS A CORRECT SURVEY TO THE BEST OF MY KNOWLEDGE BASED UPON AN EDM TOTAL STATION AND GPS FIELD SURVEY AND TOWN OF HANCOCK AND REFERENCED LAND AND HIGHWAY RECORDS. THIS PLAT MEETS THE REQUIREMENTS OF 27 VSA SECTION 1403.

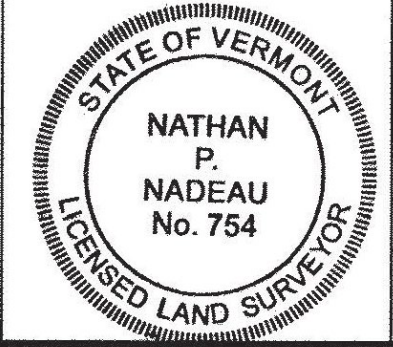

DATE: 7-23-2014	SCALE 1IN. = 40FT.
SURV'D BY: DR/JB/JN	DRAWN BY: NPN/AJN
CHECK'D BY: NPN/AJN	PROJECT #: 12568
SHEET 13 OF 45	

BLAIS-HORIZONS CERTIFIES THAT THIS DRAWING WAS PRODUCED AS AN ORIGINAL INK ON MYLAR

SIGNATURE