

END PROJECT ST. 187(M)
BEGIN PROJECT ST. 187(N)

BEGIN SPECIAL USE PERMIT
(BOUNDARY REFERENCE 3).

GREEN MOUNTAIN NATIONAL FOREST
SEE SPECIAL USE PERMIT
JUNE 8, 1956

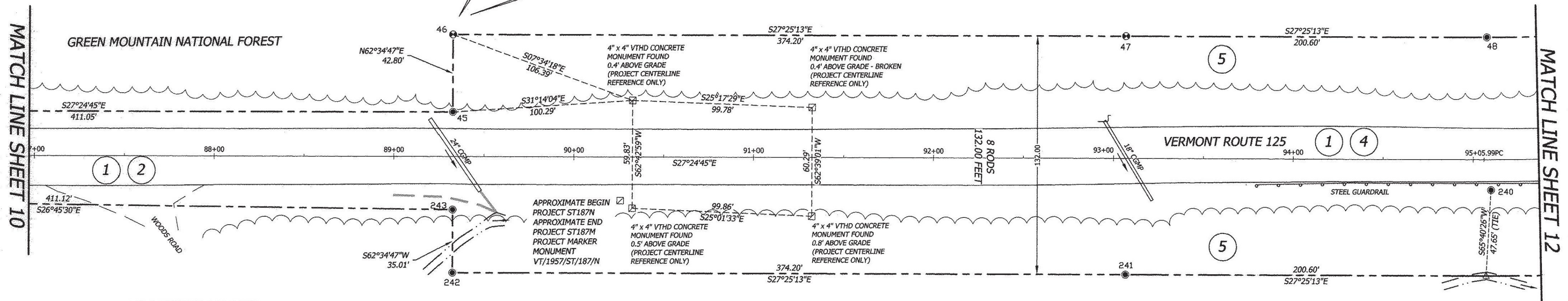

MIDDLEBURY COLLEGE
SEE CORPORATION DEED
BOOK 15, PAGE 299
HIGHWAY PROJECT HANCOCK ST. 187(M)

MIDDLEBURY COLLEGE
SEE PROJECT PLANS
HIGHWAY PROJECT HANCOCK ST.187(N)

© 2014
horizons
Engineering
All rights reserved

BLAIS - HORIZONS
Surveying & Engineering
17 Sunset Terrace ~ Newport, VT 05855
Phone 802.334.6434 ~ Fax 802.334.5602

VERMONT ROUTE 125
STATUTORY SURVEY
HANCOCK, ADDISON COUNTY, VERMONT

PREPARED FOR
VERMONT AGENCY OF
TRANSPORTATION
1 NATIONAL LIFE DRIVE
MONTPELIER, VT 05633-5001

	DATE: 7-23-2014	SCALE: 1IN. = 40FT.
	SURV'D BY: DR/JB/JN	DRAWN BY: NPN/AJN
	CHECK'D BY: NPN/AJN	PROJECT #: 12568
	SHEET 11 OF 45	

MONUMENT DETAIL TABLE

PT.	NORTHING	EASTING	BASELINE OFFSET	DESCRIPTION
45	521161.25	1522993.25	89+32.60 24.75 L	5/8-INCH REBAR 0.7' AG
46	521180.96	1523031.24	89+32.60 67.55 L	FENO MARKER 1.0' AG
47	520848.80	1523203.56	93+06.80 67.60 L	FENO MARKER 1.0' AG
48	520670.74	1523295.94	95+07.48 67.62 L	5/8-INCH REBAR 0.8' AG
240	520629.59	1523222.20	95+09.92 16.79 R	5/8-INCH REBAR 0.3' AG
241	520788.01	1523086.39	93+06.81 64.40 R	5/8-INCH REBAR 0.8' AG
242	521120.17	1522914.07	89+32.61 64.45 R	5/8-INCH REBAR 0.8' AG
243	521136.30	1522945.15	89+32.61 29.44 R	5/8-INCH REBAR 1.0' AG



Nathan P. Nadeau
NATHAN P. NADEAU, LS
DATE: 7/24/2014

I CERTIFY THAT THIS IS A CORRECT SURVEY TO THE BEST OF MY KNOWLEDGE BASED UPON AN EDM TOTAL STATION AND GPS FIELD SURVEY AND TOWN OF HANCOCK AND REFERENCED LAND AND HIGHWAY RECORDS. THIS PLAT MEETS THE REQUIREMENTS OF 27 VSA SECTION 1403.

BLAIS-HORIZONS CERTIFIES THAT THIS DRAWING WAS PRODUCED AS AN ORIGINAL LINK ON MYLAR

SIGNATURE