

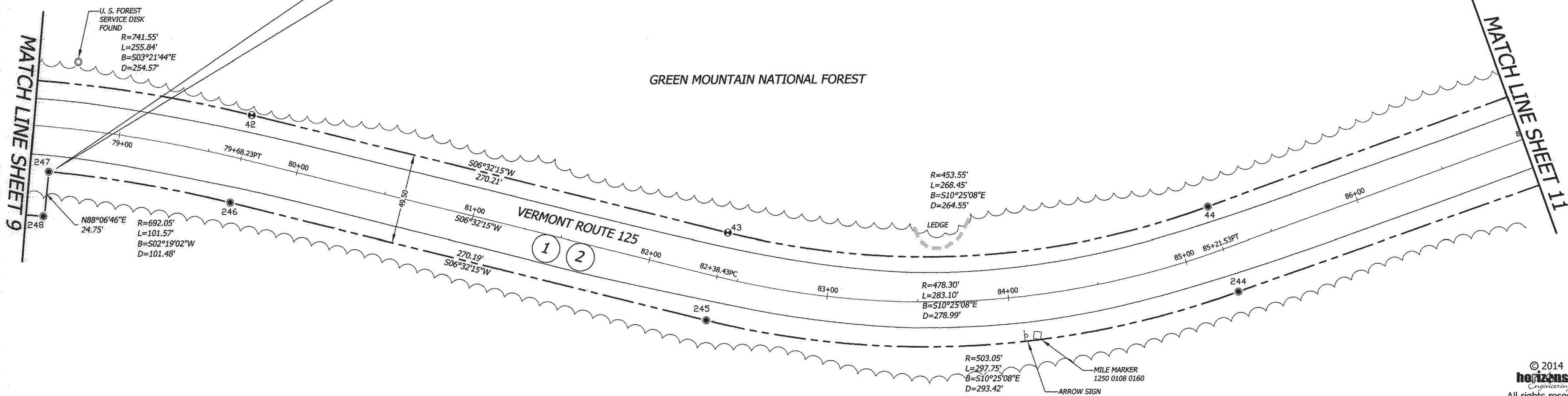

END RIGHT-OF-WAY DEFINED BY DEED TO MIDDLEBURY COLLEGE IN BOOK 15, PAGE 299 (REFERENCE 4). SOUTH OF ROADWAY



GREEN MOUNTAIN NATIONAL FOREST

VERMONT ROUTE 125

MIDDLEBURY COLLEGE
SEE CORPORATION DEED
BOOK 15, PAGE 299
HIGHWAY PROJECT HANCOCK ST. 187(M)

© 2014
horizons
All rights reserved

BLAIS - HORIZONS
Surveying & Engineering
17 Sunset Terrace ~ Newport, VT 05855
Phone 802.334.6434 ~ Fax 802.334.5602

VERMONT ROUTE 125
STATUTORY SURVEY
HANCOCK, ADDISON COUNTY, VERMONT

PREPARED FOR

VERMONT AGENCY OF
TRANSPORTATION
1 NATIONAL LIFE DRIVE
MONTPELIER, VT 05633-5001

	DATE:	SCALE:
	7-23-2014	1IN. = 40FT.
	SURV'D BY:	DRAWN BY:
	DR/JB/JN	NPN/AJN
CHECK'D BY:	PROJECT #:	
NPN/AJN	12568	
SHEET 10 OF 45		

Nathan P. Nadeau 7/24/2014
NATHAN P. NADEAU, LS DATE

I CERTIFY THAT THIS IS A CORRECT SURVEY TO THE BEST OF MY KNOWLEDGE BASED UPON AN EDM TOTAL STATION AND GPS FIELD SURVEY AND TOWN OF HANCOCK AND REFERENCED LAND AND HIGHWAY RECORDS. THIS PLAN MEETS THE REQUIREMENTS OF 27 VSA SECTION 1403.



MONUMENT DETAIL TABLE

PT.	NORTHING	EASTING	BASELINE OFFSET	DESCRIPTION
42	522054.79	1522786.92	79+68.23 24.75 L	FENO MARKER 1.3' AG
43	521786.34	1522756.17	82+38.43 24.74 L	FENO MARKER 0.8' AG
44	521526.15	1522804.01	85+21.55 24.75 L	5/8-INCH REBAR 0.5' AG
244	521503.39	1522760.05	85+21.53 24.75 R	5/8-INCH REBAR 1.0' AG
245	521791.97	1522706.99	82+38.43 24.75 R	5/8-INCH REBAR 0.5' AG
246	522060.41	1522737.75	79+68.24 24.75 R	5/8-INCH REBAR 1.0' AG
247	522161.80	1522741.85	78+63.03 24.75 R	5/8-INCH REBAR 0.7' AG
248	522160.99	1522717.12	78+63.03 49.50 R	5/8-INCH REBAR 1.0' AG

BLAIS-HORIZONS CERTIFIES THAT THIS DRAWING WAS PRODUCED AS AN ORIGINAL INK ON MYLAR

SIGNATURE