

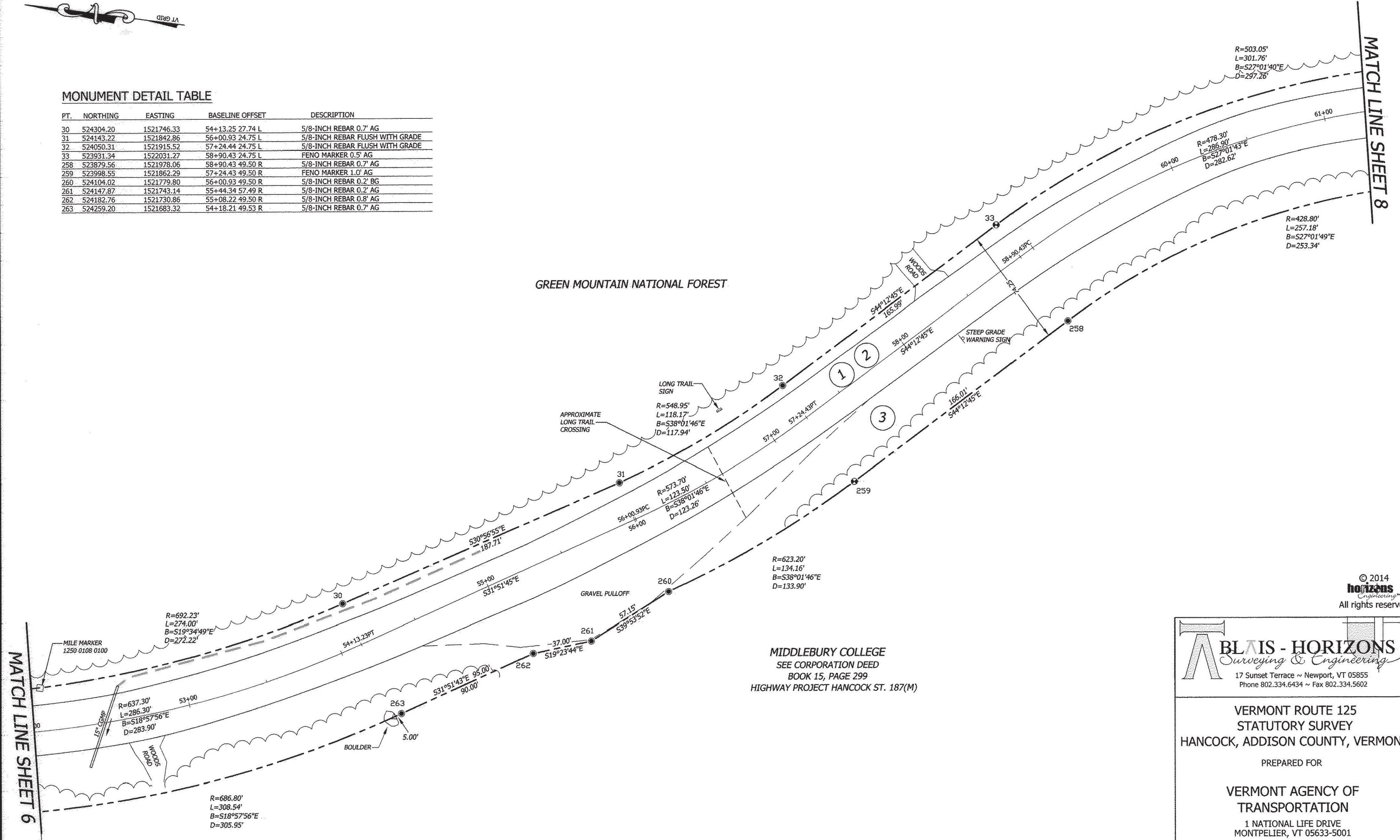

MONUMENT DETAIL TABLE

PT.	NORTHING	EASTING	BASELINE OFFSET	DESCRIPTION
30	524304.20	1521746.33	54+13.25 27.74 L	5/8-INCH REBAR 0.7' AG
31	524143.22	1521842.86	56+00.93 24.75 L	5/8-INCH REBAR FLUSH WITH GRADE
32	524050.31	1521915.52	57+24.44 24.75 L	5/8-INCH REBAR FLUSH WITH GRADE
33	523931.34	1522031.27	58+90.43 24.75 L	FENO MARKER 0.5' AG
258	523879.56	1521978.06	58+90.43 49.50 R	5/8-INCH REBAR 0.7' AG
259	523998.55	1521862.29	57+24.43 49.50 R	FENO MARKER 1.0' AG
260	524104.02	1521779.80	56+00.93 49.50 R	5/8-INCH REBAR 0.2' BG
261	524147.87	1521743.14	55+44.34 57.49 R	5/8-INCH REBAR 0.2' AG
262	524182.76	1521730.86	55+08.22 49.50 R	5/8-INCH REBAR 0.8' AG
263	524259.20	1521683.32	54+18.21 49.53 R	5/8-INCH REBAR 0.7' AG



© 2014
horizons
Engineering
All rights reserved

BLAIS - HORIZONS
Surveying & Engineering
17 Sunset Terrace • Newport, VT 05855
Phone 802.334.6434 • Fax 802.334.5602

VERMONT ROUTE 125
STATUTORY SURVEY
HANCOCK, ADDISON COUNTY, VERMONT
PREPARED FOR
VERMONT AGENCY OF
TRANSPORTATION
1 NATIONAL LIFE DRIVE
MONTPELIER, VT 05633-5001

DATE: 7-23-2014	SCALE 1IN. = 40FT.
SURV'D BY: DR/JB/JN	DRAWN BY: NPN/AJN
CHECK'D BY: NPN/AJN	PROJECT #: 12568

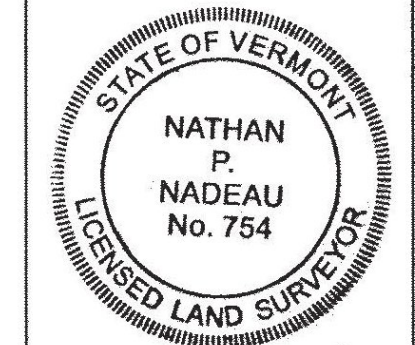

Nathan P. Nadeau 7/24/2014
NATHAN P. NADEAU, LS DATE

I CERTIFY THAT THIS IS A CORRECT SURVEY TO THE BEST OF MY KNOWLEDGE BASED UPON AN EDM TOTAL STATION AND GPS FIELD SURVEY AND TOWN OF HANCOCK AND REFERENCED LAND AND HIGHWAY RECORDS. THIS PLAT MEETS THE REQUIREMENTS OF 27 VSA SECTION 1403.



BLAIS-HORIZONS CERTIFIES THAT THIS DRAWING WAS PRODUCED AS AN ORIGINAL LINK ON MYLAR

SIGNATURE

MATCH LINE SHEET 6

MATCH LINE SHEET 8