

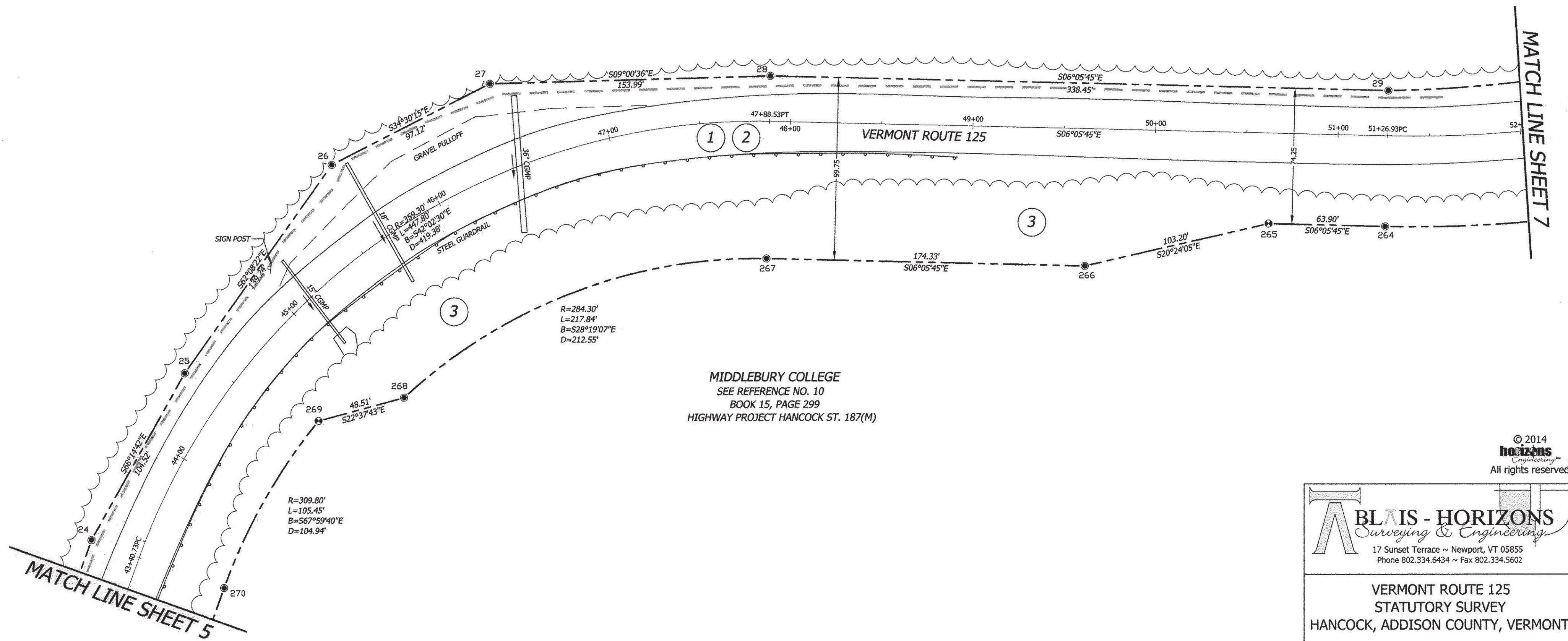

GREEN MOUNTAIN NATIONAL FOREST



MIDDLEBURY COLLEGE  
SEE REFERENCE NO. 10  
BOOK 15, PAGE 299  
HIGHWAY PROJECT HANCOCK ST. 187(M)

© 2014  
horizons  
Engineering  
All rights reserved

**BLAIS - HORIZONS**  
Surveying & Engineering  
17 Sunset Terrace ~ Newport, VT 05855  
Phone 802.334.6434 ~ Fax 802.334.5602

VERMONT ROUTE 125  
STATUTORY SURVEY  
HANCOCK, ADDISON COUNTY, VERMONT  
PREPARED FOR  
VERMONT AGENCY OF  
TRANSPORTATION  
1 NATIONAL LIFE DRIVE  
MONTPELIER, VT 05633-5001

	DATE: 7-23-2014	SCALE 1IN. = 40FT.
	SURV'D BY: DR/JB/JN	DRAWN BY: NPN/AJN
	CHECK'D BY: NPN/AJN	PROJECT #: 12568
	SHEET 6 OF 45	

*Nathan P. Nadeau*  
NATHAN P. NADEAU, LS  
DATE: 7/24/2014

I CERTIFY THAT THIS IS A CORRECT SURVEY TO THE BEST OF MY KNOWLEDGE BASED UPON AN EDM TOTAL STATION AND GPS FIELD SURVEY AND TOWN OF HANCOCK AND REFERENCED LAND AND HIGHWAY RECORDS. THIS PLAT MEETS THE REQUIREMENTS OF 27 VSA SECTION 1403.



MONUMENT DETAIL TABLE

PT.	NORTHING	EASTING	BASELINE OFFSET	DESCRIPTION
24	525233.15	1521319.85	43+40.96 27.84 L	5/8-INCH REBAR 0.7' AG
25	525194.41	1521416.93	44+38.60 24.75 L	5/8-INCH REBAR 0.7' AG
26	525129.34	1521540.03	45+63.58 49.21 L	5/8-INCH REBAR 1.3' AG
27	525049.31	1521595.04	46+49.35 47.73 L	5/8-INCH REBAR 0.3' AG
28	524897.22	1521619.16	47+88.53 24.75 L	5/8-INCH REBAR 1.0' AG
29	524560.68	1521655.10	51+26.93 24.75 L	5/8-INCH REBAR 0.7' AG
264	524552.80	1521581.27	51+26.93 49.50 R	5/8-INCH REBAR 1.0' AG
265	524616.34	1521574.49	50+63.03 49.50 R	FENO MARKER 0.7' AG
266	524713.06	1521538.51	49+63.03 75.00 R	5/8-INCH REBAR 0.7' AG
267	524886.41	1521520.00	47+88.70 75.00 R	5/8-INCH REBAR 0.7' AG
268	525073.53	1521419.17	45+13.03 75.00 R	5/8-INCH REBAR 1.0' AG
269	525118.30	1521400.50	44+63.03 49.50 R	FENO MARKER 0.5' AG
270	525157.62	1521303.21	43+40.73 49.50 R	5/8-INCH REBAR 0.5' AG

BLAIS-HORIZONS CERTIFIES THAT THIS DRAWING WAS PRODUCED AS AN ORIGINAL WORK ON MYLAR

SIGNATURE