

APPROXIMATE TOWN LINE

GREEN MOUNTAIN NATIONAL FOREST

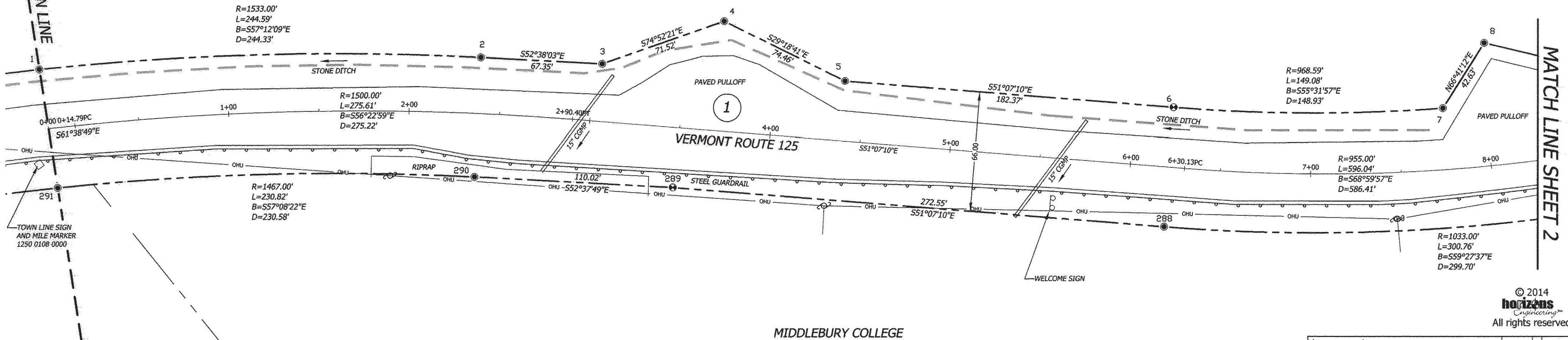

MATCH LINE SHEET 2

MIDDLEBURY COLLEGE

HANCOCK
RIPTON

GREEN MOUNTAIN NATIONAL FOREST

© 2014
horizons
Engineering
All rights reserved

BLAIS - HORIZONS
Surveying & Engineering
17 Sunset Terrace ~ Newport, VT 05855
Phone 802.334.6434 ~ Fax 802.334.5602

VERMONT ROUTE 125
STATUTORY SURVEY
HANCOCK, ADDISON COUNTY, VERMONT

PREPARED FOR
VERMONT AGENCY OF
TRANSPORTATION
1 NATIONAL LIFE DRIVE
MONTPELIER, VT 05633-5001

	DATE:	SCALE
	7-23-2014	1IN. = 40FT.
	SURV'D BY:	DRAWN BY:
	DR/JB/JN	NPN/AJN
CHECK'D BY:	PROJECT #:	
NPN/AJN	12568	
SHEET 1 OF 45		

Nathan P. Naudeau
NATHAN P. NADEAU, LS
DATE: 7/24/2014

I CERTIFY THAT THIS IS A CORRECT SURVEY TO THE BEST OF MY KNOWLEDGE BASED UPON AN EDM TOTAL STATION AND GPS FIELD SURVEY AND TOWN OF HANCOCK AND REFERENCED LAND AND HIGHWAY RECORDS. THIS PLAT MEETS THE REQUIREMENTS OF 27 VSA SECTION 1403.



MONUMENT DETAIL TABLE

PT.	NORTHING	EASTING	BASELINE OFFSET	DESCRIPTION
1	526406.37	1517491.99	-0+01.69 33.00 L	5/8-INCH REBAR 0.3' AG
2	526274.02	1517697.38	2+38.13 31.00 L	5/8-INCH REBAR 0.7' AG
3	526233.15	1517750.90	3+04.39 31.85 L	5/8-INCH REBAR 0.2' AG
4	526214.48	1517819.95	3+69.85 60.66 L	5/8-INCH REBAR 0.7' AG
5	526149.56	1517856.40	4+38.98 33.00 L	5/8-INCH REBAR 0.2' AG
6	526035.08	1517998.36	6+21.35 33.00 L	FENO MARKER 0.5' AG
7	525950.80	1518121.15	7+75.53 33.80 L	5/8-INCH REBAR 0.5' AG
8	525967.67	1518160.30	8+02.84 67.69 L	5/8-INCH REBAR 1.0' AG
288	525983.71	1517956.94	6+21.35 33.00 R	5/8-INCH REBAR 0.3' AG
289	526154.79	1517744.76	3+48.79 33.00 R	FENO MARKER 0.3' AG
290	526221.57	1517657.32	2+37.56 35.00 R	5/8-INCH REBAR 0.3' AG
291	526346.68	1517463.63	0+01.69 33.00 R	5/8-INCH REBAR 0.3' AG

BLAIS-HORIZONS CERTIFIES THAT THIS DRAWING WAS PRODUCED AS AN ORIGINAL INK ON MYLAR

SIGNATURE