

VERMONT ROUTE 125 STATUTORY SURVEY HANCOCK, ADDISON COUNTY, VERMONT

HANCOCK TOWN CLERK'S OFFICE
RECEIVED FOR RECORD
THIS DAY OF October A.D. 2014
AT 10 O'CLOCK AM MINUTES M
RECORDED IN HANCOCK PLAT RECORDS
IN VOLUME PAGE
ATTEST TOWN CLERK

LEGEND

- FENO TYPE SURVEY MARKER SET WITH 2" BRONZE CAP #754 (SEE DETAIL)
- 5/8-INCH IRON ROD (REBAR) SET WITH 2" ALUM. CAP #754 (SEE DETAIL)
- △ ROW POINT OF DEFLECTION (NOT MONUMENTED)
- EXISTING IRON PIPE OR ROD FOUND
- LIMITS OF VT ROUTE 125 RIGHT OF WAY
- ABUTTING PROPERTY LINE
- OHU --- OVERHEAD UTILITIES
- UTILITY POLE
- GUARDRAIL
- TREELINE
- STONE DITCH
- DITCHLINE
- STONEWALL
- LEDGE OUTCROP
- WIRE FENCE
- RAIL FENCE
- ① PARCEL ID (SEE SUMMARY OF RIGHT OF WAY)

NOTES

1. THE VERMONT AGENCY OF TRANSPORTATION AUTHORIZES THE SURVEY OF THE RIGHT OF WAYS, EASEMENTS, AND FEE TITLES ASSOCIATED WITH VERMONT ROUTE 125. THIS SURVEY WAS PERFORMED IN ACCORDANCE WITH 19 V.S.A §33 - SURVEY OF EXISTING HIGHWAYS; DAMAGES. A SURVEY REPORT HAS BEEN PREPARED AND IS ON FILE WITH THE AGENCY.
2. THIS PLAT DEPICTS A CONTINUOUS ROUTE SURVEY OF VERMONT ROUTE 125 FROM THE INTERSECTION OF VERMONT ROUTE 100 TO THE HANCOCK-RIPTON TOWN LINE.
3. THIS PLAT IS THE RESULT IN PART OF A FIELD SURVEY CONDUCTED BETWEEN OCTOBER, 2012 TO JANUARY, 2014 AND IN PART THE RESULT OF TOPOGRAPHIC INFORMATION PROVIDED BY THE AGENCY FROM PRIOR FIELD SURVEYS. EXISTING SURVEY CONTROL PROVIDED BY THE AGENCY WAS UTILIZED AND VERIFIED BY BLAIS-HORIZONS. FIELD LOCATION AND INSTALLATION OF MONUMENTS WAS COMPLETED BY ELECTRONIC TOTAL STATION SURVEY USING LOCATION-SPECIFIC SCALE FACTORS FOR GROUND TO GRID CONVERSION.
4. ALL BEARINGS AND DISTANCES SHOWN HEREON REFER TO THE VERMONT COORDINATE SYSTEM, NAD 83, US SURVEY FEET.
5. ABUTTING PROPERTY LINES WERE COMPILED FROM EXISTING PLANS OF RECORD AND PHYSICAL EVIDENCE FOUND, AND ARE INTENDED TO BE APPROXIMATE LOCATIONS NOT BASED ON A BOUNDARY RETRACEMENT SURVEY. ABUTTING LAND OWNER NAMES WERE TAKEN FROM TOWN OF HANCOCK RECORDS.
6. THE LIMITS OF VERMONT ROUTE 125 RIGHT OF WAY AS SHOWN HEREON ARE GENERALLY ESTABLISHED AS FOLLOWS:

FROM HANCOCK-RIPTON TOWN LINE TO APPROXIMATELY 1.7 MILES EASTERLY THEREOF: RIGHT OF WAY RETRACEMENT OF STATE OF VERMONT DEPARTMENT OF HIGHWAYS PROJECT HANCOCK ST. 187(M) (1956). SEE ALSO DEED OF MIDDLEBURY COLLEGE TO STATE OF VERMONT DATED AUGUST 8, 1957 AND RECORDED IN HANCOCK VOLUME 15 PAGE 299.

FROM 1.7 MILES EASTERLY OF TOWN LINE TO APPROXIMATELY 1.0 MILE EASTERLY THEREOF: RIGHT OF WAY RETRACEMENT OF STATE OF VERMONT DEPARTMENT OF HIGHWAYS PROJECT HANCOCK ST. 187(N) (1956). SEE ALSO "SPECIAL USE PERMIT" BETWEEN GREEN MOUNTAIN NATIONAL FOREST AND VERMONT HIGHWAY COMMISSION" DATED JUNE, 1956.

FROM 2.7 MILES EASTERLY OF TOWN LINE TO INTERSECTION WITH ROUTE 100: THE HISTORICAL SURVEY PLATS OF THIS ROAD, REFERENCED AS PROJECT ST. 187(L), WERE NOT RECOVERED. IN THE ABSENCE OF THESE PLANS, AND WITH THE INABILITY TO ACCURATELY DETERMINE THE HISTORIC LAYOUT OF VERMONT ROUTE 125 AS DEFINED IN OTHER DEEDS AND MAPS, THIS SECTION IS ESTABLISHED BY STATUTORY RESURVEY PER 19 V.S.A. §33.
7. THE HANCOCK-RIPTON TOWN LINE IS BASED ON PHYSICAL EVIDENCE ONLY (BLAZED TREES) AND NOT ON A TOWN LINE BOUNDARY RETRACEMENT.
8. NO UNDERGROUND UTILITIES WERE IDENTIFIED OR LOCATED.

PLAT REFERENCES

1. "PLAN AND PROFILE HANCOCK-MIDDLEBURY ROAD, HANCOCK, VT" DATED OCTOBER, 1918. CENTERLINE SURVEY OF VERMONT ROUTE 125, UNABLE TO ACCURATELY DETERMINE LOCATION.
2. "VERMONT DEPARTMENT OF HIGHWAYS PROJECT HANCOCK ST. 187(M) (1956)" PROVIDED BY VERMONT AGENCY OF TRANSPORTATION AND ON FILE AT TOWN OF HANCOCK.
3. "VERMONT DEPARTMENT OF HIGHWAYS PROJECT HANCOCK ST. 187(N) (1956)" PROVIDED BY VERMONT AGENCY OF TRANSPORTATION AND ON FILE AT TOWN OF HANCOCK.
4. "VERMONT DEPARTMENT OF HIGHWAYS PROJECT HANCOCK ST. 187(L)". THE "L-SERIES" PLANS WERE NOT RECOVERED DURING THE COURSE OF THIS SURVEY, AT EITHER THE TOWN OF HANCOCK OR OFFICES OF VERMONT AGENCY OF TRANSPORTATION.
5. "VERMONT DEPARTMENT OF HIGHWAYS PROJECT HANCOCK SA. 187(L)" (1956). THESE PLANS DEPICT A BRIDGE REPLACEMENT PROJECT OVER TUCKER BROOK.
6. "VERMONT AGENCY OF TRANSPORTATION PROJECT HANCOCK ER BR 0174(16)" DATED JULY, 2012. BRIDGE REPLACEMENT PROJECT OVER HANCOCK BRANCH.

BOUNDARY REFERENCES

1. "SURVEY OF ROAD FROM ROCHESTER TO RIPTON LINE" DATED OCTOBER 26, 1869 RECORDED IN HANCOCK VOLUME 2, PAGE 364. THIS HISTORIC CENTERLINE LAYOUT AND DESCRIPTION OF VERMONT ROUTE 125 IS UNABLE TO BE ACCURATELY DETERMINED ON THE GROUND.
2. NOTE: VERMONT ROUTE 125 WAS TAKEN INTO THE STATE HIGHWAY SYSTEM ON MARCH 28, 1935 BY ORDER OF THE STATE HIGHWAY BOARD.
3. "SPECIAL USE PERMIT GREEN MOUNTAIN NATIONAL FOREST TO STATE OF VERMONT HIGHWAY COMMISSION" DATED JUNE, 1956. THIS AGREEMENT COVERS 9,240 FEET OF ROADWAY THROUGH GREEN MOUNTAIN NATIONAL FOREST THROUGH HIGHWAY PROJECTS "N" AND "L" REFERENCED ABOVE, AND SPECIFIES A RIGHT OF WAY EXTENDING 66 FEET ON EACH SIDE OF THE CENTERLINE, EXCEPT WHERE IT IS NECESSARY BECAUSE OF TOPOGRAPHY TO EXTEND MORE THAN 66 FEET, IN WHICH THE REFERENCED PLANS WILL APPLY AS TO WIDTH.
4. DEED OF MIDDLEBURY COLLEGE TO STATE OF VERMONT, DATED AUGUST 8, 1957 AND RECORDED IN TOWN OF HANCOCK VOLUME 15 PAGE 299. THIS WARRANTY DEED CONVEYS CERTAIN PARCELS OF LAND IN CONJUNCTION WITH PROJECT ST. 187(M).

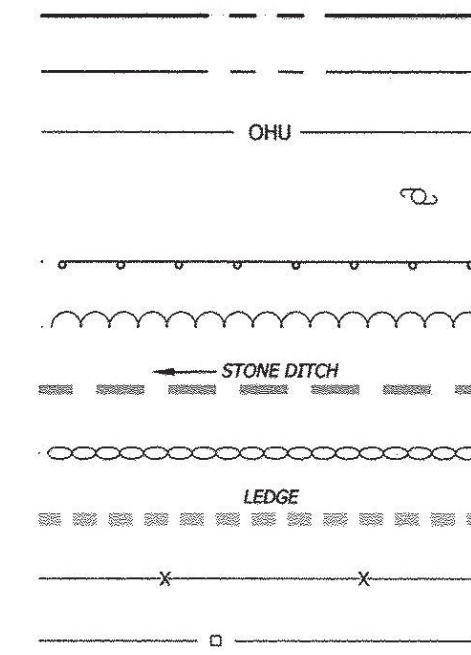

①

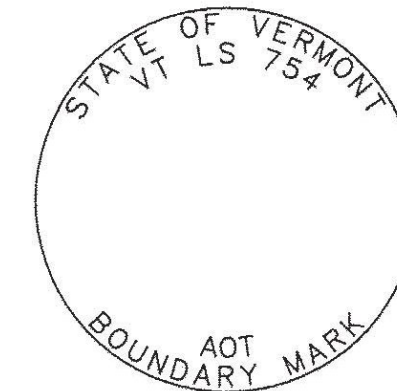

DETAIL OF SURVEY MARKER CAP

VERMONT AGENCY OF TRANSPORTATION	
APPROVED: <i>[Signature]</i> CHIEF OF RIGHT OF WAY DATE: <u>9/29/2014</u>	APPROVED: <i>[Signature]</i> CHIEF, PLANS AND TITLES DATE: <u>9/19/2014</u>

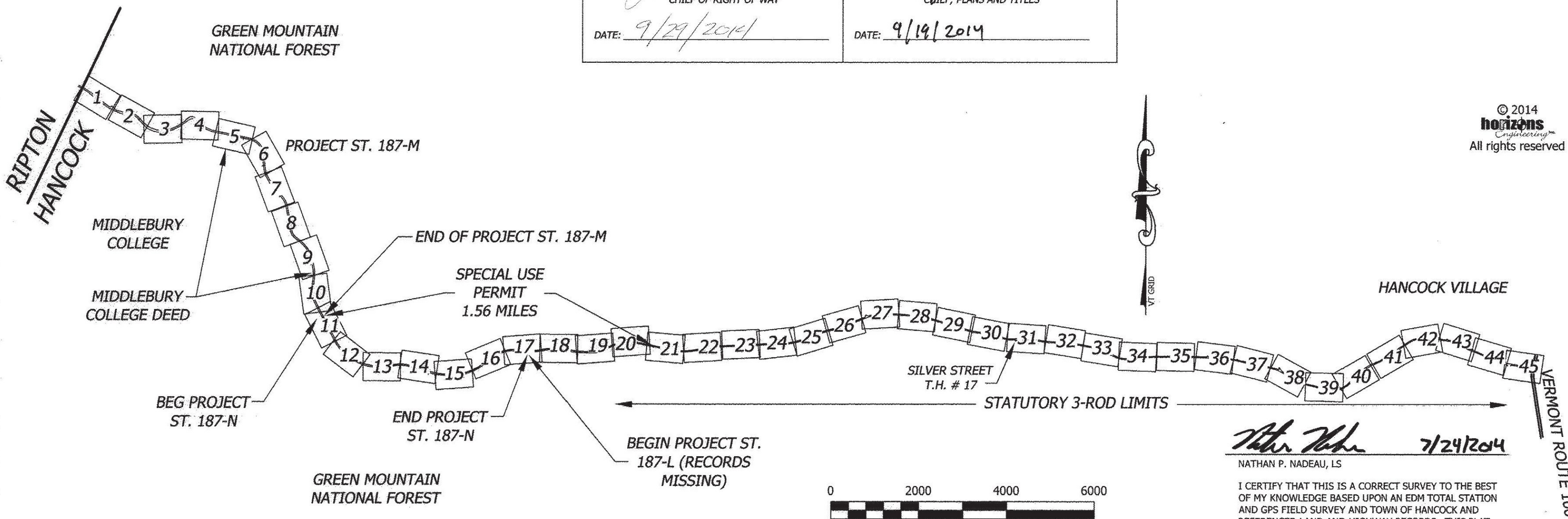

© 2014
horizons
Engineering
All rights reserved

BLAIS - HORIZONS
Surveying & Engineering
17 Sunset Terrace ~ Newport, VT 05855
Phone 802.334.6434 ~ Fax 802.334.5602

**VERMONT ROUTE 125
STATUTORY SURVEY
HANCOCK, ADDISON COUNTY, VERMONT**

PREPARED FOR
**VERMONT AGENCY OF
TRANSPORTATION**
1 NATIONAL LIFE DRIVE
MONTPELIER, VT 05633-5001

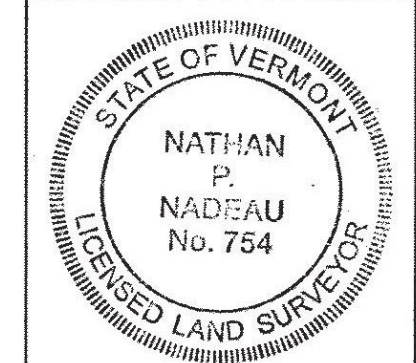

DATE: 7-23-2014	SCALE
SURV'D BY: DR/JB/JN	DRAWN BY: NPN/AJN
CHECK'D BY: NPN/AJN	PROJECT #: 12568

[Signature] 7/24/2014
NATHAN P. NADEAU, LS
I CERTIFY THAT THIS IS A CORRECT SURVEY TO THE BEST OF MY KNOWLEDGE BASED UPON AN EDM TOTAL STATION AND GPS FIELD SURVEY AND TOWN OF HANCOCK AND REFERENCED LAND AND HIGHWAY RECORDS. THIS PLAT MEETS THE REQUIREMENTS OF 27 VSA SECTION 1403.

BLAIS-HORIZONS CERTIFIES THAT THIS DRAWING WAS PRODUCED AS AN ORIGINAL INK ON MYLAR

[Signature]
SIGNATURE