

N/F  
 RICHARD H. LASHOONES,  
 DIANNE C. LASHOONES  
 & DOROTHY E. DAY  
 BK. 86, PG. 295  
 JULY 9, 2010  
 BR #52

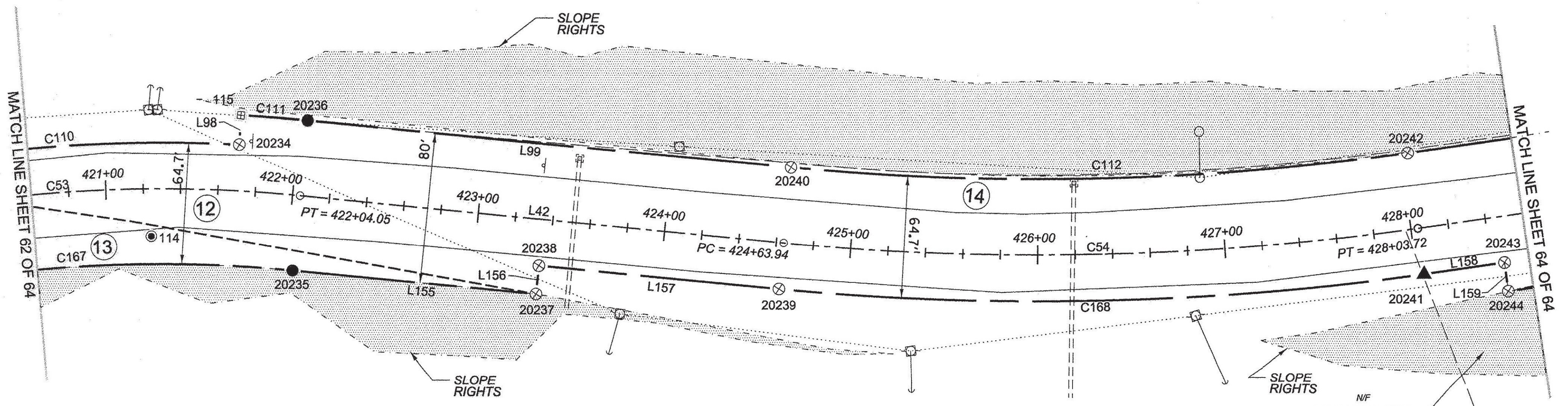

N/F  
 RICHARD A. DIMATTEO  
 & VINCENT G. DIMATTEO  
 BK. 74, PG. 134  
 FEB. 20, 2006  
 BR #54

N/F  
 SHARON L. KAIS  
 BK. 71, PG. 474  
 JUNE 08, 2005  
 BR #54

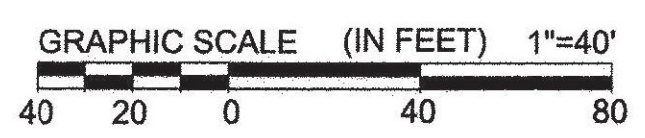

LEGEND:  
 SEE SHEET 1 OF 64

NOTES:  
 SEE SHEETS 2 & 3 OF 64

MONUMENT TABLE:  
 SEE SHEETS 6, 7, 8 OF 64

ROW CENTER LINE TABLE:  
 SEE SHEET 8 OF 64

ROW LIMIT LINE & CURVE TABLES:  
 SEE SHEET 9 OF 64

I CERTIFY THAT THIS PLAT IS BASED ON INFORMATION ABSTRACTED FROM DOCUMENTS, PAROL EVIDENCE, AND PHYSICAL EVIDENCE. THE SURVEY WORK IDENTIFIED HEREON IS CONSISTENT WITH THIS INFORMATION.

I CERTIFY THAT THIS PLAT MEETS THE REQUIREMENTS OF 27 VSA SECTION 1403 AND COMPLIES WITH VERMONT BOARD OF LAND SURVEYORS RULES, PART 5.4 AND 5.5 ADOPTED UNDER 26 VS SECTION 2344(A).

SIGNED: *Timothy A. Patch*  
 TIMOTHY A. PATCH, L.S. 680

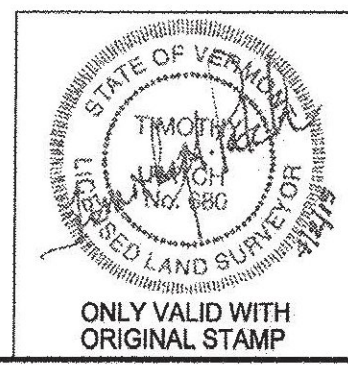

<b>STATE OF VERMONT AGENCY OF TRANSPORTATION</b>		SURVEYED: SJC ENGINEERING
<b>STATUTORY SURVEY</b> TOWN OF MARSHFIELD		REVIEWED: TAP
<b>VERMONT US ROUTE 2</b> APPROXIMATELY FROM PLAINFIELD TOWN LINE TO CABOT TOWN LINE		DATE: 04/01/2015
		SCALE: 1"=40'
FILE: z122600ROW.DGN		SHEET NO. 63 OF 64

