

N/F
**DAVID A. COUTU
 & JANIE L. COUTU**
 BK. 45, PG. 311
 MAY 12, 1994
 BR #20

N/F
**ALFRED J. O'ROWKE
 BETTY J. O'ROURKE**
 BK. 77, PG. 7
 JAN. 25, 2007
 BR #20 & #21

N/F
MEADOWCREST CAMPGROUND, LLC
 BK. 87, PG. 300
 NOV. 17, 2010
 BR #22

N/F
**EDWARD D. BURKART, JR.
 ROBERT D. BURKART
 & DARLENE DEVINCENZI**
 BK. 69, PG. 59
 AUG. 28, 2004
 BR #22

PATTY'S CROSSING T. H. #38
 VOLUME 2, PAGE 170 NOVEMBER 4, 1944 2 RODS
 VOLUME 3, PAGE 57A MAY 27, 1948 2 1/2 RODS
 APPARENTLY ALTERS VOLUME 2, PAGE 170

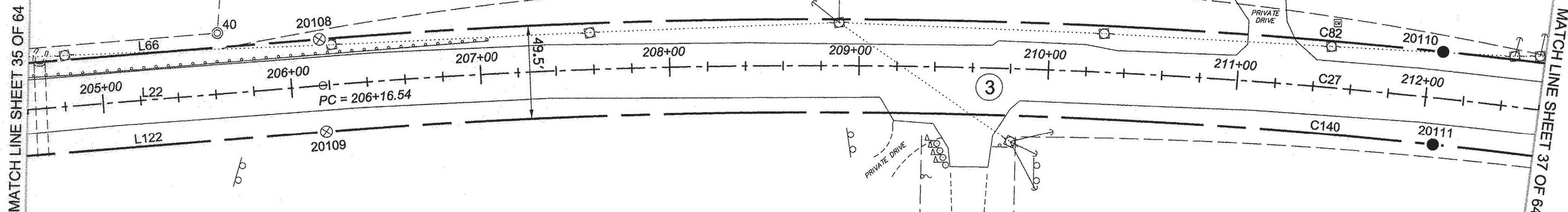

ORIGINAL DRAWING - INK ON POLYESTER FILM MEETING THE REQUIREMENTS OF 27 V.S.A. § 1403

PIN ID # 12X600

RECEIVED
 APR 28 2015
 MARSHFIELD, VERMONT
 TOWN CLERK'S OFFICE

LEGEND:
 SEE SHEET 1 OF 64

NOTES:
 SEE SHEETS 2 & 3 OF 64

MONUMENT TABLE:
 SEE SHEETS 6,7,8 OF 64

ROW CENTER LINE TABLE:
 SEE SHEET 8 OF 64

ROW LIMIT LINE & CURVE TABLES:
 SEE SHEET 9 OF 64

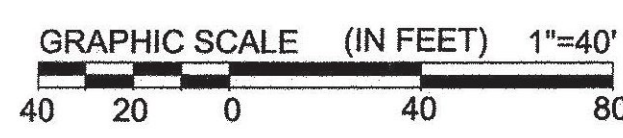

I CERTIFY THAT THIS PLAT IS BASED ON INFORMATION ABSTRACTED FROM DOCUMENTS, PAROL EVIDENCE, AND PHYSICAL EVIDENCE. THE SURVEY WORK IDENTIFIED HEREON IS CONSISTENT WITH THIS INFORMATION.

I CERTIFY THAT THIS PLAT MEETS THE REQUIREMENTS OF 27 VSA SECTION 1403 AND COMPLIES WITH VERMONT BOARD OF LAND SURVEYORS RULES, PART 5.4 AND 5.5 ADOPTED UNDER 26 VSA SECTION 2544(A).

SIGNED: *Timothy A. Patch*
 TIMOTHY A. PATCH, L.S. 680

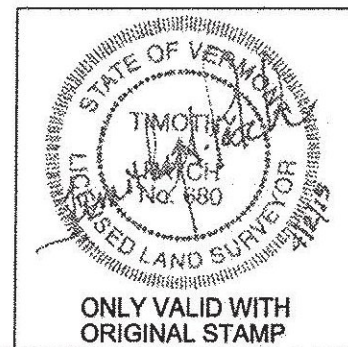

STATE OF VERMONT AGENCY OF TRANSPORTATION		SURVEYED: SCS ENGINEERING
STATUTORY SURVEY		REVIEWED: TAP
TOWN OF MARSHFIELD		DATE: 04/01/2015
VERMONT US ROUTE 2		SCALE: 1"=40'
APPROXIMATELY FROM PLAINFIELD TOWN LINE TO CABOT TOWN LINE		FILE: 212600ROW.DGN
		SHEET NO. 36 OF 64



ONLY VALID WITH ORIGINAL STAMP