

GPS CONTROL POINTS

DANBY CORS ARP

PID DL2318
 N = 310162.23
 E = 1508688.83
 ELLIP HEIGHT = 636.36

STATION IS A GPS CONTINUOUSLY OPERATING REFERENCE STATION. STATION IS THE ANTENNA REFERENCE POINT OF THE GPS ANTENNA. LOCATED AT THE CURRIER MEMORIAL SCHOOL IN DANBY, VERMONT. THE MONUMENT IS ATTACHED TO A TWO STORY CONCRETE/BRICK BUILDING WITH AN 8 FT CONCRETE FOUNDATION BUILT IN 1966. MAST IS A 1.75 INCH DIA GALV. PIPE THAT IS 108 INCHES LONG. THE MAST ATTACHED TO A STEEL MOUNTING FRAME WITH THREE ATTACHMENTS CONSISTING OF 3/8 INCH SS THROUGH BOLTS. THE MOUNTING FRAME IS ATTACHED TO THE BUILDING USING 8 ATTACHMENT POINTS. ALL 8 ATTACHMENTS ARE THROUGH BOLTED AND CONSIST OF 1/2 INCH SS THREADED ROD AND NUTS.

TRAVERSE TIES

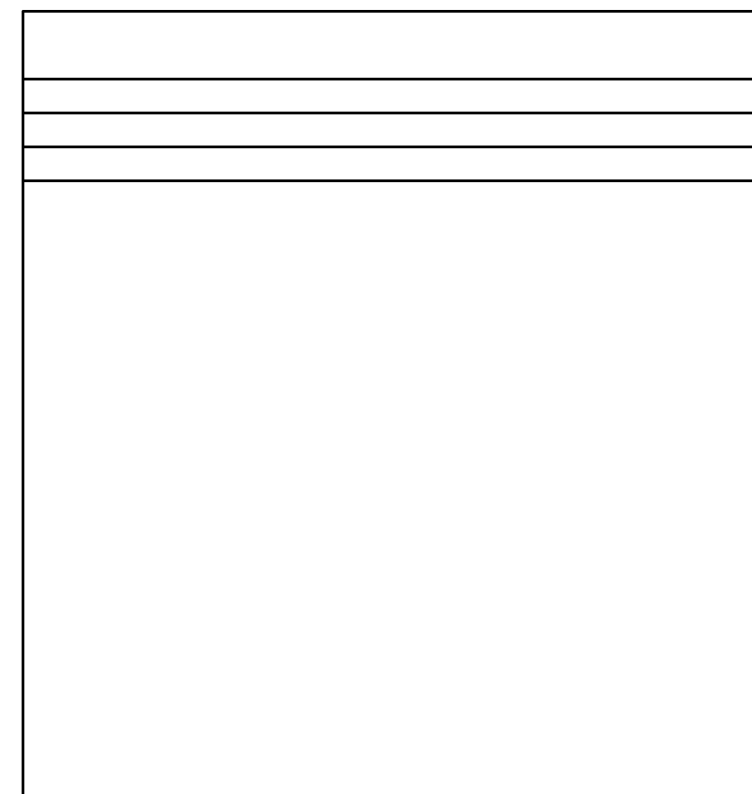
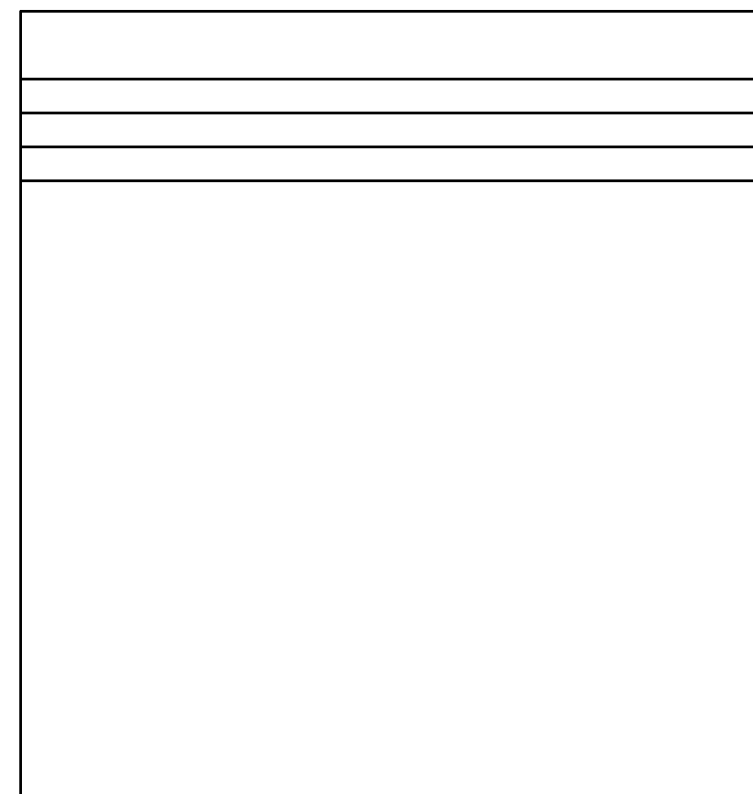
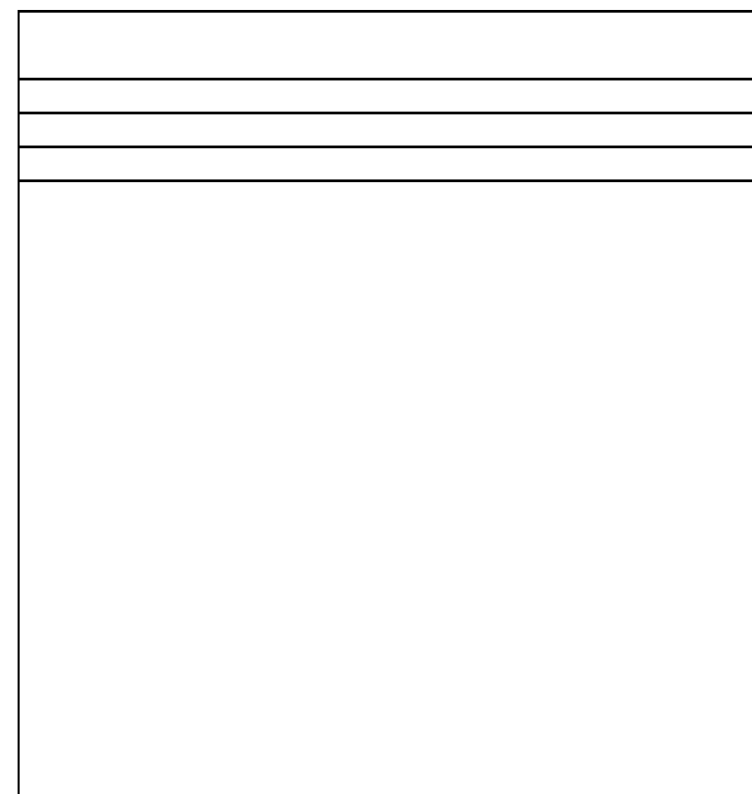
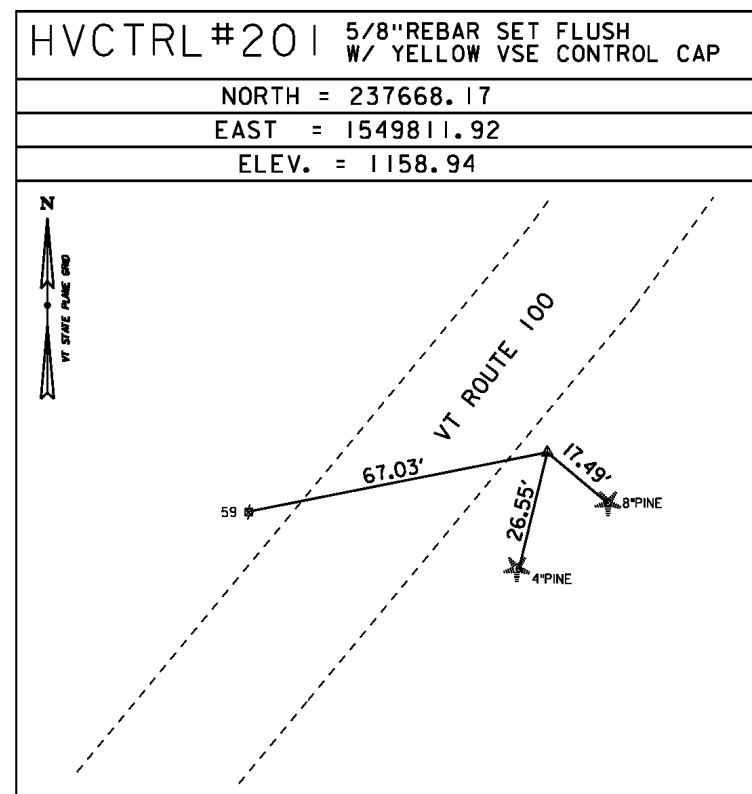
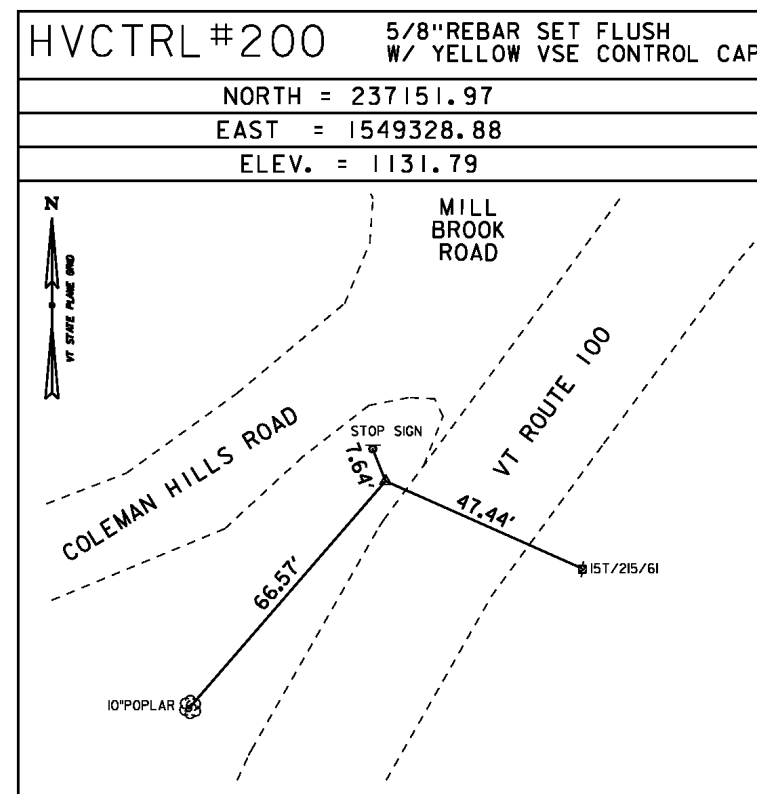

* CONTROL TIES COMPLETED: FEBRUARY 12, 2013 BY VSE, T. SCARZELLO-PC, T. COMSTOCK

ALIGNMENT TIES

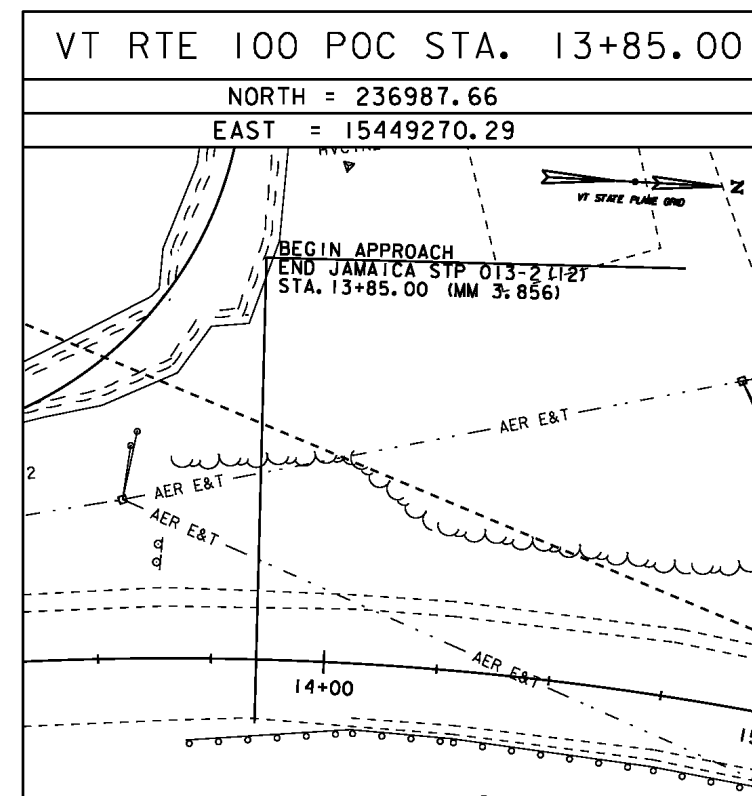
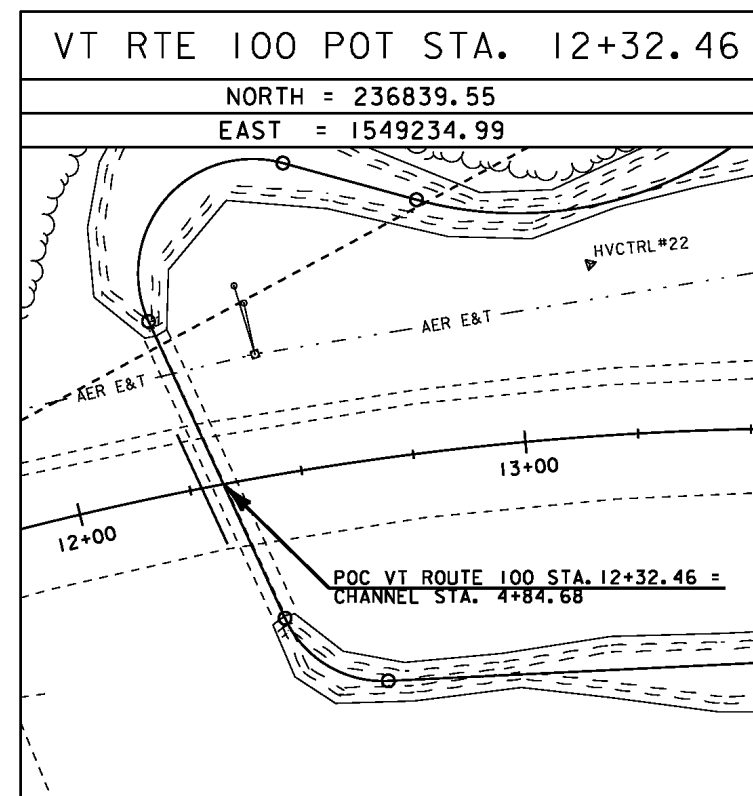
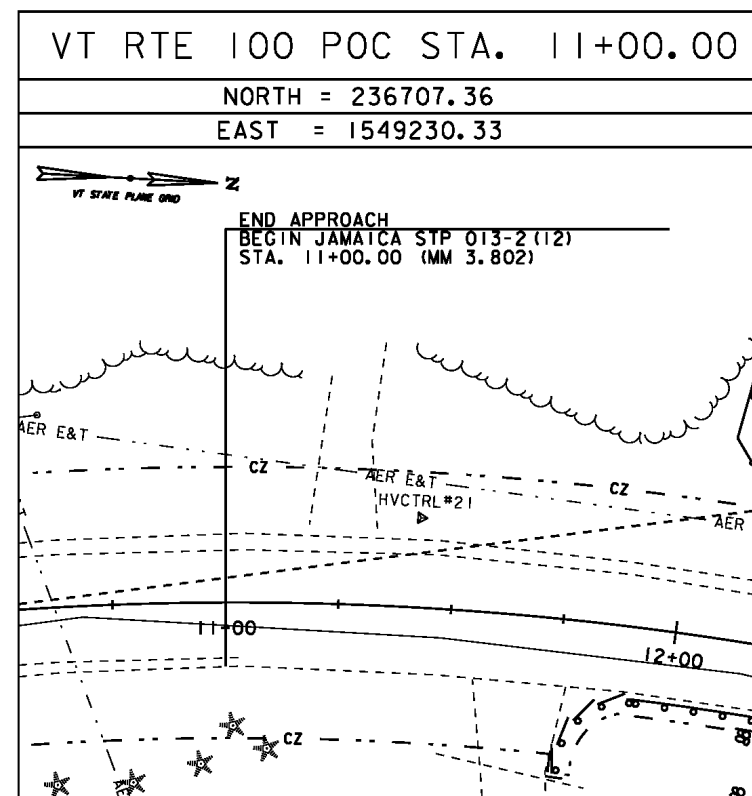
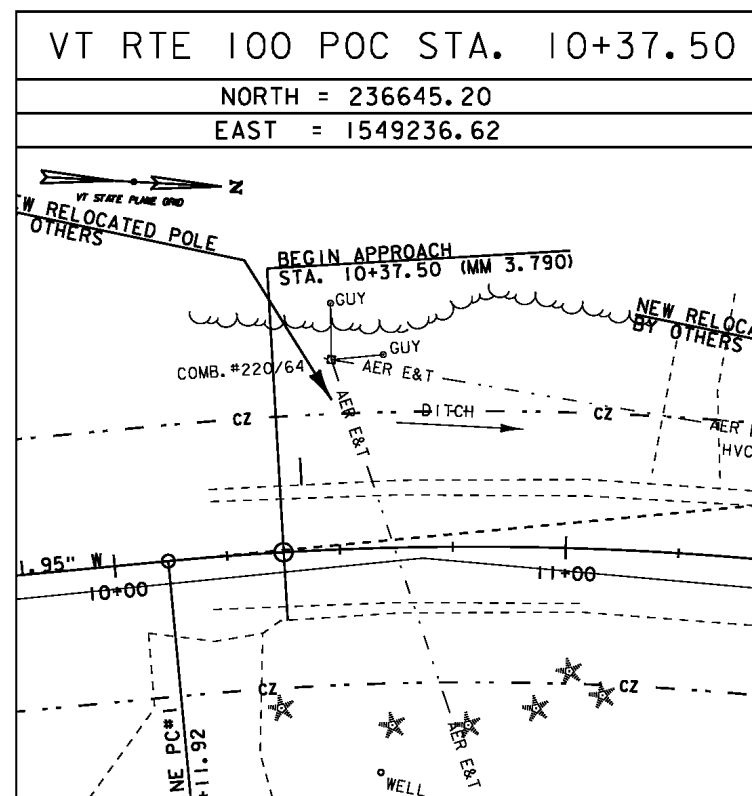
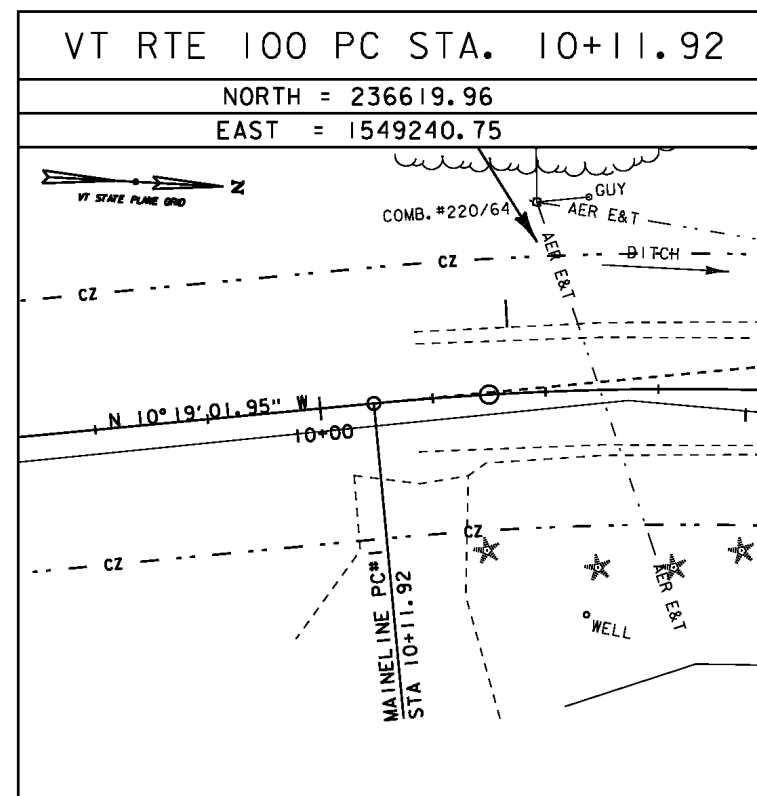

| | |
|------------|---------------------|
| DATUM | |
| VERTICAL | NAVD 88(GEODI2A) FT |
| HORIZONTAL | NAD 83(2011) SFT |
| ADJUSTMENT | NONE |

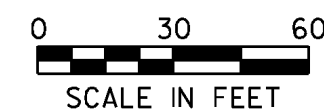

| | |
|-----------------|-----------------|
| PROJECT NAME: | JAMAICA |
| PROJECT NUMBER: | STP 013-2(12) |
| FILE NAME: | r12b474t1e1.dgn |
| PROJECT LEADER: | P. LIBBY |
| DESIGNED BY: | GIA, INC. |
| TIE SHEET 1 | |
| PLOT DATE: | 07-AUG-2014 |
| DRAWN BY: | GIA, INC. |
| CHECKED BY: | GIA, INC. |
| SHEET | 9 OF 12 |