

Original Drawing – Ink on Polymer meeting the requirements of 27 V.S.A. § 1403

R. O. W. PLANS

INDEX OF SHEETS

1	TITLE
2	LEGEND
3	DETAIL
4	LAYOUT
5	PRELIMINARY INFORMATION
6-7	TYPICALS
8	TIE
9	PROFILE
10	UTILITY
11	PLAN & ELEVATION
12	EPSC CONSTRUCTION

STATE OF VERMONT AGENCY OF TRANSPORTATION



PROPOSED IMPROVEMENT BRIDGE PROJECT

TOWN OF CHELSEA
COUNTY OF ORANGE

ROUTE NO : VT ROUTE 110, RURAL MAJOR COLLECTOR

BRIDGE NO : 11

PROJECT LOCATION: 0.3 MILES NORTH OF THE JUNCTION WITH VT ROUTE 113

PROJECT DESCRIPTION: REMOVAL AND REPLACEMENT OF THE DECK AND SUPERSTRUCTURE OF BRIDGE 11

LENGTH OF STRUCTURE: 87.25 FEET
 LENGTH OF ROADWAY: 162.75 FEET
 LENGTH OF PROJECT: 250.00 FEET
 LENGTH OF ROW PROJECT: 512.60 FEET

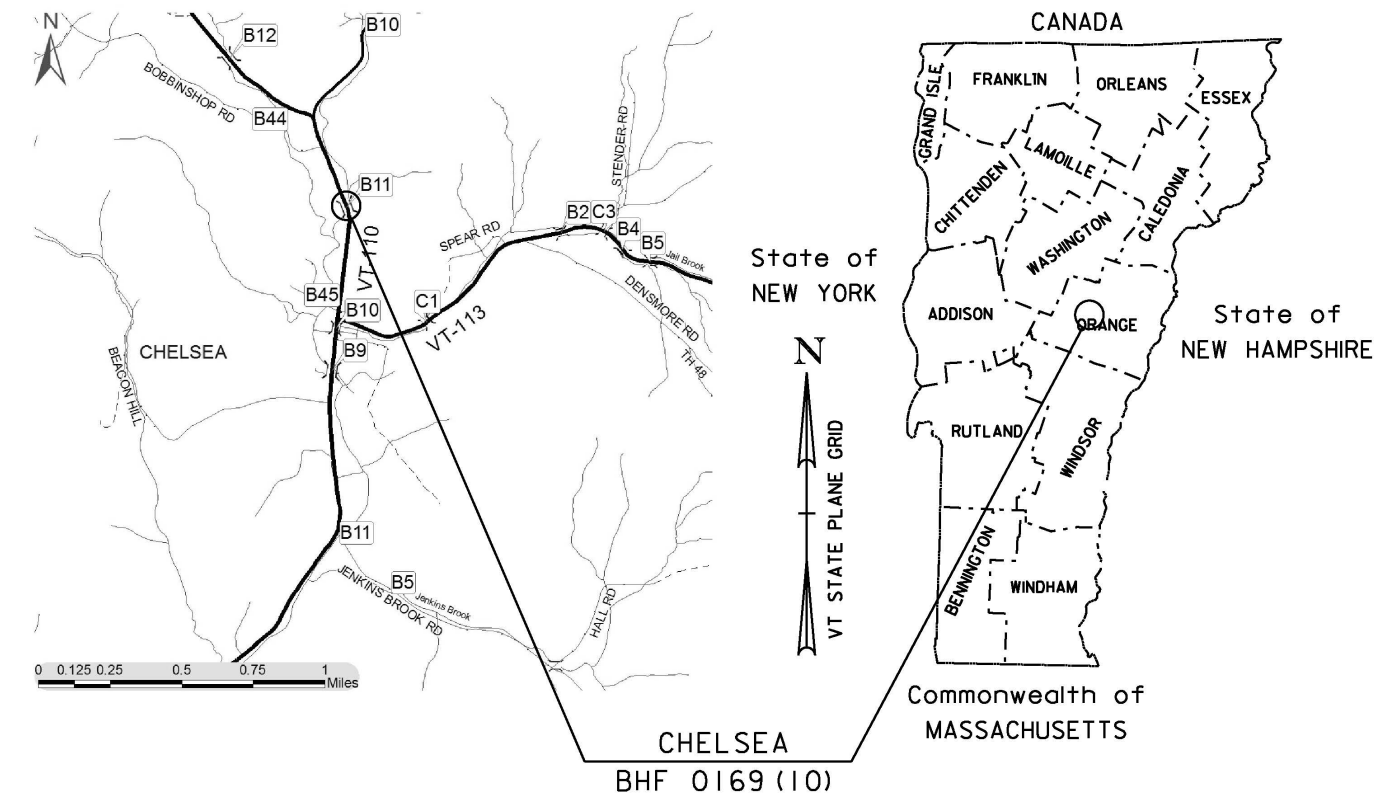

**BEGIN R.O.W. PROJECT
CHELSEA BHF 0169(10)
STA. 173+00.00, 24.41' LT**

**END R.O.W. PROJECT
CHELSEA BHF 0169(10)
STA. 178+12.60, 39.49' RT**

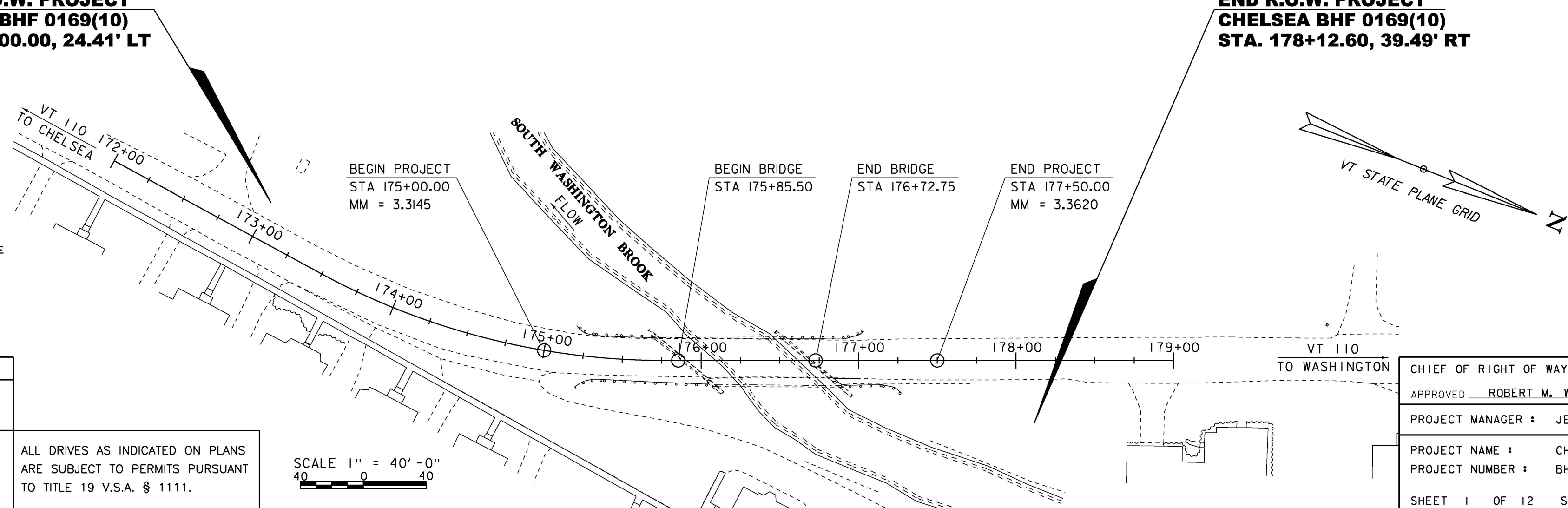

CONSTRUCTION IS TO BE CARRIED ON IN ACCORDANCE WITH THESE PLANS AND THE STANDARD SPECIFICATIONS FOR CONSTRUCTION DATED 2011, AS APPROVED BY THE FEDERAL HIGHWAY ADMINISTRATION ON JULY 20, 2011 FOR USE ON THIS PROJECT, INCLUDING ALL SUBSEQUENT REVISIONS AND SUCH REVISED SPECIFICATIONS AND SPECIAL PROVISIONS AS ARE INCORPORATED IN THESE PLANS.

QUALITY ASSURANCE PROGRAM : LEVEL 2	
SURVEYED BY :	R. GILMAN
SURVEYED DATE :	05-11-2012
DATUM	
VERTICAL	NAVD 88
HORIZONTAL	NAD 83 (07)

ALL DRIVES AS INDICATED ON PLANS ARE SUBJECT TO PERMITS PURSUANT TO TITLE 19 V.S.A. § 1111.

SCALE 1" = 40'-0"
0 40

CHIEF OF RIGHT OF WAY	
APPROVED	ROBERT M. WHITE DATE 10-22-15
PROJECT MANAGER : JENNIFER FITCH, P.E.	
PROJECT NAME :	CHELSEA
PROJECT NUMBER :	BHF 0169 (10)
SHEET 1 OF 12 SHEETS	