

# STATE OF VERMONT AGENCY OF TRANSPORTATION



## PROPOSED IMPROVEMENT

PROJECT IS LOCATED ON VT 107 IN STOCKBRIDGE  
BETWEEN MILE MARKER 1.7 AND 2.1  
LEDGE STABILIZATION INCLUDING THE PLACEMENT  
OF DOWELS.  
LENGTH OF R. O. W. PROJECT: 715' FEET

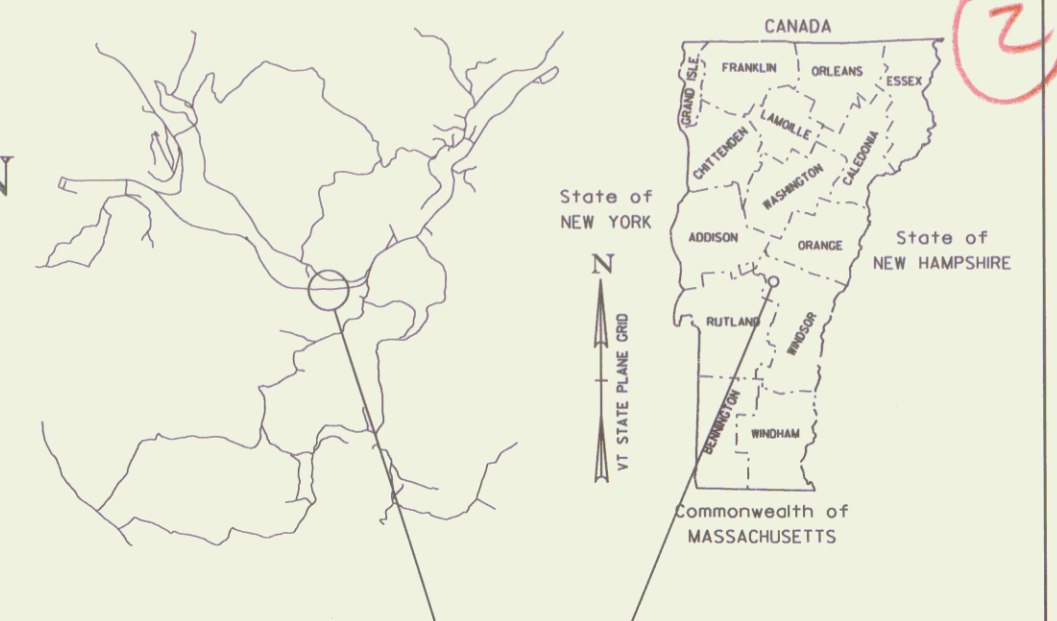
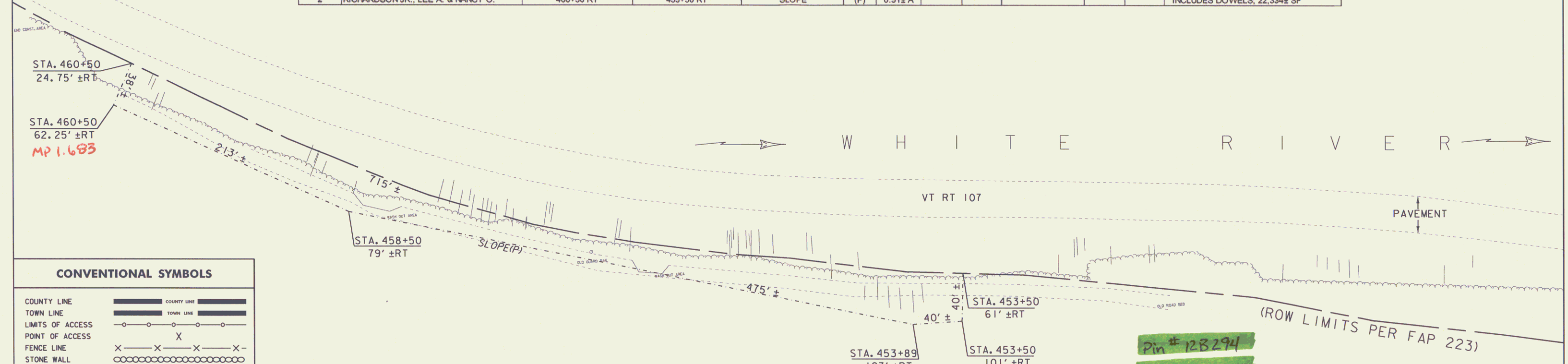

TABLE OF PROPERTY ACQUISITION											
PARCEL NO.	PROPERTY OWNER	BEGINNING STATION	ENDING STATION	RIGHT			RECORDING DATA				REMARKS
				TYPE	(T)/(P)	AREA ±	TITLE	DATE	TOWN / CITY	BOOK	
2	RICHARDSON JR., LEE A. & NANCY O.	460+50 RT	463+50 RT	SLOPE	(P)	0.51± A					INCLUDES DOWELS; 22,334± SF



CONVENTIONAL SYMBOLS	
COUNTY LINE	
TOWN LINE	
LIMITS OF ACCESS	
POINT OF ACCESS	
FENCE LINE	
STONE WALL	
TRAVELED WAY	
RAILROAD	
SURVEY LINE	
CULVERT	
POWER POLE	
TELEPHONE POLE	
TREES	
CONTROL OF ACCESS	
PROPERTY LINE	
R.O.W. TAKING LINE	
SLOPE RIGHTS	
TOP OF CUT	
TOE OF SLOPE	

SURVEYED BY :  
SURVEYED DATE :  
DATUM  
VERTICAL  
HORIZONTAL

**RICHARDSON JR.,  
LEE A. & NANCY O.**

(2)

REFERENCE IS MADE TO PROJECT PLANS  
STOCKBRIDGE FAP 223 DATED 1937.  
STATIONING WAS FROM SAID PROJECT.  
OFFSETS ARE FROM EXISTING CENTERLINE.



THESE PLANS ARE SUBJECT TO SUCH ENGINEERING CHANGES AS MAY BE REQUIRED BY THE FEDERAL HIGHWAY ADMINISTRATION OR THE DIRECTOR OF PROGRAM DEVELOPMENT.  
CONSTRUCTION IS TO BE CARRIED ON IN ACCORDANCE WITH THESE PLANS AND THE STANDARD SPECIFICATIONS FOR CONSTRUCTION DATED 2011, AS APPROVED BY THE FEDERAL HIGHWAY ADMINISTRATION ON JULY 20, 2011 FOR USE ON THIS PROJECT, INCLUDING ALL SUBSEQUENT REVISIONS AND SUCH REVISED SPECIFICATIONS AND SPECIAL PROVISIONS AS ARE INCORPORATED IN THESE PLANS.

Pin # 128294  
Route VT107  
Date 6/27/13

APPROVED _____ DATE _____ <i>Director of Program Development</i>	
APPROVED _____ DATE _____ <i>Chief of Right of Way</i>	
<b>STOCKBRIDGE</b> <b>ER 022-1 (26)</b>	
ROW SHEET (2) OF 2 SHEETS	