

Standard Steel Beam Guard Rail
w/ 5' Posts, Item 545-D
WB 774000 - EB 774000 Lt
WB 774000 - EB 774000 Lt
WB 774000 - EB 774000 Lt
WB 774000 - EB 774000 Lt

6' Galvanized Chain Link Fence, Item 581-I
WB 762+00 - 774+00 Lt
E.B. 762+00 - 774+00 Rt
WB 775+00 - 778+00 Lt
E.B. 775+00 - 778+00 Rt

Note: Frontage Road to be built in its entirety during Stage 1 Construction
That fence listed below is to be installed prior to the commencement of other work in this area.

Special Ditch
Common Excavation, Item 103
E.B. 762+00 - 764+75 Rt

Construct Drive
Frontage Rd. 765+00 Ft
Frontage Rd. 772+00 Ft
Frontage Rd. 776+00 Ft

Construct Maint. U-Turn
767+75

* Three Cable Guard Rail w/ Light Steel Posts, Item 530
WB 762+00 - 778+00 Lt
E.B. 762+00 - 778+00 Rt
WB 775+00 - 778+00 Lt
E.B. 775+00 - 778+00 Rt

Two Cable Guard Rail
Front 765+00 - 769+00 Lt
Front 765+00 - 769+00 Lt

Demolition & Disposal of Building Item 526
771+00 Lt
771+00 Rt
773+00 Lt
773+00 Rt

* Stage 2 Construction

* Bridge Railing (Bridge Approach) Item 572
WB 772+50 - 773+00 Lt
WB 773+00 - 773+00 Rt
E.B. 771+75 - 774+00 Lt
E.B. 771+87 - 774+12 Rt
WB 775+00 - 777+00 Lt
WB 775+00 - 777+00 Lt
E.B. 775+00 - 776+00 Lt
E.B. 775+00 - 776+00 Lt

Stone Fill for Slope Protection, Light Type
Item 517
E.B. 740+00 - 769+75 Rt
Removing & Re-setting Curb, Item 527
Vt. Sta. 133 - 74+00 - 74+00 Lt
74+00 - 74+00 Lt
74+10 - 74+30 Lt
Vt. Sta. 133 - 74+00 - 74+00 Lt
74+10 - 74+30 Lt

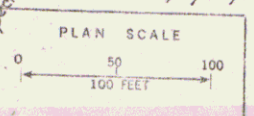
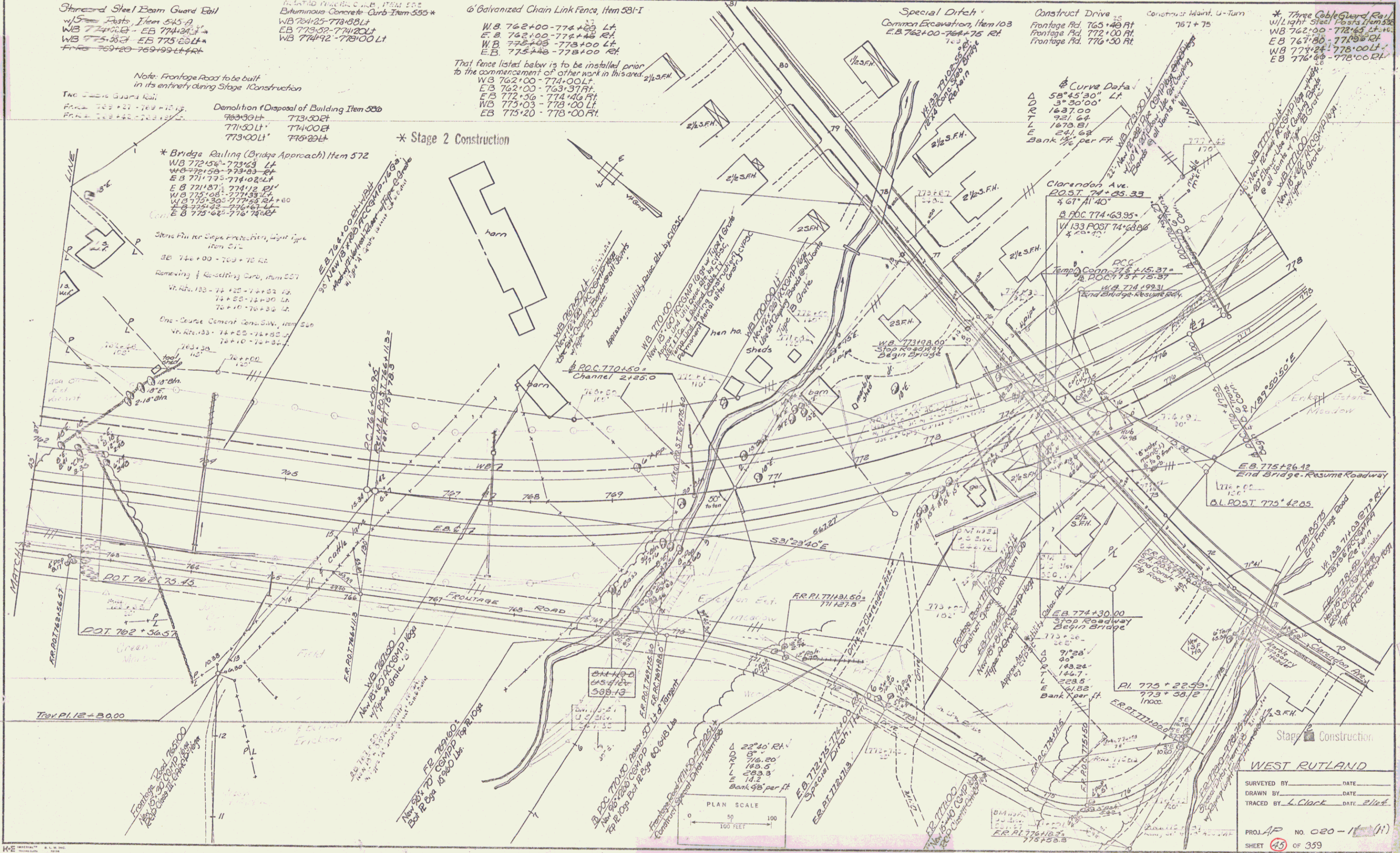

WEST RUTLAND
SURVEYED BY _____ DATE _____
DRAWN BY _____ DATE _____
TRACED BY L. Clark DATE 2/1/87
PROJ. AP No. 020-11(1)
SHEET 45 OF 359
Sheet 104 of 170 Sheets