

DRILLING & BLASTING OF SOIL  
NOT SUBGRADE ITEM #15  
K.B. 684+75 - 685+00  
W.B. 682+00 - 682+00  
W.B. 683+00 - 682+00  
W.B. 684+00 - 683+00

\* THREE CABLE GUARD RAIL WITH LIGHT  
STEEL POSTS, ITEM 538  
REV. E.B. 682+00 - 684+25 RT. 80  
REV. E.B. 682+00 - 682+00 RT. 71+55  
REV. E.B. 682+00 - 682+00 RT. 71+55  
REV. E.B. 682+00 - 682+00 RT. 71+55  
REV. E.B. 682+00 - 682+00 RT. 71+55

TREATED TIMBER CURB, ITEM 550 \*  
BITUMINOUS-CONCRETE CURB, ITEM 566 \*  
REV. E.B. 682+00 - 684+25 RT. 80  
REV. W.B. 685+02 - 686+25 RT. 71+55  
REV. E.B. 684+49 - 691+52 RT. 71+55  
W.B. 692+12 - 692+27 LT.

PROPERTY LINE FENCE WITH  
STEEL POSTS, ITEM 583 - II  
REV. E.B. 682+00 - 684+75 RT. 71+55  
REV. W.B. 682+00 - 686+75 LT. 686+00 LT.  
REV. E.B. 684+49 - 692+26 RT. 71+55  
REV. E.B. 682+00 - 682+00 RT. 71+55  
REV. W.B. 682+00 - 682+00 LT.

STANDARD STEEL BEAM GUARD RAIL \*  
WITH STEEL POSTS, ITEM 545-A  
REV. W.B. 685+02 RT - REV. E.B. 685+14 LT  
REV. E.B. 689+24 LT - REV. W.B. 690+08 RT  
E.B. 691+90 LT - W.B. 692+26 RT.  
E.B. 695+41 LT - W.B. 696+00 RT.

\* GALVANIZED CHAIN-LINK FENCE, ITEM 581-I  
REV. W.B. 690+00 - 692+20 LT  
W.B. 692+25 - 693+00 LT

THAT FENCE LISTED BELOW IS TO BE  
INSTALLED PRIOR TO THE COMMENCEMENT  
OF OTHER WORK IN THIS AREA.  
REV. E.B. 684+49 - 692+26 RT (PROPERTY-LINE)  
REV. W.B. 690+00 - 694+20 LT (CHAIN-LINK)  
E.B. 692+60 - 693+44 RT (PROPERTY-LINE)  
W.B. 695+85 - 696+00 LT (CHAIN-LINK)

SODDING, ITEM 612 \*  
REV. W.B. 684+52 - 685+02 RT  
W.B. 691+58 - 692+26 RT.  
E.B. 691+82 - 691+90 LT.

REINFORCED CONCRETE RETAINING WALL  
#1 683+03 - 683+37 E.B. RT  
#2 685+25 - 687+00 E.B. RT

METAL DIN-TYPE RETAINING WALL ITEM 578  
689+33 - 690+87 Rev W.B. LT

\* BRIDGE RAILING (Bridge Approach) ITEM 578  
E.B. 684+57 - 684+82 RT  
E.B. 684+82 - 685+18 LT  
W.B. 683+44 - 686+26 RT  
W.B. 684+27 - 686+26 LT  
E.B. 687+23 - 691+33 RT  
E.B. 687+23 - 691+33 LT  
W.B. 687+02 - 691+26 LT  
W.B. 687+02 - 691+26 LT

DEMOLITION & DISPOSAL OF BUILDING ITEM 586  
685+00 RT  
685+30 LT  
685+30 E  
689+00 RT  
690+00 E  
691+70 LT  
691+70 E  
693+30 RT  
693+70 RT  
693+25 RT (3)  
694+10 E  
694+05 LT  
693+40 LT (Non Gov't Part)  
694+40 LT (Non Gov't Part)  
694+70 LT (2) (Non Gov't Part)  
697+10 LT

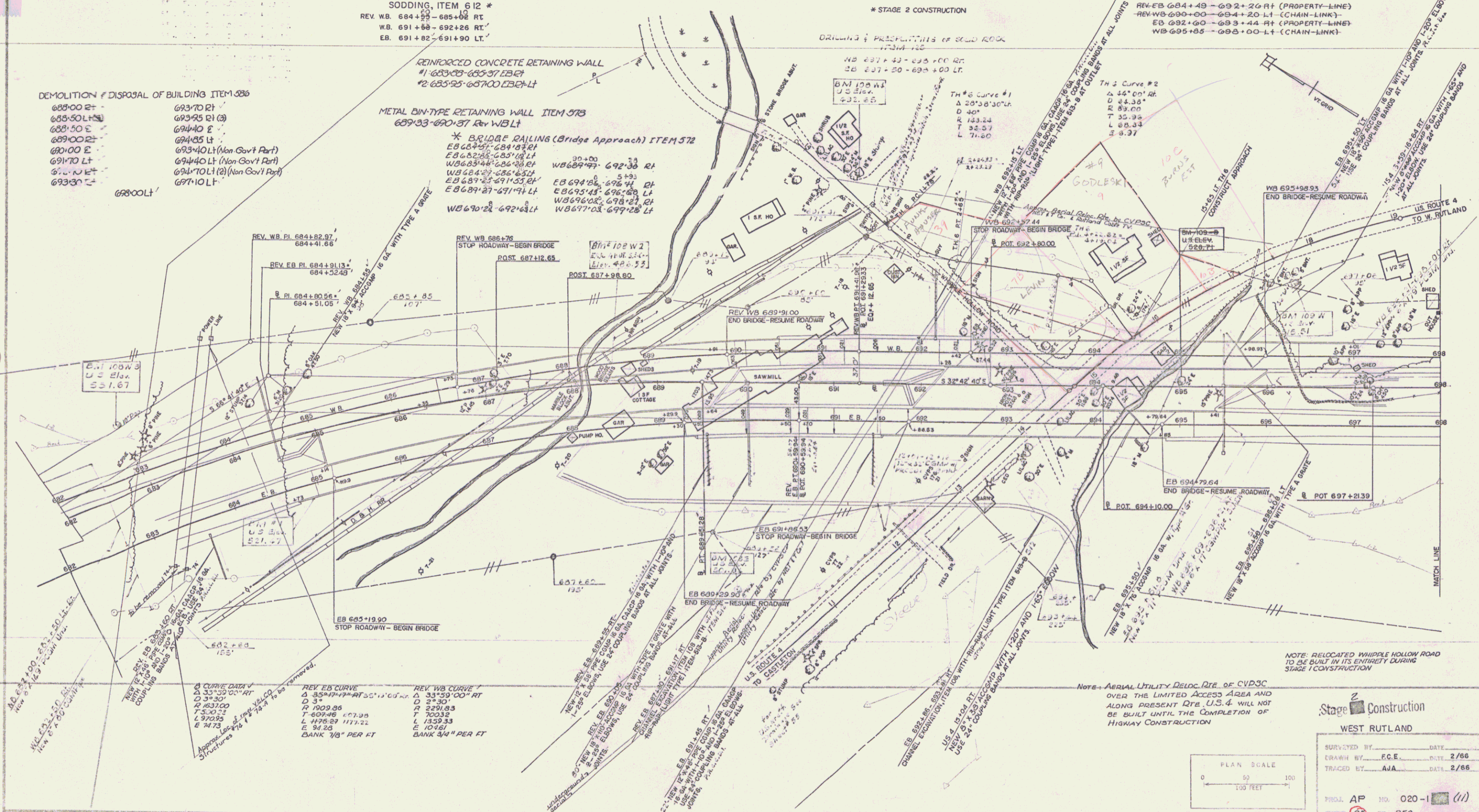

| REV. E.B. CURVE  | REV. W.B. CURVE  |
|------------------|------------------|
| Δ 33°30'00" RT   | Δ 33°30'00" RT   |
| D 31.30          | D 27.30          |
| R 1637.00        | R 2291.83        |
| T 520.72         | T 700.32         |
| L 370.25         | L 339.33         |
| E 147.3          | E 102.61         |
| BANK 1/8" PER FT | BANK 3/4" PER FT |



Stage 2 Construction  
WEST RUTLAND

|                  |           |
|------------------|-----------|
| SURVEYED BY      | DATE      |
| DRAWN BY E.C.E.  | DATE 2/66 |
| TRACED BY A.J.A. | DATE 2/66 |

PROJ. AP NO. 020-1 (11)  
SHEET 35 OF 359

Sheet 34 of 70 Sheets

6