

- INDEX OF SHEETS
1. TITLE SHEET
 2. QUANTITY SHEET
 3. PLAN
 4. PROFILE, TYPICAL SECTIONS AND GENERAL NOTES
 5. TYPICAL SECTION, PLAN, CURB AND RAILING DETAILS
 6. SUPERSTRUCTURE DETAILS
 7. ABUTMENT DETAILS
 8. PIER AND WATER LINE RELOCATION DETAILS
 9. REINFORCING STEEL SCHEDULE
 - 10-13. ROADWAY SECTIONS
 - 14-18. CHANNEL SECTIONS

- STANDARDS
19. E-3 BRIDGE CONSTRUCTION APPROACH SIGNS 11-7-73 R
 20. E-9 TRAFFIC SIGNS 12-19-72 R
 21. G-1a 12-9-72 R
 22. SCB-D6-73, DET. A TYPE II 11-28-73

STATE OF VERMONT
DEPARTMENT OF HIGHWAYS



PROPOSED IMPROVEMENT
BRIDGE PROJECT
COUNTY OF LAMOILLE
TOWN OF STOWE
VERMONT ROUTE 108
BRIDGE NO. 3

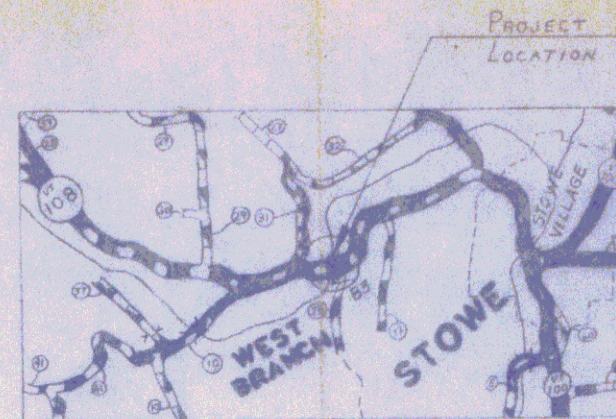

PROJECT BMA 6124

BEGINNING AT A POINT APPROXIMATELY 1.04 FT. WEST OF THE STOWE VILLAGE LINE ON VT RTE 108 AND EXTENDING 350 FT. EASTERLY.

THIS PROJECT SHALL CONSIST OF WIDENING PRESENT SUPERSTRUCTURE, REPAIRING ABUTMENTS AND PIER, AND APPROACH AND CHANNEL WORK AS DETAILED ON THESE PLANS.

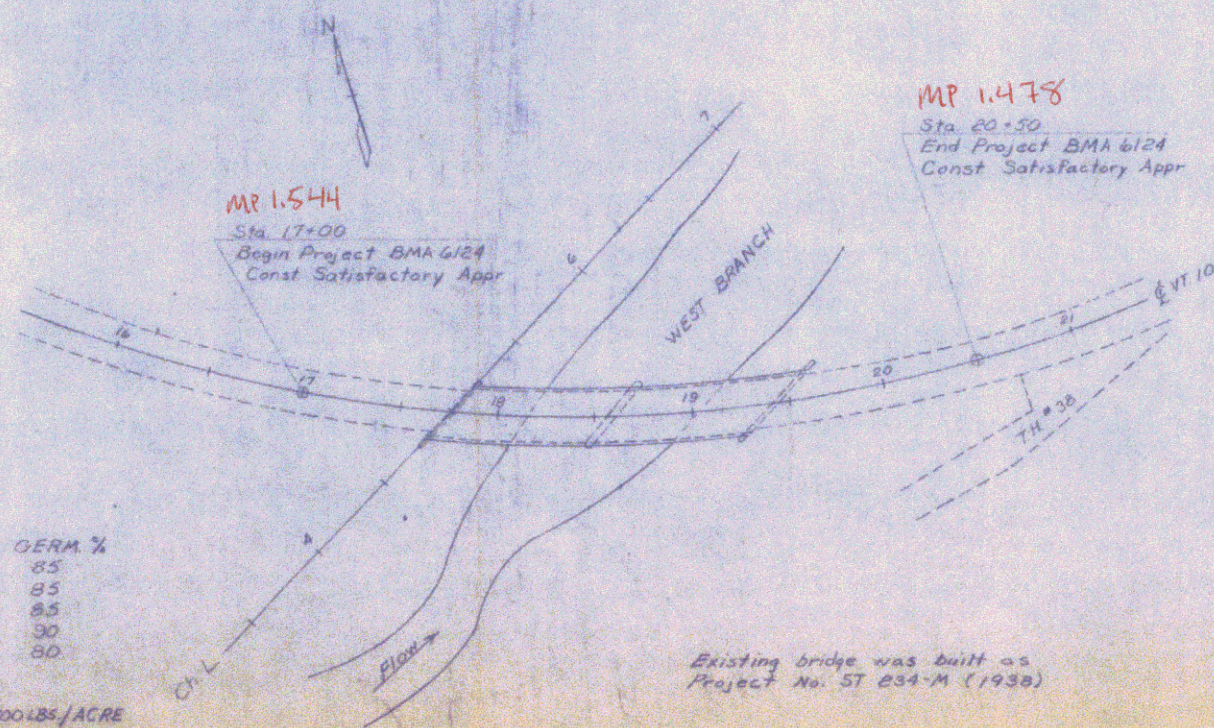

CONVENTIONAL SIGNS

- COUNTY LINE
- TOWN LINE
- LIMIT OF ACCESS
- POINT OF ACCESS
- TRUCK LANE
- TRUCK PAUL
- TRUCKED WAY
- ROAD PAUL
- RAILROAD
- POWER LINE
- POLE
- POWER POLE
- TELEPHONE POLE
- TREE
- P.A. CONST. IDENTIFICATION SIGN
- PROPERTY LINE
- ROAD TAKING LINE
- SLOPE PROTECT
- TOP OF CUT
- TOP OF SLOPE

% WT	LBS/ACRE	SEEDING FORMULA NAME	PUR. %	GERM. %
41.67	25	CREEPING RED FESCUE	98	85
25.00	15	ALFALFA	99	85
8.33	5	RED TOP	95	85
16.67	10	PERENNIAL RYE GRASS	95	90
8.33	5	BIRDSFOOT TREFOIL (EMPIRE)	98	80

APPLICATION RATES: ITEM 6510, SEED 60 LBS/ACRE
ITEM 6511, FERTILIZER (10-20-10) 300 LBS/ACRE
ITEM 6512, PINE MULCH 2 TON/ACRE

SEED, FERTILIZER, MULCH SHALL BE APPLIED TO ALL NEW SLOPES AS DIRECTED BY THE ENGINEER.

Existing bridge was built as Project No. ST 634-M (1930)

RECOMMENDED FOR: [Signature]
CONSTRUCTION ENGINEER: [Signature]
RECOMMENDED BY: [Signature]
DISTRICT ENGINEER: [Signature]

These plans are subject to such engineering changes as may be required by the Federal Highway Administration or the Chief Engineer.
Construction is to be carried on in accordance with these plans and the Standard Specifications for Highway and Bridge Construction as approved by the Federal Highway Administration, including all subsequent approved special and special revised specifications and special instructions on any correspondence.

Plan # 11R001
Date 14 June 74
Bridges Inc.
Carl W. Carlson
President
Contractor
John W. Kelley
Commissioner

APPROVED BY: [Signature]
DATE: 4/1/72
DEPARTMENT OF TRANSPORTATION
FEDERAL HIGHWAY ADMINISTRATION

EXISTING BRIDGE DATA :

CONCRETE DECK ON STEEL WF-BEAMS (36 WF 250)
 ROADWAY WIDTH = 24'
 CLEAR SPAN = 162' ALONG &
 CLEAR HEIGHT = 16'

SURVEY CURVE DATA

Δ = 45° 30'
 D = 7° 00'
 R = 818.51'
 L = 650.00'
 T = 343.23'

REVISED CURVE DATA

* CURVE #1 Δ = 15° 30' D = 17° 45' R = 737.301 L = 100.62 T = 100.62
 * CURVE #2 Δ = 14° 30' D = 5° 48' R = 987.86 L = 250.0' T = 125.67
 * CURVE #3 Δ = 15° 30' D = 17° 45' R = 723.48 L = 195.72 T = 98.46

ARC DEFINITION

REMOVAL AND DISPOSAL OF EXISTING GUARD RAIL, ITEM 202.40
 15+50 - 17+65 RT.
 16+04 - 17+85 LT.
 19+27 - 20+50 RT.
 19+60 - 20+96 LT.

GUARD RAIL, STANDARD STEEL BEAM WITH STEEL POSTS, TYPE I, ITEM 612.5
 16+51 - 17+65 RT.
 17+08 - 17+85 LT.
 19+27 - 20+41 RT.
 19+60 - 20+49 LT.

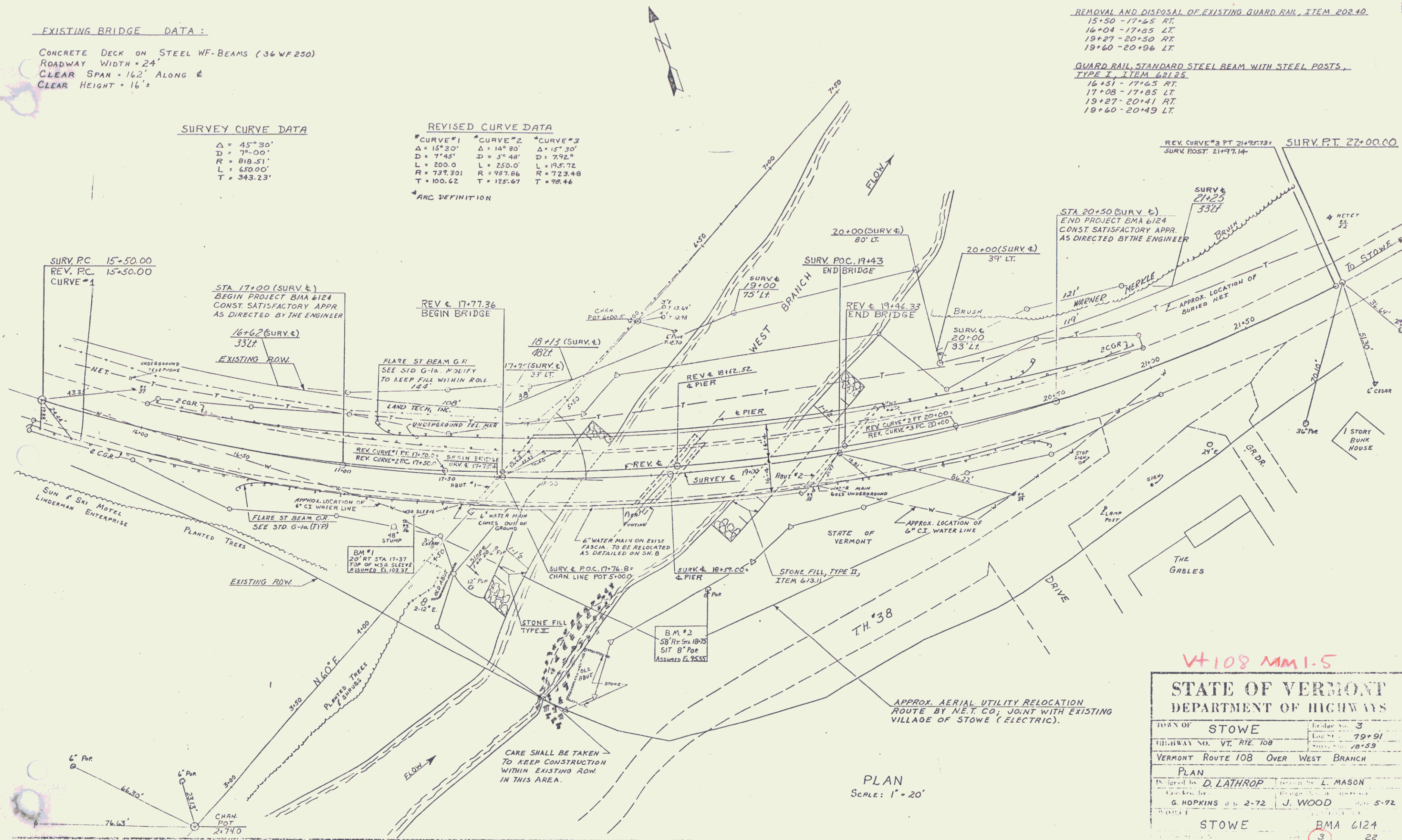

VH 108 MM 1.5

STATE OF VERMONT	
DEPARTMENT OF HIGHWAYS	
TOWN OF STOWE	Sheet No. 3
HIGHWAY NO. VT. RTE. 108	Length 79+91
VERMONT ROUTE 108 OVER WEST BRANCH	
PLAN	
Designed by D. LATHROP	Checked by L. MASON
Drawn by G. HOPKINS	Checked by J. WOOD
Date 2-72	Date 5-72
STOWE	
BMA 6124	
3	

PLAN
 Scale: 1" = 20'