

EXISTING BRIDGE DATA :

CONCRETE DECK ON STEEL WF-BEAMS (36 WF 250)
 ROADWAY WIDTH = 24'
 CLEAR SPAN = 162' ALONG &
 CLEAR HEIGHT = 16'

SURVEY CURVE DATA

Δ = 45° 30'
 D = 7° 00'
 R = 818.51'
 L = 650.00'
 T = 343.23'

REVISED CURVE DATA

* CURVE #1 Δ = 15° 30' D = 17° 45' R = 737.301 T = 100.62
 * CURVE #2 Δ = 14° 30' D = 5° 48' R = 987.86 T = 125.67
 * CURVE #3 Δ = 15° 30' D = 15° 30' R = 723.48 T = 98.46

ARC DEFINITION

REMOVAL AND DISPOSAL OF EXISTING GUARD RAIL, ITEM 202.40
 15+50 - 17+65 RT.
 16+04 - 17+85 LT.
 19+27 - 20+50 RT.
 19+60 - 20+96 LT.

GUARD RAIL, STANDARD STEEL BEAM WITH STEEL POSTS, TYPE 1, ITEM 612.5
 16+51 - 17+65 RT.
 17+08 - 17+85 LT.
 19+27 - 20+41 RT.
 19+60 - 20+49 LT.

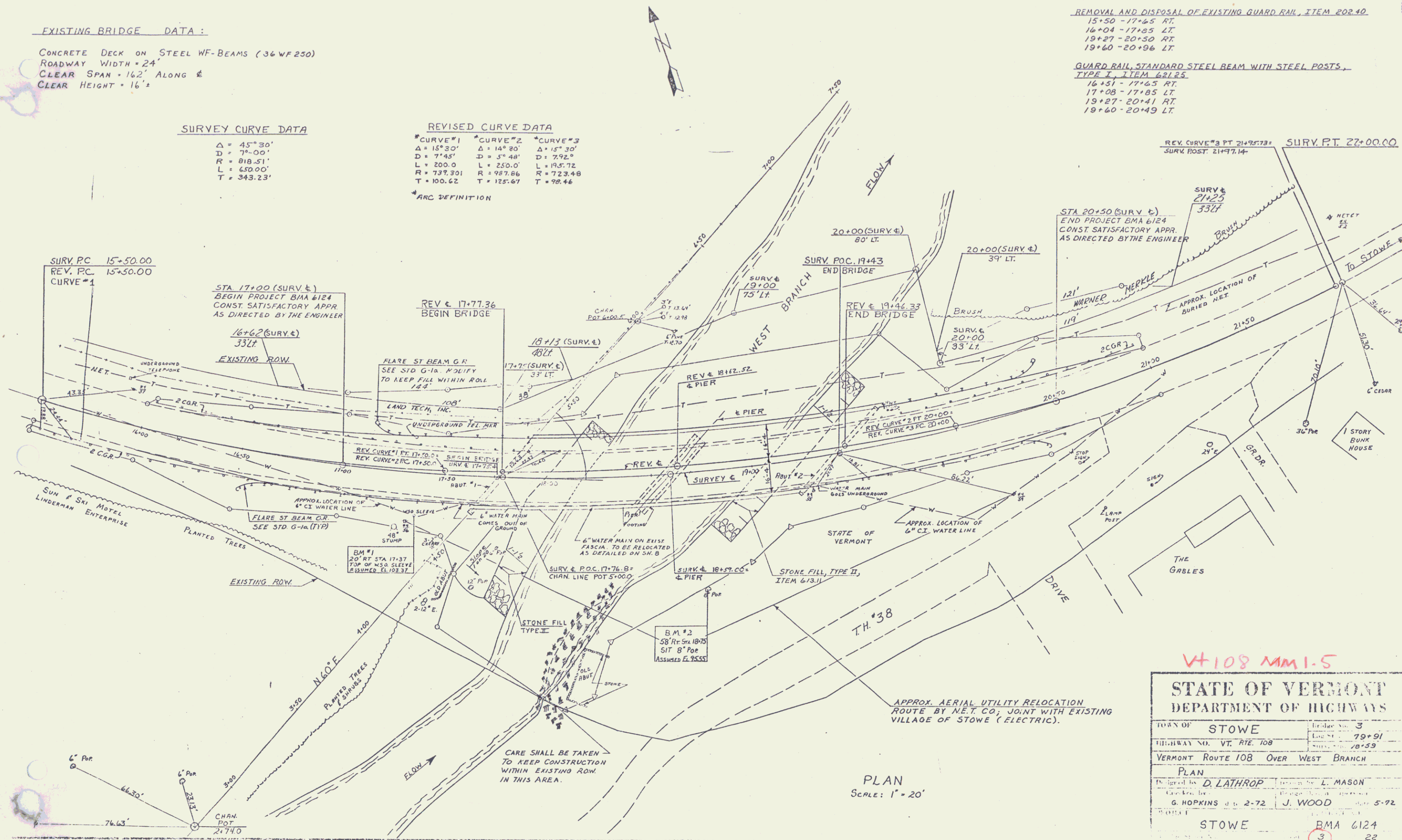

VH 108 MM 1.5

STATE OF VERMONT	
DEPARTMENT OF HIGHWAYS	
TOWN OF STOWE	Sheet No. 3
HIGHWAY NO. VT. RTE. 108	Length 79+91
VERMONT ROUTE 108 OVER WEST BRANCH	
PLAN	
Designed by D. LATHROP	Checked by L. MASON
Drawn by G. HOPKINS	Checked by J. WOOD
Date 2-72	Date 5-72
STOWE	
BMA 6124	
3	

PLAN
 Scale: 1" = 20'