

Original Drawing - Ink on polymer meeting the requirements of 27 V.S.A. § 1403

# STATE OF VERMONT AGENCY OF TRANSPORTATION



*R.O.W. PLANS*

## PROPOSED IMPROVEMENT BRIDGE PROJECT

TOWN OF HANCOCK  
COUNTY OF ADDISON

ROUTE NO: VT 125, MAJOR COLLECTOR    BRIDGE NO: 23

PROJECT LOCATION: BEGINNING AT A POINT APPROXIMATELY 2.2 MILES WEST OF THE JUNCTION OF VT 125 AND VT 100 AND EXTENDING EASTERLY 275 FEET ALONG VT 125.

PROJECT DESCRIPTION: REPLACEMENT OF THE EXISTING BRIDGE WITH A NEW BRIDGE ON THE EXISTING ALIGNMENT WITH NECESSARY ROADWAY AND CHANNEL WORK.

LENGTH OF STRUCTURE: 72.66 FEET  
 LENGTH OF ROADWAY: 202.34 FEET  
 LENGTH OF PROJECT: 275.00 FEET  
 LENGTH OF ROW PROJECT: 425.08 FEET

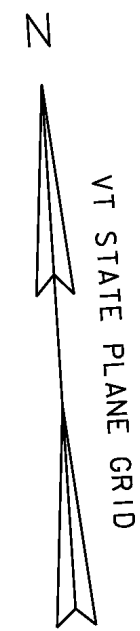
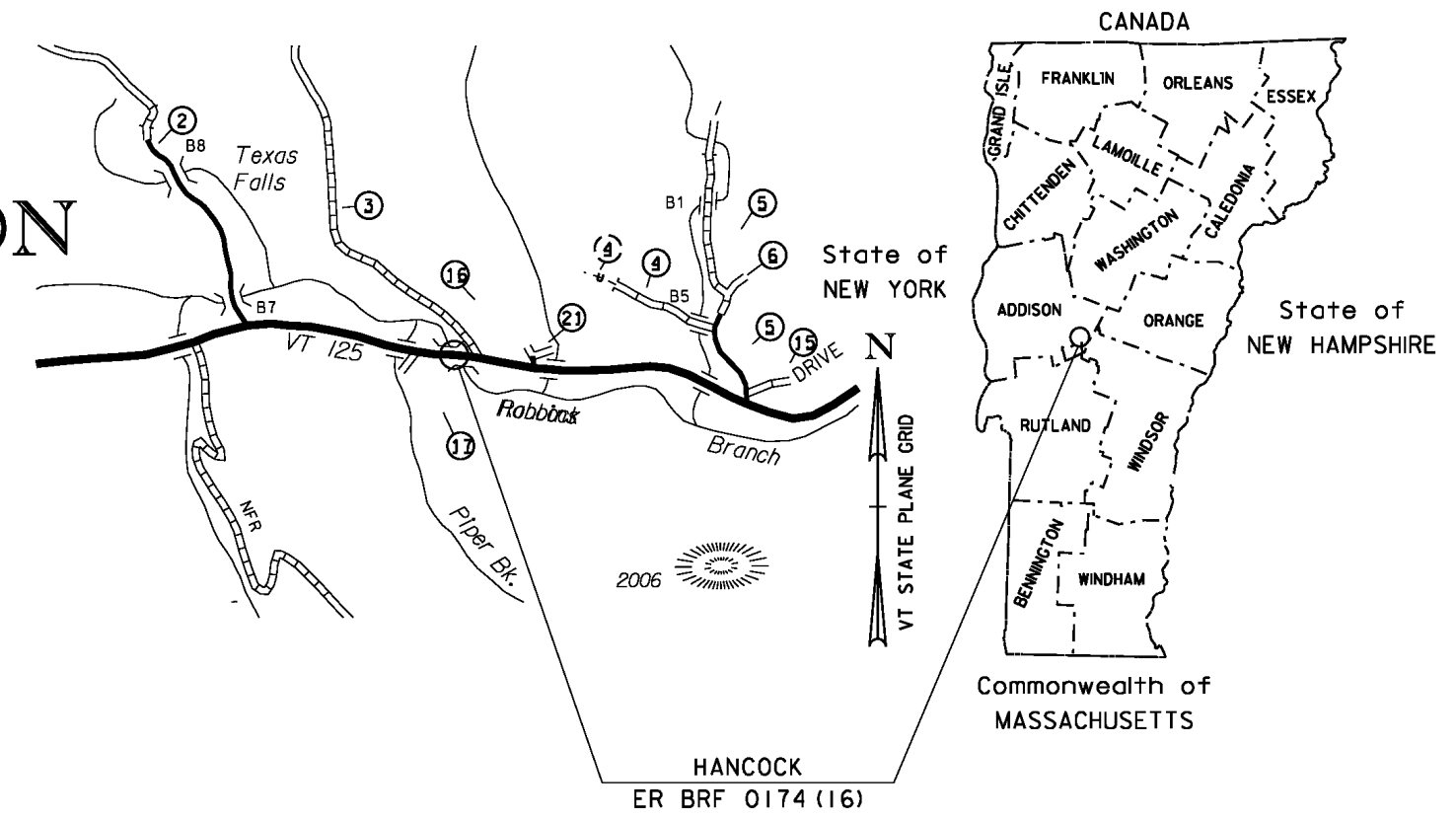

**BEGIN ROW PROJECT  
ER BR 0174(16)  
STA. 266+00.00 CL**

**BEGIN ROW PROJECT  
ER BR 0174(16)  
STA. 270+25.08 CL**

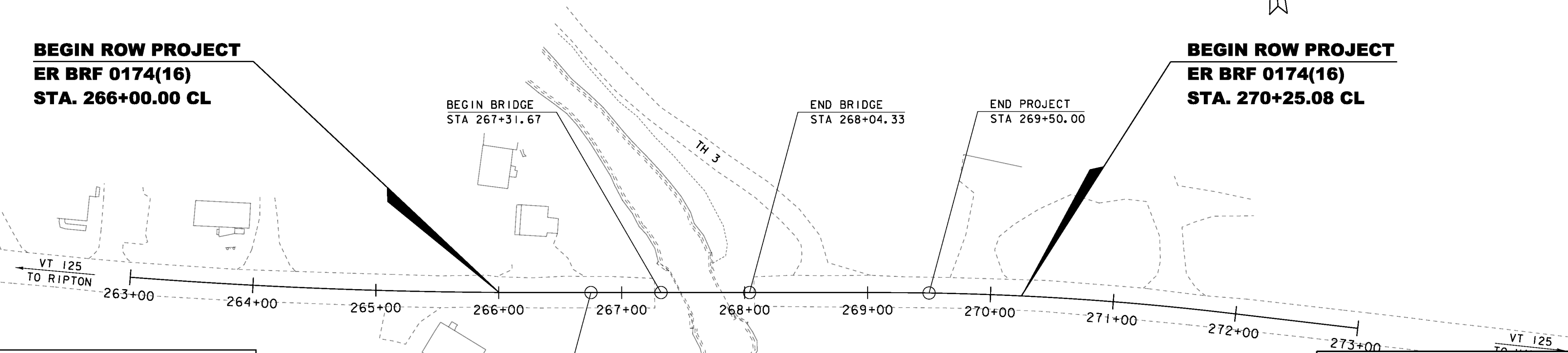

CONVENTIONAL SYMBOLS	
COUNTY LINE	
TOWN LINE	
LIMITS OF ACCESS	
POINT OF ACCESS	
FENCE LINE	
STONE WALL	
TRAVELED WAY	
GUARD RAIL	
RAILROAD	
SURVEY LINE	
CULVERT	
POWER POLE	
TELEPHONE POLE	
TREES	
CONTROL OF ACCESS	
PROPERTY LINE	
R.O.W. TAKING LINE	
SLOPE RIGHTS	
TOP OF CUT	
TOE OF SLOPE	

ALL DRIVES AS INDICATED ON PLANS ARE SUBJECT TO PERMITS PURSUANT TO TITLE 19 V.S.A. § 1111.

SURVEYED BY : L. ORVIS  
 SURVEYED DATE : 10-30-2011

DATUM  
 VERTICAL    NAVD 88  
 HORIZONTAL    NAD 83 (CORS)

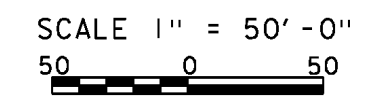

THESE PLANS ARE SUBJECT TO SUCH ENGINEERING CHANGES AS MAY BE REQUIRED BY THE FEDERAL HIGHWAY ADMINISTRATION OR THE DIRECTOR OF PROGRAM DEVELOPMENT.

CONSTRUCTION IS TO BE CARRIED ON IN ACCORDANCE WITH THESE PLANS AND THE STANDARD SPECIFICATIONS FOR CONSTRUCTION DATED 2011, AS APPROVED BY THE FEDERAL HIGHWAY ADMINISTRATION ON JULY 20, 2011 FOR USE ON THIS PROJECT, INCLUDING ALL SUBSEQUENT REVISIONS AND SUCH REVISED SPECIFICATIONS AND SPECIAL PROVISIONS AS ARE INCORPORATED IN THESE PLANS.

APPROVED RICHARD TETREAULT DATE 06-14-12  
*Director of Program Development*

APPROVED ROBERT M. WHITE DATE 06-14-12  
*Chief of Right of Way*

**HANCOCK**  
 ER BR 0174(16)  
 ROW SHEET 1 OF 10 SHEETS