

Original Drawing - Ink on polymer meeting the requirements of 27 V.S.A. § 1403

# R. O. W. PLANS

## INDEX OF SHEETS

- |       |                               |
|-------|-------------------------------|
| 1     | TITLE                         |
| 2     | LEGEND SHEET                  |
| 3     | DETAIL SHEET                  |
| 4-5   | LAYOUT SHEETS                 |
| 6     | PRELIMINARY INFORMATION SHEET |
| 7-8   | TYPICALS SECTIONS SHEETS      |
| 9     | SURVEY TIE SHEET              |
| 10-11 | PROFILE SHEETS                |
| 12-13 | EPSC CONSTRUCTION SHEETS      |
| 14    | PLAN & ELEVATION SHEET        |

# STATE OF VERMONT AGENCY OF TRANSPORTATION



## PROPOSED IMPROVEMENT BRIDGE PROJECT TOWN OF LINCOLN COUNTY OF ADDISON TH 1 (RURAL MAJOR COLLECTOR) BRIDGE #19

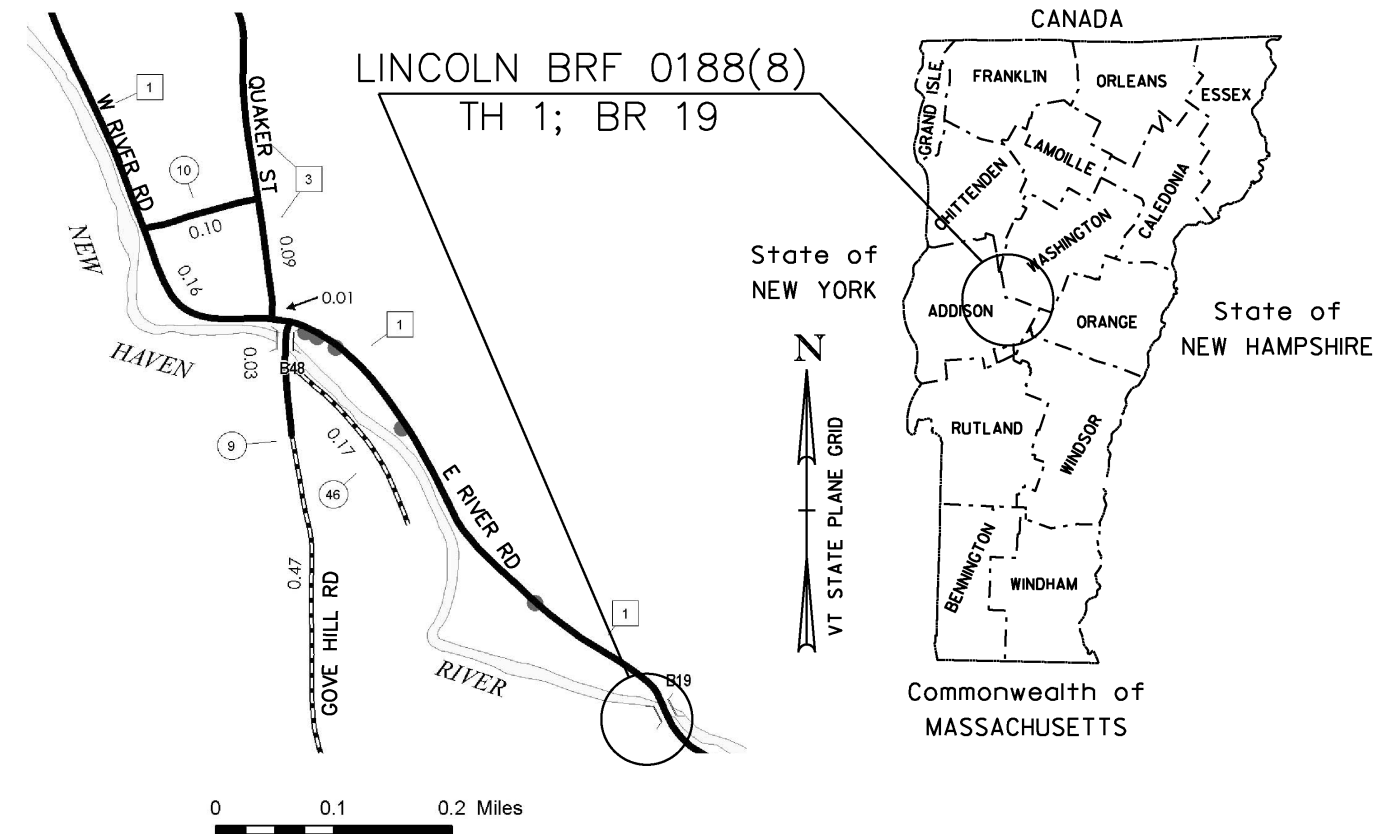

**BEGIN R.O.W. PROJECT  
BRF 0188(8)  
STA. 500+78 23.12' LT**

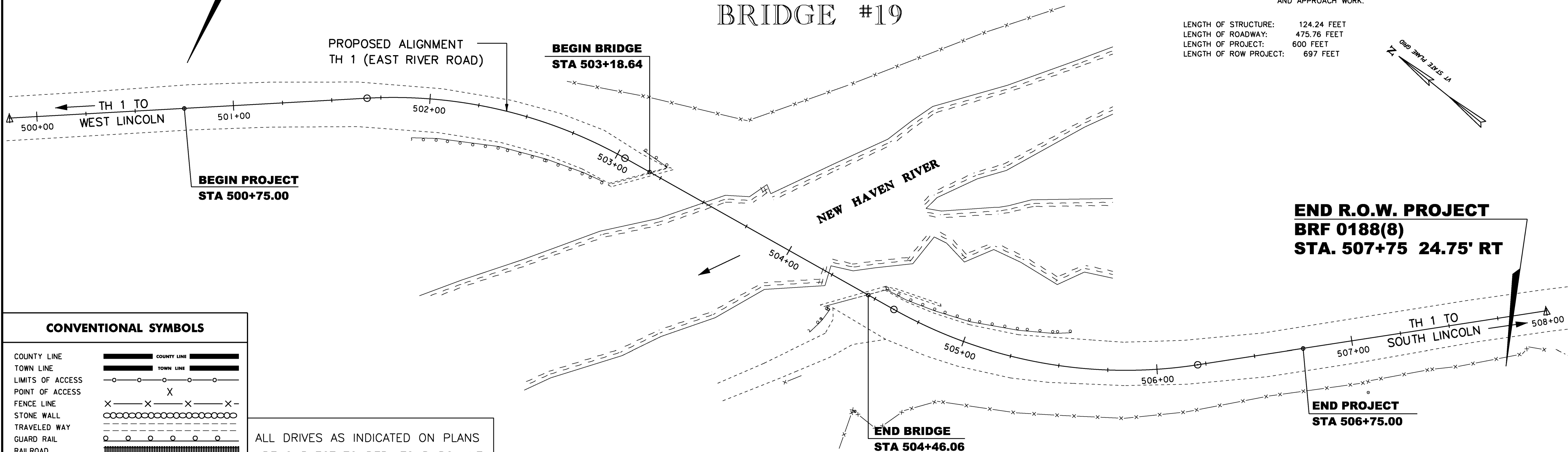

**PROJECT LOCATION:** BEGINNING AT A POINT ON EAST RIVER ROAD APPROXIMATELY 0.5 MILES SOUTH OF ITS JUNCTION WITH GOVE HILL ROAD AND PROCEEDING SOUTHERLY FOR APPROXIMATELY 0.1 MILES ALONG EAST RIVER ROAD.

**PROJECT DESCRIPTION:** REPLACE EXISTING BRIDGE WITH A NEW WIDENED BRIDGE ON AN ALIGNMENT SIMILAR TO EXISTING INCLUDING RELATED CHANNEL AND APPROACH WORK.

**LENGTH OF STRUCTURE:** 124.24 FEET  
**LENGTH OF ROADWAY:** 475.76 FEET  
**LENGTH OF PROJECT:** 600 FEET  
**LENGTH OF ROW PROJECT:** 697 FEET

### CONVENTIONAL SYMBOLS

COUNTY LINE	
TOWN LINE	
LIMITS OF ACCESS	
POINT OF ACCESS	
FENCE LINE	
STONE WALL	
TRAVELED WAY	
GUARD RAIL	
RAILROAD	
SURVEY LINE	
CULVERT	
POWER POLE	
TELEPHONE POLE	
TREES	
CONTROL OF ACCESS	
PROPERTY LINE	
R.O.W. TAKING LINE	
SLOPE RIGHTS	
TOP OF CUT	
TOE OF SLOPE	

ALL DRIVES AS INDICATED ON PLANS ARE SUBJECT TO PERMITS PURSUANT TO TITLE 19 V.S.A. § 1111.

SURVEYED BY : VERMONT SURVEY & ENGINEERING, INC.  
SURVEYED DATE : 11/16/2010

DATUM  
VERTICAL NAVD 88 (GEOID 9 FT)  
HORIZONTAL NAD 83 (CORS) SPC (4400VT) sFT

SCALE 1" = 25'-0"

THESE PLANS ARE SUBJECT TO SUCH ENGINEERING CHANGES AS MAY BE REQUIRED BY THE FEDERAL HIGHWAY ADMINISTRATION OR THE DIRECTOR OF PROGRAM DEVELOPMENT.

CONSTRUCTION IS TO BE CARRIED ON IN ACCORDANCE WITH THESE PLANS AND THE STANDARD SPECIFICATIONS FOR CONSTRUCTION DATED 2011, AS APPROVED BY THE FEDERAL HIGHWAY ADMINISTRATION ON JULY 20, 2011 FOR USE ON THIS PROJECT, INCLUDING ALL SUBSEQUENT REVISIONS AND SUCH REVISED SPECIFICATIONS AND SPECIAL PROVISIONS AS ARE INCORPORATED IN THESE PLANS.

CHIEF OF RIGHT OF WAY	
APPROVED	ROBERT M. WHITE DATE 03-24-14
PROJECT MANAGER : TODD SUMNER	
PROJECT NAME :	LINCOLN
PROJECT NUMBER :	BRF 0188 (8)
SHEET 1 OF 14 SHEETS	