

621.20 STEEL BEAM GUARDRAIL, GALVANIZED  
 STA 56+06.27 TO 58+24.93 LT  
 STA 56+06.27 TO 59+24.83 RT

621.80 REMOVAL AND DISPOSAL OF GUARDRAIL  
 STA 55+98.60 TO 58+38.11 LT  
 STA 55+96.90 TO 59+34.98 RT

646.21 4 INCH YELLOW LINE LF  
 STA 56+25.00 TO 57+50.00 LT  
 STA 56+25.00 TO 57+50.00 RT

675.60 ERECTING SALVAGED SIGNS EACH  
 STA 56+40.65 LT  
 STA 57+10.39 RT

621.60 ANCHOR FOR STEEL BEAM RAIL EACH  
 STA 56+06.27 LT  
 STA 56+06.27 RT  
 STA 58+24.93 LT  
 STA 59+24.83 RT

646.20 4 INCH WHITE LINE LF  
 STA 56+25.00 TO 57+50.00 LT  
 STA 56+25.00 TO 57+50.00 RT

675.50 REMOVING SIGNS EACH  
 STA 56+40.65 LT  
 STA 57+10.39 RT

675.61 SETTING SALVAGED POSTS EACH  
 STA 56+40.65 LT  
 STA 57+10.39 RT

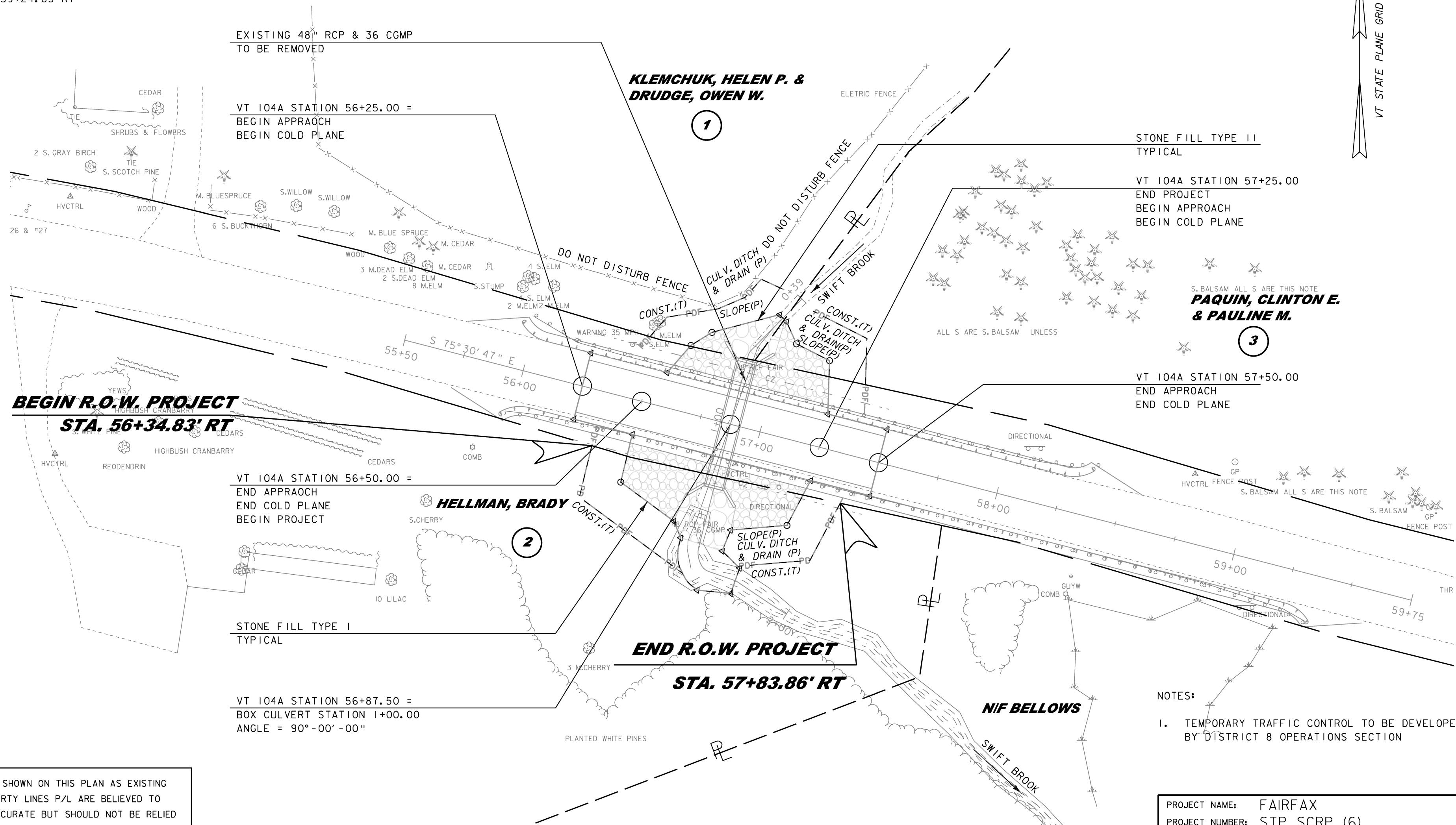

**BEGIN R.O.W. PROJECT**  
**STA. 56+34.83' RT**

VT 104A STATION 56+50.00 =  
 END APPROACH  
 END COLD PLANE  
 BEGIN PROJECT

STONE FILL TYPE I  
 TYPICAL

VT 104A STATION 56+87.50 =  
 BOX CULVERT STATION 1+00.00  
 ANGLE = 90°-00'-00"

**END R.O.W. PROJECT**  
**STA. 57+83.86' RT**

STONE FILL TYPE II  
 TYPICAL

VT 104A STATION 57+25.00  
 END PROJECT  
 BEGIN APPROACH  
 BEGIN COLD PLANE

VT 104A STATION 57+50.00  
 END APPROACH  
 END COLD PLANE

- NOTES:
- TEMPORARY TRAFFIC CONTROL TO BE DEVELOPED BY DISTRICT 8 OPERATIONS SECTION

LINES SHOWN ON THIS PLAN AS EXISTING PROPERTY LINES P/L ARE BELIEVED TO BE ACCURATE BUT SHOULD NOT BE RELIED UPON FOR PURPOSES UNRELATED TO THE STATE OF VERMONT'S ACQUISITION OF LAND AND RIGHTS FOR THIS PROJECT.

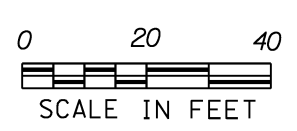

PROJECT NAME: FAIRFAX	PLOT DATE: 06-JUN-2011
PROJECT NUMBER: STP SCRIP (6)	DRAWN BY: J. BLANCHARD
FILE NAME: r10b196.lay.dgn	CHECKED BY: J. BLANCHARD
PROJECT LEADER: K. UPMAL	SHEET 11 OF 11
DESIGNED BY: S. PALMER	
R.O.W. LAYOUT	