

R.O.W. PLANS

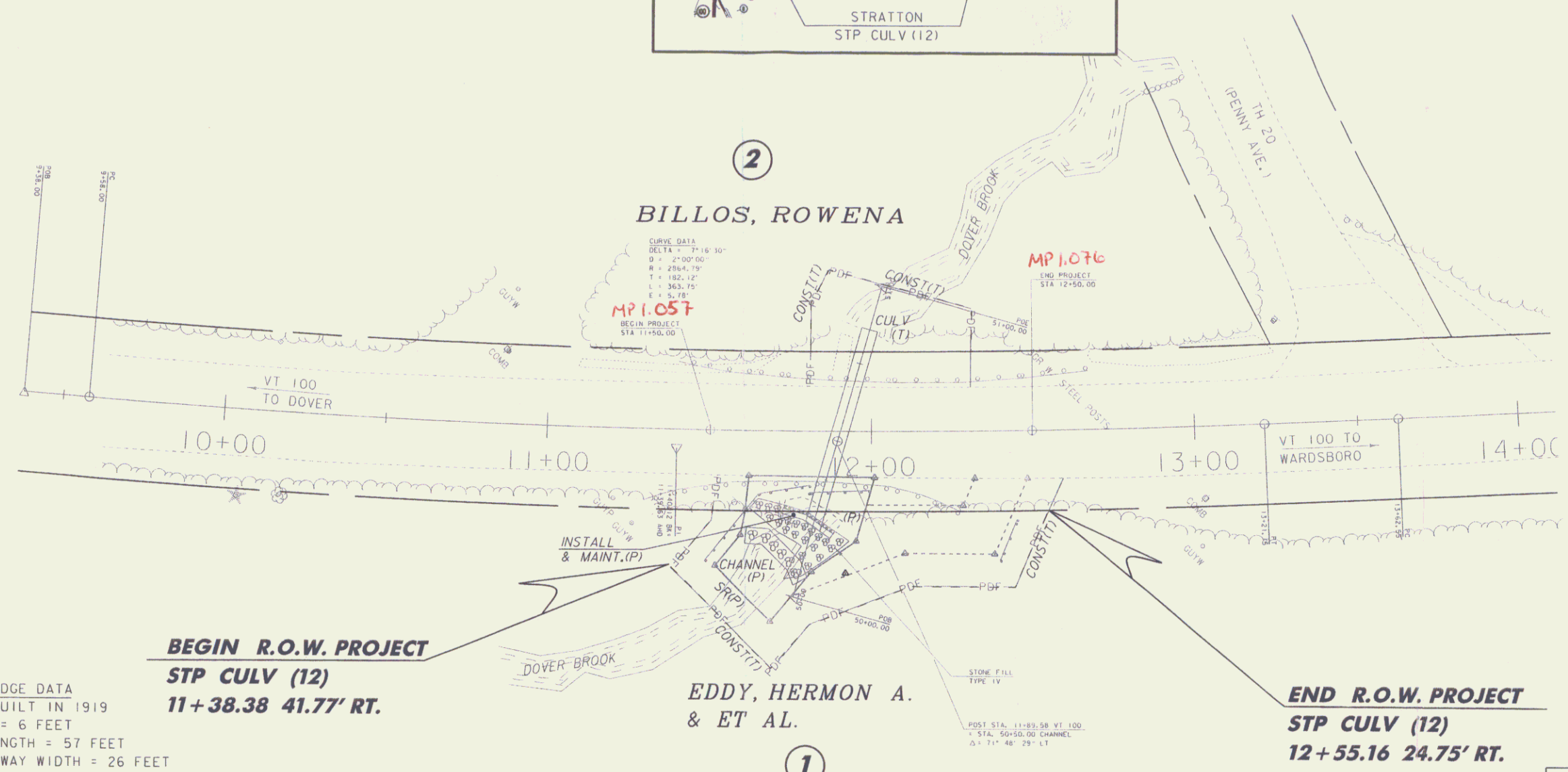
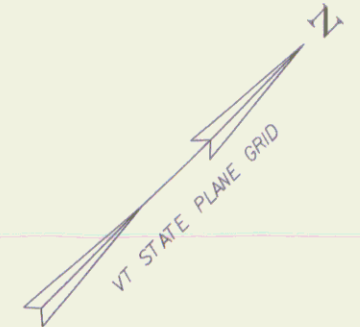
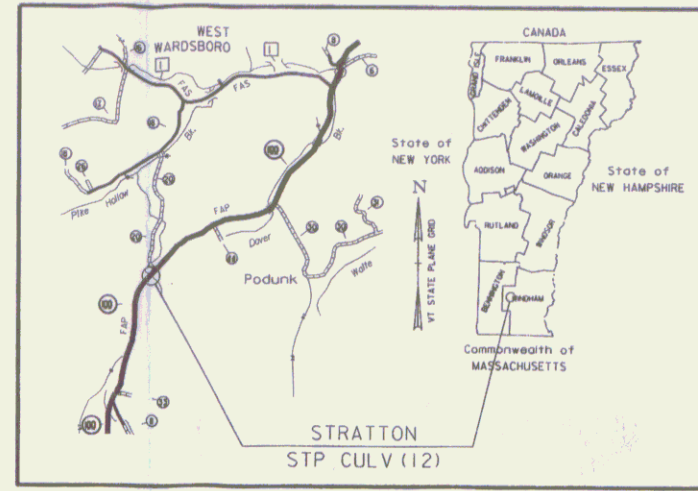

TABLE OF REVISIONS			
REVISION NO.	SHEET NO.	DESCRIPTION	DATE
1	1	PARCEL NO. 2 BILLOS CHANGE CULVERT (P) TO CULVERT (T) REMOVE PER C.O. 9812	
		APPROVED BY: H.P.	
		ELECTRONIC FILES TO STRUCTURES	6-1-18

Pin # 088058  
Route VT100

EXISTING BRIDGE DATA  
72" ACCGMP BUILT IN 1919  
SPAN LENGTH = 6 FEET  
STRUCTURE LENGTH = 57 FEET  
APPROX. ROADWAY WIDTH = 26 FEET

**BEGIN R.O.W. PROJECT**  
**STP CULV (12)**  
**11+38.38 41.77' RT.**

**END R.O.W. PROJECT**  
**STP CULV (12)**  
**12+55.16 24.75' RT.**

TABLE OF PROPERTY ACQUISITION

PARCEL NO.	PROPERTY OWNER	SHEET NO.	BEGINNING STATION	ENDING STATION	TAKE	REMAINDER	RIGHT			RECORDING DATA				REMARKS			
					AREA±	AREA±	TYPE	(T)/(P)	AREA ±	TITLE	DATE	TOWN / CITY	BOOK		PAGE		
1	EDDY, HERMON A. ET AL	1	11+38.38 RT.	12+55.16 RT.			CONST.	(T)	2,389 SF	WD	04/21/10	STRATTON	143	394	INCLUDES EROSION CONTROL & PDF		
							SLOPE	(P)	921 SF								
							CHANNEL	(P)	442 SF								
							INSTALL & MAINT.	(P)	119 SF								
2	BILLOS, ROWENA	1	11+81.14 LT.	12+31.75 LT.			CONST.	(T)	910 SF			STRATTON			INCLUDES EROSION CONTROL & PDF		
							CULVERT	(T)									

**FOR R.O.W. USE ONLY**

LINES SHOWN ON THIS PLAN AS EXISTING PROPERTY LINES P/L ARE BELIEVED TO BE ACCURATE BUT SHOULD NOT BE RELIED UPON FOR PURPOSES UNRELATED TO THE STATE OF VERMONT'S ACQUISITION OF LAND AND RIGHTS FOR THIS PROJECT.

SCALE 1" = 20' - 0"  
20 0 20

PROJECT NAME: STRATTON  
PROJECT NUMBER: STP CULV(12)  
FILE NAME: s08b058bdr.dgn  
PROJECT LEADER: C.P.WILLIAMS  
DESIGNED BY: H.J.SALLS  
ROW SHEET 1  
PLOT DATE: 15-AUG-2018  
DRAWN BY: D.D.BEARD  
CHECKED BY: H.J.SALLS  
ROW SHEET 1 OF 2