

STATE OF VERMONT  
AGENCY OF TRANSPORTATION

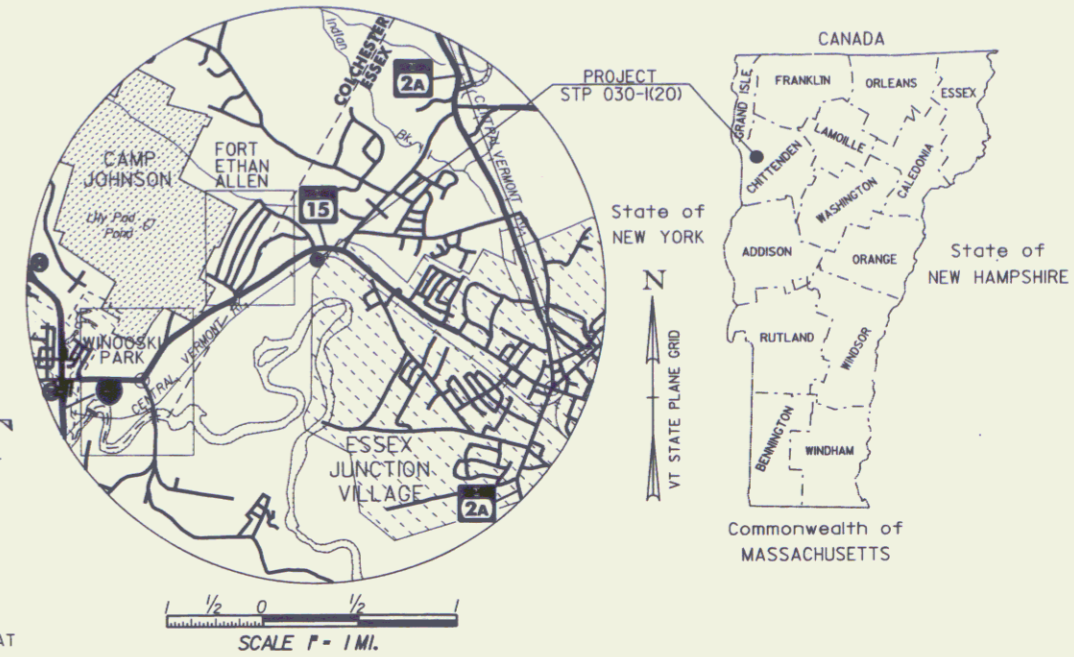

PROPOSED SAFETY IMPROVEMENT  
**TOWN OF ESSEX**  
COUNTY OF CHITTENDEN

R.O.W. PLANS



LOCATED IN THE TOWN OF ESSEX ON VERMONT ROUTE 15, ADJACENT TO THE NEW ENGLAND CENTRAL RAILROAD (NECR), BEGINNING AT VT ROUTE 15 MM 0.20 AND EXTENDING EASTERLY 0.30 MILES TO MM 0.50.

WORK TO BE PERFORMED UNDER THIS PROJECT INCLUDES REPAIR OF A SLIDE AREA ON THE SOUTH SIDE OF THE NECR, INCLUDING NEW DRAINAGE STRUCTURES WITHIN THE HIGHWAY AND RAILROAD ROW, A SLEEVE UNDER THE RAILROAD, AND REPLACEMENT OF RAILROAD TIES AND BALLAST.

LENGTH OF R.O.W. PROJECT = 179'

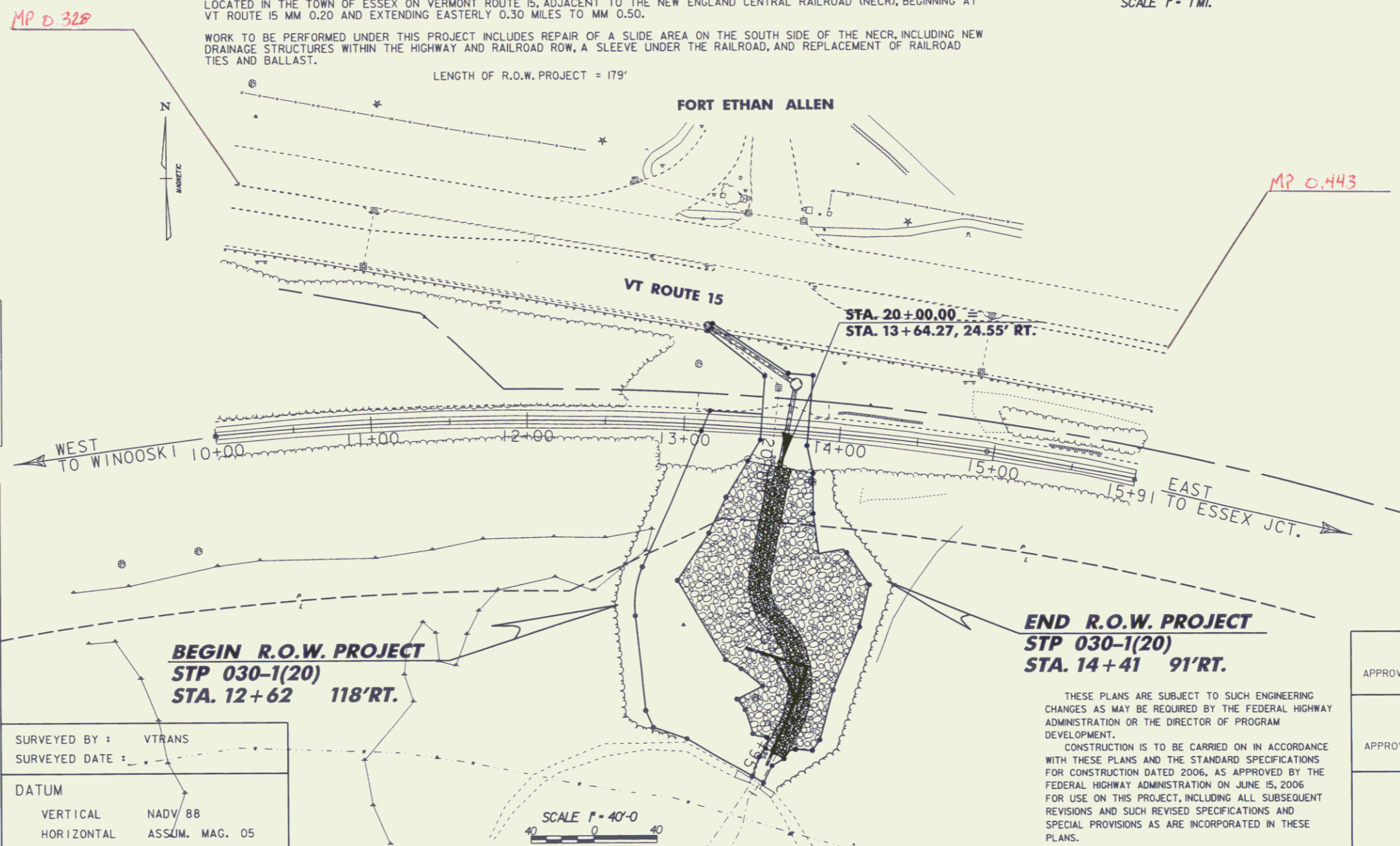

LINES SHOWN ON THIS PLAN AS EXISTING PROPERTY LINES P/L ARE BELIEVED TO BE ACCURATE BUT SHOULD NOT BE RELIED UPON FOR PURPOSES UNRELATED TO THE STATE OF VERMONT'S ACQUISITION OF LAND AND RIGHTS FOR THIS PROJECT.

CONVENTIONAL SYMBOLS	
COUNTY LINE	
TOWN LINE	
LIMITS OF ACCESS	
POINT OF ACCESS	
FENCE LINE	
STONE WALL	
TRAVELED WAY	
GUARD RAIL	
RAILROAD	
SURVEY LINE	
CULVERT	
POWER POLE	
TELEPHONE POLE	
TREES	
CONTROL OF ACCESS	
PROPERTY LINE	
R.O.W. TAKING LINE	
SLOPE RIGHTS	
TOP OF CUT	
TOE OF SLOPE	

SURVEYED BY : VTRANS  
SURVEYED DATE :  
DATUM  
VERTICAL NADY 88  
HORIZONTAL ASSUM. MAG. 05

**END R.O.W. PROJECT**  
**STP 030-1(20)**  
**STA. 14+41 91'RT.**

THESE PLANS ARE SUBJECT TO SUCH ENGINEERING CHANGES AS MAY BE REQUIRED BY THE FEDERAL HIGHWAY ADMINISTRATION OR THE DIRECTOR OF PROGRAM DEVELOPMENT.  
CONSTRUCTION IS TO BE CARRIED ON IN ACCORDANCE WITH THESE PLANS AND THE STANDARD SPECIFICATIONS FOR CONSTRUCTION DATED 2006, AS APPROVED BY THE FEDERAL HIGHWAY ADMINISTRATION ON JUNE 15, 2006 FOR USE ON THIS PROJECT, INCLUDING ALL SUBSEQUENT REVISIONS AND SUCH REVISED SPECIFICATIONS AND SPECIAL PROVISIONS AS ARE INCORPORATED IN THESE PLANS.

APPROVED DATE 3/22/06  
Director of Program Development

APPROVED \_\_\_\_\_ DATE \_\_\_\_\_  
Chief of Right of Way

ESSEX  
STP 030-1(20)  
R.O.W. SHEET 1 OF 10 SHEETS

Pin # 06E206  
Route VT 15