

R. O. W. PLANS

STATE OF VERMONT
AGENCY OF TRANSPORTATION

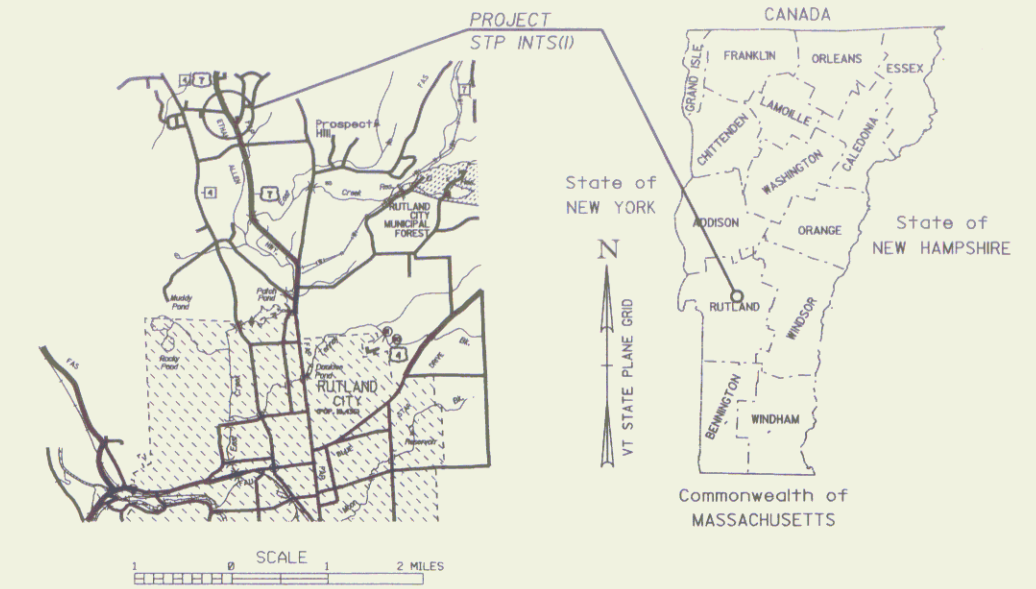

PROPOSED IMPROVEMENT
TOWN OF RUTLAND
COUNTY OF RUTLAND
US RTE 7 (RURAL PRINCIPAL ARTERIAL)



BEGINNING AT A POINT ON US ROUTE 7 APPROXIMATELY 3.35 MILES NORTHERLY OF THE RUTLAND CITY-RUTLAND TOWN LINE, AND EXTENDING NORTHERLY ALONG US ROUTE 7 FOR A DISTANCE OF 0.196 MILES TO THE NORTH.
LENGTH OF ROADWAY 1032.85 FT = 0.196 MILES
LENGTH OF ROW PROJECT 1,046 FT = 0.198 MILES
WORK TO BE PERFORMED UNDER THIS PROJECT CONSISTS OF RESURFACING AND WIDENING A PORTION OF EXISTING U.S. ROUTE 7 TO ADD A NORTHBOUND LEFT TURN LANE, GRADING, SUBBASE, PAVING, GUARDRAIL, SIGNAGE AND OTHER RELATED ITEMS.

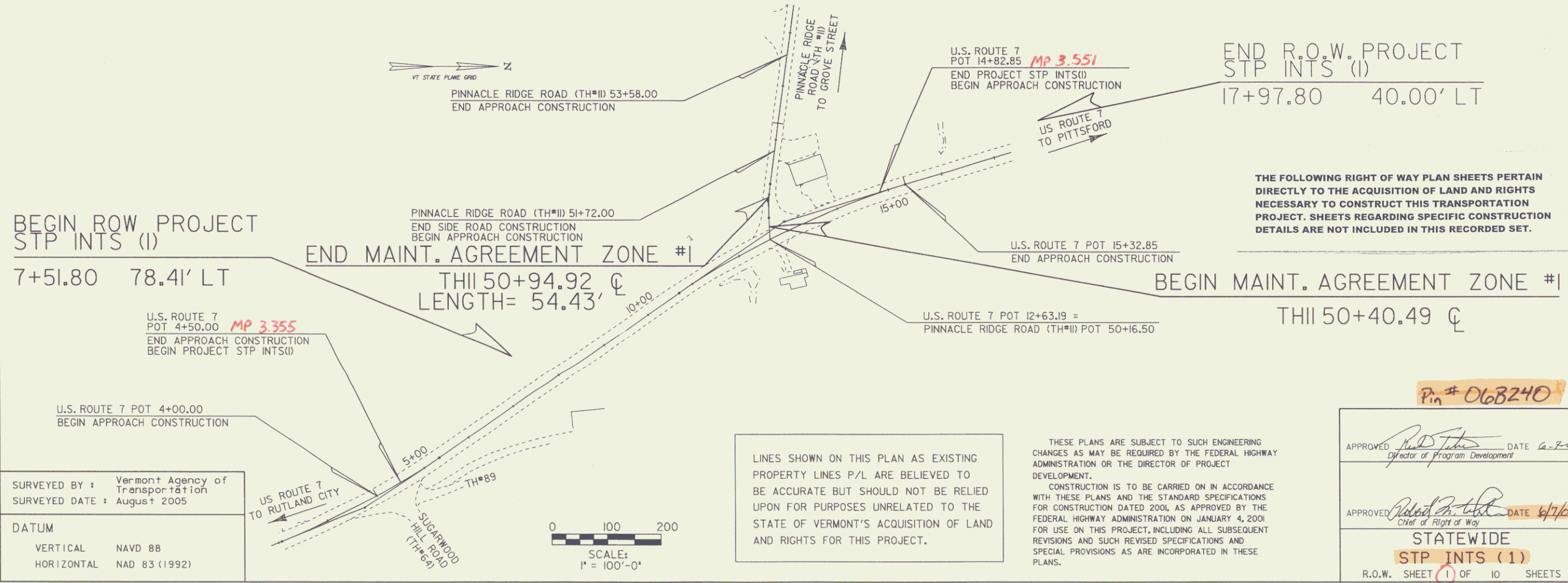

CONVENTIONAL SYMBOLS

COUNTY LINE	———
TOWN LINE	———
LIMITS OF ACCESS	—o—o—o—
POINT OF ACCESS	X
FENCE LINE	—x—x—x—
STONE WALL	—o—o—o—
TRAVELED WAY	—o—o—o—
RAILROAD	—+—+—+—
SURVEY LINE	—+—+—+—
CULVERT	—+—+—+—
POWER POLE	⊕
TELEPHONE POLE	⊕
TREES	⊕
CONTROL OF ACCESS	—+—+—+—
PROPERTY LINE	—+—+—+—
R.O.W. TAKING LINE	—o—o—o—
SLOPE RIGHTS	—o—o—o—
TOP OF CUT	—o—o—o—
TOE OF SLOPE	—o—o—o—

SURVEYED BY : Vermont Agency of Transportation
SURVEYED DATE : August 2005
DATUM
VERTICAL NAVD 88
HORIZONTAL NAD 83 (1992)

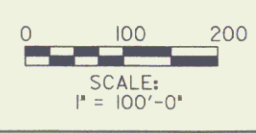

LINES SHOWN ON THIS PLAN AS EXISTING PROPERTY LINES P/L ARE BELIEVED TO BE ACCURATE BUT SHOULD NOT BE RELIED UPON FOR PURPOSES UNRELATED TO THE STATE OF VERMONT'S ACQUISITION OF LAND AND RIGHTS FOR THIS PROJECT.

THESE PLANS ARE SUBJECT TO SUCH ENGINEERING CHANGES AS MAY BE REQUIRED BY THE FEDERAL HIGHWAY ADMINISTRATION OR THE DIRECTOR OF PROJECT DEVELOPMENT.
CONSTRUCTION IS TO BE CARRIED ON IN ACCORDANCE WITH THESE PLANS AND THE STANDARD SPECIFICATIONS FOR CONSTRUCTION DATED 2004 AS APPROVED BY THE FEDERAL HIGHWAY ADMINISTRATION ON JANUARY 4, 2001 FOR USE ON THIS PROJECT, INCLUDING ALL SUBSEQUENT REVISIONS AND SUCH REVISED SPECIFICATIONS AND SPECIAL PROVISIONS AS ARE INCORPORATED IN THESE PLANS.

THE FOLLOWING RIGHT OF WAY PLAN SHEETS PERTAIN DIRECTLY TO THE ACQUISITION OF LAND AND RIGHTS NECESSARY TO CONSTRUCT THIS TRANSPORTATION PROJECT. SHEETS REGARDING SPECIFIC CONSTRUCTION DETAILS ARE NOT INCLUDED IN THIS RECORDED SET.

Pin # 068240

APPROVED: *[Signature]* DATE 6-7-07
Director of Program Development

APPROVED: *[Signature]* DATE 6/1/07
Chief of Right of Way

STATEWIDE
STP INTS (1)
R.O.W. SHEET 1 OF 10 SHEETS