

INSTALL HYDRANT (DRY HYDRANT)
STA. 61+34.00 - 62+04.92 LT

DELINEATOR WITH STEEL POST (TYPE 1)
STA. 59+84 LT (GREEN)
STA. 59+81 RT (BLUE)

REMOVAL AND DISPOSAL OF GUARDRAIL
STA. 60+43.09 - 60+84.28 RT
STA. 59+22.82 - 60+85.48 LT
STA. 61+50.29 - 63+37.35 RT
STA. 61+49.41 - 62+25.00 LT

HEAVY DUTY STEEL BEAM GUARDRAIL, GALVANIZED
STA. 59+69.40 - 60+58.90 LT
STA. 59+61.67 - 60+57.17 RT
STA. 62+09.73 - 62+25.00 LT
STA. 62+10.04 - 62+25.00 RT

ANCHORS FOR HEAVY DUTY STEEL BEAM GUARDRAIL
STA. 59+78.90 LT
STA. 59+75.00 RT

CONSTRUCT DRIVE
STA. 57+58 LT, 19' - GRAVEL
STA. 58+11 LT, 14' - GRAVEL
STA. 57+97 RT, 12' - GRAVEL

REMOVAL OF EXISTING FENCE
STA. 58+50 - STA. 61+00 RT
STA. 59+00 - STA. 60+00 LT
STA. 62+15 - STA. 62+20 LT

4" YELLOW LINE (DOUBLE)
STA. 57+50 - 62+25

4" WHITE LINE
STA. 57+50 - 62+25 LT
STA. 57+50 - 62+25 RT

BEGIN R.O.W. PROJECT
ER ST 0271(16)
STA. 56+21.00
33.44 RT.

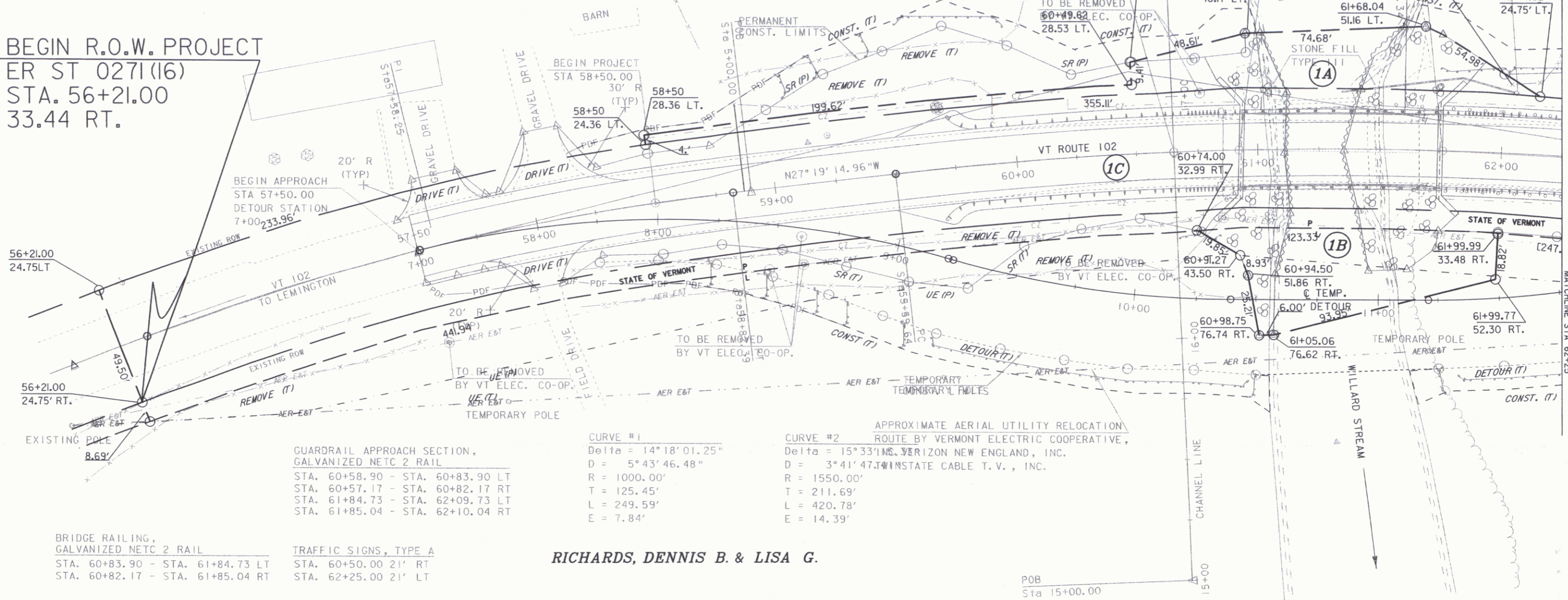

GUARDRAIL APPROACH SECTION, GALVANIZED NETC 2 RAIL
STA. 60+58.90 - STA. 60+83.90 LT
STA. 60+57.17 - STA. 60+82.17 RT
STA. 61+84.73 - STA. 62+09.73 LT
STA. 61+85.04 - STA. 62+10.04 RT

BRIDGE RAILING, GALVANIZED NETC 2 RAIL
STA. 60+83.90 - STA. 61+84.73 LT
STA. 60+82.17 - STA. 61+85.04 RT

TRAFFIC SIGNS, TYPE A
STA. 60+50.00 21' RT
STA. 62+25.00 21' LT

PREVIOUS BRIDGE DATA
SINGLE SPAN OPEN BOTTOM CONCRETE ARCH - DESTROYED IN 2004 FLOOD
CLEAR SPAN (NORMAL TO STREAM): 31 FEET MIN.
OVERALL LENGTH: 34.5 FEET BACK TO BACK OF ABUTMENTS
VERTICAL CLEARANCE: 7 FEET
BRIDGE WIDTH: +/- 34.5 FEET FACE OF RAIL TO FACE OF RAIL

CURVE #1
Delta = 14° 18' 01.25"
D = 5° 43' 46.48"
R = 1000.00'
T = 125.45'
L = 249.59'
E = 7.84'

CURVE #2
Delta = 15° 33' 11.33"
D = 3° 41' 47.14"
R = 1550.00'
T = 211.69'
L = 420.78'
E = 14.39'

RICHARDS, DENNIS B. & LISA G.

CURRENT STRUCTURE
WIDTH: 24
LENGTH: 80

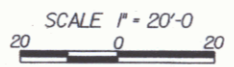

LINES SHOWN ON THIS PLAN AS EXISTING PROPERTY LINES P/L ARE BELIEVED TO BE ACCURATE BUT SHOULD NOT BE RELIED UPON FOR PURPOSES UNRELATED TO THE STATE OF VERMONT'S ACQUISITION OF LAND AND RIGHTS FOR THIS PROJECT.

ROW LAYOUT SHEET #1

PROJECT NAME:	Canaan
PROJECT NUMBER:	ER ST 0271(16)
FILE NAME:	04c098\struc\04c098bdr
PROJECT LEADER:	M. Evans-Mongeon
DESIGNED BY:	S. Scribner
ROW SHEET (14) OF 15	
PLOT DATE:	22-JUL-2008
DRAWN BY:	L. DUQUETTE
CHECKED BY:	S. SCRIBNER
	SHEET 9 OF 66