

**CONSTRUCTION NOTES**

**EXCAVATION OF SURFACES AND PAVEMENTS**

STATION 1+50, LT. - 105+00, RT.  
STATION 104+50, LT. - 3+40, LT.

**COLD PLANING - BITUMINOUS PAVEMENT**

STATION 100+75 - 101+25  
STATION 1+00 - 1+50  
STATION 6+31 - 6+81

**RELOCATE MAILBOX - SINGLE SUPPORT**

STATION 101+63, LT.  
STATION 104+90, LT.  
STATION 4+35, LT.  
STATION 4+54, RT.  
STATION 4+90, LT.  
STATION 5+18, RT.  
STATION 6+33, RT.  
STATION 6+55, LT.

**RELOCATE MAILBOX - MULTIPLE SUPPORT**

STATION 3+87, LT.

**VERTICAL GRANITE CURB**

STATION 1+50, LT. - 105+08.4, RT.  
STATION 105+16, LT. - 3+35.2, LT.  
STATION 3+78.2 - 4+27.8, LT.  
STATION 4+86.2 - 6+07.4, LT.

**CONSTRUCT DRIVES - 1 1/2" BCP, TYPE III**

STATION 101+75, RT. - 28' WIDE  
STATION 102+73, LT. - 30' WIDE  
STATION 105+01, LT. - 10' WIDE  
STATION 3+35, RT. - 29' WIDE (COMM.)  
STATION 3+57, LT. - 23' WIDE  
STATION 4+43, LT. - 20' WIDE (COMM.)  
STATION 4+70, LT. - 13.5' WIDE  
STATION 4+73, RT. - 14.5' WIDE  
STATION 5+85, RT. - 99' WIDE  
STATION 6+30, LT. - 24' WIDE

**TRANSPLANTING SHRUBS**

STATION 103+00 - 104+15, RT. (14 SHRUBS)

**REMOVE & RESET SIGN (COMM. - LIGHTED)**

STATION 4+00, LT. (3 SIGNS)

**DRAINAGE NOTES**

- ① STA. 2+15.1, RT. 24.8 - STA. 2+12.8, RT. 16.8  
NEW PRECAST DI, TYPE A  
RIM ELEV. = 355.15  
NEW 12" x 4.5 LF PCOSP  
INV. OUT = 351.95
- ② STA. 2+12.8, RT. 16.8  
ADJUST DI  
REMOVE DI GRATE & FRAME  
REPLACE WITH MH COVER & FRAME  
RIM ELEV. = 356.08
- ③ STA. 3+71.0, RT. 41.0  
REMOVE EXIST DI  
NEW PRECAST DI, TYPE D  
CONST. OVER EXIST. 6" PVC  
RIM ELEV. = 356.00
- ④ STA. 3+54.1, RT. 24.6  
ADJUST DI  
REMOVE DI GRATE & FRAME  
REPLACE WITH MH COVER & FRAME  
RIM ELEV. = 356.47

- ⑤ STA. 4+88.2, LT. 24.8 - STA. 4+13.1, LT. 26.0  
NEW PRECAST DI, TYPE D  
RIM ELEV. = 359.69  
NEW 15" x 7.2 LF PCOSP  
15" INV. OUT (S) = 354.25
- ⑥ STA. 4+05.0, LT. 41.6 - STA. 4+13.0, LT. 26.0  
NEW PRECAST DI, TYPE A  
RIM ELEV. = 357.64  
NEW 12" x 13.1 LF PCOSP  
INV. OUT = 354.43
- ⑦ STA. 4+13.1, LT. 26.0  
NEW PRECAST DI, TYPE D  
RIM ELEV. = 359.27  
15" INV. OUT (E) = 353.3 (Exist.)  
15" INV. IN (N) = 353.55  
12" INV. IN (W) = 353.65  
REMOVE EXIST. DI
- ⑧ STA. 3+00, LT. 26.0 - STA. 105+25.0, LT. 17.7  
NEW PRECAST DI, TYPE D  
RIM ELEV. = 358.10  
NEW 12" x 55.5 LF PCOSP  
INV. OUT = 352.76
- ⑨ STA. 105+09.5, LT. 28.1 - STA. 105+25.0, LT. 17.7  
NEW PRECAST DI, TYPE A  
RIM ELEV. = 353.00  
NEW 12" x 16.0 LF PCOSP  
12" INV. OUT = 349.83

- ⑩ STA. 105+25.0, LT. 17.7 - STA. 105+25.0, RT. 59.1  
NEW PRECAST DI, TYPE D  
RIM ELEV. = 355.05  
NEW 18" x 74.9 LF RCP  
18" INV. OUT = 349.75  
12" INV. IN (S) = 349.75  
12" INV. IN (N) = 350.43  
INV. AT OUTLET = 349.37  
CONST. TYPE II STONE PAD (2' x 5' x 2' DEEP)
- ⑪ STA. 103+00.0, LT. 21.3  
NEW PRECAST DI, TYPE A  
RIM ELEV. = 337.50  
INV. OUT = 331.0 (Exist.)
- ⑫ STA. 5+02.8, LT. 29.4 - STA. 5+53.4, LT. 27.2  
REMOVE 47 LF X 12" RCP  
REMOVE DI, +53.4, LT. 27.2
- ⑬ STA. 4+14.2, LT. 27.3 - STA. 5+02.8, LT. 29.4  
REMOVE 83 LF X 12" RCP  
REMOVE DI, +02.8, LT. 29.4

**NOTES**

- 1. THE DRAINAGE STRUCTURE RIM AND INVERT ELEVATIONS ARE BASED ON SURVEY INFORMATION FROM AERIAL SURVEY. THE CONTRACTOR SHALL SET ACTUAL RIM ELEVATIONS ONE INCH BELOW FINISHED PAVEMENT ELEVATIONS. THE CONTRACTOR SHALL FIELD CHECK PROPOSED PIPE INVERTS BEFORE ORDERING DRAINAGE STRUCTURES.
- 2. THE USE OF BRICK AND MORTAR TO ADJUST THE ELEVATION OF DRAINAGE STRUCTURES IS PROHIBITED. ALL ELEVATION ADJUSTMENTS SHALL BE MADE USING EITHER GRADE RINGS OR A SYNTHETIC RISER.
- 3. ALL CONNECTIONS BETWEEN PRECAST DRAINAGE STRUCTURES AND DRAINAGE PIPES SHALL BE A BOOTED CONNECTION.

04B206

PROJECT NAME: HINESBURG  
PROJECT NUMBER: HES 021-K20

FILE NAME: \*\*\*FILENAME\*\*\*  
PROJECT LEADER: G. BAKOS  
DESIGNED BY: D. PECK

PLOT DATE: 05-MAR-2008  
DRAWN BY: D. PECK  
CHECKED BY: G. BAKOS  
R. O. W. SHEET 9 OF 9

|                                  |         |
|----------------------------------|---------|
| AERIAL SURVEY BY: COL-EAST, INC. |         |
| SURVEYED DATE: 2004              |         |
| DATUM                            |         |
| VERTICAL                         | NAVD 88 |
| HORIZONTAL                       | NAD 83  |

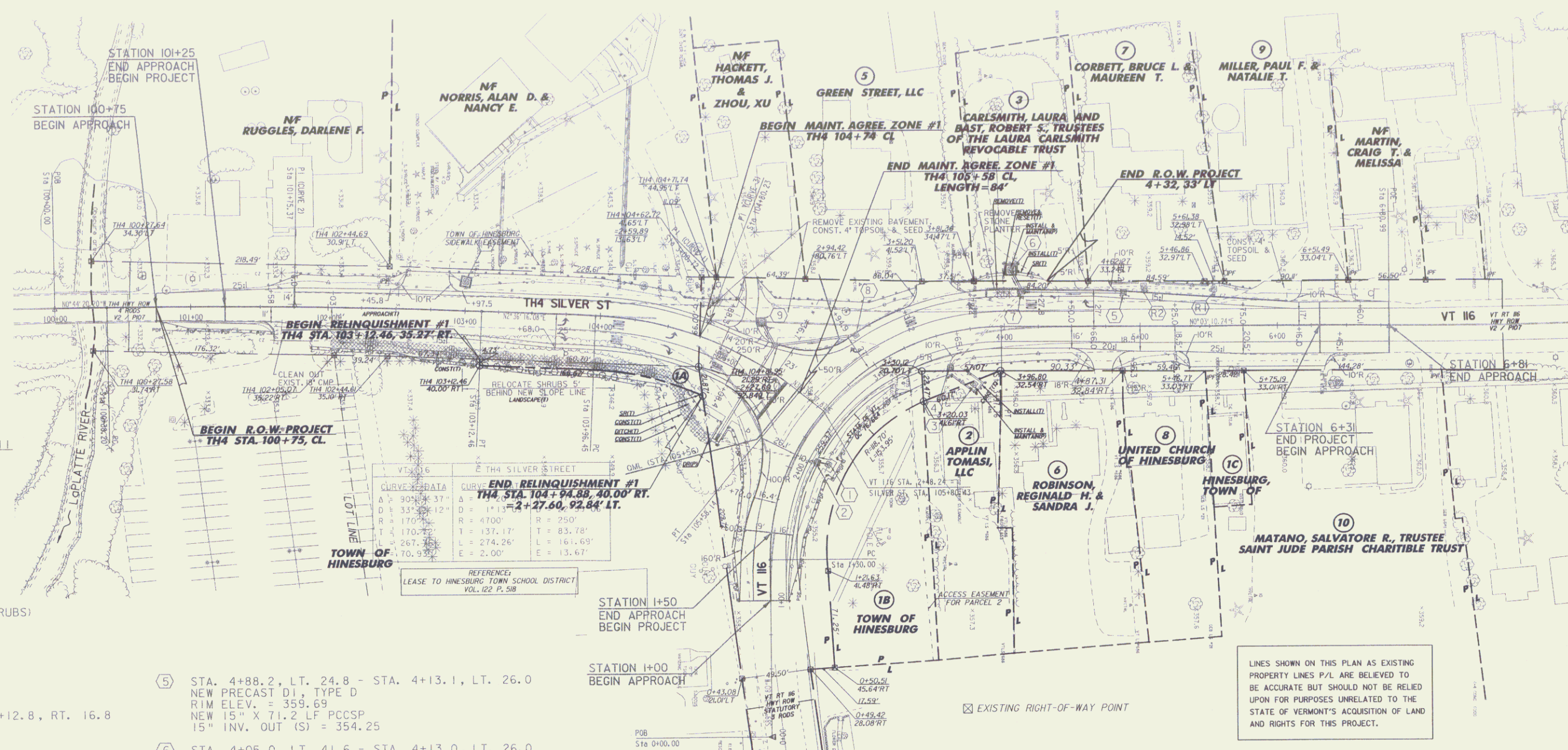
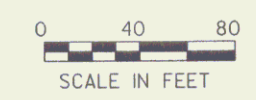

LINES SHOWN ON THIS PLAN AS EXISTING PROPERTY LINES P/L ARE BELIEVED TO BE ACCURATE BUT SHOULD NOT BE RELED UPON FOR PURPOSES UNRELATED TO THE STATE OF VERMONT'S ACQUISITION OF LAND AND RIGHTS FOR THIS PROJECT.