

BEGINNING STATION	ENDING STATION	TAKING	REMARKS
409+14 LT.	415+00 LT.	.25A±	10.685 S.F.±

TOWN OF PITTSFORD
 Pin # 02B196
 Project NH 019-3(493)
 Route US 7
 Date 10/29/1996

THOMAS J. & KELLEY H. TURNER

LINES SHOWN ON THIS PLAN AS EXISTING PROPERTY LINES P/L ARE BELIEVED TO BE ACCURATE BUT SHOULD NOT BE RELIED UPON FOR PURPOSES UNRELATED TO THE STATE OF VERMONT'S ACQUISITION OF LAND AND RIGHTS FOR THIS PROJECT.

DATUM
 VERTICAL _____
 HORIZONTAL _____

0 20 40
 SCALE IN FEET

PROJECT: PITTSFORD RIGHT TURN LANE	PROJECT NO.:
DESIGN FILE NAME:	PLOT DATE: 11-SEP-1997
IPARM FILE NAME:	SURVEY DATE:
SURVEYED BY:	DRAWN BY:
SQUAD LEADER:	R. O. W. SHEET 1 OF 2

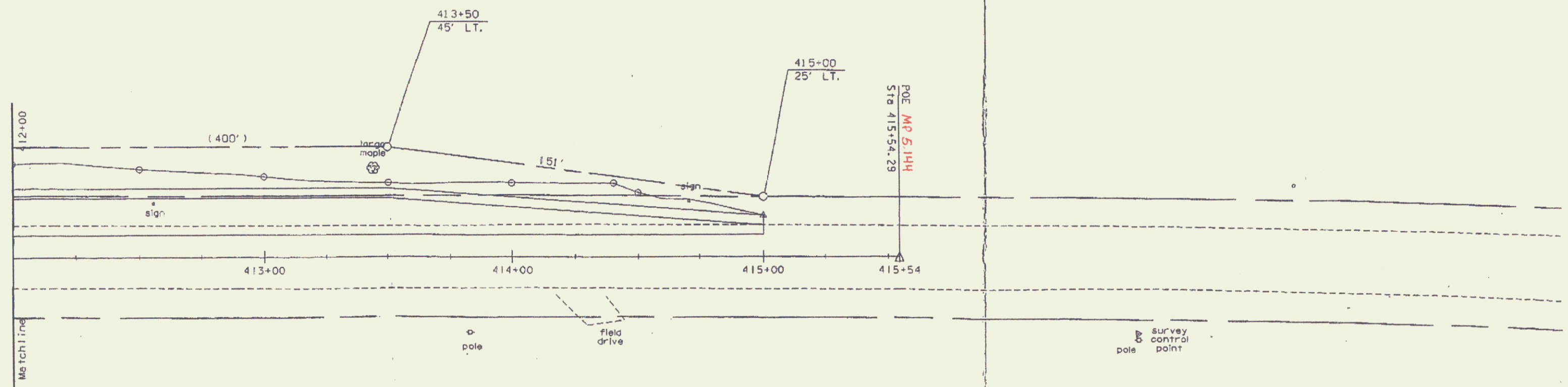
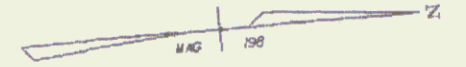

LINES SHOWN ON THIS PLAN AS EXISTING PROPERTY LINES P/L ARE BELIEVED TO BE ACCURATE BUT SHOULD NOT BE RELIED UPON FOR PURPOSES UNRELATED TO THE STATE OF VERMONT'S ACQUISITION OF LAND AND RIGHTS FOR THIS PROJECT.

LTUM
VERTICAL _____
HORIZONTAL _____

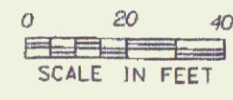

PROJECT: PITTSFORD RIGHT TURN LANE	PROJECT NO.:
DESIGN FILE NAME:	PLOT DATE: 11-SEP-1997
IPARM FILE NAME:	SURVEY DATE:
SURVEYED BY:	DRAWN BY:
SQUAD LEADER:	

R. O. W. SHEET 2 OF 2