

Original Drawing - Ink on polymer meeting the requirements of 27 V.S.A. § 1403

# STATE OF VERMONT AGENCY OF TRANSPORTATION



R.O.W. PLANS

## PROPOSED IMPROVEMENT TOWN OF BARTON, VILLAGE OF ORLEANS COUNTY OF ORLEANS

ROUTE NO : TH #3, CL 3      BRIDGE NO : #61

**PROJECT LOCATION :** LOCATED IN THE COUNTY OF ORLEANS, VILLAGE OF ORLEANS, ON TOWN HIGHWAY #3 (EAST STREET), BRIDGE #61 OVER THE WILLOUGHBY RIVER, APPROXIMATELY 0.2 MILE EAST OF THE JUNCTION OF TOWN HIGHWAY #1.

**PROJECT DESCRIPTION :** THE PROJECT SHALL CONSIST OF THE CONSTRUCTION OF A NEW BRIDGE WITH RELATED APPROACH AND CHANNEL CONSTRUCTION.

LENGTH OF STRUCTURE : 114.25 FEET.  
LENGTH OF ROADWAY : 85.75 FEET.  
LENGTH OF PROJECT : 200.00 FEET.  
LENGTH OF R.O.W. PROJECT : 436.37 FEET

THE FOLLOWING RIGHT OF WAY PLAN SHEETS PERTAIN DIRECTLY TO THE ACQUISITION OF LAND AND RIGHTS NECESSARY TO CONSTRUCT THIS TRANSPORTATION PROJECT. SHEETS REGARDING SPECIFIC CONSTRUCTION DETAILS ARE NOT INCLUDED IN THIS RECORDED SET.

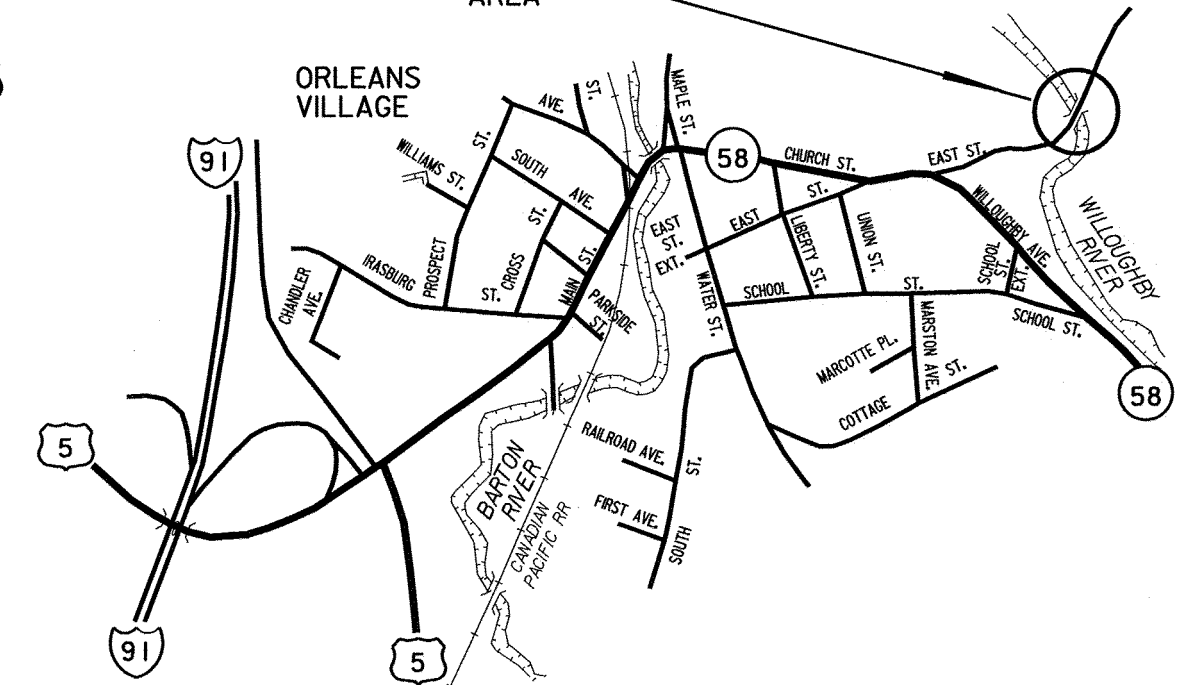
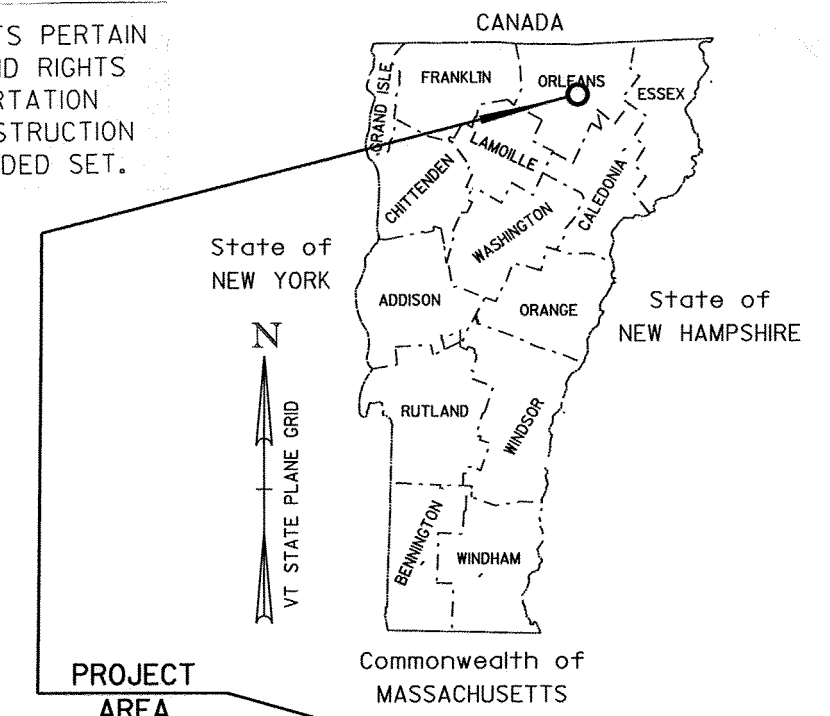

Not To Scale

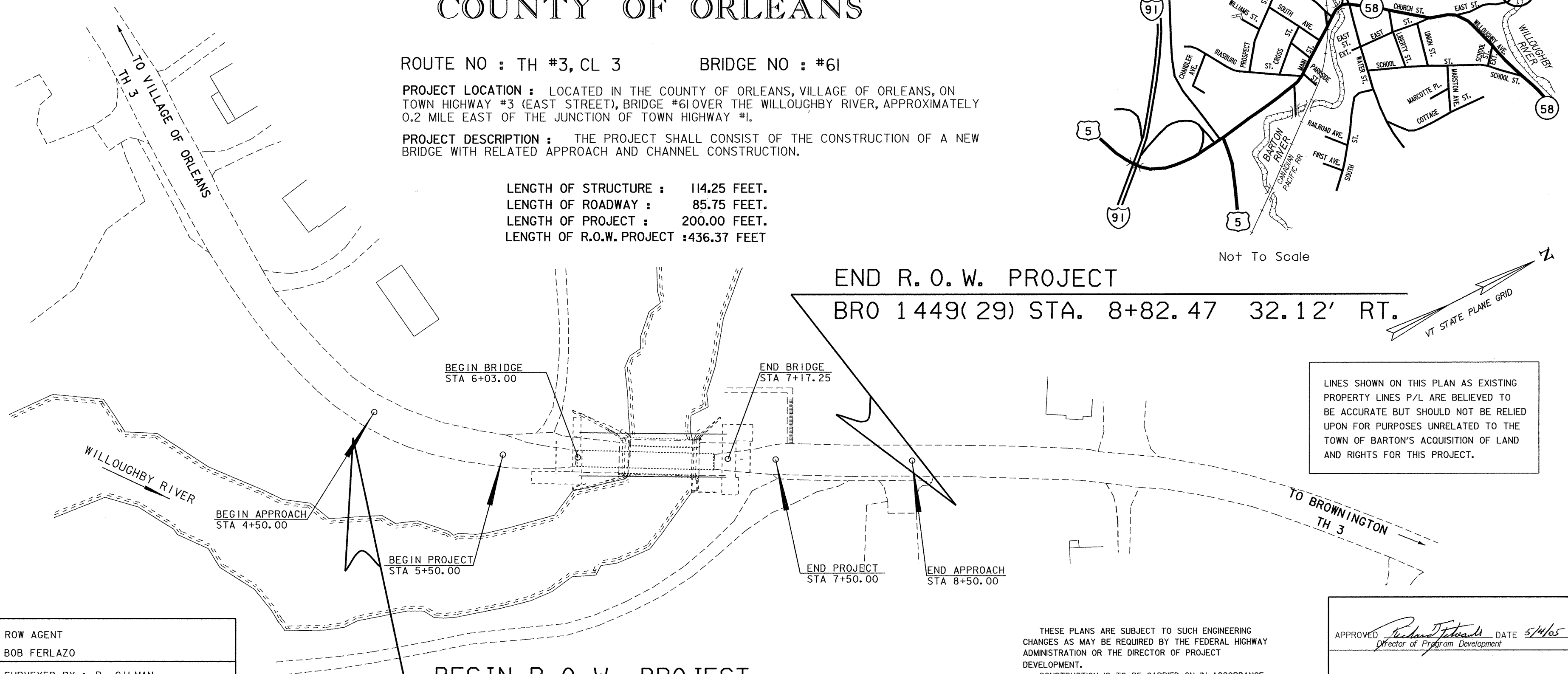

END R. O. W. PROJECT  
BRO 1449(29) STA. 8+82.47 32.12' RT.

BEGIN R. O. W. PROJECT  
BRO 1449(29) STA. 4+46.10 24.10' RT.

LINES SHOWN ON THIS PLAN AS EXISTING PROPERTY LINES P/L ARE BELIEVED TO BE ACCURATE BUT SHOULD NOT BE RELIED UPON FOR PURPOSES UNRELATED TO THE TOWN OF BARTON'S ACQUISITION OF LAND AND RIGHTS FOR THIS PROJECT.

CONVENTIONAL SYMBOLS	
COUNTY LINE	
TOWN LINE	
LIMITS OF ACCESS	
POINT OF ACCESS	
FENCE LINE	
STONE WALL	
TRAVELED WAY	
GUARD RAIL	
RAILROAD	
SURVEY LINE	
CULVERT	
POWER POLE	
TELEPHONE POLE	
TREES	
CONTROL OF ACCESS	
PROPERTY LINE	
R.O.W. TAKING LINE	
SLOPE RIGHTS	
TOP OF CUT	
TOE OF SLOPE	

ROW AGENT  
BOB FERLAZO

SURVEYED BY : R. GILMAN  
SURVEYED DATE : 10/2001

DATUM  
VERTICAL NAVD 88  
HORIZONTAL NAD 83 (96)

THESE PLANS ARE SUBJECT TO SUCH ENGINEERING CHANGES AS MAY BE REQUIRED BY THE FEDERAL HIGHWAY ADMINISTRATION OR THE DIRECTOR OF PROJECT DEVELOPMENT.

CONSTRUCTION IS TO BE CARRIED ON IN ACCORDANCE WITH THESE PLANS AND THE STANDARD SPECIFICATIONS FOR CONSTRUCTION DATED 2001, AS APPROVED BY THE FEDERAL HIGHWAY ADMINISTRATION ON JANUARY 4, 2001 FOR USE ON THIS PROJECT, INCLUDING ALL SUBSEQUENT REVISIONS AND SUCH REVISED SPECIFICATIONS AND SPECIAL PROVISIONS AS ARE INCORPORATED IN THESE PLANS.

APPROVED *Richard J. Fitch* DATE 5/4/05  
Director of Program Development

APPROVED *William J. Moore* DATE 5/2/05  
Chief of Right of Way

**BARTON**  
BRO 1449(29)  
R.O.W. SHEET 1 OF 13 SHEETS

