

TOWN OF HANCOCK
 Project ST 187-L
 Pin # 01R417
 Route VT 125
 Date 12/17/1957

ST
 187-L 1941 7 14

Curve Data
 $\Delta = 6^\circ 47' 44''$
 $D = 44'$
 $R = 1432.7$
 $T = 110.0$
 $L = 219.6$
 $E = 4.2$
 Bank 1/8 per ft.

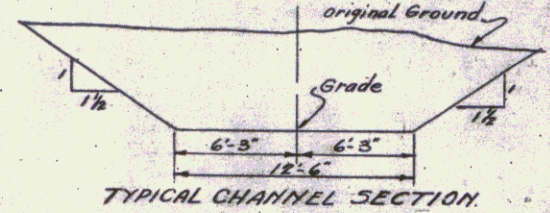
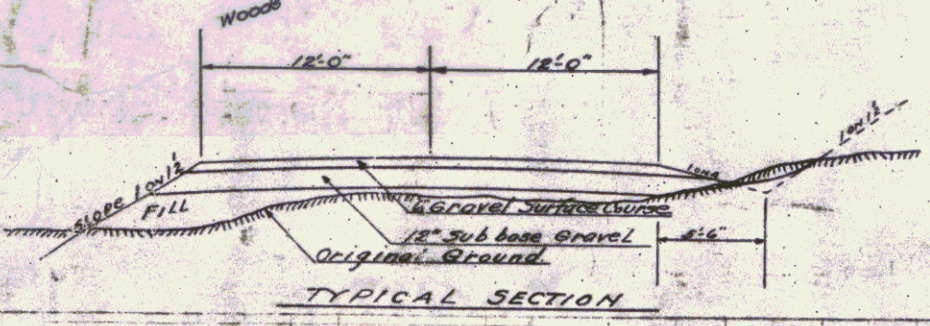
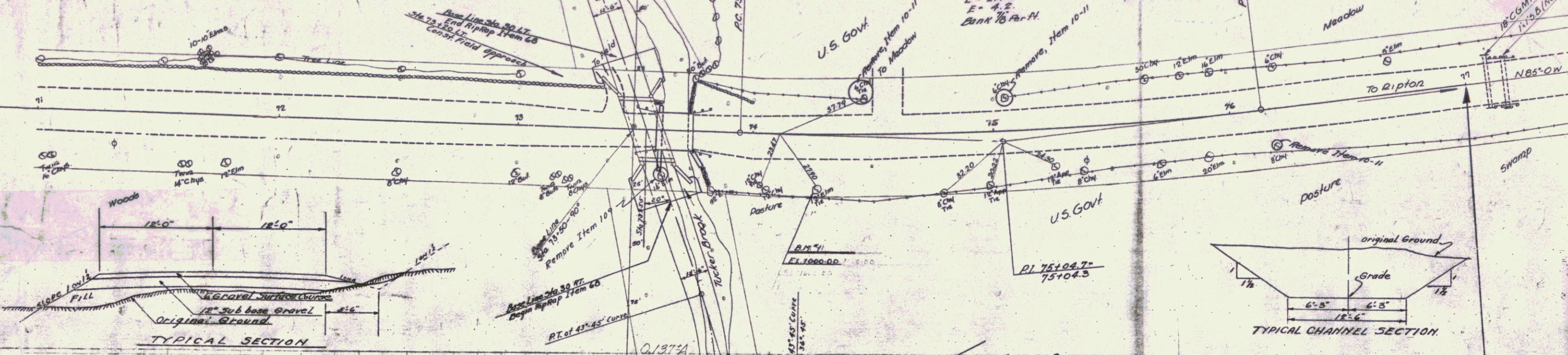

Sta 70+50
 Begin Project
 MP 5.915

BRIDGE DATA		
TYPE	Present	Proposed
Span	10'-6"	12'-6"
Clear Height	4'-0"	5'-0"
Waterway	40'-0"	62'-0"
Length Overall	75'	15'
roadway Width	14'	24'

- LIST OF SHEETS
- 1 PLAN & PROFILE
 - 2 SLAB DETAILS FOR 20' SPAN
 - 3 ABUTMENTS DETAILS
 - 4 SB-SC CURB & RAIL
 - 5 SB-11 BARRICADES LIGHTS SIGNS
 - 6 SB-20 DETAILS (CONDIFIED) E.T.
 - 7 3'-30" CABLE GUARD RAIL
 - 8-10 ROAD SECTIONS
 - 11-14 CHANNEL SECTIONS

- LIST OF QUANTITIES
- | | |
|---------------------------------------|-----------|
| 10-H COMMON EXCAVATION INC. BORROW | 700 C.Y. |
| 15 CHANNEL EXCAVATION | 800 C.Y. |
| 16 STRUCTURE EXCAVATION | 300 C.Y. |
| 18-B TEMP BRIDGE & TRAFFIC | 1 L.S. |
| 17-C SUB-BASE OF GRAVEL | 720 C.Y. |
| 22 GRAVEL SURFACE COURSE | 310 C.Y. |
| 41-A CONCRETE CLASS "A" | 24 C.Y. |
| 42 REINFORCING STEEL | 3430 Lbs. |
| 45 CEMENT MORTAR MASONRY | 134 C.Y. |
| 57 REMOVAL OF PRESENT SUPERSTRUCTURE | 1 L.S. |
| 68 RIP-RAP FOR BANK PROTECTION (M.T.) | 50 C.Y. |
| 80-A CABLE GUARD RAIL | 64 L.F. |
| 80-B ANCHORS FOR CABLE GUARD RAIL | 4 Each |
| 109 CUTTING & REMOVING TREES | 1 Each |

MP 5.772
 Sta 71+00
 End Project

APPROVED: Aug 13 1961
 O. P. Harding By G. R. Perkins (Acting)
 DISTRICT HIGHWAY COMMISSIONER

CORRECTED
 A. D. Wilbur
 BRIDGE ENGINEER

APPROVED: Sept 4, 1961
 Commissioner of Highways.

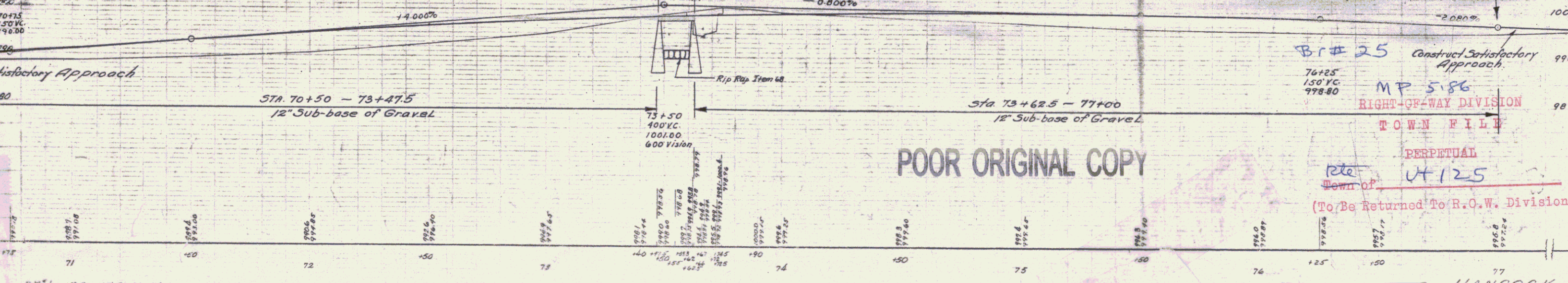

POOR ORIGINAL COPY

Br # 25 Construct Satisfactory Approach
 76+25
 150 VC
 778.80

MP 5.86
 RIGHT-OF-WAY DIVISION
 TOWN FILE
 PERPETUAL
 rte
 Town of VT 125
 (To Be Returned To R.O.W. Division)

B.M. 1 - 12' Elm 25 ft Sta. 74+27 EL. 1000.00

77
 HANCOCK
 ST 187-L
 SHEET 1 of 14

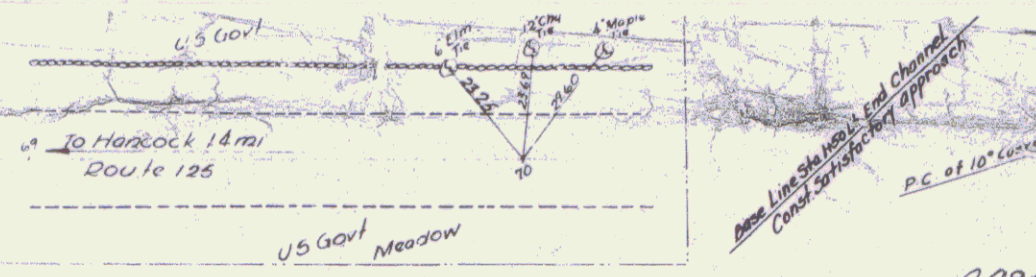

Curve Data
 $\Delta = 8^\circ 47' 15''$
 $D = 4'$
 $R = 1432.7$
 $T = 110.0$
 $L = 219.6$
 $E = 4.2$
 Bank 7/8 Per 74

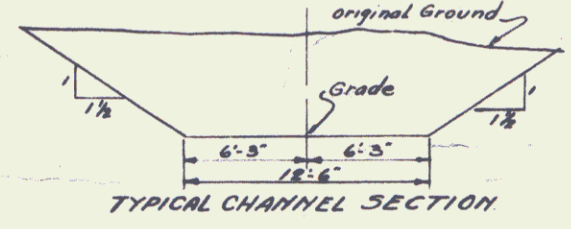
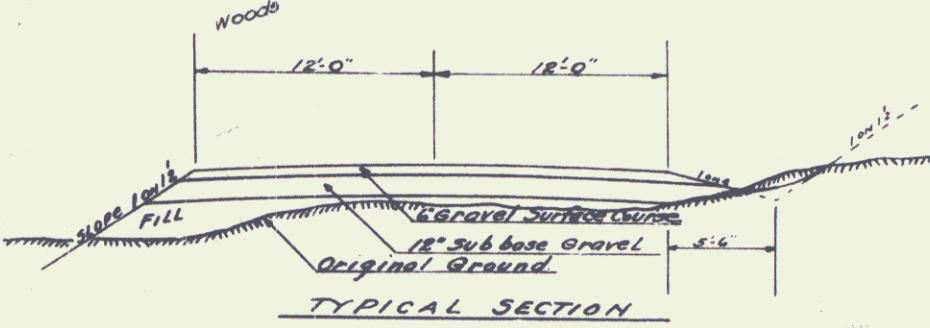

Sta 70+50
 Begin Project

Sta 77+00
 End Project

BRIDGE DATA		
TYPE	Present	Proposed
Span	10'-6"	12'-6"
Clear Height	4'-0"	5'-0"
Waterway	40'	62'
Length Overall	15'	15'
Roadway Width	14'	24'

- LIST OF SHEETS
- 1 PLAN & PROFILE
 - 2 SLAB DETAILS FOR 20" S&W
 - 3 ABUTMENTS DETAILS
 - 4 SB-3C CURB & RAIL
 - 5 SB-11 BARRICADES LIGHTS SIGNS
 - 6 SB-20 DETAILS C/PROVIDED & U.
 - 7 SB-30 CABLE GUARD RAIL
 - 8-10 ROAD SECTIONS
 - 11-14 CHANNEL SECTIONS

- LIST OF QUANTITIES
- | | |
|--------------------------------------|-----------|
| 10-11 COMMON EXCAVATION INC. BORROW | 700 C.Y. |
| 15 CHANNEL EXCAVATION | 800 C.Y. |
| 16 STRUCTURE EXCAVATION | 300 C.Y. |
| 18-B TEMP BRIDGE E/PAINT OF TRAFFIC | 1 L.S. |
| 17-C SUB-BASE OF GRAVEL | 780 C.Y. |
| 22 GRAVEL SURFACE COURSE | 310 C.Y. |
| 41-A CONCRETE CLASS "A" | 24 C.Y. |
| 42 REINFORCING STEEL | 3430 LBS. |
| 43 CEMENT MORTAR MASONRY | 134 C.Y. |
| 51 REMOVAL OF PRESENT SUPERSTRUCTURE | 1 L.S. |
| 68 RIP-RAP FOR BANK PROTECTION | 50 C.Y. |
| 80-A CABLE GUARD RAIL | 64 L.F. |
| 80-B ANCHORS FOR CABLE GUARD RAIL | 4 Each |
| 109 CUTTING & REMOVING TREES | 1 Each |

APPROVED: (Aug 13, 1941)
 DISTRICT HIGHWAY COMMISSIONER

CORRECTED: 1941
 BRIDGE ENGINEER

APPROVED: Sept 4, 1941
 COMMISSIONER OF HIGHWAYS

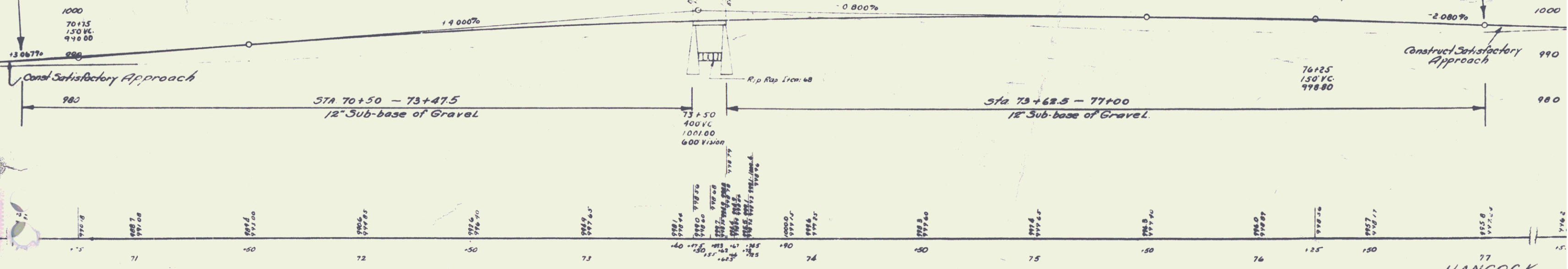

B.M. 1 - 12.10 25 R. Sta. 74+27 EL. 1000.00

HANCOCK
 51 107-L
 SHEET (A) 01 14

POOR ORIGINAL COPY

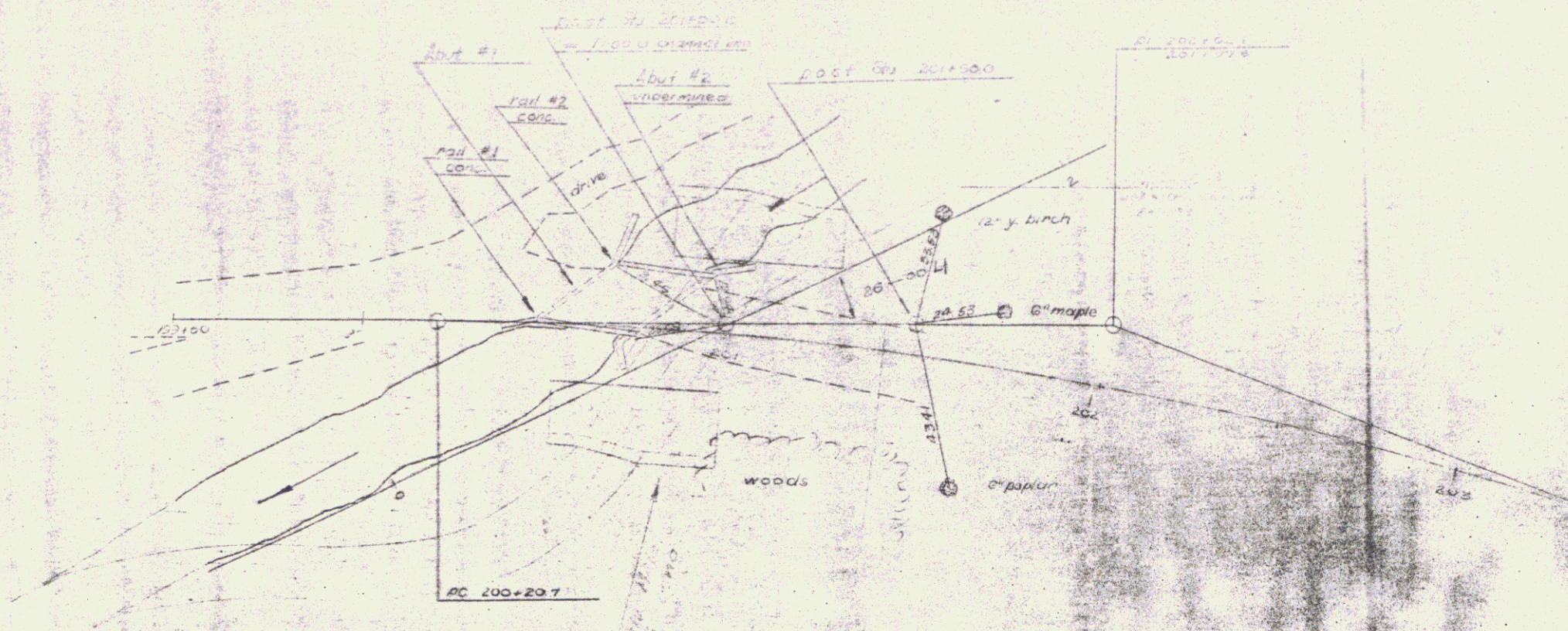

Br# 20?
M.P. 3.45

MP
 RIGHT-OF-WAY DIVISION
 TOWN FILE
 PERPETUAL
 Rte 4125
 Town of [unclear]
 (To Be Returned To R.O.W. Division)
 Hancock
 Hancock
 Bridge
 SHEET 2

3

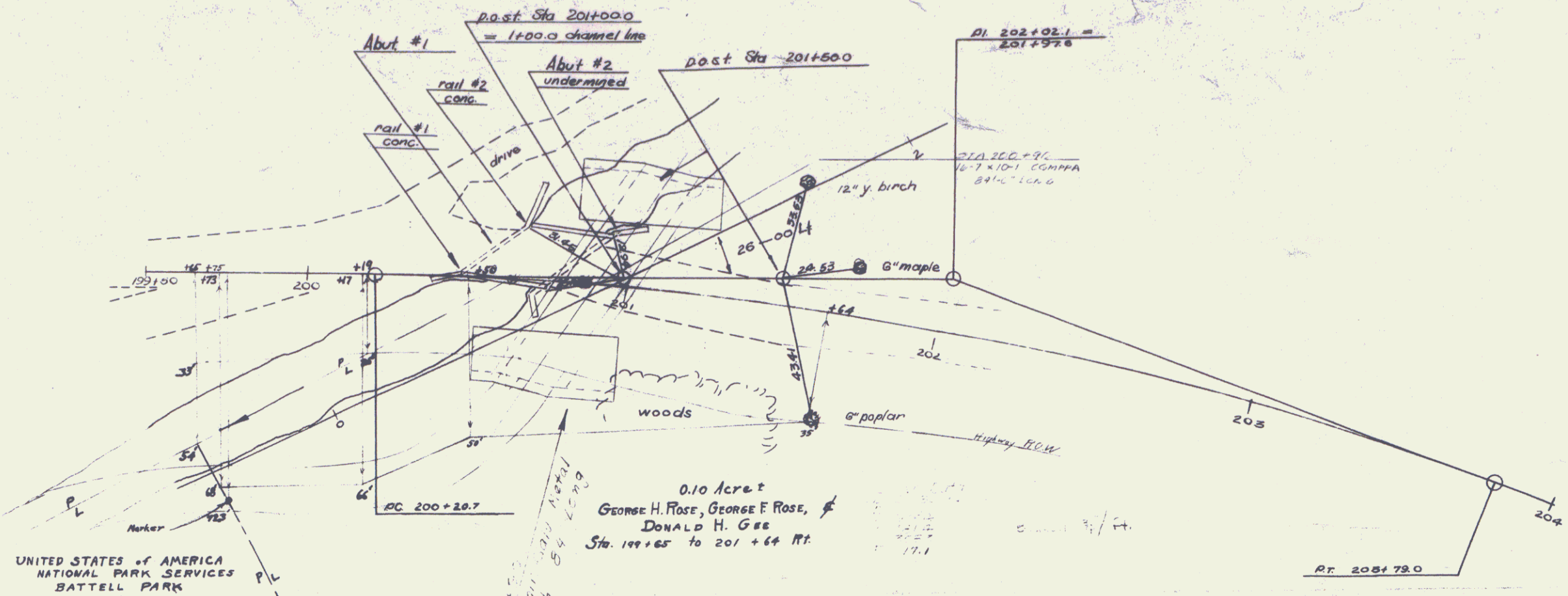

0.10 Acre ±
 GEORGE H. ROSE, GEORGE F. ROSE, &
 DONALD H. GEE
 Sta. 199+65 to 201+64 RT.

UNITED STATES OF AMERICA
 NATIONAL PARK SERVICES
 BATTELL PARK

199+00
 200' VC
 1237.50

PROJECT Hancock
 NUMBER SA-187-L
 TYPE Corr. Coll. Mail R. Pipe Arch
 CONTRACTOR
 YEAR 1956
 LOCATION W. 125 - Lynde St. 272+16
 COUNTY
 STATE

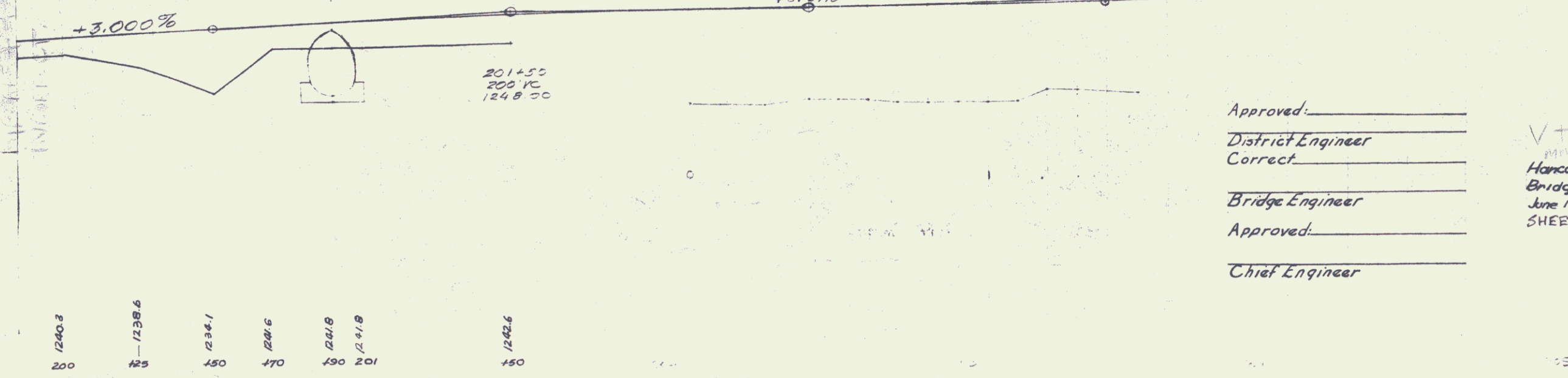

Approved: _____
 District Engineer
 Correct
 Bridge Engineer
 Approved: _____
 Chief Engineer

V+1
 Hancock S.A.
 Bridge 187.0
 June 19, 1956
 SHEET 2A

4