

GRAVEL BORROW ITEM 105
 BERLIN STATE HWY.
 104+00 - 110+75
 RAMP A
 36+41 - 37+86.5

SUB-BASE OF SAND ITEM 202
 BERLIN ST HWY.
 110+75 - 117+00

THREE CABLE GUARDRAIL
 W/ LIGHT STEEL POSTS, ITEM 535
 RAMP A
 36+41 - 37+86.5

TREATED TIMBER CURB, ITEM 555
 BERLIN ST HWY.
 105+45.75 - 110+75.75
 RAMP A
 36+41 - 37+86.5

STD. STEEL BEAM GUARD RAIL
 W/ STEEL POSTS (6'-3" SPACING)
 ITEM 345-A
 104+04 - 110+79 RT.

TWO CABLE GUARD RAIL, ITEM 341
 2+50 - 3+86 RT (Drive)

STONE FILL FOR SLOPE PROTECTION
 (LIGHT TYPE), ITEM 512
 BERLIN ST HWY.
 109+36 - 109+46 LT
 109+54 - 109+64 LT
 RAMP A
 36+37 - 37+03 RT.

RIP-PAD (LIGHT TYPE), ITEM 513-B
 BERLIN ST HWY.
 109+46 - 109+54 LT

CONSTRUCT DRIVES
 111+00 LT & RT
 104+25 LT
 3'00 TULLAR DRIVE

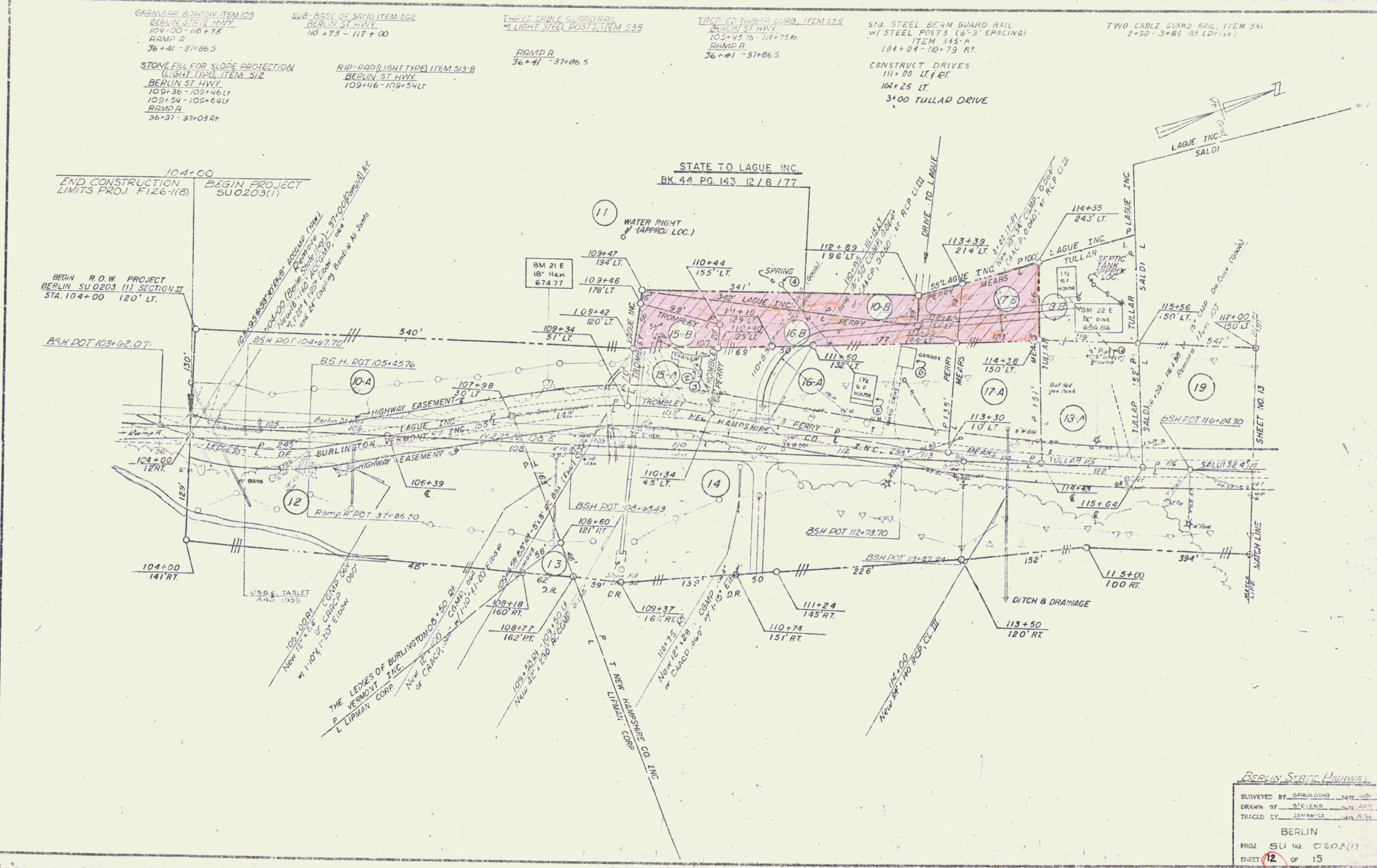

BERLIN STATE Highway
 SURVEYED BY SPAULDING DATE NOV. 63
 DRAWN BY STEVENS DATE APR. 65
 TRACED BY JANNICE DATE JUL. 65
 BERLIN
 PROJ SU NO. 0202(1)
 SHEET 12 OF 15

5