

GRANULAR BORROW  
BERLIN STATE HWY  
104+00 - 110+75  
RAMP A  
36+41 - 37+86.5

STONE FILL, TYPE II  
BERLIN STATE HWY  
109+56 - 109+64 LF  
109+54 - 109+64 LF

SAND BORROW  
BERLIN ST HWY  
110+75 - 117+00  
DEMOLITION + DISPOSAL  
OF BUILDINGS  
112+25 LF

REMOVE OR DEMOLISH  
(Common Excavation)  
③ Septic Tank 110+10 LF  
④ Spring 111+10 LF

GUARD RAIL, THREE CABLE  
w/ LIGHT STEEL POSTS  
RAMP A  
36+41 - 37+75 RT

BITUMINOUS SURFACE  
TREATMENT, TYPE V  
Drive 111+00 LF

TREATED TIMBER CURB  
BERLIN STATE HIGHWAY  
104+00 - 110+75 RT  
RAMP A  
36+41 - 37+86.5 RT

GUARD RAIL, STANDARD STEEL BEAM  
w/ STEEL POSTS, TYPE II  
(6'-3" SPACING)  
104+04 - 110+79 RT

CONSTRUCT DRIVES  
111+00 LF RT

WOOD GUIDE POSTS - 5'-0" SPACING  
Drive @ 111+00 - 2+50 - 3+86 RT

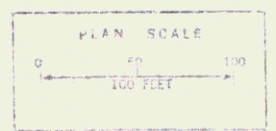
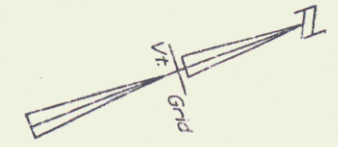
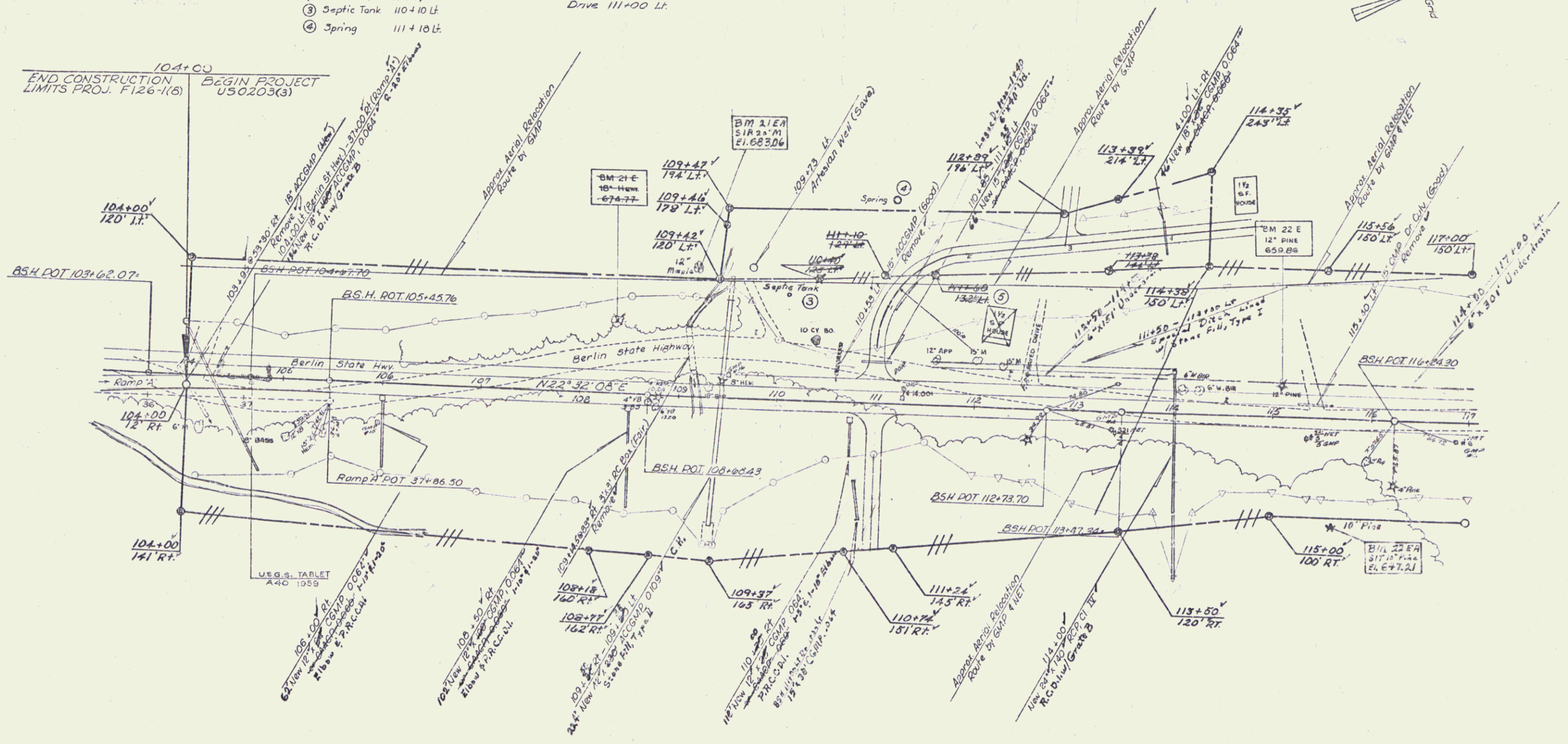

SECTION 2  
BERLIN STATE HIGHWAY

SURVEYED BY: SCALDING DATE: NOV '67  
 DRAWN BY: STEVENS DATE: APR '68  
 TRACKED BY: JANAWICZ DATE: MAY '68

BERLIN  
 FROM: US 020.2(3)  
 SHEET: 297 OF 341