

GUIDE POSTS OF WOOD  
CULVERT STA LEFT RIGHT

256+70	1	1
--------	---	---

CABLE GUARD RAIL

STA TO STA	LINE	LENG	CONSTANT	PRY LENG
242+35-242+59	LT	24'	40'	64'
242+35-242+59	RT	26'	40'	64'
243+02-243+26	LT	26'	40'	64'
243+02-243+26	RT	24'	40'	64'

REINFORCED CONCRETE PIPE CULVERTS

STATION	SIZE	LENGTH	C.B.M.
256+70	18"	46'	35cy.

47-B 1932 20 36

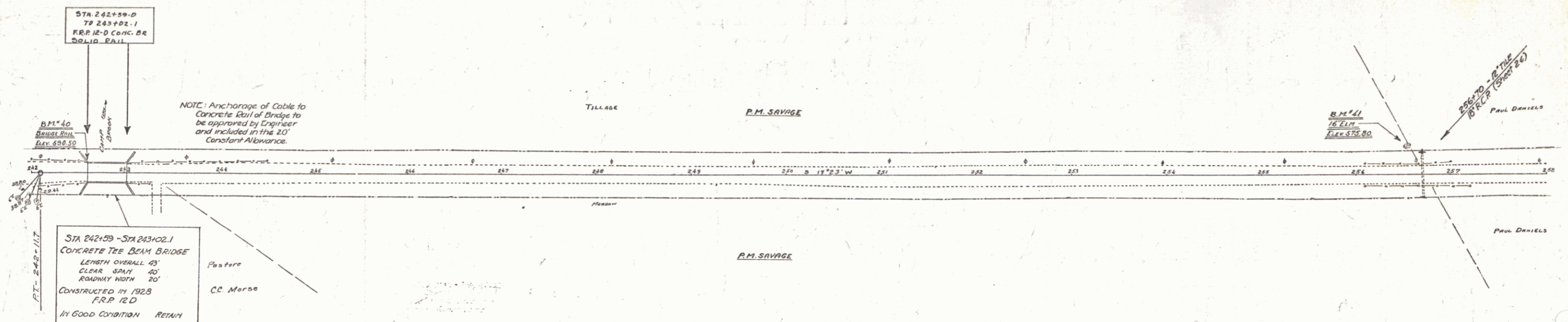
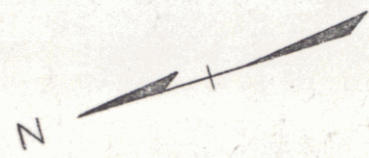

STA 242+39 - STA 243+02.1  
CONCRETE TEE BEAM BRIDGE  
LENGTH OVERALL 63'  
CLEAR SPAN 40'  
ROADWAY WIDTH 20'  
CONSTRUCTED IN 1928  
F.R.P. RD.  
IN GOOD CONDITION RETAIN

NOTE: Anchorage of Cable to Concrete Abutment of Bridge to be approved by Engineer and included in the 20' Constant Allowance.

WOOD PILE

WOOD PILE

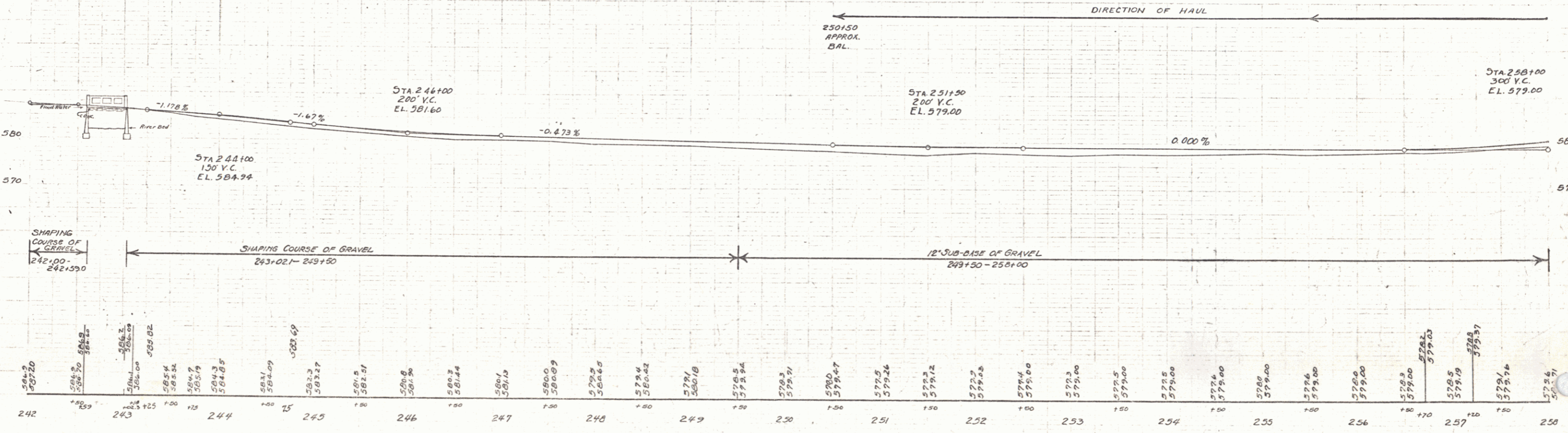

BM #40 PRINT SPOT ON CONC. RAIL OF BRIDGE 11 FT. LT. 242+39 ELEV. 590.50  
BM #41 SPIKE IN ROOT 16" ELM. 28 FT. LT. STA. 256+54 ELEV. 575.80

SERIES P.A.P. NO. 67-25  
SHEET 20 OF 96