

**GUIDE POSTS OF WOOD**

STATION	LT.	RT.
227+77	1	-
229+64	1	-

**WOOD GUARD RAIL**

STATION	LEFT	RIGHT
230+30	25	25
232+60	25	25

**REINFORCED CONCRETE PIPE CULVERTS**

STATION	SIZE	LENGTH	CONCRETE	SPACING	PERCENTAGE
227+77	18" x 18"	40'	14y	14y	137%
229+18	18" x 24"	25'	14y	14y	111%
230+30	24" x 24"	25'	14y	14y	58y
231+60	18" x 24"	25'	14y	14y	27y
232+60	18" x 24"	25'	14y	14y	14y

REV. CURVE No. 25  
 Δ 70° 30' 15"  
 D 77' 15"  
 R 130.3  
 T 56.20  
 L 97.70  
 E 173.4

CURVE No. 26  
 Δ 55° 15'  
 D 41'  
 R 40.3  
 T 23.4  
 L 40.9  
 E 56.9

**Concrete R.O.W. Markers**

STATION	LT.	RT.	DISTANCE
227+75	-	-	24.75 FT.
228+50	-	-	23 "
229+50	-	-	33 "
233+00	-	-	33 "

Markers Set by G.A. Pierce, June 1934  
 R.O.W. - Distance to back of Marker

Parcel	Kind of Instrument	Date of Instrument	Grantor	Grantee	Recorded Book/Sheet	Recorded Date	Remarks
Parcel A	O.C.D.	5-12-32	CLARENCE MORSE	STAFF	35 1137	5-23-32	Calc. Sta. 231.50
A		6-10-32	HAROLD BOZEMAN		35 1137	7-14-32	

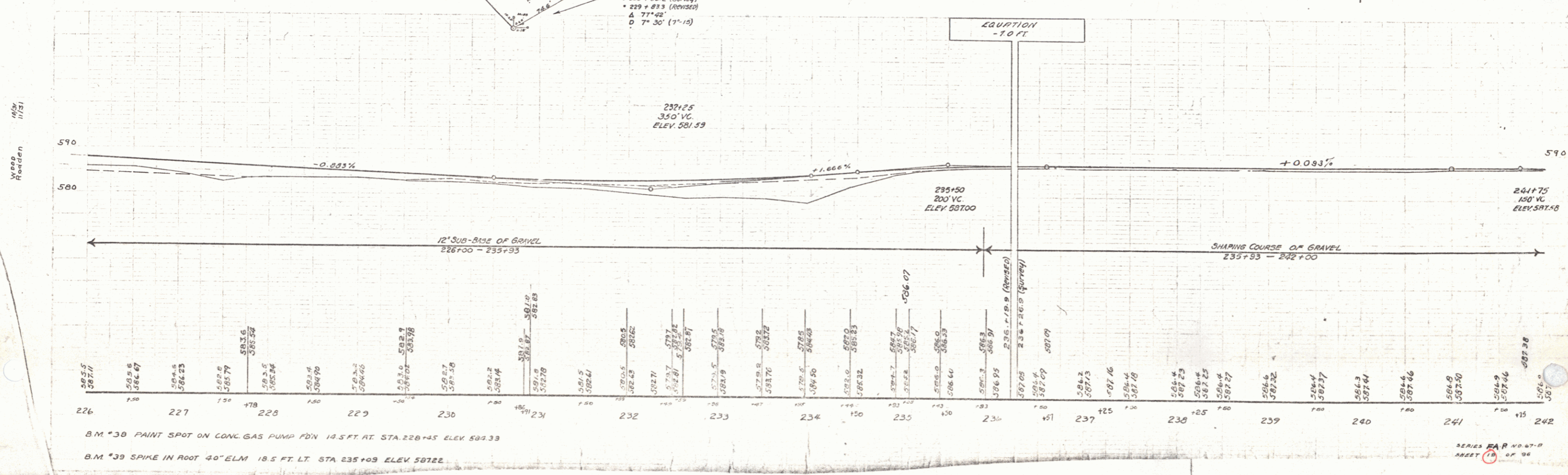

B.M. \*30 PAINT SPOT ON CONC. GAS PUMP FDN 14.5 FT. RT. STA. 228+45 ELEV 582.33  
 B.M. \*39 SPIKE IN ROOT 40" ELM. 18.5 FT. LT. STA. 235+09 ELEV 587.22