

WOOD GUARD RAIL

CULVERT STA.	LEFT	RIGHT
73+00	24	24
84+00	26	26

CABLE GUARD RAIL

STA. TO STA.	LENS	CONSTANT	DRY LEIS
73+40-79+00	LT	168	40 200
79+00-81+50	LT	176	40 216
81+50-86+00	LT	192	40 232
86+00-90+00	LT	68	20 88

REINFORCED CONCRETE PIPE CULVERTS

STATION	SIZE	LENS	CONC. A	CRIM.	REIN. STEEL
73+00	30"	68'	32.4	33"	58'
81+50	18"	38'	18"	14.4	11.4
77+58	15"	40'	2.3	1.4	157'

REINFORCED CONCRETE BOX CULVERT

STATION	SIZE	CURVE	LENS	STEEL	STRUCTURE	EXCAV.
84+88	4x5	27.0	22.0	22.6		

RELAYS PIPE CULVERTS

STATION	LENS	TYPE	SIZE	LENS	CRIM.
84+45	LT	CONC	10'	20'	23.4

STD. UNDERDRAIN WITH 6" P.C.G.M.P.

STA. - STA.	LENS	TYPE	CRIM.
70+00 - 70+25	25'	RT	1.00
77+00 - 77+58	58'	RT	1.75
84+50 - 84+88	38'	RT	3.8

GUIDE POSTS OF WOOD

CULVERT STA.	LEFT	RIGHT
81+26	2	2
77+58	1	1

Parcel Kind of Date of Grantor Grantee Received Remarks

Parcel	Kind of Instrument	Date of Instrument	Grantor	Grantee	Received	Remarks
A	G.C.D.	8-3-32	HOW DINGLER	ST. of H.	50	8-15-32 Randolph
A' & B'		6-30-32	H. HAND FIX	"	50	7-14-32 Randolph
A' & B' & C'		6-30-32	H. & N. D. FIX	"	35	7-14-32 Barbel

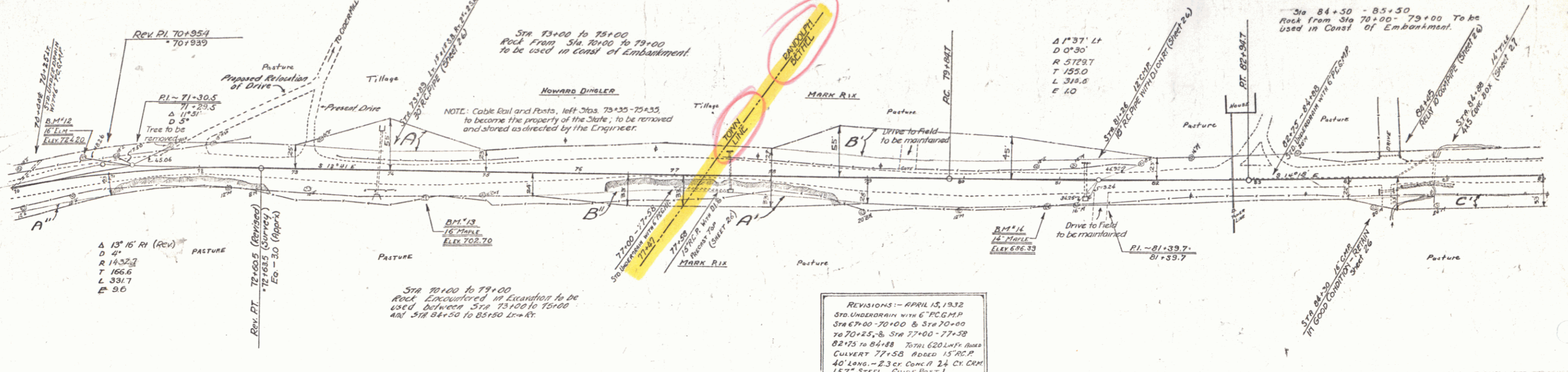

REVISIONS - APRIL 15, 1932
 STD. UNDERDRAIN WITH 6" P.C.G.M.P.
 STA 77+00-77+58 & STA 70+00-70+25
 STA 70+25-77+00 - 77+58
 84+75 to 84+88 Total 620 L.F. BOX CULVERT 77+58 ADDED 15" R.C.P. 40' LONG - 2.3 CR. CONC. A 24 CR. CRIM 157" STEEL GUIDE POST 1

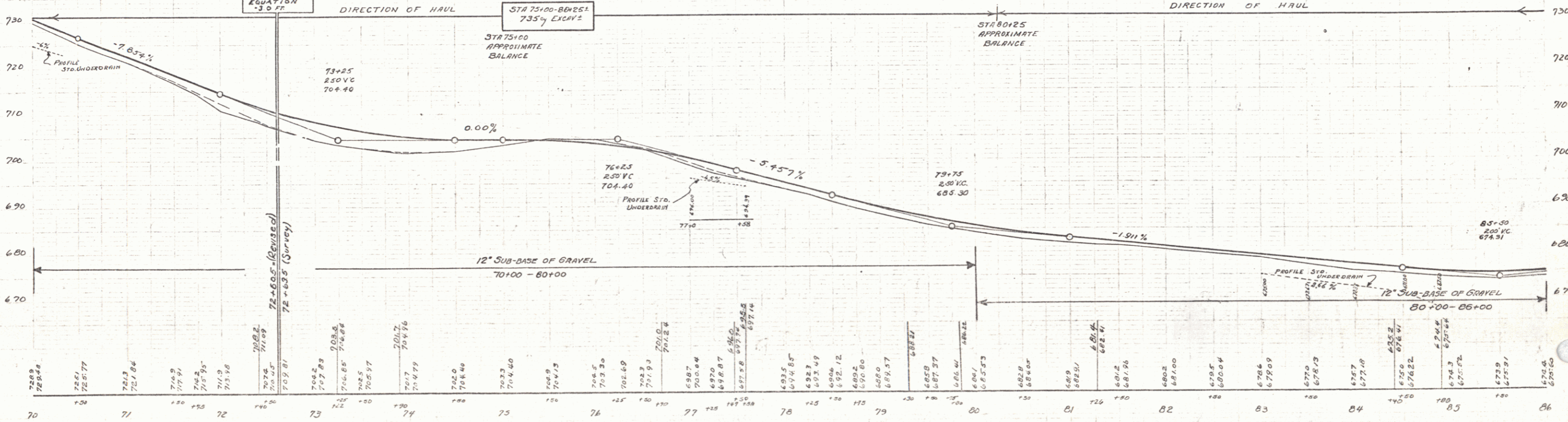

B.M. #12 - SPIKE IN TRUNK 16" ELM - 16.5' LT. STA 70+82 - EL. 724.20
 B.M. #13 - " " ROOT 16" MAPLE - 26' RT - " 74+37 - " 702.70
 B.M. #14 - " " TRUNK 14" " - 26' RT - " 80+86 - " 686.39

SERIES PART 67-B
 SHEET 5 OF 96