

WOOD GUARD RAIL  
 CULVERT STA LEFT RIGHT  
 36+81 --- 26

GUIDE POSTS OF WOOD  
 Station LEFT RIGHT  
 23+16 ---

STA TO STA	LEN	CONSTANT	DAY
27+00-27+24	24	40	104
27+10-27+30	20	40	88
36+60-37+24	64	40	104

Parcel	Kind of Instrument	Date of Instrument	Grantor	Grantee	Recorded	Remarks
B	G.C.D.	6-13-32	Fred P. Beeble	State of W.	50 1334	8-14-32
A & B	"	6-8-32	Thos. T. M. Capron	"	50 1023	7-14-32

STATION	SIZE	LEN	CONC.	CR.	REIN. STEEL	ALLEGES
23+14	24"	44'	---	---	---	---
27+35	24"	52'	---	---	---	---
36+81	30"	48'	32cy	---	---	58"

STA TO STA	LEN	CR.
31+50 - 32+50	100'	---
32+50 - 33+00	50'	---
33+00 - 36+40	340'	---
36+40 - 36+81	41'	---

STATE OF WISCONSIN  
 DIVISION OF HIGHWAYS  
 PROJECT NO. 167-B 1932 G 96

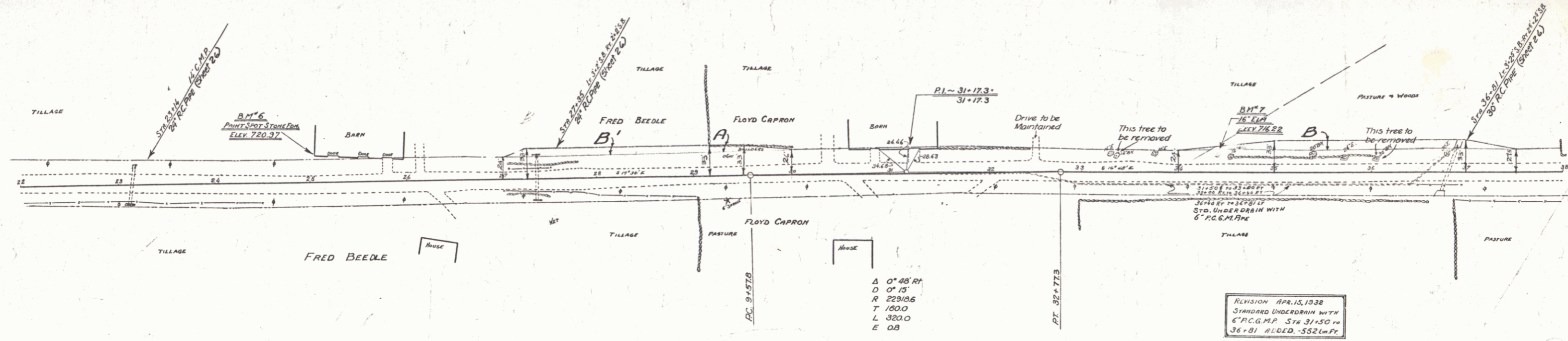

A 0° 48' RT  
 D 0' 15"  
 R 2230.6  
 T 1600  
 L 3500  
 E 0.8

REVISION APR. 15, 1938  
 STANDARD UNDERDRAIN WITH  
 6" P.C.G.M.P. STA 31+50 TO  
 36+81 ALL L.D. - 552 L.M.P.

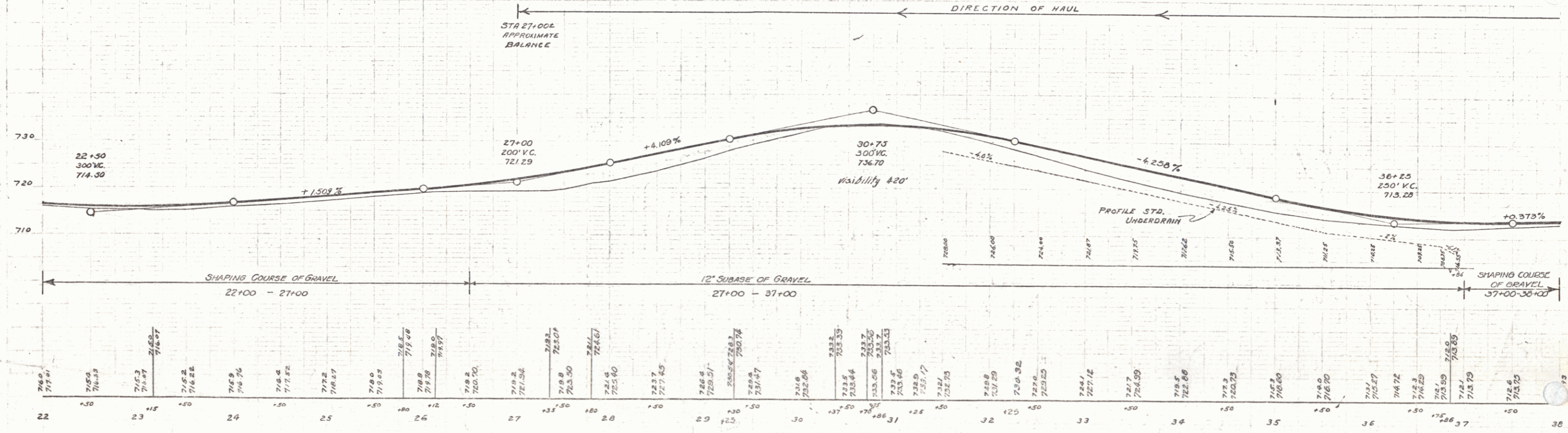

D.M. 6 - PAINT SPOT ON STONE FOOT OF BARN - 20' LT. - STA. 23+05 - EL. 720.97  
 D.M. 7 - SPIKE IN ROOT 16' ELM. 15' LT. - STA. 34+40 - EL. 716.22

SERIES R.A.P. NO. 67-B  
 SHEET 5 OF 96

4