

INDEX OF SHEETS

- 1-12 Plan and Profile Sheet
- 13-15 20 Scale-Special Detail Sheets of Divisional (and
- 16-24 Bridge-100 Series (Plan & Detail of Bridge including Chord Sections)
- STANDARD SHEETS
- 25 A-61 (Drilling & Blasting of Solid Rock Subgrade)
- 26 B-1 (Banking Tables)
- 27 B-5 (Typical Slope Grading)
- 28 B-10 (Slope Consolidation)
- 29 B-11 (Slope Stabilization)
- 30 C-1 (Culverts)
- 31 C-1a (Culverts)
- 32 D-2 (C.R.M. Roadways)
- 33 D-4 (Detention Flushing Basin & Cover)
- 34 D-8 (Reinforced Drop Inlet)
- 35 D-8 (Reinforced Drop Inlet-Tops)
- 36 D-10 (Reinforced Drop Inlet-Tops)
- 37 D-11 (Reinforced Drop Inlet-Grate)
- 38 D-16 (Detail of C.I. Grate)
- 39 E-1 (Barricades, Signs & Lights)
- 40 E-31 (Federal Aid Construction Identification Signs)
- 41 E-3 (Three Cable Guard Rail with Steel Posts)
- 42 G-4 (Steel Guide & Marker Posts)
- 43 J-1 (Project Markers) (Boundary Markers)
- 44 100-81-85 (General Bridge Notes)
- 45 100-86-85 (Detail B)
- 46-52 Cross Sections
- 53-55 BLANK

1966-1967
 2 Final Curves
 2 Dotted Plans
 2 Channel Plans
 2 Drainage Plans
 2 Misc. Stationing

STATE OF VERMONT
 DEPARTMENT OF HIGHWAYS
PROPOSED IMPROVEMENT

TOWN OF WILMINGTON
COUNTY OF WINDHAM
VERMONT ROUTE NO. 100
WILMINGTON-WEST DOVER ROAD

BEGINNING AT A POINT APPROXIMATELY 2.5 MILES SOUTHERLY OF THE WILMINGTON-DOVER TOWN LINE AND EXTENDING NORTHERLY 0.312 MILES.

LENGTH OF ROADWAY 1627.50 FEET 0.308 MILES
 LENGTH OF BRIDGE 22.50 FEET 0.004 MILES
 LENGTH OF PROJECT 1650.00 FEET 0.312 MILES



PROJECT NAME & NUMBER TYPE PAVT. AREA
 WILMINGTON S 017 (4) BIT. CONC. PAVT.
RECORD PLANS
MATERIALS

SUBBASE OF GRAVEL & GRAVEL SHOULDERS—MRS. J. FABRI GRAVEL PIT—WILMINGTON, VT.
 PEASTONE — W. E. DAILEY — BENNINGTON, VT.
 ASPHALT — MOBIL OIL — ALBANY, N.Y. & PROVIDENCE, R.I.
 TAR EMULSION — TRIRAM CORP. — FRAMINGHAM, MASS.
 BITUMINOUS CONCRETE — LAKE ASPHALT AND PETROLEUM CO. OF MASS.—E. DEERFIELD, MASS.
 CONCRETE CLASS AA & B — W. E. DAILEY READY MIX — SO. SHAFESBURY, VT.
 REINFORCING STEEL — BETHLEHEM STEEL CORP.—CAMBRIDGE, MASS.
 STRUCTURAL STEEL — A. LEO NASH STEEL CORP.—PITTSFIELD, MASS.
 PREFORMED JOINT SEALER — D. S. BROWN CO.—NO. BALTIMORE, OHIO.
 BRIDGE RAILING — VERMONT STRUCTURAL STEEL CORP.—BURLINGTON, VT.
 GRANITE BRIDGE CURB — BARETTA GRANITE CO.—MILFORD, N.H.
 METAL CULVERT PIPE — NORTHEASTERN CULVERT CORP.—WESTMINSTER, VT.
 CAST IRON GRATE — E. L. LEBARON FOUNDRY CO.—BROCKTON, MASS.
 PRECAST REINFORCED CONCRETE CURB D.I., PROJECT MARKERS, BOUNDS & STEEL MARKER POSTS — S. I. GRISWOLD AND CO., INC. — WILLISTON, VT.
 CABLE FOR GUARD RAIL — PAULSEN WEBBER CORDAGE CORP.—SUDBURY, PA.
 STEEL GUIDE POSTS & CABLE GUARD RAIL—MAINLINE FENCE CO.—WESTBROOK, ME.
 CONTRACTOR—W. H. MORSE CONST. CO., INC. BENNINGTON, VT.
 RES. ENG.—R. MCCLAY & D. C. HASTINGS. RECORD PLANS—A. G. SPIDLE.

CONTRACT : DATED—SEPTEMBER 12, 1966.
 STARTED—SEPTEMBER 29, 1966.
 COMPLETED—JULY 13, 1967.
 ACCEPTED—AUGUST 1, 1967.

1966	ADT	2150-1750
1966	ADT	3500-2950
1966	DHV	1500-1160
	V	40 MPH
	D	56
	T	3

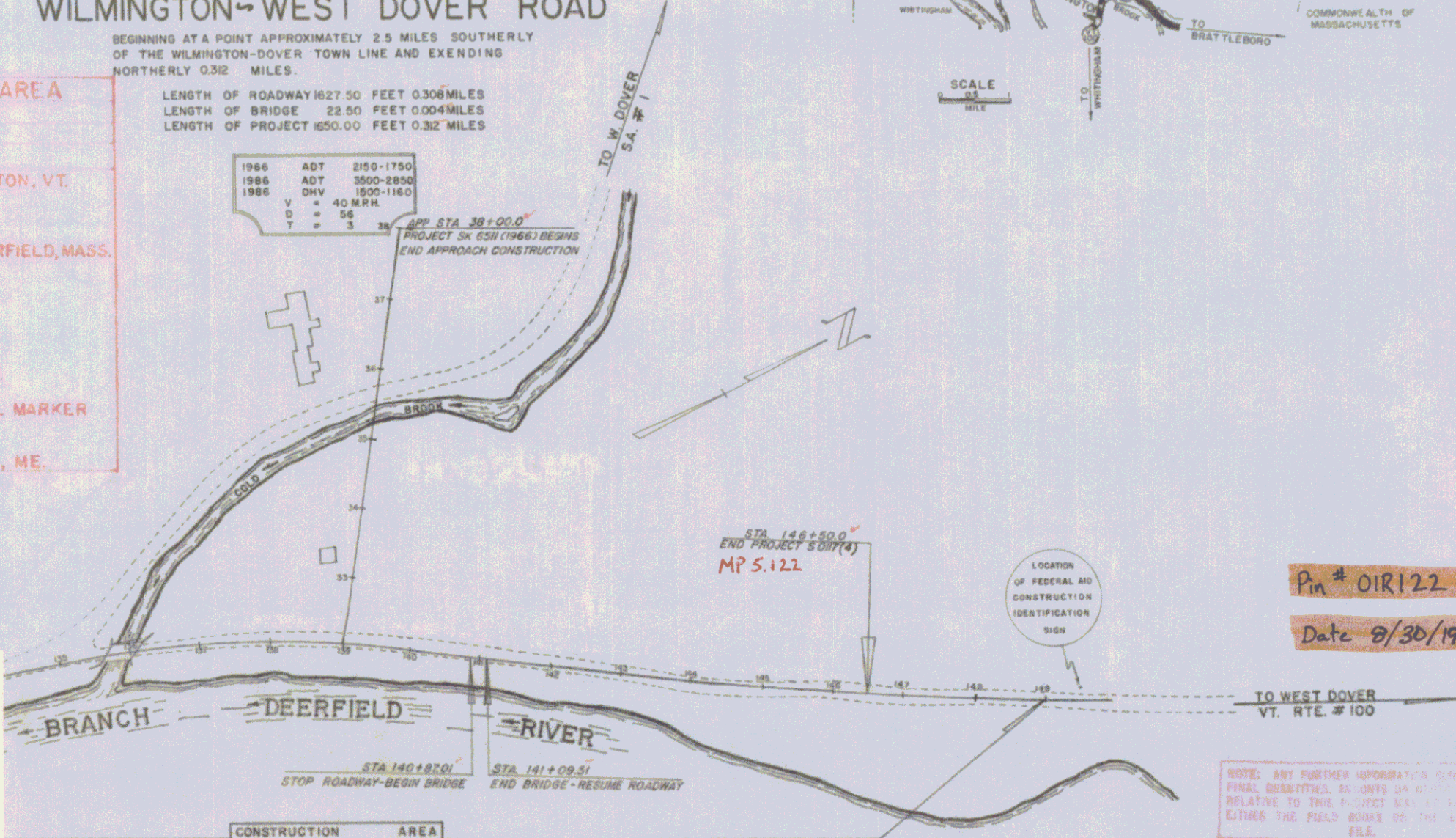

CONVENTIONAL SIGNS

- COUNTY LINE
- TOWN LINE
- FENCE LINE
- STONE WALL
- UNFENCED PROPERTY
- GUARD RAIL
- TRAVELED WAY
- RAILROAD
- RETAINING WALL
- CENTER LINE
- SURVEY LINE
- CULVERT
- DROP INLET
- TROLLEY POLE
- POWER POLE
- TELEPHONE POLE
- TREES
- HEDGE

- RIGHT-OF-WAY LINE
- SLOPE RIGHTS
- GROUND ELEVATION
- GRADE ELEVATION
- CURVE DATA
- REFLECTION OF ANGLE
- DEGREE OF CURVE
- RADIUS OF CURVE
- TANGENT DISTANCE
- LENGTH OF CURVE
- EXTERNAL DISTANCE
- POINT OF INTERSECTION
- POINT OF CURVE
- POINT OF TANGENT
- POINT ON TANGENT
- POINT ON SUB-TANGENT

PROJECT: WILMINGTON
 NUMBER: S 017 (4)
 TYPE: BITUMINOUS CONCRETE PAVEMENT
 CONTRACTOR: W. H. MORSE CONST. CORP. BENNINGTON, VT.
 YEAR: 1966-67
 LOCATION: BEGINNING AT A POINT APPROXIMATELY 2.5 MILES SOUTHERLY OF THE WILMINGTON-DOVER TOWN LINE AND EXTENDING NORTHERLY 0.312 MILES.

APPROVED: [Signature]	APPROVED: [Signature]	APPROVED: [Signature]	APPROVED: [Signature]	APPROVED: [Signature]	APPROVED: [Signature]
DATE: 1/28/65	DATE: 12/21/65	DATE: 1/28/65	DATE: 2/15/66	DATE: 12/22/65	DATE: 8/20/66

THESE PLANS ARE SUBJECT TO SUCH REVISIONS AS MAY BE REQUIRED BY THE BUREAU OF PUBLIC ROADS OR THE COMMISSIONER OF HIGHWAYS.
 CONSTRUCTION IS TO BE CARRIED ON IN ACCORDANCE WITH THESE PLANS AND THE STANDARD SPECIFICATIONS FOR HIGHWAY AND BRIDGE CONSTRUCTION DATED APRIL 1964, AS APPROVED BY THE BUREAU OF PUBLIC ROADS ON OCTOBER 12, 1964, INCLUDING ALL SUBSEQUENT APPROVED REVISIONS AND SUCH REVISED SPECIFICATIONS AND SPECIAL PROVISIONS AS ARE INCORPORATED IN THESE PLANS.

NOTE: ANY FURTHER INFORMATION OR REVISIONS SHOULD BE SUBMITTED AS LINES OR OTHER MARKS RELATIVE TO THIS PROJECT SHALL BE MADE EITHER THE FIELD BOOK OR THE ORIGINAL FILE.
 BENCH MARKS BASED ON U.S.S. ELEVATIONS.

DEPARTMENT OF COMMERCE
 BUREAU OF PUBLIC ROADS
 APPROVED: [Signature]
 DIVISION ENGINEER
 DATE: [Blank]
 SHEET 1 OF 25 SHEETS

Pin # 01R122
 Date 8/30/1966

STATE OF VERMONT
DEPARTMENT OF HIGHWAYS
RIGHT-OF-WAY PLANS
DETAIL SHEET
OF

TABLE OF PROJECT PROPERTY ACQUISITION

PARCEL NO.	GRANTOR	SHEET NO.	BEGINNING STATION	ENDING STATION	TAKING A ^c	REM. A ^c	RIGHTS	TITLE TAKEN	DATE	TOWN OR CITY RECORDED	BK.	PG.	REMARKS
1a	HOWE, FRANCIS E.	7,8	128+00	135+34	0.1								
1b		7,8	128+00 130+85 _{LT.} 132+04 _{LT.} 132+14 _{LT.} 131+78	135+48 135+65 _{LT.}	0.4		DRIVE (T) SLOPE RTS. (T) CULVERT (P) WATERLINE						
2	VOGEL, ROBERT M. & THORA T.	8,9	135+34 135+70 _{LT.} 136+98 _{LT.} 140+48 _{LT.} 140+50 _{LT.} 34+55 _{RT.} 36+00 _{RT.} 35+45 _{LT.} 36+43 _{RT.} 36+60 _{LT.} 36+42 142+00 _{LT.} 33+66 _{C.}	143+00 137+85 _{LT.} 141+00 _{LT.} 141+50 _{LT.} 36+00	1.1 0.1 100 _{SPT.} 0.4		SLOPE RTS. (T) CULVERT (P) SLOPE RTS. (T) CHANNEL (P) DRIVE (T) DRIVE (T) DRIVE (T) CULVERT (P) DRIVE (T) CULVERT (P) CULVERT (P) CULVERT (P)						
3	HANLEY, JAMES J. & YOLANDE	8,9	135+48 144+00 _{RT.} 146+60 _{RT.}	149+89 146+76 _{RT.} 180 _{SPT.}	0.8		SLOPE RTS. (T) CULVERT (P)						
4	HAY, IAN M. & HAZEL H.	8	37+50 _{RT.} 36+00 _{RT.}	38+00 _{RT.} 165 _{SPT.}			SLOPE RTS. (P) DRIVE (T)						

TABLE OF REVISIONS

REVISION NO.	SHEET NO.	DESCRIPTION OF REVISION	DATE	MADE BY	APPROVED BY
1	9	Parcel # 2, Culvert Right added between Station 33+66 CL. - 36+00 per change Order # 576	1-20-67	M.A.R.	<i>[Signature]</i>

MP 486-518
RIGHT-OF-WAY DIVISION
TOWN FILE
PERPETUAL
Town of Wt 100
(To Be Returned To R.O.W. Division)

MADE BY: C.R.L. DATE: 8-30-66
CHECKED BY: _____ DATE: _____

PRESENT R.O.W.
 - - - - - TAKING WITHOUT ACCESS
 - - - - - TAKING WITHOUT ACCESS ALONG PROPERTY LINES
 - - - - - TAKING WITH ACCESS
 (P) PERMANENT EASEMENT
 (T) TEMPORARY EASEMENT

LEGEND
 SR - SR - SLOPE RIGHTS
 P - P - PROPERTY LINE
 - Δ - Δ - TOP OF CUT
 - O - O - TOE OF SLOPE

APPROVED: T.C. Bennett DATE: 8-30-66
 CHIEF OF ACQUISITION
 APPROVED: P.H. Saw DATE: 8-30-66
 HIGHWAY ENGINEER
 APPROVED: H.P. Radgion DATE: 8-30-66
 R.O.W. DIVISION

PROJECT: WILMINGTON
 NO. S 0117(4)
 SHEET: (6) OF 55

Steel Guide Posts
 128+53 - 130+00 Rt. 7
 131+50 - 131 5

THREE CABLE GUARD RAIL
 W/ STEEL POSTS
 Rt.
 133+00 - 131+44
 131+59 - 134+00
 130+22 - 131+07
 131+64 - 134+00

STONE FILL FOR SLOPE PROTECTION
 (LIGHT TYPE)
 Rt.
 131+25 - 134+00

SLOPE EDGING
 Lt.
 132+50 - 134+00

CONSTRUCT DRIVE
 Lt. Rt.
 130+20 131+50

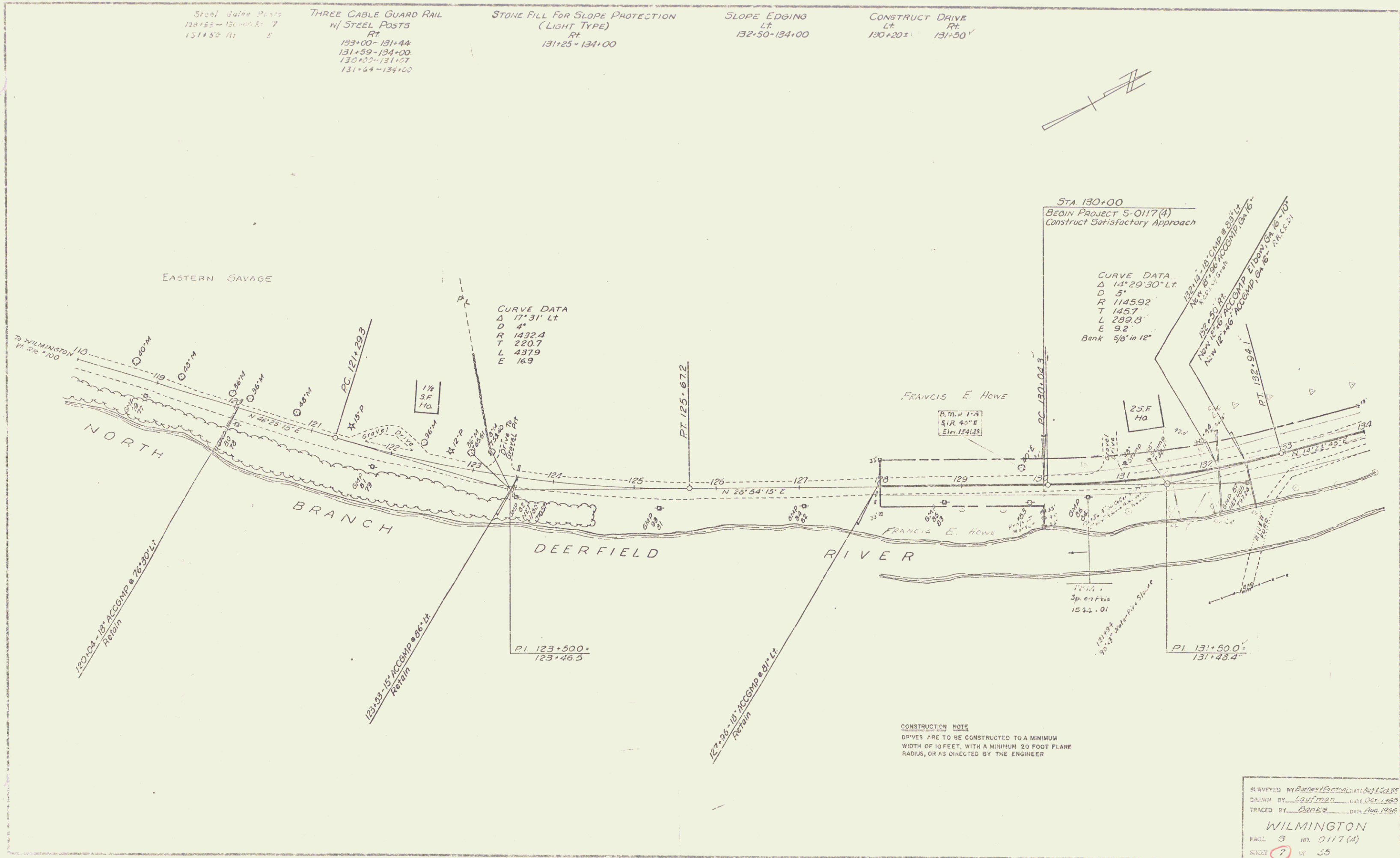

POOR ORIGINAL COPY

CURVE DATA
Δ 101°31' 17"
D 24"
R 14324
T 2207
L 2579
E 189

4 150+00
200' 200' 200' 200'
(Extracted from Station, 4, 150+00)

CURVE DATA
Δ 101°31' 17"
D 24"
R 14324
T 2207
L 2579
E 189
Bank 100' 110'

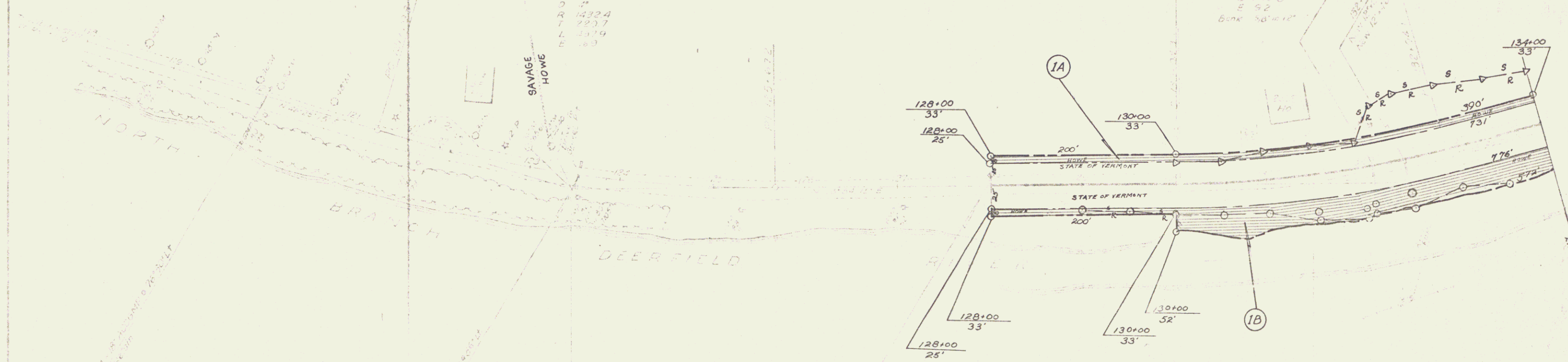

7A

4

STONE FILL THREE CABLE GUARD RAIL FOR SLOPE PROTECTION WITH STEEL POSTS (LIGHT TYPE)

RT	142'00" - 142'85.5"	97'	143'100"	143'100"
RT	142'100" - 143'150"	143'144" - 146'30"	142'25"	149'180"

CONSTRUCT DRIVE

LT	143'100"	143'100"
RT	142'25"	149'180"

Steel Guide Posts
143'100 Rt 5

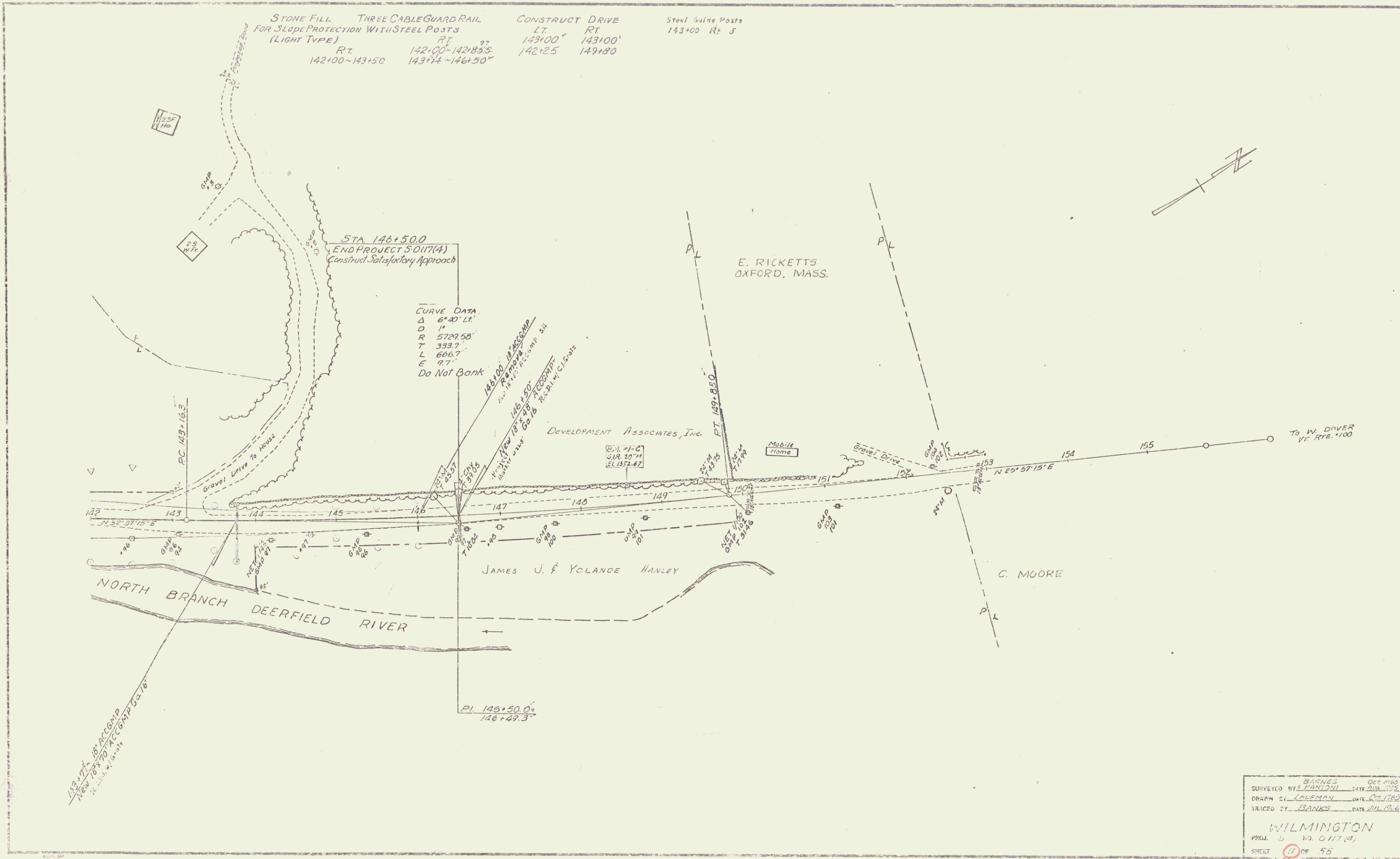

CURVE DATA
 Δ 6°40' LT
 D 14
 R 5729.55'
 T 333.7'
 L 666.7'
 E 9.7'
 Do Not Bank

BARNES OCT 1965
 SURVEYED BY S. FANTON DATE 2/28/65
 DRAWN BY COLEMAN DATE OCT 1965
 TRACED BY BANKS DATE JUL 1966
 WILMINGTON
 PROJ. 5 NO. 0117(4)
 SHEET 11 OF 55

POOR ORIGINAL COPY



DO NOT BANK
 PL
 46.100
 46.100
 46.100

DEVELOPMENT ASSOCIATES, INC.
 UO66L
 143+00
 33'
 142+01
 24'
 (245)
 141+00
 85'
 144+00
 33'

DEVELOPMENT ASSOCIATES, INC.
 STATE OF VERMONT
 590'
 149+00
 26'
 149+90
 33'

RICKETTS
 MOORE
 HOWE
 MOORE

11A

- INDEX OF SHEETS
- SHEET 1 PLAN AND PROFILE
- 2 - SERIES S.B. 20 NO. 45" SPAN 15" SKEW WITHOUT GRAVEL
 - 3 - S.B. NO. 2 TYPICAL DETAILS
 - 4 - S.B. NO. 3 SKEW ENDS
 - 5 - S.B. NO. 4 SOLID PAV.
 - 6 - S.A.R. NO. 12' T. 4" SQUARE
 - 7 - S.A.R. NO. 12' T. BEAM 15" SKEW

- SUMMARY OF QUANTITIES
- ITEM 15 - STRUCTURE ELEVATION 450 CU YDS
- 34A - CONCRETE CLASS A (1-2-4) 73 CU YDS
 - 34B - CONCRETE CLASS B (1-2-5) 170 CU YDS
 - 35 - REINFORCING STEEL 26,500 LBS

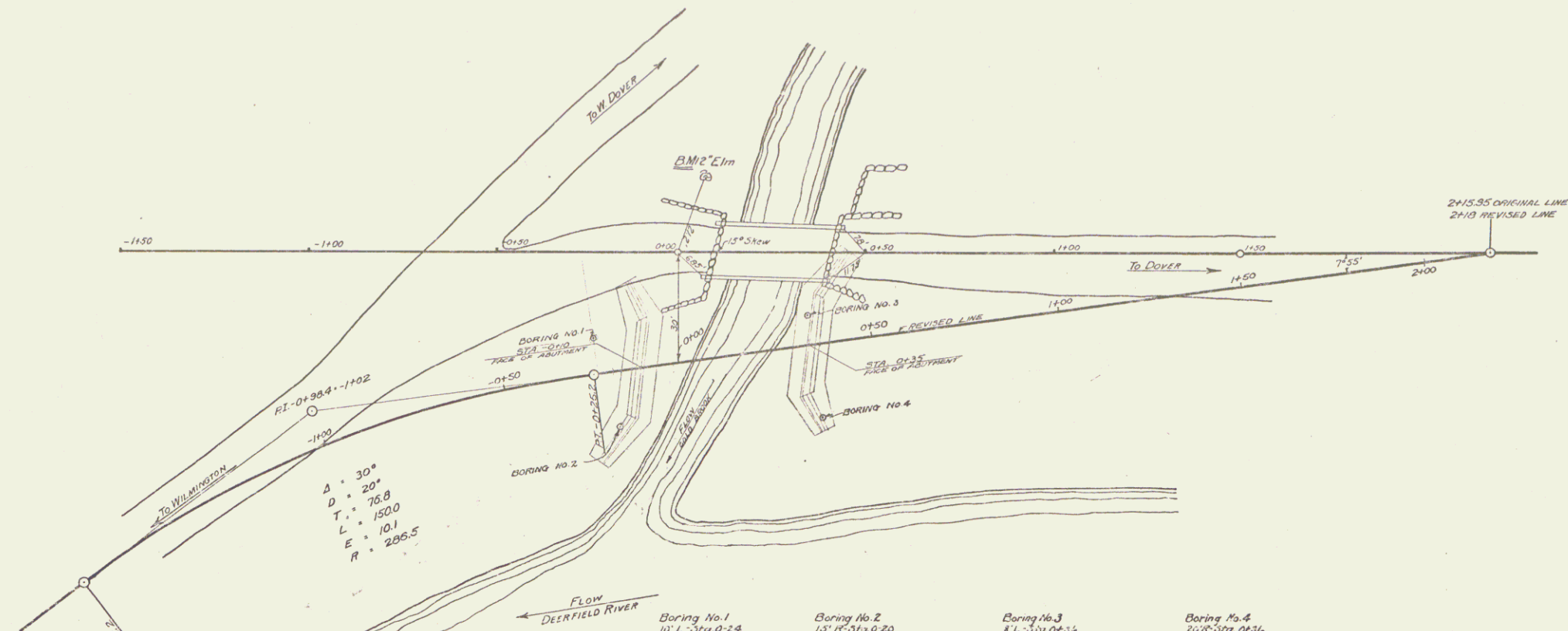

Boring No. 1	Boring No. 2	Boring No. 3	Boring No. 4
12' 0" Dia. 0-24	12' 0" Dia. 0-20	8" 0" Dia. 0-25	20" 0" Dia. 0-26
Elev. 92.2	Elev. 89.0	Elev. 91.6	Elev. 89.8
Sand & silt	1' 0" - 1' 6" - Coarse Sand 1' 6" - 2' 3" - Gravel	Sand & Gravel	Sand & Gravel
Elev. 74.0	Sand & Gravel	Elev. 81.5	Sand & Gravel
Elev. 74.0	Elev. 74.0	Gravel	Elev. 73.5
Coarse Gravel	1' Coarse Gravel	Elev. 71.5	Very Coarse Gravel
Elev. 62.0	Elev. 62.0	Elev. 70.5	Elev. 62.5
Very Coarse Gravel	Very Coarse Gravel	Large Rocks	Large Rocks

Correct
A. D. Bishop
Bridge Engineer

Approved: 7/14/28
J. E. Sargent
Chief Engineer

*This bridge replaced
in 1917*



COLD BROOK BRIDGE
WILFINGTON, VT.
App. No. 5-1928
Vt. 100, 451, 500 Cold Brook
SHEET 12